

INSTALLATION INSTRUCTIONS

WRAP AROUND SERIES

Model Series: CA, OW, VCA, SJ, SW, TCA,
TOW, TVCA, TSJ, TSW

CAUTION: THE INSTALLATION AND SERVICING OF THIS PRODUCT SHOULD BE PERFORMED BY A QUALIFIED ELECTRICIAN OR SERVICE PERSONNEL

ATTENTION : L'INSTALLATION ET L'ENTRETIEN DE CE PRODUIT DOIVENT ÊTRE EFFECTUÉS PAR UN ÉLECTRICIEN OU UN MEMBRE DU PERSONNEL QUALIFIÉ.

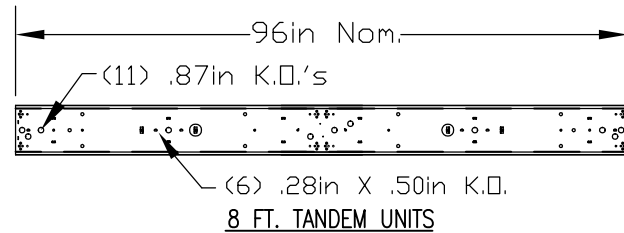
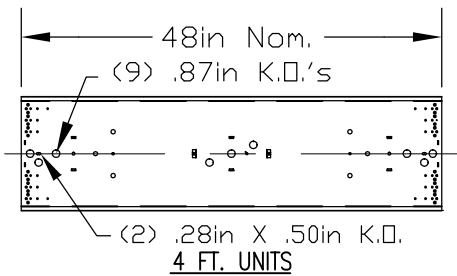

MOUNTING PATTERNS

SURFACE CEILING MOUNT

GRID TEE CEILING MOUNT

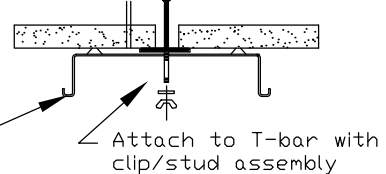
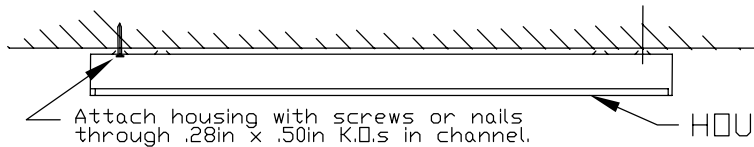

NOTE: Fixtures (except 3 lamp) may be pendant mounted through .87in K.O.s. When installing fixtures end to end for through wiring, remove .87in K.O.s and install bushing.

To remove lens lift lens up shift to one side and hinge down.

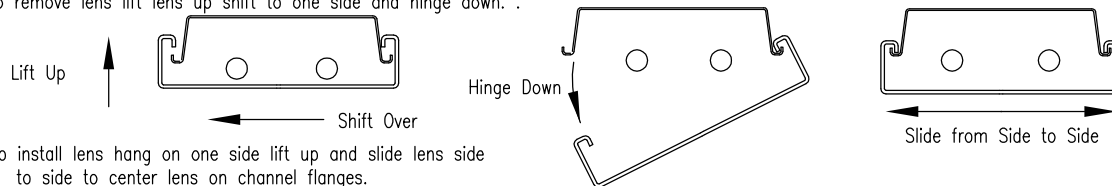

To install lens hang on one side lift up and slide lens side to side to center lens on channel flanges.

ELECTRICAL CONNECTIONS

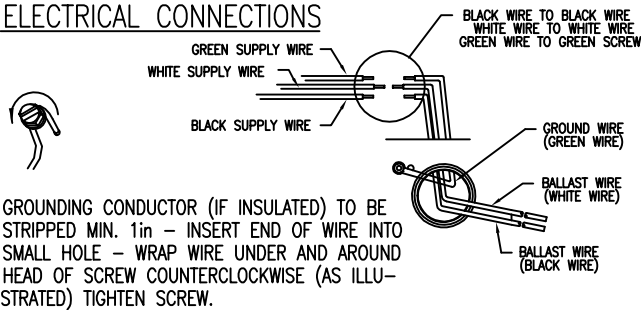

GROUNDING CONDUCTOR (IF INSULATED) TO BE STRIPPED MIN. 1in - INSERT END OF WIRE INTO SMALL HOLE - WRAP WIRE UNDER AND AROUND HEAD OF SCREW COUNTERCLOCKWISE (AS ILLUSTRATED) TIGHTEN SCREW.

ROW MOUNTING (except SJ series)

Remove two .18in K.O.s in each metal end cap. Lock fixtures together using (2) No. 8 screw through end cap K.O.s. place nut on screw and tighten securely.

Remove two .87in K.O.s in each metal end cap. Lock fixtures together using .87in conduit bushing (by others). Pull supply wires through bushing and connect to ballast leads in wiring channel.

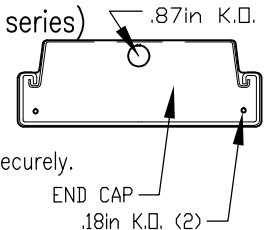

VANDAL RESISTANCE FIXTURE

After fixture is installed and lens is in place, open the vandal resistant bag parts, clips in hardware bag can now be installed. Start screw in holes provided on the side of the fixture near the ends.

Before tightening the screw, slide clip down over the screw head. While holding clip against lens flange, tighten screw.

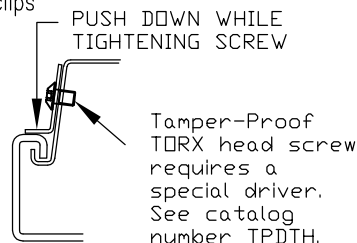

DECORATIVE END CAP OPTIONAL (CA SERIES)

Remove two .18in K.O.s in each metal end cap. Place studs on back of end caps through these holes and secure with push-nuts from inside fixture.

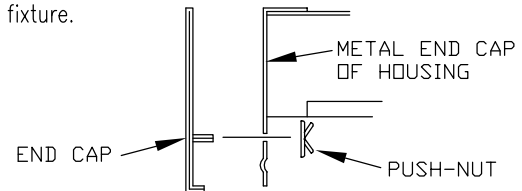

CAUTION: Electrical luminaires are designed for permanent installation in ordinary (Non-Hazardous) locations in accordance with the National Electrical Code and all applicable local codes. Do not use in areas of limited ventilation or in high ambient enclosures. The lamp and luminaire operate at high temperatures, contact with combustible materials can cause fire and personal contact can cause severe burns.

ATTENTION: Ce luminaire a été conçu pour une installation permanente dans un emplacement régulier (non dangereux) et en conformité avec le Code électrique canadien et codes locaux applicables. Ne jamais installer dans un endroit où la ventilation est limitée ou dans des boîtiers où la température ambiante est très élevée. La lampe et le luminaire fonctionnent à des températures élevées, un contact avec des matériaux combustibles peut engendrer un incendie et un contact corporel peut causer de sévères brûlures.

PHILIPS

Philips Lighting North America Corporation
200 Franklin Square Drive
Somerset, NJ 08873, USA
Phone: 855-486-2216
philips.com/luminaires

Philips Lighting Canada Ltd.
281 Hillmount Road
Markham ON, Canada L6C 2S3
Phone: 800-668-9008
philips.com/luminaires

712674103 APRIL, 2013
12NC: 443580051140
SAP 12NC: 443580390460