



by Signify

Architectural Linear

TruGroove suspended micro

IS-TM03 Suspended Indirect



System Overview

These instructions review how to install TruGroove suspended micro fixtures. Modules can be installed as individual 2ft, 2.5ft, 3ft, 3.5ft, 4ft, 5ft, 6ft, or 8ft standalone units, or they can be joined together to create continuous runs and patterns. The graphics below show the components required to install a typical run of TruGroove suspended micro fixtures.

IMPORTANT: Read all instructions including fixture wiring AND mechanical details before beginning installation.

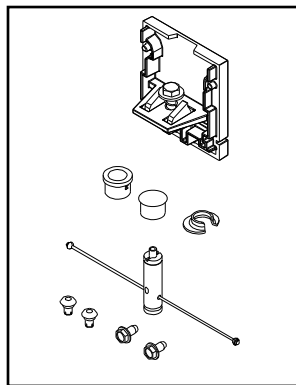

TM Indirect Endcap Kit

- TM indirect endcap (x1)
- Sling cable assembly (x1)
- Cable strain relief (x1) (Heyco #7418)
- 1/2" bushing (x1)
- 1/2" plug (x1)
- Push pins (x2)

Note: 2 kits required for capped ends

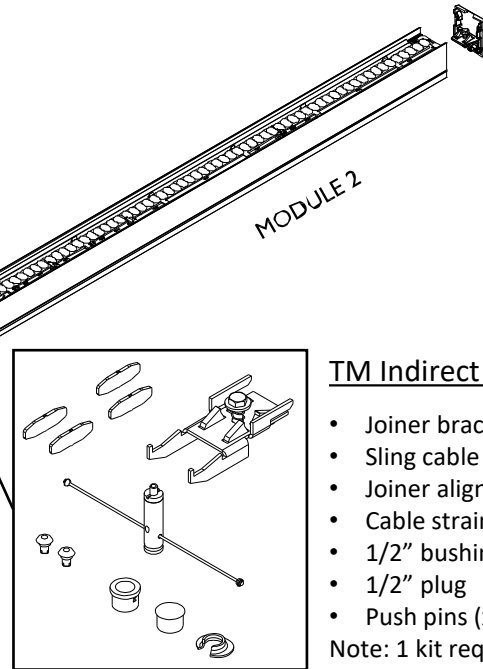

TM Indirect Joint Kit

- Joiner bracket (x1)
- Sling cable assembly (x1)
- Joiner aligners (x4)
- Cable strain relief
- 1/2" bushing
- 1/2" plug
- Push pins (x2)

Note: 1 kit required per joint

Module Lengths

TruGroove suspended micro fixtures come in the module lengths shown below. Add 0.25" for each endcap for accurate run length.

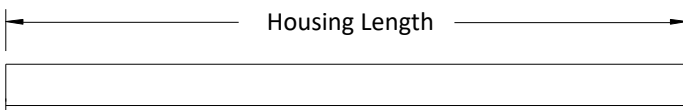

Length without endcaps	feet	2.0	2.5	3.0	3.5	4.0	5.0	6.0	8.0
	Inches	24.0	30.0	36.0	42.0	48.0	60.0	72.0	96.0
	mm	610	762	914	1067	1219	1524	1829	2438

Mount Spacing

Fixture modules are designed for exact on-grid mounting. For non-accessible ceilings or in tile installations, mounts are adjustable within 1" of each module end.

TOOLS REQUIRED:

- 5/16" nut driver
- Small flathead screwdriver
- Heyco PN0019(R12) crimping tool

! **ATTENTION: Install in accordance with local and national building and electric codes.**

This equipment has been tested and found to comply with the limits for a Class A digital device, pursuant to part 15 of the FCC Rules. These limits are designed to provide reasonable protection against harmful interference when the equipment is operated in a commercial environment. This equipment generates, uses, and can radiate radio frequency energy and, if not installed and used in accordance with the instruction manual, may cause harmful interference to radio communications. Operation of this equipment in a residential area is likely to cause harmful interference in which case the user will be required to correct the interference at his own expense.

**Warning! Shock Hazard!**

IMPORTANT:
Disconnect or turn off
power before
attempting any
installation, service or
maintenance.

**Warning! Shock Hazard!**

Fixture must be
connected to building
ground via the
provided ground wire
before re-connecting
to main power supply.

**Installation Notes**

Arrange boxed fixtures on floor in specified mounting locations, based on supplied layout drawings. Remove fixtures from boxes.

Install all ceiling mounting components and vertical aircraft cables using separate installation instruction for Aircraft Cable Mounting (supplied).

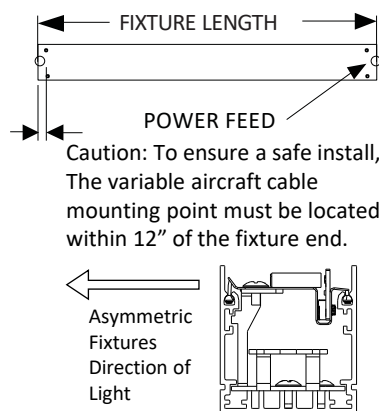
**Mounting & Power Location**

Ensure asymmetric fixtures have LEDs pointing in desired direction.



ATTENTION: Install in accordance with local and national building and electric codes.

Installation Preparation

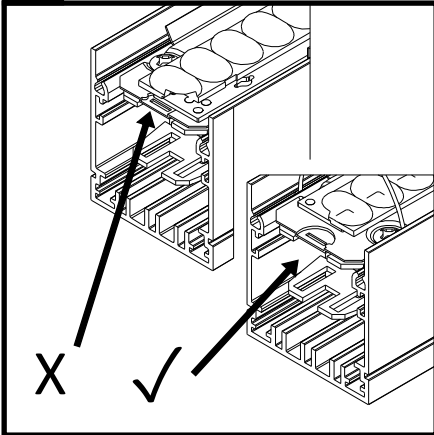
! Power Feed Location

If installing a fixture with one power feed location, ensure electrical knockout orientation matches required power feed location.

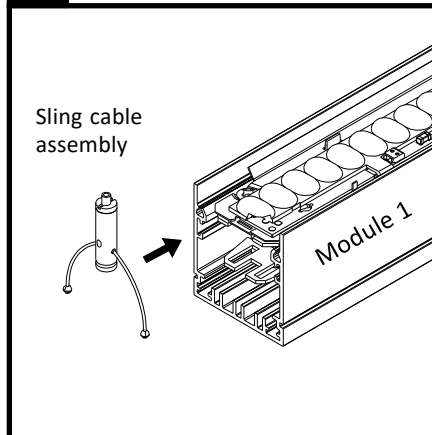
1 Sling Mount Installation

With module 1 on the ground, slide sling cable assembly into top fixture screw chase on both ends of the fixture.

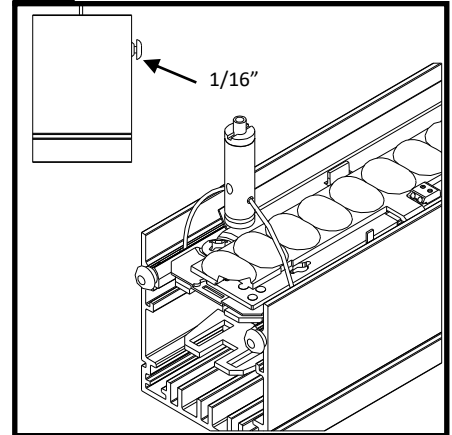
2 Fixture Preparation

Attach two push pins to screw chases to secure sling cable assembly inside fixture during installation process. Gently tap each push pin into the housing leaving a 1/16" gap for easier removal later.

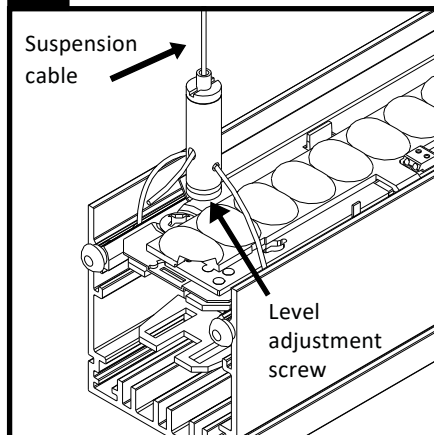
3 Fixture Installation

Raise fixture to installed level and insert suspension cable inside sling cable assembly. Ensure end of aircraft cable exits from sling cable assembly as shown.

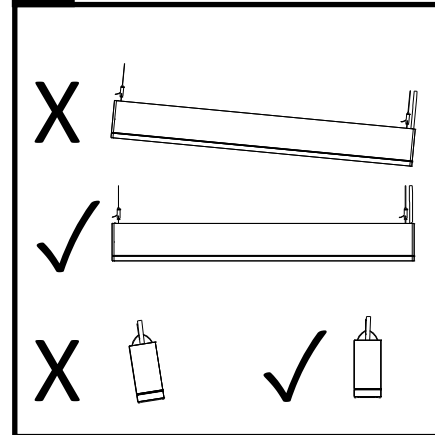
4 Fixture Levelling

Ensure module 1 is installed level. Do not install at an angle.

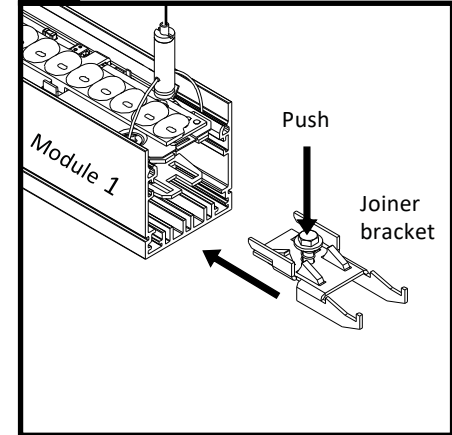
5 Fixture Joining - Preparation

Slide joiner bracket into fixture bracket until it locks in position. Push down hex bolt and spring on joiner bracket to engage with internal bracket.

IMPORTANT: LEVELING INSTRUCTIONS

For side to side leveling, loosen adjustment screw at bottom of cable gripper and slide slowly until level. When complete, re-tighten levelling screw by hand.

For vertical leveling, support bottom of fixture, press plunger on top of cable gripper and slowly lift/lower fixture to desired position. Release plunger when complete. Ensure fixture is secure before removing support.

! ATTENTION: Install in accordance with local and national building and electric codes.

Note: Install power cord after joining fixtures. For standalone fixture, **skip to step 12.**

6 Fixture Joining - Preparation

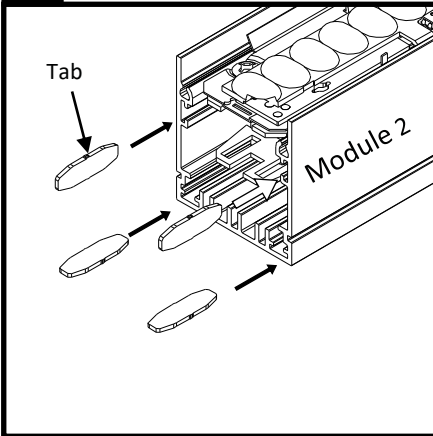

With module 2 on the ground, tap joiner aligners inside top and bottom screw chases as shown. To allow for proper joining, ensure aligner tab in the middle is fully inserted inside module 2 housing, approximately 1/8" past the middle point.

7 Fixture Joining

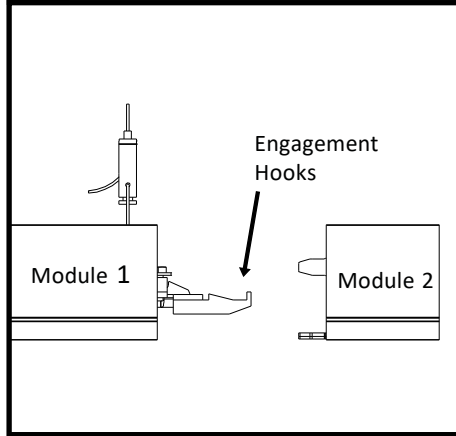

Raise module 2 to installed module 1 position. Install and secure sling cable assembly at opposite end of module 2. Remove push pins from module 1.

8 Fixture Joining

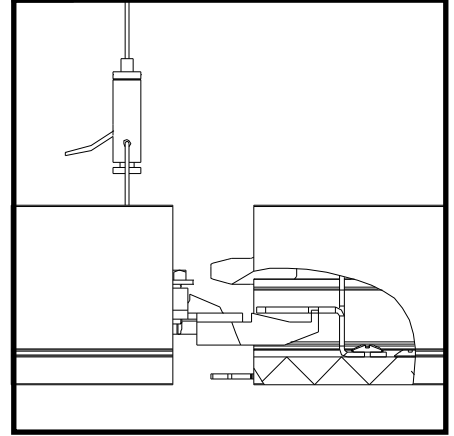

Bring modules together and engage joiner bracket in module 1 on fixture bracket in module 2. Ensure slots on module 2 fixture bracket lock on hooks of module 1 joiner bracket.

Important: Modules must be level relative to each other when joining of sections is required

9 Wiring Connection

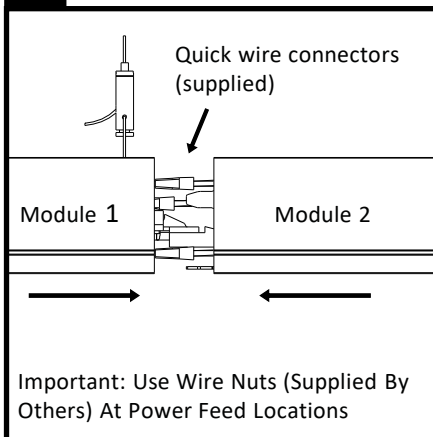

Bring modules close together, support module 2, complete wiring connections and tuck wires inside fixture wiring cavity.

IMPORTANT: WIRING INSTRUCTIONS

Quick wire connectors (supplied) are used for through wiring connections between fixtures. Wire nuts (by others) are used for connection of power drops wiring to fixture wiring.

10 Fixture Joining

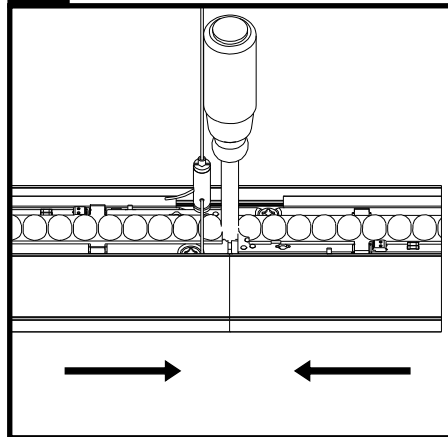

Ensure all connections are secure and all wires are fully tucked inside fixture wiring cavity. Slide fixture modules together gently. Insert 5/16" nut driver through 1/2" hole in top of reflector and tighten screw. Check that joint seam is tight.

NOTE: For fixtures with one power feed location, remove light engine pan before tightening joint.

11 Install Plug

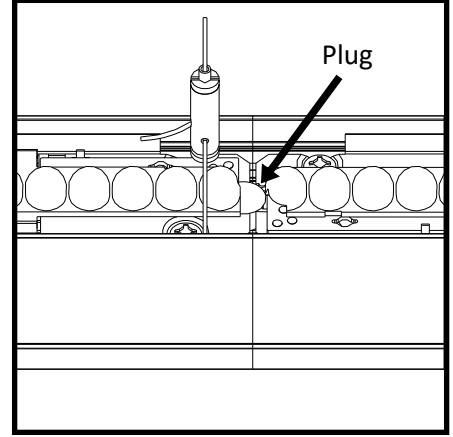

After joint is tightened, if there is no power connection at the joint, insert 1/2" plug provided to seal top reflector. Level fixtures.



FIXT = FIXTURE MODULE

! ATTENTION: Install in accordance with local and national building and electric codes.

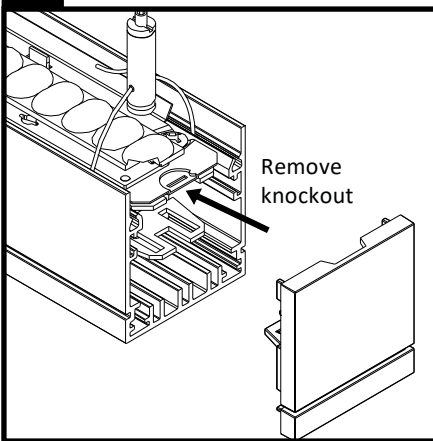
12 Endcap Installation

Push in and break off 1/2" knockout in top reflector. Remove push pins.

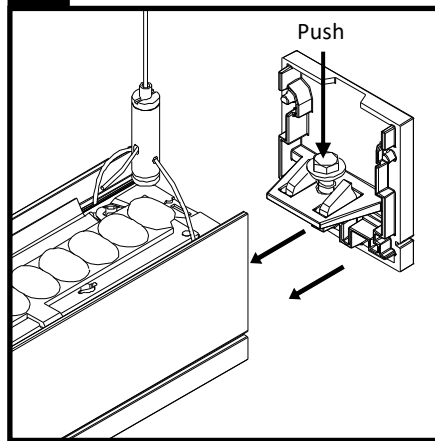
13 Endcap Installation

Slide endcap towards fixture bracket until it engages and clicks in place. Push down on bolt to help engage if needed.

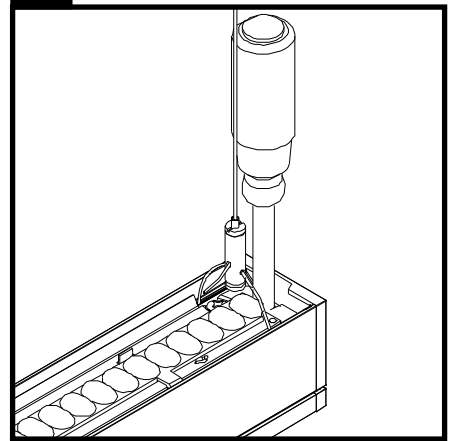
14 Endcap Installation

Insert 5/16" nut driver through 1/2" hole in top reflector and tighten screw until endcap seam is tight. **NOTE: Do not overtighten.** For a non power location, after the endcap is tightened, install 1/2" plug provided to seal top reflector. Trim plug as shown against endcap.

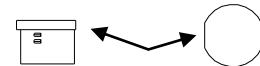

Trim 1/2" plug

Power Cord Installation

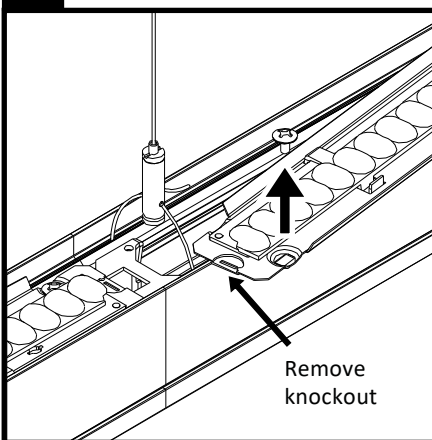
15 Power Feed at Joint

Determine power feed location. Remove screws from light pan and rotate. Open 1/2" electrical knockout at required end.

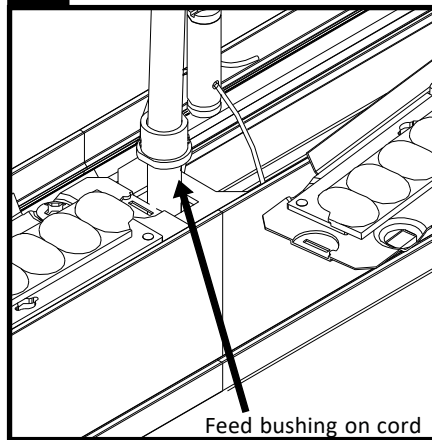
16 Power Cord

Install 1/2" bushing on power cord, pointing out of fixture as shown. Feed power cord through joiner bracket and make wiring connections inside of the fixture.

Installation tip: Do not unsheathe power cord until after feeding through the bracket.

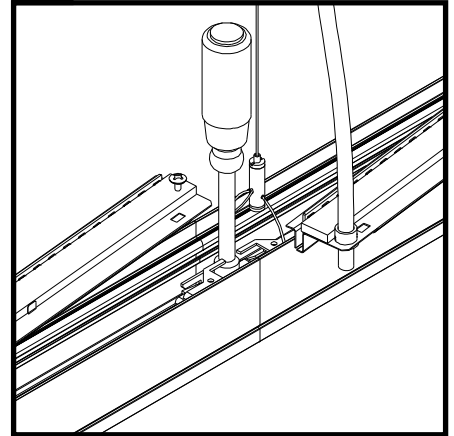
17 Asymmetric Fixtures

For asymmetric fixtures, remove both pans to fully tighten joint. At a joint, slide sling cable assembly onto the module opposite power cord. Feed power cord through pan. At endcap, feed power cord through pan and underneath the sling cable assembly.

Installation tip: Do not unsheathe power cord until after feeding through the bracket.

! **ATTENTION: Install in accordance with local and national building and electric codes.**

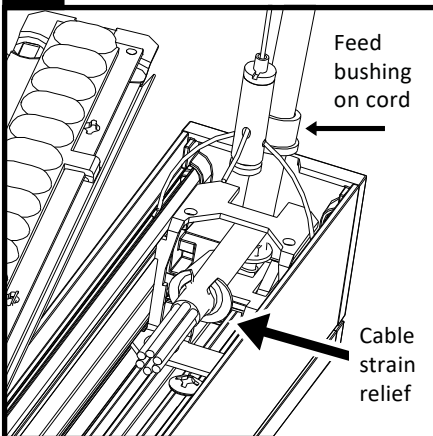
18 Crimp Strain Relief

At endcap, install bushing on power cord, pointing outward. Feed power cord through bracket. Make wiring connections. For all joints and endcaps, install and crimp provided cable metal strain relief bushing to secure power cord below fixture bracket. Use the Heyco PN0019(R12) crimping tool to ensure proper installation. Replace light engine(s).

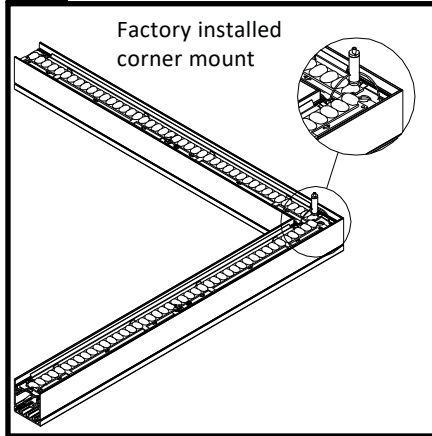
19 Corner installation

If a corner is required, it is recommended the corner module be installed first. All corners come with a factory installed cable sling assembly in the middle.

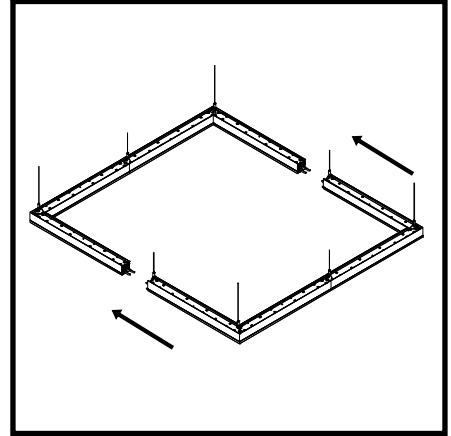
20 Closed Pattern Installation

If installing a square or rectangular closed pattern, it is recommended to install opposite U-shaped fixture/corner patterns first and complete the installation by bringing U-shaped sections together as shown.

21 Finishing

- Ensure all fixtures and corners are level and in line with each other. Fixtures must be installed horizontally levelled. Fixtures must not be installed at an angle.
- Trim excess vertical aircraft cable installed in step 3.
- If horizontal leveling is required, loosen adjustment screw shown in step 3, level fixture and re-tighten screw.
- Check that all joint and endcap screws are installed and tightened. Check that all seams are tight.
- Use spare 1/2" plug(s) provided to close any open 1/2" electrical knockout location(s) in top reflector.

! ATTENTION: Install in accordance with local and national building and electric codes.



© 2021 Signify Holding. All rights reserved. The information provided herein is subject to change, without notice. Signify does not give any representation or warranty as to the accuracy or completeness of the information included herein and shall not be liable for any action in reliance thereon. The information presented in this document is not intended as any commercial offer and does not form part of any quotation or contract, unless otherwise agreed by Signify.

Signify North America Corporation
400 Crossing Blvd, Suite 600
Bridgewater, NJ 08807
Telephone: 855-486-2216

Signify Canada Ltd.
281 Hillmount Road,
Markham, ON, Canada L6C 2S3
Telephone: 800-668-9008

All trademarks are owned by Signify Holding or their respective owners.