



by Signify

# Linear Suspended

TruGroove

Shapes



## System Overview

These instructions cover the installation of TruGroove suspended shapes. Refer to graphics below for available configurations and important mounting dimensions. Each suspended shape requires 4 mounting points. Refer to applicable ceiling mount installation instructions and follow in conjunction with these instructions.



2'X2' Cross



1'X1' Square



1'X4' Rectangle



4'X4' Cross



2'X2' Square



2'X4' Rectangle

Configuration	Mounting Length	Mounting Width
2'X2' cross	24.00" (610mm)	24.00" (610mm)
4'X4' cross	48.00" (610mm)	48.00" (610mm)
1'X1' square	12.25" (311mm)	12.25" (311mm)
2'X2' square	24.00" (610mm)	24.00" (610mm)
1'X4' rectangle	48.00" (610mm)	12.25" (311mm)
2'X4' rectangle	48.00" (610mm)	24.00" (610mm)

**TOOLS REQUIRED:** Phillips screwdriver, #2 square drive screwdriver (optional), cable cutters, pliers.

### 1 CEILING MOUNT INSTALLATION

Follow supplied ceiling mount installation instructions.

Refer to applicable ceiling mounting instructions. Follow instructions and required mounting dimensions provided in this document for required TruGroove shape configuration. Install ceiling mounts, suspension cables and power cord as shown in ceiling mounting instructions.

### 2 HOUSING INSTALLATION

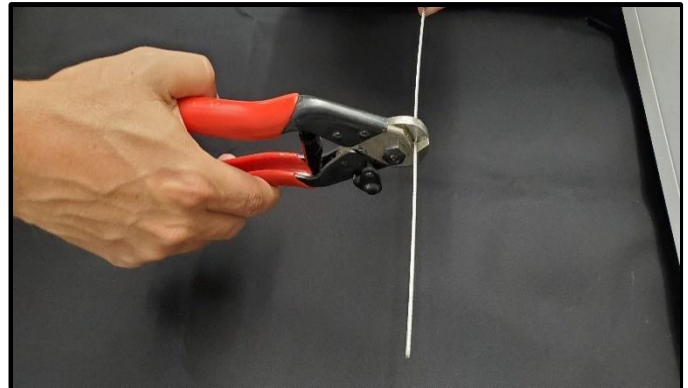

Determine required fixture installation height above finished floor. For easier housing installation, **trim suspension cables flush** with bottom of housing. **IMPORTANT:** Use appropriate cable cutters and make sure cable ends are clean and burr free before installing housing. (Recommended cutters: K.K. Porter cable cutter cat. No. 0690TN or Klein all purpose shears cat. No. 1104)

### 3 HOUSING INSTALLATION

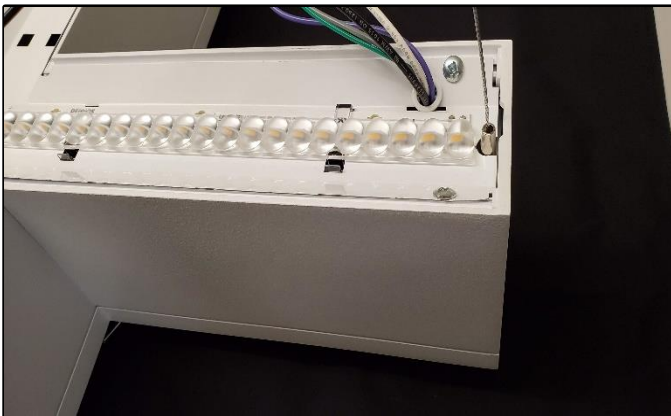

Insert suspension cable into cable gripper inside housing. **IMPORTANT:** Ensure cable is fully inserted and secured inside gripper. Repeat process at other 3 locations to fully suspend housing.

### 4 HOUSING INSTALLATION

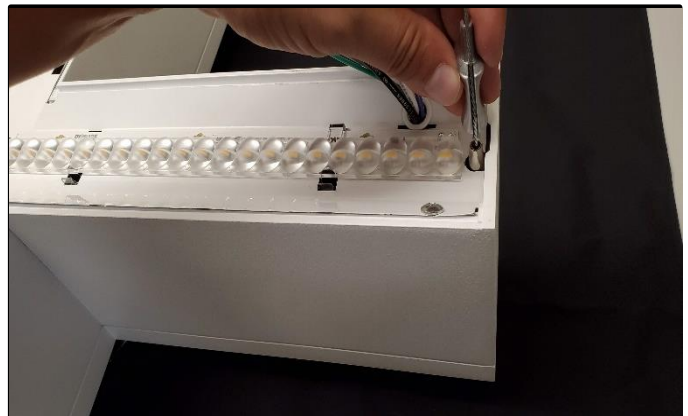

To make small leveling adjustments, support bottom of housing at mount location, slide supplied release key onto cable as shown and gently push down to release gripper. **IMPORTANT:** Support bottom of housing throughout leveling process detailed in this step. Once adjustment is made, remove release key. Repeat process as required to completely level housing.

### 5 POWER CORD INSTALLATION

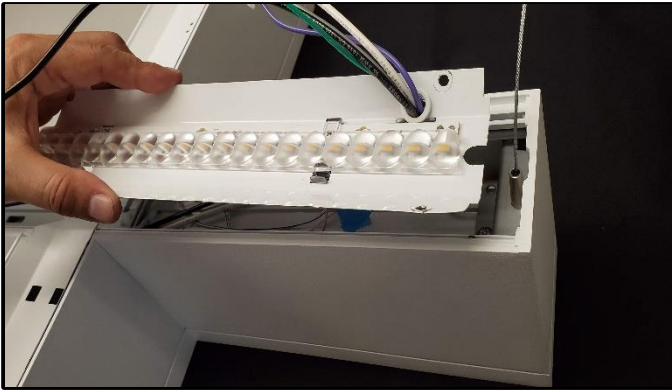

Remove LED pan (or cover for down light only versions) at required power location. Save screws for re-installation later.

### 6 POWER CORD INSTALLATION

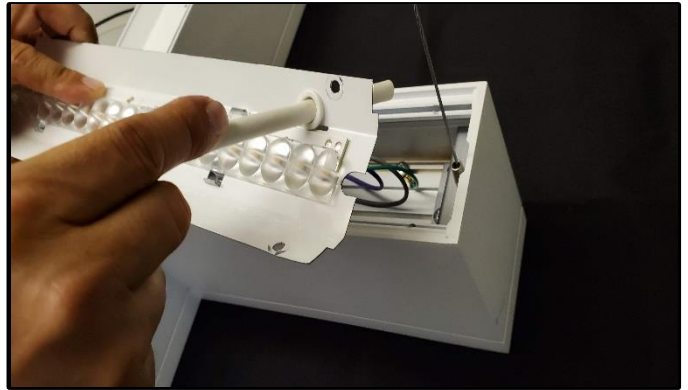

Pull out factory installed wires through hole in LED pan (or cover for down light only versions). Feed supplied power cord through hole in LED pan (or cover for down light only versions).

### 7 POWER CORD INSTALLATION

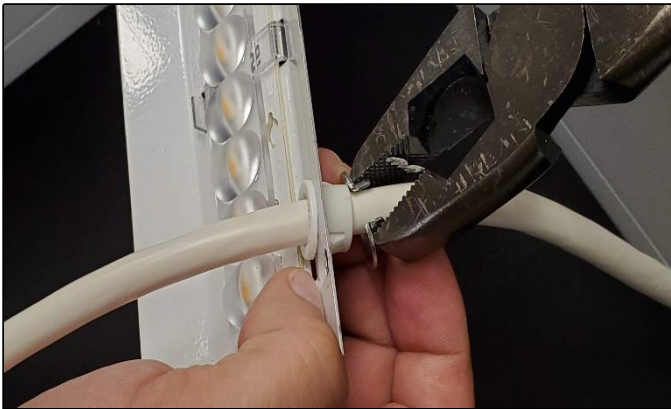

Install supplied strain relief as shown using pliers.

### 8 POWER CORD INSTALLATION

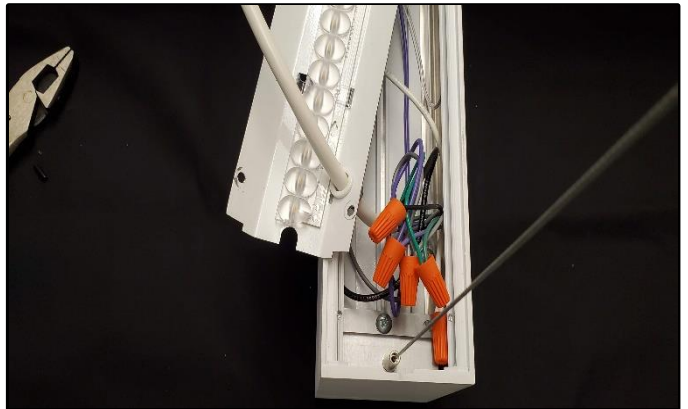

Cut excess power cord, strip ends and make power connections inside housing using wire nuts (supplied by others).

### 9 POWER CORD INSTALLATION

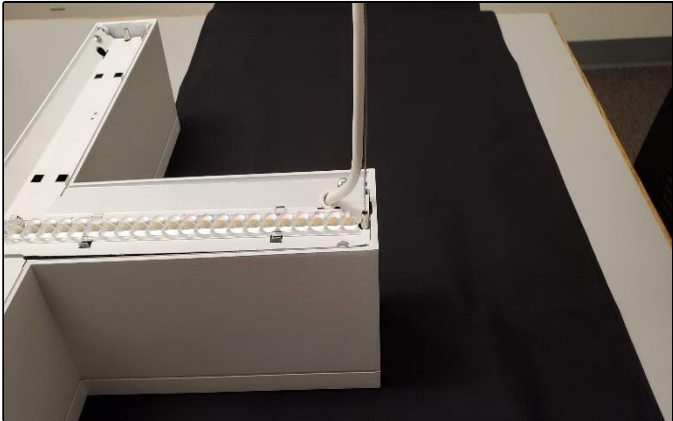

Re-install LED pan (or cover for down light versions only) and screws removed in step 5.

### 10 FINISHING

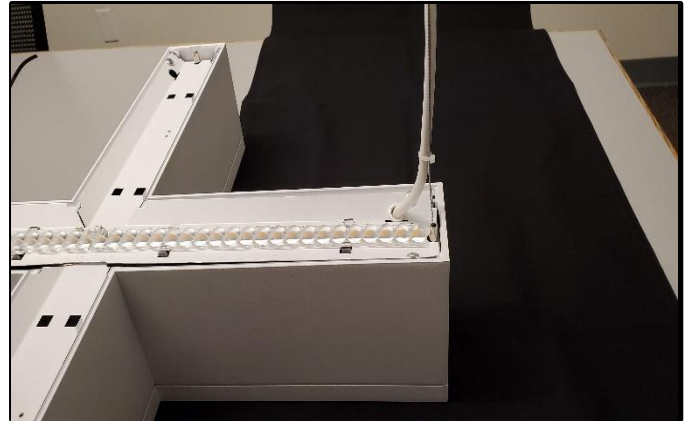

Optional: Use cable ties to secure power cord to aircraft cable as required.

