



by  Signify

# ID-M1 Cable Mount

## Installation Instruction

### Support Connection at Ceiling

**IMPORTANT:** Read all instructions including fixture/sensor wiring AND mechanical details **before** beginning installation.



### M1 - 0°-15° Slope Mount – Non-accessible ceiling

#### What is Included in this package:

M1-P0 - M1 Cable Mounting Installation without Power

M1-P1 - M1 Cable Mounting Installation with Power

#### M1 –P0

- CROSSBAR STRAP W/ STUD (x1)
- FORMED CANOPY CP0 (x1)
- ¼-20 THREADED COLLAR (x2)
- SCREW 6-B X 32 (X1)
- A/C WIRE GRIPPER (x1)

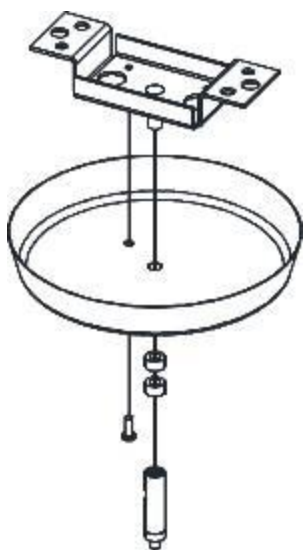

#### M1 –P1

- CROSSBAR STRAP W/ STUD (x1)
- FORMED CANOPY CP1 (x1)
- ¼-20 THREADED COLLAR (x2)
- SCREW 6-B X 32 (X1)
- A/C WIRE GRIPPER (x1)
- HEYCO BUSHING SNAP (x2)
- HEYCO BUSHING STRAIN (x2)

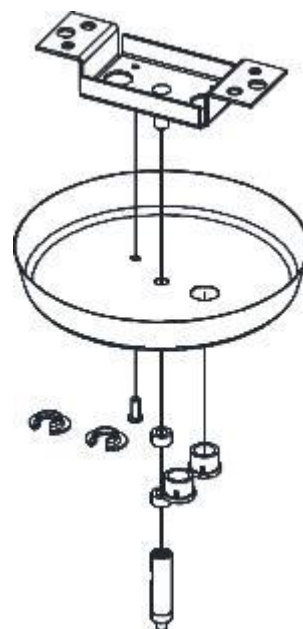

**PLEASE RETAIN PACKAGE FOR FUTURE REFERENCE**

*TOOLS REQUIRED: Phillips screwdriver, flat-head screwdriver, cable/wire cutter, pliers*

### 1 Install ceiling mounting components

**ATTENTION:** Install in accordance to national and local electrical codes and building codes.

**ATTENTION:** Refer to associated installation instruction to complete installation (e.g, leveling, joining, powered and non powered mounts.)

### 2 Install crossbar strap with stud to structure for non-power (M1-P0).

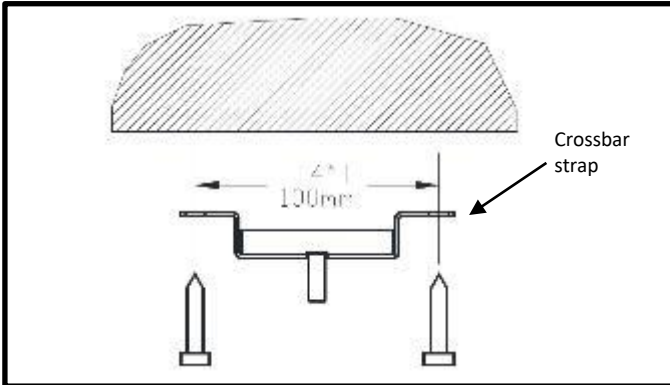

Select appropriate fasteners, which will support a load of 750lbs. each to attach crossbar strap with stud to structure.

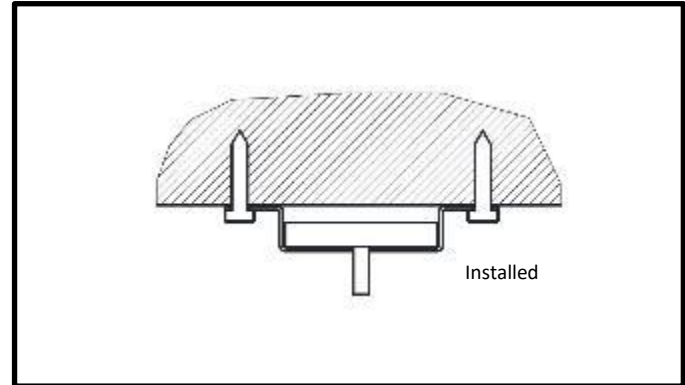

Secure crossbar strap with stud to location specified on application drawings.

### 3 Install canopy to crossbar strap

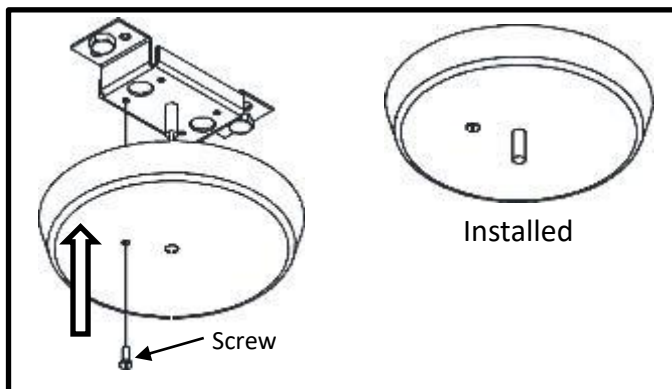

Install canopy to crossbar strap. Guide stud through hole in canopy, align the mounting hole in canopy with crossbar strap. Use a #6 x 3/8 in. screw (provided) to secure canopy to mounting plate.

### 4 Install collar(s) and gripper

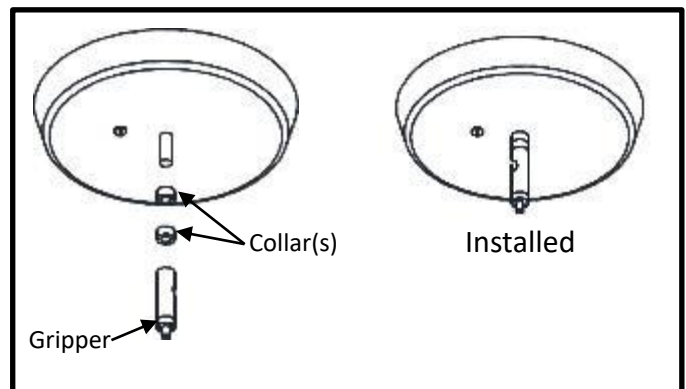

Install provided collar(s) and gripper onto threaded stud.

### 5 Install aircraft cable into gripper

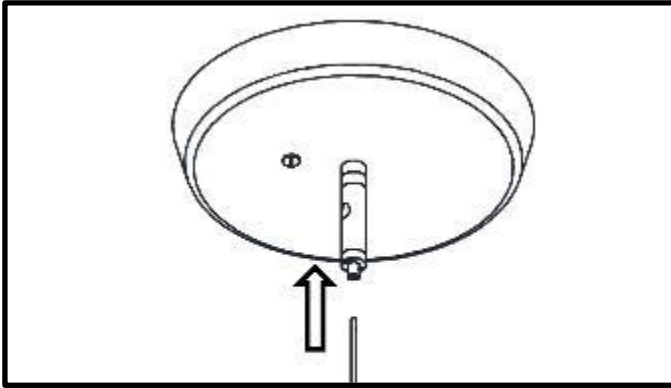

Insert crimp end of A/C cable into luminaire. Feed free end of A/C cable into gripper.

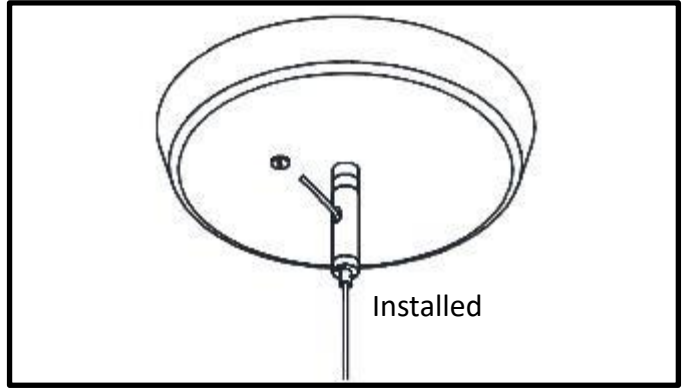

After cables have been secured, carefully lower luminaire until supported by cable. Cut excess cable after the desired height is determined and luminaire is level.

## 1 Install ceiling mounting components

**ATTENTION:** Install in accordance to national and local electrical codes and building codes.

**ATTENTION:** Refer to associated installation instruction to complete installation (e.g, leveling, joining, powered and non powered mounts.)

**ATTENTION:** Signify Ledalite recommends that crossbar straps with studs be mounted to supporting structure to ensure compliance with local electrical code.

## 2 Install power cord in octagonal box or equivalent.

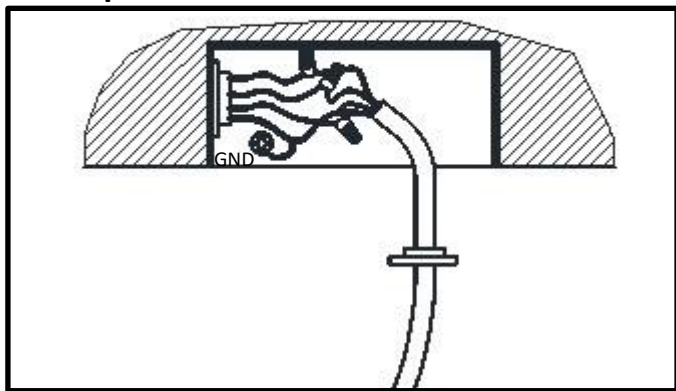

Install an Iberville #54151-K octagonal box or equivalent. Slip strain relief bushing over one end of power cord, approximately one inch and crimp. Make power and ground connection in octagonal box.

## 3 Install crossbar strap with stud to structure for non-power (M1-P1).

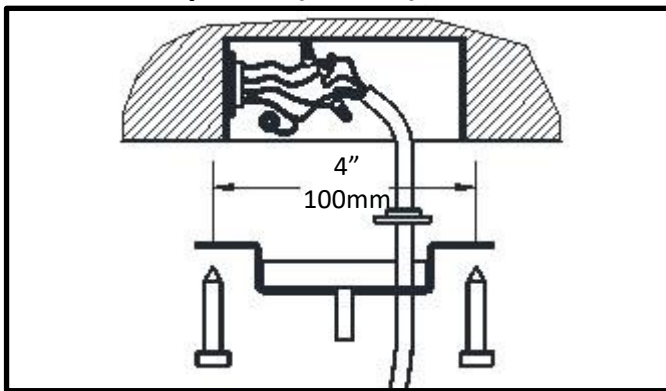

Select appropriate fasteners, which will support a load of 750lbs. each to attach crossbar strap with stud to structure.

Feed power cord through hole in crossbar strap. Secure crossbar strap to location specified on application drawings.

## 4 Install canopy to crossbar strap

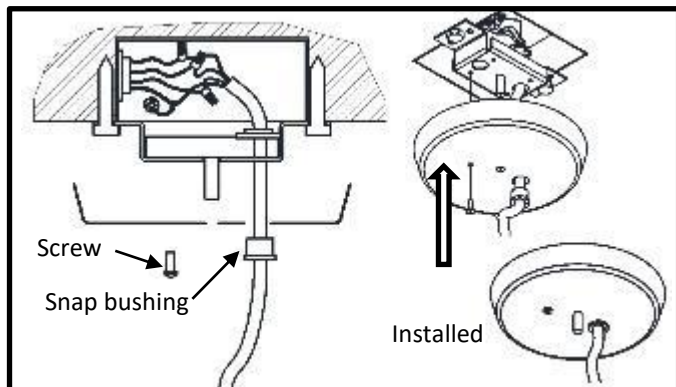

Snap bushing (provided) into canopy power supply hole and feed power cord through. Guide stud through hole in canopy, align the mounting hole in canopy with crossbar strap. Use a #6 x 3/8 in. screw (provided) to secure canopy to mounting plate.

## 5 Install collar(s) and gripper

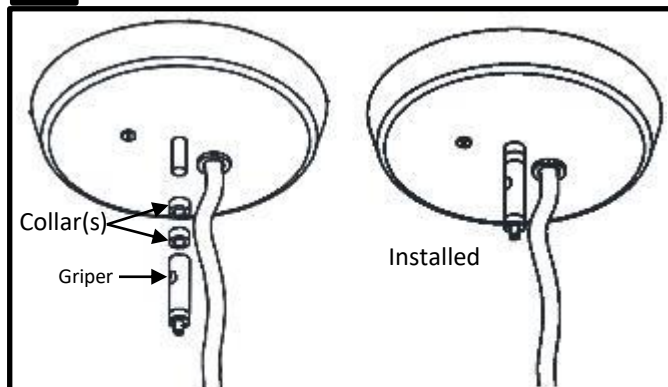

Install provided collar(s) and gripper onto threaded stud.

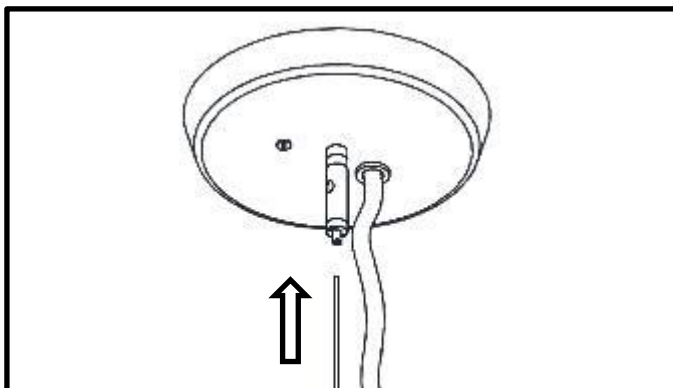
**6** Install A/C cable into gripper

Insert crimp end of A/C cable into luminaire. Feed free end of A/C cable into gripper.

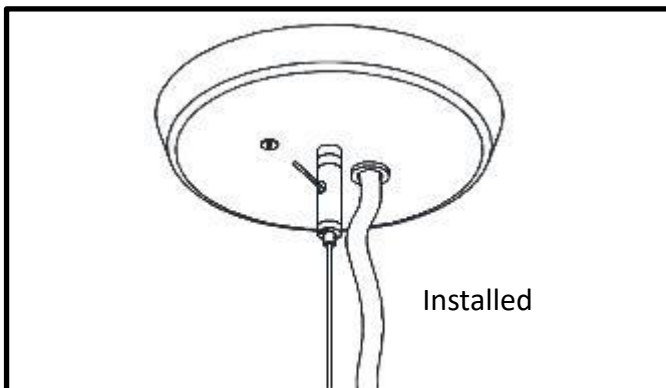

After cables have been secured, carefully lower luminaire until supported by cable. Cut excess cable after the desired height is determined and luminaire is level.

**!** **ATTENTION: Install in accordance with local and national building and electric codes.**





by  Signify

## ID-M2 Cable Mount

### Installation Instruction

#### Support Connection at Ceiling

**IMPORTANT:** Read all instructions including fixture/sensor wiring AND mechanical details **before** beginning installation.



### M2 – Fixed Position Mount – T-grid ceiling

#### What is Included in this package:

M2-P0 – M2 Cable Mounting Installation without Power

M2-P1 – M2 Cable Mounting Installation with Power

#### M2 – P0

- Tie Off Plate (x1)
- ¼-20 HEX MACHINE NUT STL (x3)
- ¼-20 HEX LOCK (DIMPLE) STL (x1)
- SCREW 6-B X 32 (X1)
- A/C WIRE GRIPPER (x1)

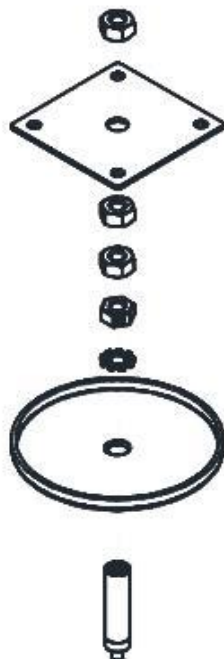

#### M2 – P1

- Tie Off Plate (x1)
- ¼-20 HEX MACHINE NUT STL (x3)
- ¼-20 HEX LOCK (DIMPLE) STL (x1)
- SCREW 6-B X 32 (x1)
- A/C WIRE GRIPPER (x1) HEYCO BUSHING SNAP (x2)
- HEYCO BUSHING STRAIN (x2)
- M2 MOUNTING STRAP (x1)
- M2 MOUNTING STRAP COVER (x1)

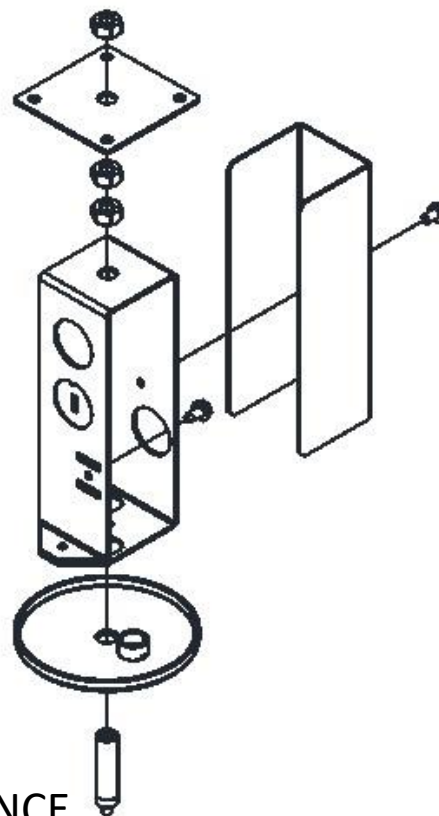

**PLEASE RETAIN PACKAGE FOR FUTURE REFERENCE**

*TOOLS REQUIRED: Phillips screwdriver, Flat-head screwdriver, #2 Robertson screwdriver (optional), Hole saw, A/C wire cutters, Pliers*

### 1 Install ceiling mounting components non-power

**ATTENTION:** Install in accordance to national and local electrical codes and building codes.

**ATTENTION:** Refer to associated installation instruction to complete installation (e.g, leveling, joining, powered and non powered mounts.)

### 2 Install 1/4"-20 threaded rod to structure for non-power (M2-P0).

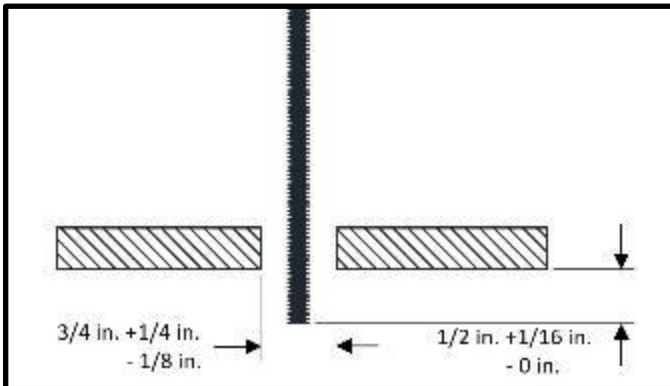

Secure 1/4"-20 threaded rod (supplied by others) to the substructure, directly above specified mount Location. (see layout drawings)

Note: Recommend using a minimum A36 steel 1/4"-20 threaded rod.

**Important:** The free end of the threaded rod must be located at approximately 1/2" below ceiling level. Drill a 3/4" diameter hole in ceiling tile at the specified mount location

**ATTENTION:** The 1/4"-20 ready rod which is attached to the substructure must safely support an axial load of 1500lbs.

### 3 Thread Locknut onto threaded rod

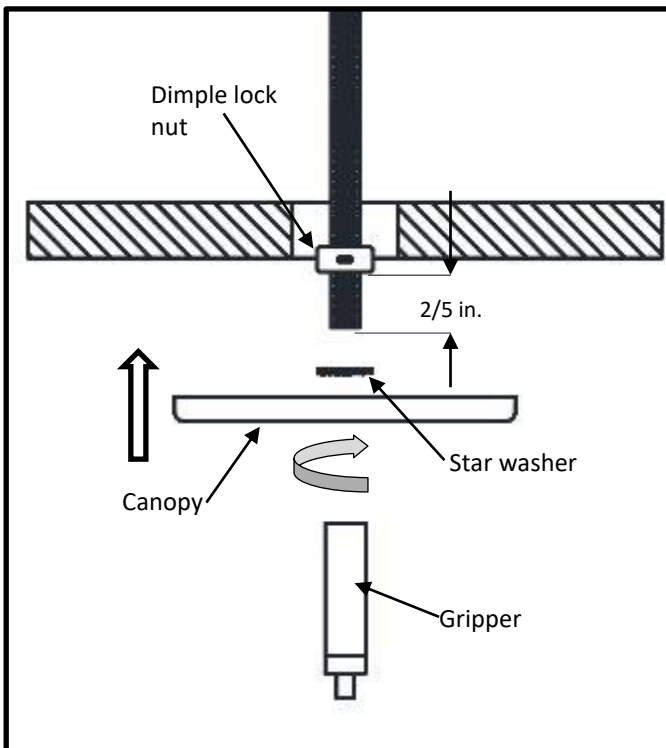

Thread locknut onto threaded rod until bottom of nut is 9/16" above free end of rod.

### 4 Install canopy and gripper

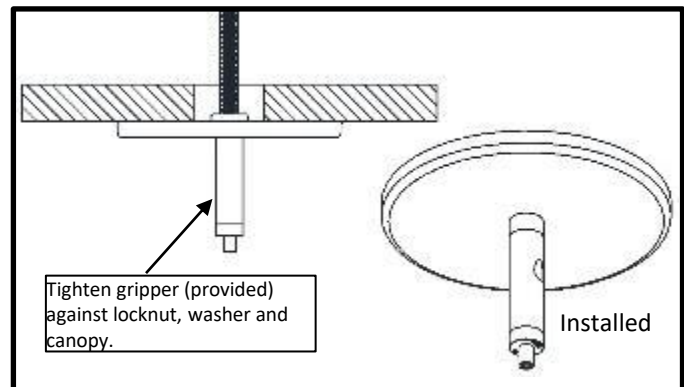

**IMPORTANT:** ENSURE THAT THE 1/4"-20 GRIPPER IS TIGHTENED SECURELY AGAINST THE MOUNTING STRAP AND CANOPY.

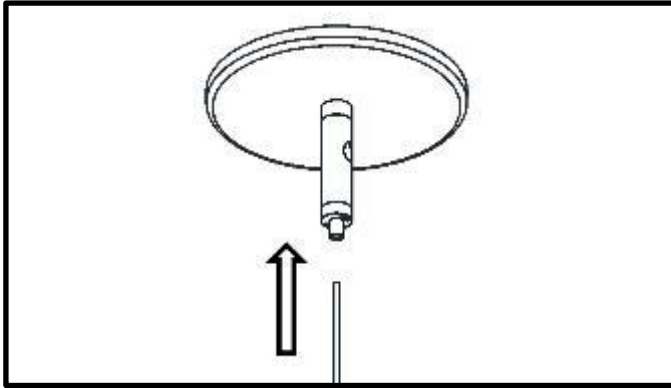
**5** Install A/C cable into gripper

Insert crimp end of A/C cable into luminaire. Feed free end of A/C cable into gripper.

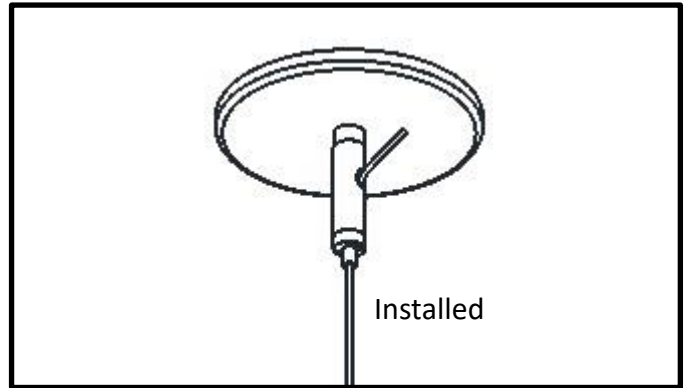

After cables have been secured, carefully lower luminaire until supported by cable. Cut excess cable after the desired height is determined and luminaire is level.



**1 Install ceiling mounting components power**

**ATTENTION:** Install in accordance to national and local electrical codes and building codes.

**ATTENTION:** Refer to associated installation instruction to complete installation (e.g, leveling, joining, powered and non powered mounts.)

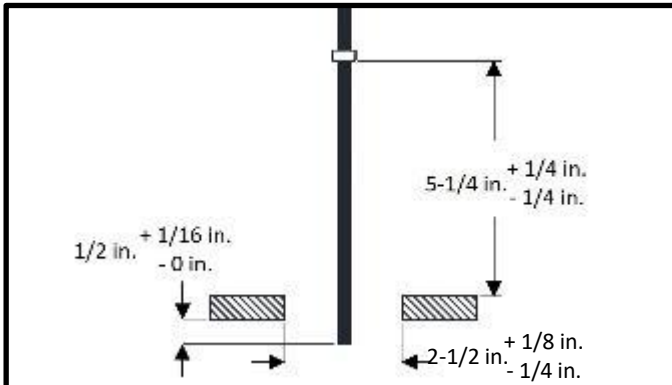
**2 Install 1/4"-20 threaded rod to structure for power (M2-P1).**

Secure 1/4"-20 threaded rod (supplied by others) to the substructure, directly above specified mount location. (see layout drawings)

Note: Recommend using a minimum A36 steel 1/4"-20 threaded rod.

Important: The free end of the threaded rod must be located approximately 1/2" below ceiling level. Drill a 2-1/2" diameter hole in ceiling tile at the specified mount location.

**ATTENTION:** The 1/4"-20 ready rod which is attached to the substructure must safely support an axial load of 1500lbs.

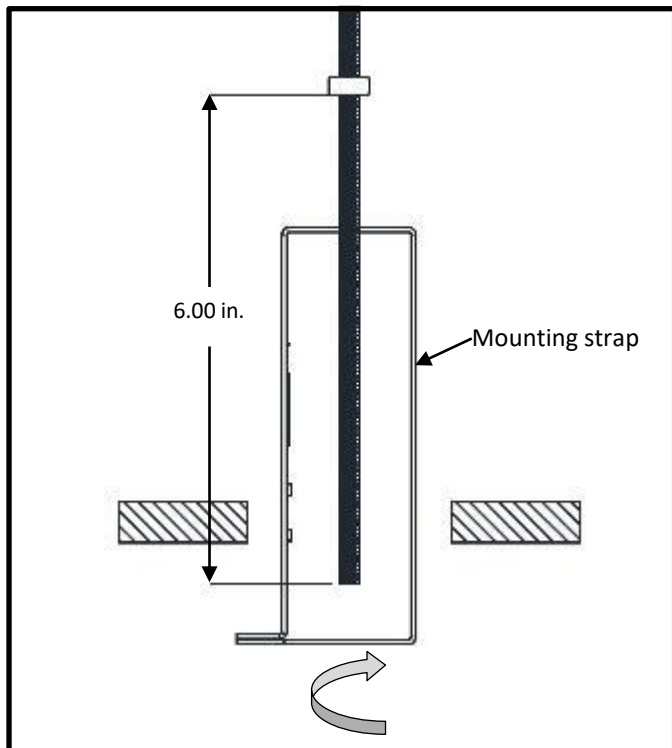
**3 Thread locknut and mounting strap**

Thread one of the 1/4"-20 nuts (provided) onto the threaded rod to at least 6" above the free end of the rod. Spin mounting strap onto threaded rod until tabs contact ceiling tile.

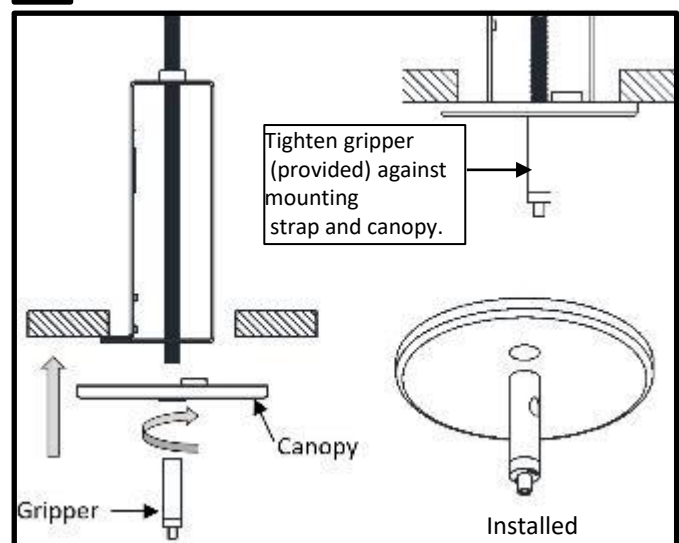
**4 Install canopy and install gripper**

Slide canopy onto 1/4"-20 threaded rod, and begin tightening the gripper against the mounting strap and canopy.

**IMPORTANT: ENSURE THAT THE 1/4"-20 GRIPPER IS TIGHTENED SECURELY AGAINST THE MOUNTING STRAP AND CANOPY.**

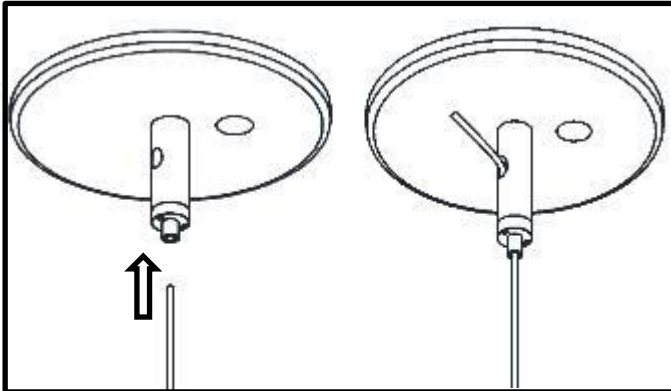
**5 Install A/C cable into gripper**

Insert crimp end of A/C cable into luminaire.  
Feed free end of A/C cable into gripper.

After cables have been secured, carefully lower luminaire until supported by cable. Cut excess cable after the desired height is determined and luminaire is level.

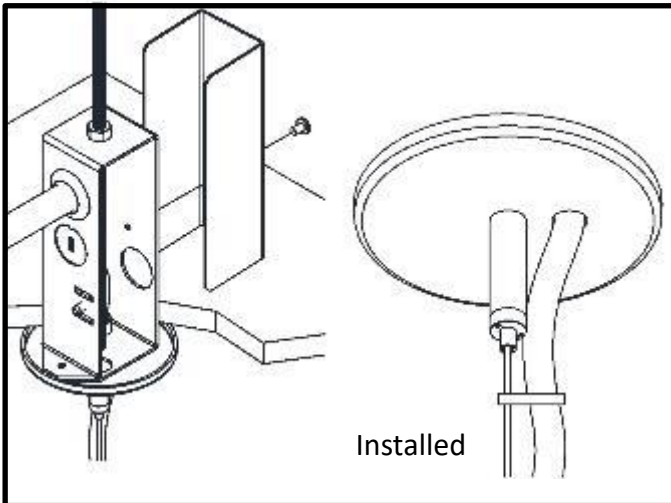
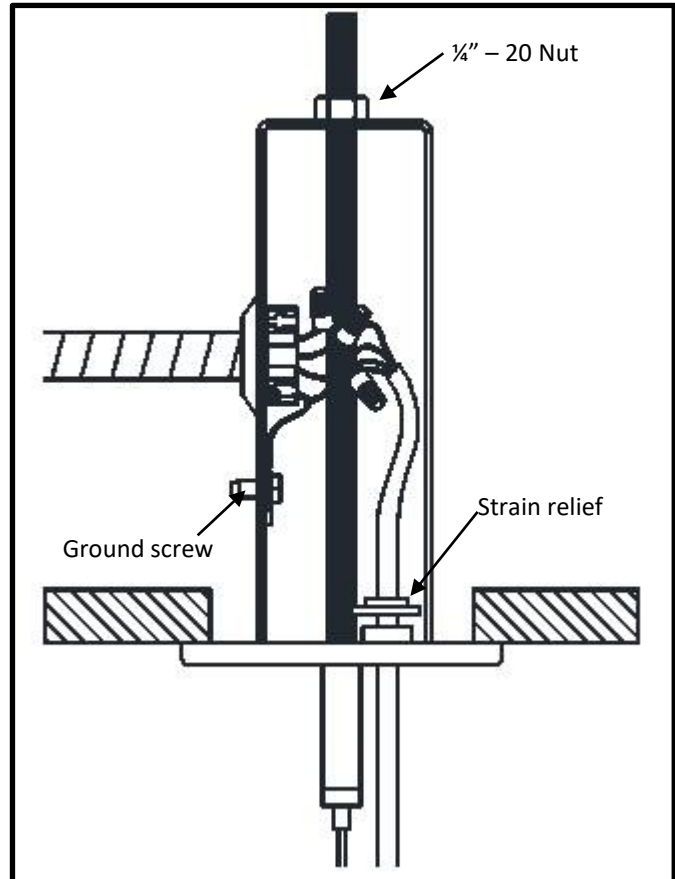
**7 Attach J-box cover****6 Make power connections**

Access the mount from above, through an adjacent tile, and screw mount further on to threaded rod so the canopy is again in contact with ceiling tile after any settling. Lock mount in place by tightening the 1/4"-20 nut down onto the top of the mounting strap.

Connect power cable to ground screw provided. Pass power cord (provided) through canopy power hole and bushing, crimp metal strain relief onto cord above canopy. Make appropriate power connections.

**! ATTENTION: Install in accordance with local and national building and electric codes.**





by  Signify

## ID-M3 Cable Mount

### Installation Instruction

#### Support Connection at Ceiling

**IMPORTANT:** Read all instructions including fixture/sensor wiring AND mechanical details **before** beginning installation.



### M3 - 0°-90° Slope Mount – Non-accessible ceiling

#### What is Included in this package:

M3-P0 – M3 Cable Mounting Installation without Power

M3-P1 – M3 Cable Mounting Installation with Power

#### M3 – P0

- MOUNT BRACKET (x1)
- BOLT BRACKET MOUNT (x1)
- LOCK NUT (x1)
- HEX HEAD SCREW (x1)
- A/C WIRE GRIPPER (x1)
- COLLAR (x2)



#### M3 – P1

- A/C CROSS BAR STRAP(x1)
- CANOPY EXTENSION RING (x1)
- FORMED CANOPY P1 (x1)
- MOUNT BRACKET (x1)
- BOLT BRACKET MOUNT (x1)
- LOCK NUT (x1)
- HEX HEAD SCREW (x1)
- A/C WIRE GRIPPER (x1)
- COLLAR (x2)
- HEYCO BUSHING SNAP (x2)
- HEYCO BUSHING STRAIN (X2)

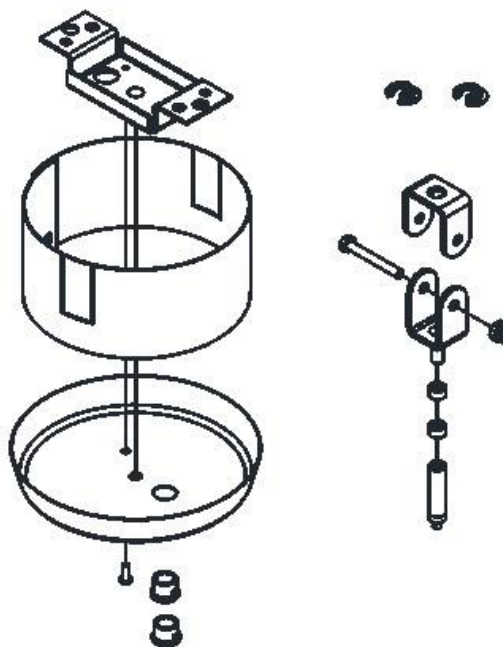

**PLEASE RETAIN PACKAGE FOR FUTURE REFERENCE**

*TOOLS REQUIRED: Phillips screwdriver, Flat-head screwdriver, #2 Robertson screwdriver (optional), A/C wire cutters, Pliers*

**1 Install ceiling mounting components non-power**

**ATTENTION:** Install in accordance to national and local electrical codes and building codes.

**ATTENTION:** Refer to associated installation instruction to complete installation (e.g, leveling, joining, powered and non powered mounts.)

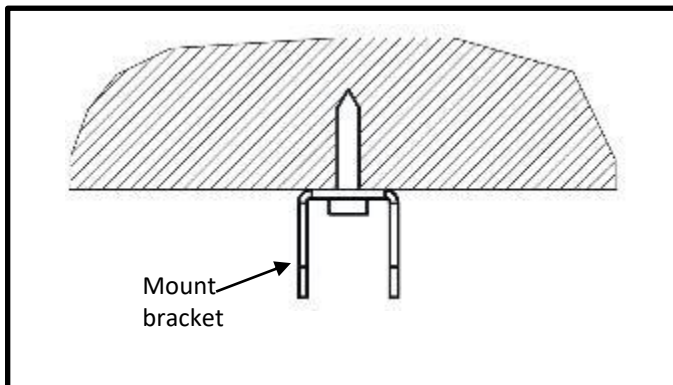
**2 Install Bolt Bracket Mount (M3-P0).**

Select an appropriate fastener which will support a load of 1500lbs. and accommodate a 3/8" diameter hole to attach the bracket to the structure.

Secure bolt bracket to structure at location specified on application drawings.

**ATTENTION:** The fastener which is attached to the structure must safely support a load of 1500lbs.

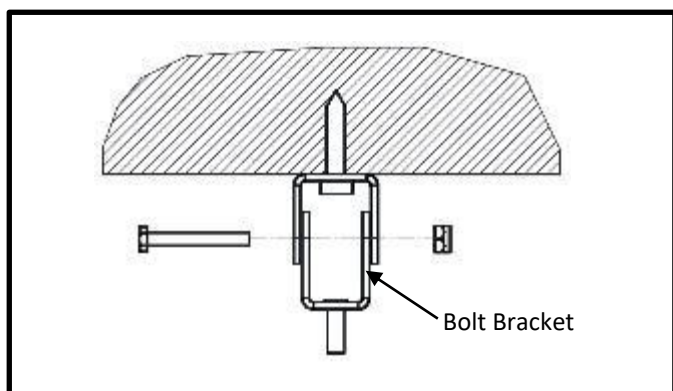
**3 Connect Bracket Mount to Bolt Bracket**

Connect mount bracket to bolt bracket using #10-32 x 1-1/2" bolt and nut supplied with mount.

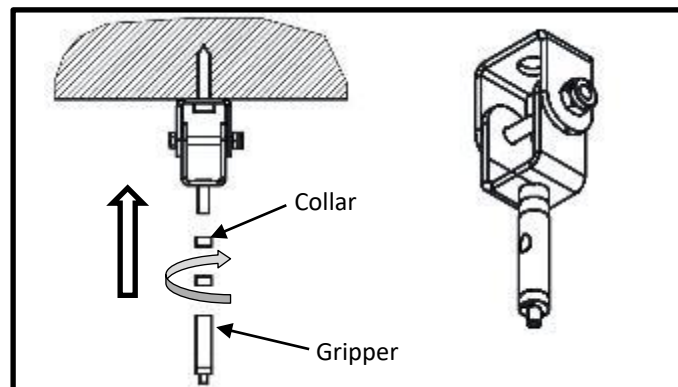
**4 Install collar(s) and gripper**

Thread collars and gripper onto bolt bracket.

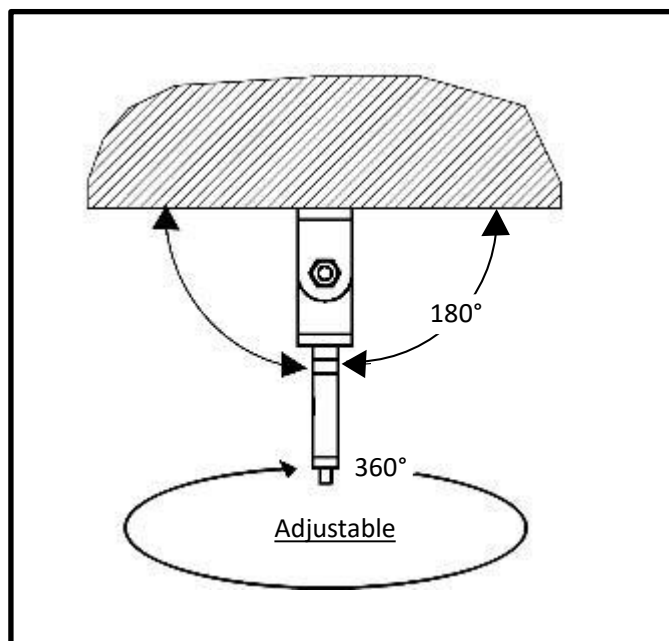
**5 Adjustability**

Adjustable to find ideal position.

### 6 Install A/C cable into gripper

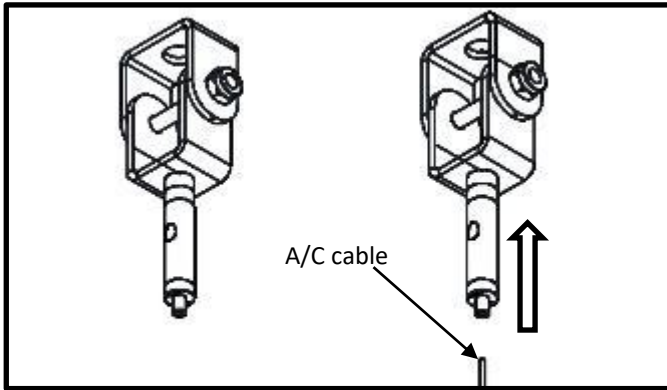

Insert crimp end of A/C cable into luminaire. Feed free end of A/C cable into gripper.

### 7 Install collar(s) and gripper

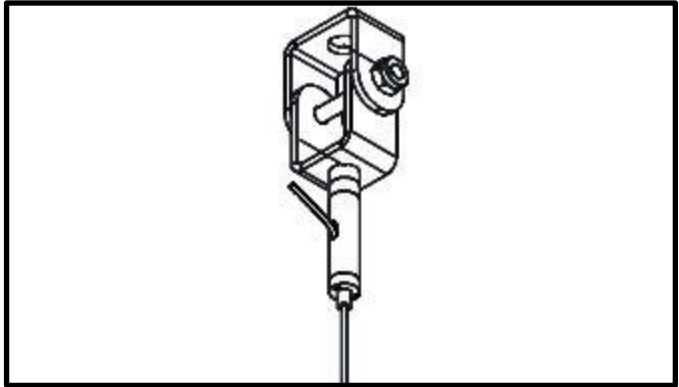

After cables have been secured, carefully lower luminaire until supported by cable. Cut excess cable after the desired height is determined and luminaire is level.

### 1 Install ceiling mounting components power

**ATTENTION:** Install in accordance to national and local electrical codes and building codes.

**ATTENTION:** Refer to associated installation instruction to complete installation (e.g, leveling, joining, powered and non powered mounts.)

### 2 Install octagonal box for power (M3-P1).

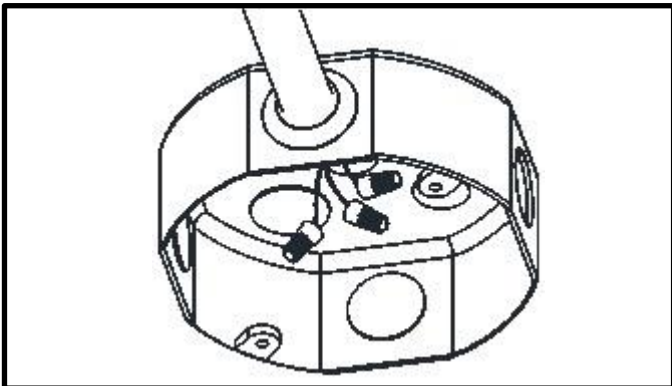

Install an Iberville #54151-K octagonal box or equivalent 1" to 6" from the mounting location.

### 3 Install crossbar strap & power cord

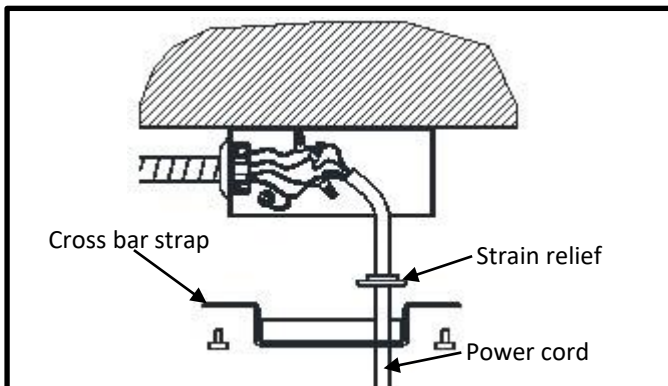

Slip strain relief bushing over power cord approximately 1" from end of jacket and crimp it. Complete power and ground connections in octagonal box.

Feed power cord through hole in cross bar strap and Secure cross bar strap to octagonal box.

### 4 Install extension collar and canopy

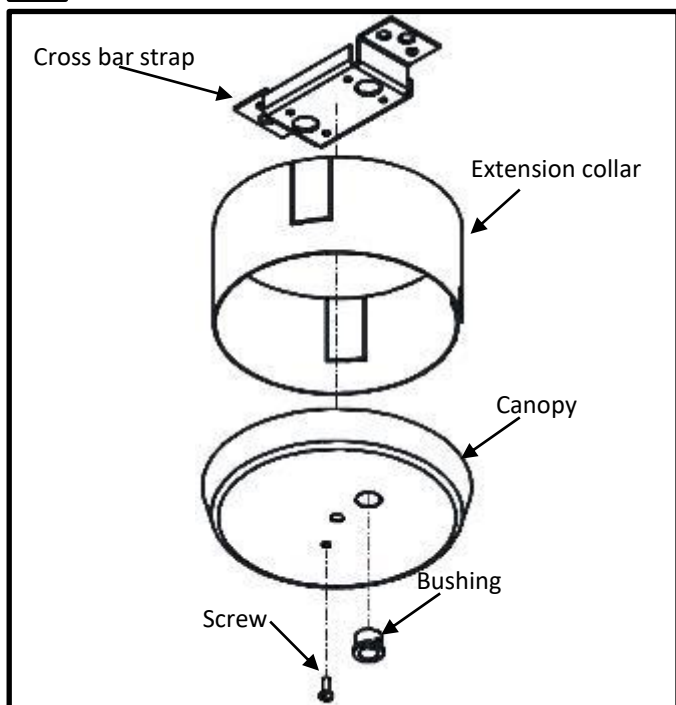

Snap bushing into canopy power hole in canopy. Feed power cord through canopy extension collar then through power hole in canopy.

### 5 Install extension collar and canopy

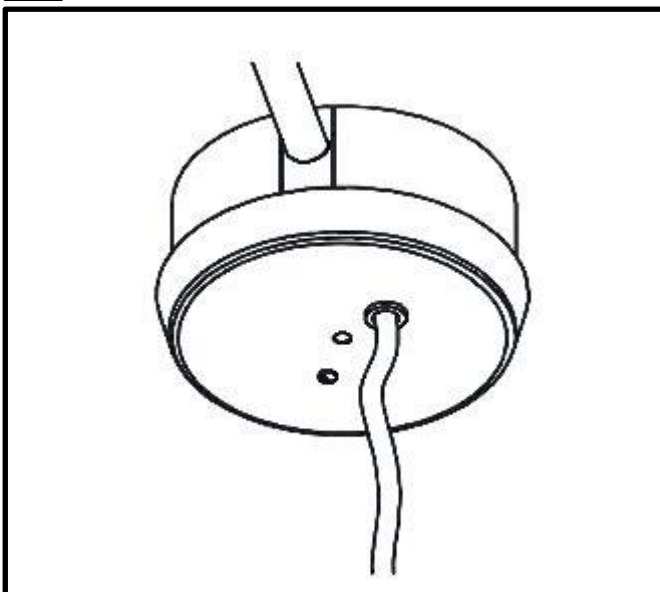

Bring the canopy up to ceiling level, align mounting hole in canopy with that of crossbar strap and use the supplied #6 x 3/8" screw to secure canopy to crossbar strap.



### 6 Install M3 mount to specified location

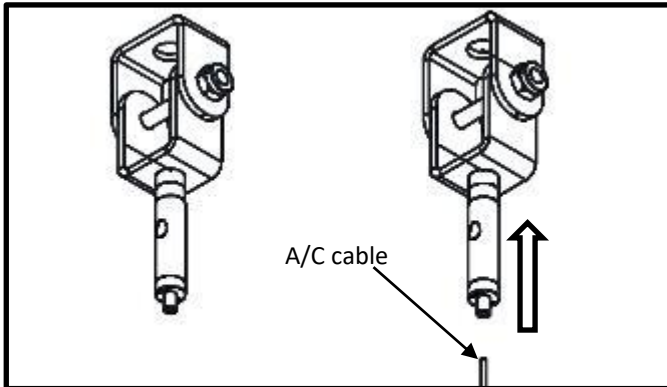

Refer to steps 1 through 5 on M3-P. Secure bolt bracket to structure at location specified on application drawings.  
Insert crimp end of A/C cable into luminaire. Feed free end of A/C cable into gripper.

### 7 Install collar(s) and gripper

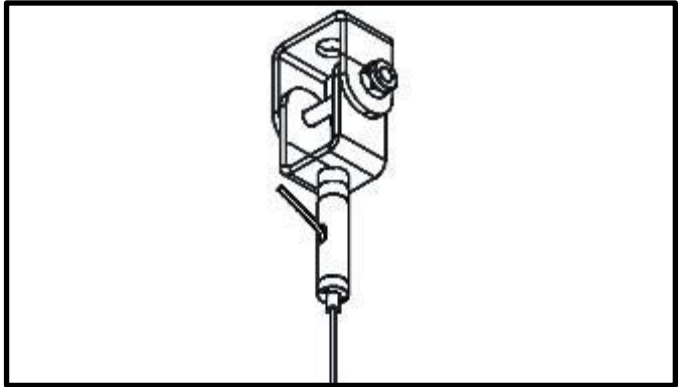

After cables have been secured, carefully lower luminaire until supported by cable. Cut excess cable after the desired height is determined and luminaire is level.

### 8 Installed

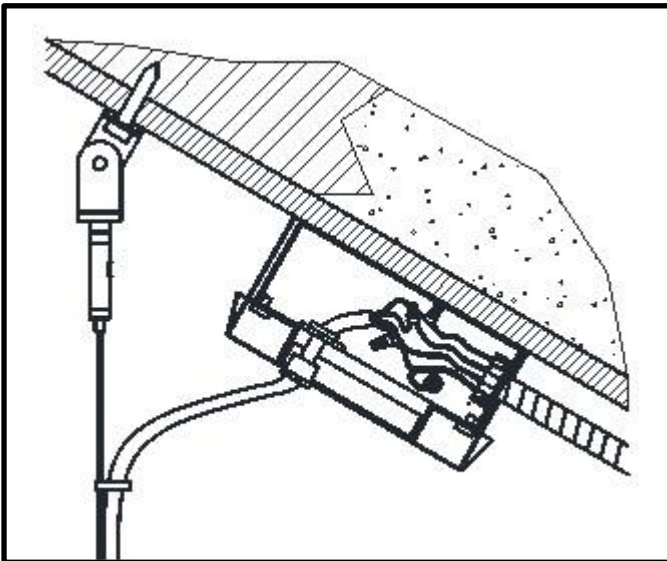

Complete power connections at luminaire. Refer to luminaire installation instructions.

**! ATTENTION: Install in accordance with local and national building and electric codes.**



© 2021 Signify Holding. All rights reserved. The information provided herein is subject to change, without notice. Signify does not give any representation or warranty as to the accuracy or completeness of the information included herein and shall not be liable for any action in reliance thereon. The information presented in this document is not intended as any commercial offer and does not form part of any quotation or contract, unless otherwise agreed by Signify.

Signify North America Corporation  
400 Crossing Blvd, Suite 600  
Bridgewater, NJ 08807  
Telephone: 855-486-2216

Signify Canada Ltd.  
281 Hillmount Road,  
Markham, ON, Canada L6C 2S3  
Telephone: 800-668-9008

All trademarks are owned by Signify Holding or their respective owners.



by Signify

## ID-M5 Cable Mount

### Installation Instruction

#### Support Connection at Ceiling

**IMPORTANT:** Read all instructions including fixture/sensor wiring AND mechanical details **before** beginning installation.



#### M5 – 24" T-grid Span Mount – T-grid ceiling

##### What is Included in this package:

M5-P0 – M5 Cable Mounting Installation without Power

M5-P1 – M5 Cable Mounting Installation with Power

#### M5 – P0

- M5 SUPPORT PLATE (x1)
- M5 LOCATION CHANNEL (x1)
- M5 MOUNTING STRAP S/A (x1)
- A/C WIRE GRIPPER (x1)
- COLLAR (x1)
- COLLAR (x1)
- HEX NUT (x1)
- SCREW (x2)
- MOLDED CANOPY (x1)

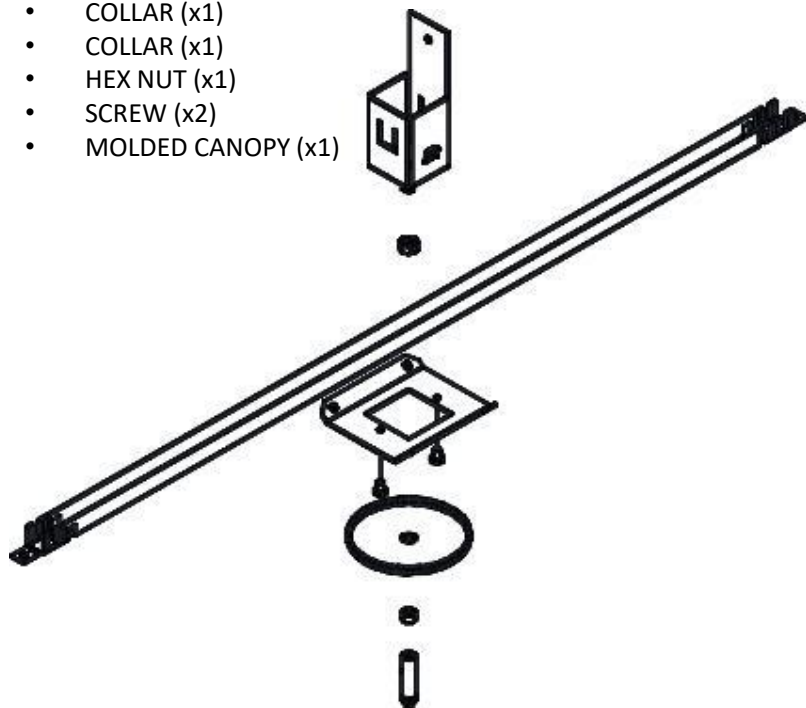

#### M5 – P1

- M5 SUPPORT PLATE (x1)
- M5 LOCATION CHANNEL (x1)
- M5 MOUNTING STRAP S/A (x1)
- A/C WIRE GRIPPER (x1)
- COLLAR (x1)
- COLLAR (x1)
- HEX NUT (x1)
- SCREW (x2)
- MOLDED CANOPY (x1)
- HEYCO BUSHING SNAP (x2)
- HEYCO BUSHING STRAIN (X2)

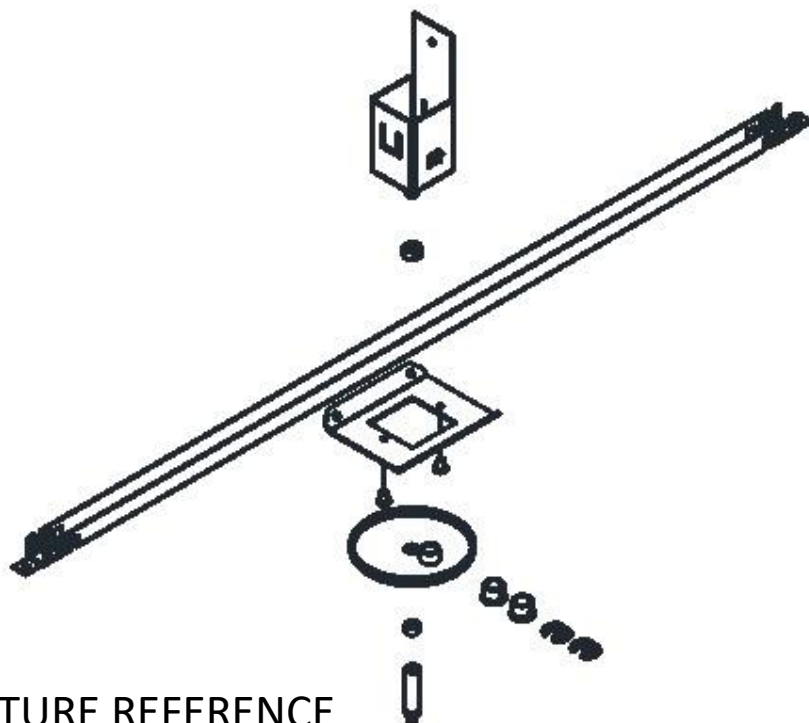

**PLEASE RETAIN PACKAGE FOR FUTURE REFERENCE**

*TOOLS REQUIRED: Phillips screwdriver, Flat-head screwdriver, #2 Robertson screwdriver (optional), A/C wire cutters, Pliers*



**1, 2** Install ceiling mounting components non-power

**ATTENTION:** Install in accordance to national and local electrical codes and building codes.

**ATTENTION:** Refer to associated installation instruction to complete installation (e.g, leveling, joining, powered and non powered mounts.)

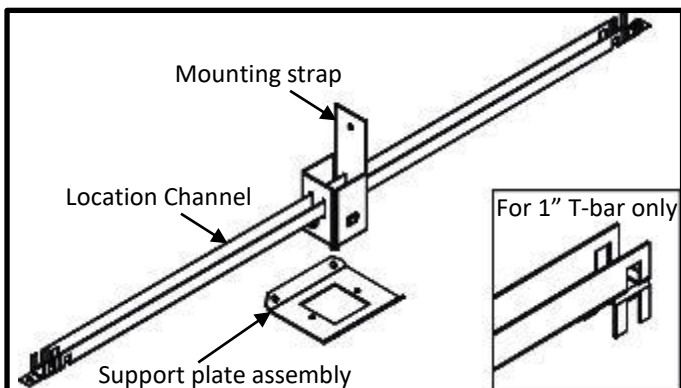
**3, 4** Prepare mounting strap

1. Attach four 12 gauge steel guy wires (by others) to substructure above. Guy wires should be angled at approximately 45° or less off the horizontal. Do not tie off loose ends until step 2.

2. Drill a 2-1/4 inch diameter hole in ceiling tile at desired mount location using a hole saw. Ensure center of hole is minimum 2 inches away from edge of T-bar.

Note: This mounting system is designed to work with 1 inch and/or 1-1/2 inch T-bar systems. Determine specific application and follow appropriate instructions in step 3.

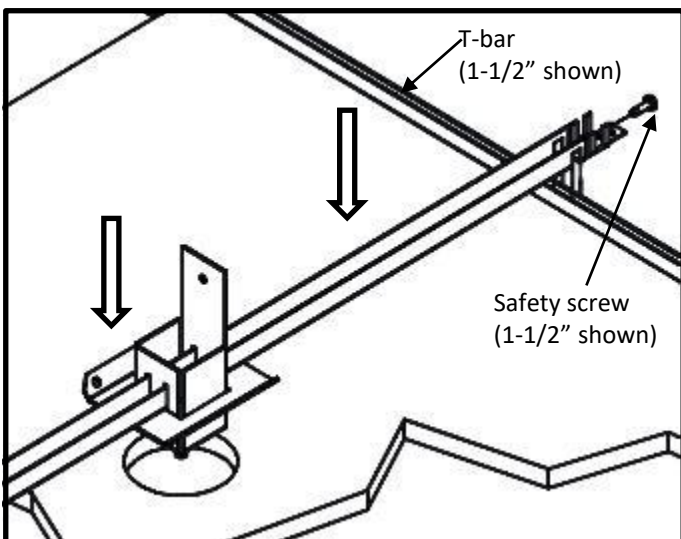
**5, 6** Install mounting strap

3. For 1 inch T-bar slide location channel through mounting strap, and fold tabs of location channel as shown.

3. For 1-1/2 inch T-bar slide location channel through mounting strap, and use location channel as shipped.

4. Snap support plate assembly past mounting strap tabs to bottom of location channel.

5. Through an adjacent tile, place mounting assembly over 2-1/4 inch diameter hole and adjust mounting strap to desired position. Once strap is aligned with mounting location, snap assembly to T-bar.

6. To secure location channel, screw a self-tapping metal screw (supplied by others) into T-bar at each end.

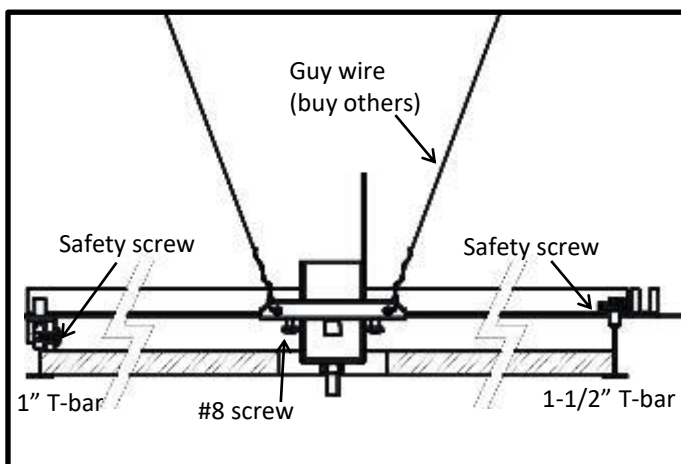
**7, 8** Install safety screws & guy wires

**Important:** Location channel is designed to locate mounting point, NOT to support fixture.

7. From below installed mount, tighten the two #8 sheet metal screws, to bind location channel, mounting strap And support plate together.

8. **IMPORTANT:** Attach guy wires installed in the first step to support plate by threading free ends through corner holes and tightly wrapping wires around themselves a minimum of four turns.

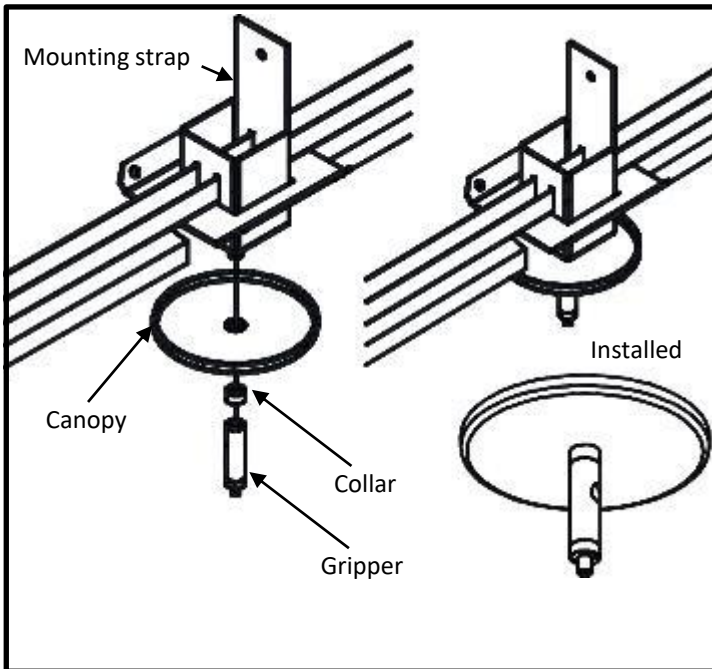
**9 Attach canopy, collar, and gripper**

**9.** Secure canopy to mounting strap by threading the collar onto the mounting strap  $\frac{1}{4}$ -20" stud.

**Important: Fully tighten the  $\frac{1}{4}$ -20" gripper against mounting strap hex nut.**

**10.** Insert crimp end of A/C cable into luminaire. Feed free end of A/C cable into gripper.

After cables have been secured, carefully lower luminaire until supported by cable. Cut excess cable after the desired height is determined and luminaire is level.

If applicable, make appropriate power connections at fixture level.

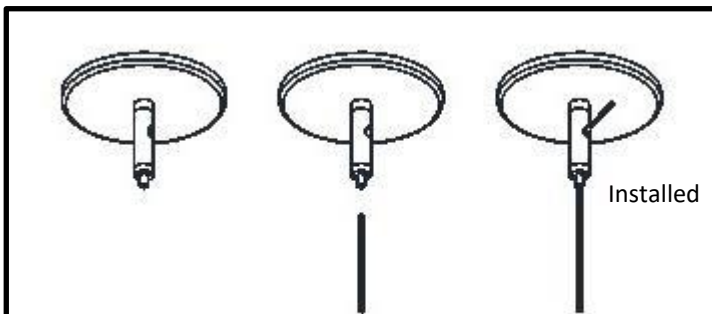
**10 Install A/C into gripper**

**1-8 Install ceiling mounting components non-power**

Refer to steps 1 – 8 prior to starting power versions of the mounting in step 11

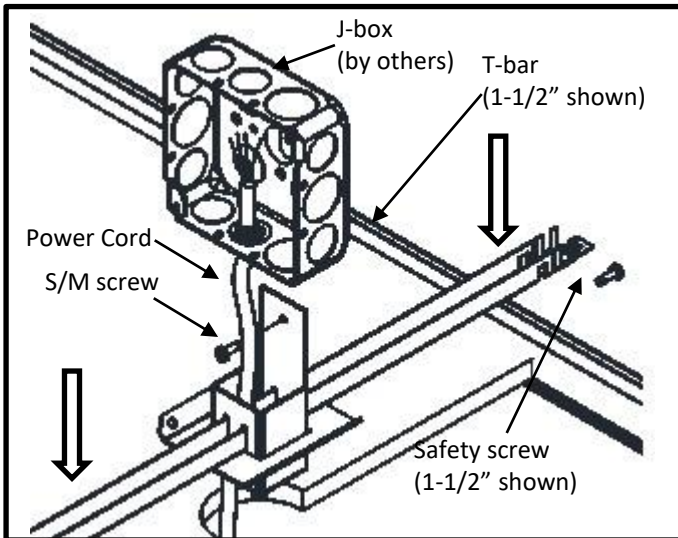
**11-13 Install power and J-box**

**11.** Assemble j-box, strain relief connector, and power cord.

**12.** Feed power cord through mounting strap hole(s).

**13.** Fasten j-box assembly to mounting strap using a self tapping sheet screw. (supplied by others)

**14.** Connect electrical conduit to j-box and make required electrical connections.

**15.** Insert and feed power cord through canopy hole.

**16.** Secure canopy to mounting strap by threading the collar onto the mounting strap ¼-20" stud.

**17.** Insert crimp end of A/C cable into luminaire. Feed free end of A/C cable into gripper.

After cables have been secured, carefully lower luminaire until supported by cable. Cut excess cable after the desired height is determined and luminaire is level.

If applicable, make appropriate power connections at fixture level.

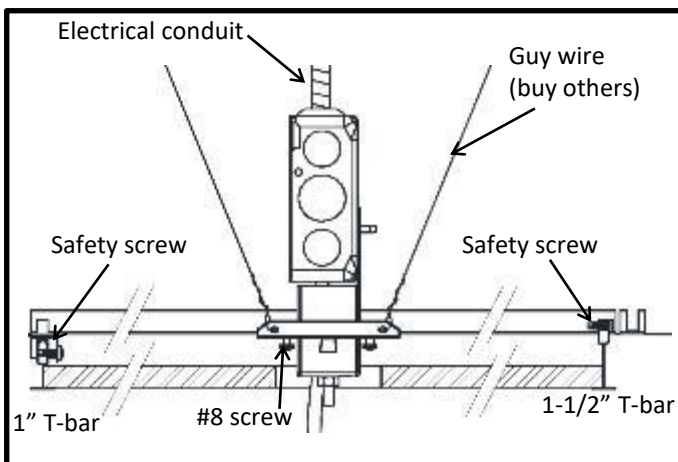
**14 Install safety screws & guy wires**

**Important:** Fully tighten the ¼-20" gripper against mounting strap hex nut.

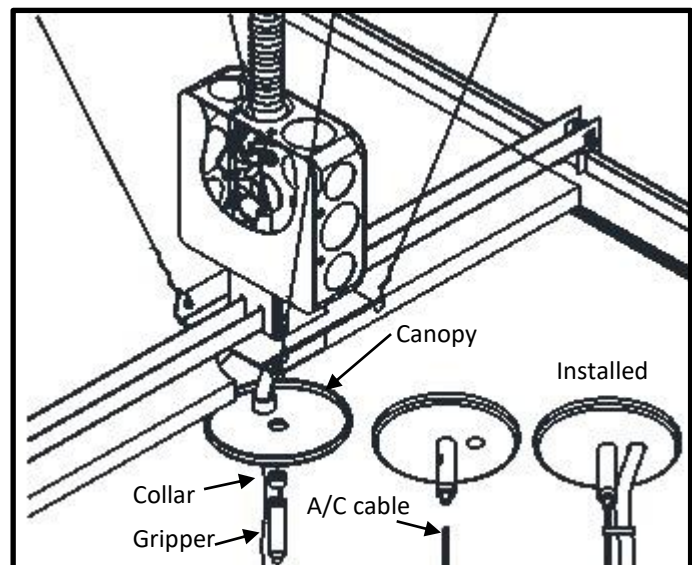
**15-17 Install safety screws & guy wires**

**! ATTENTION:** Install in accordance with local and national building and electric codes.



**IMPORTANT:** Read all instructions including fixture/sensor wiring AND mechanical details **before** beginning installation.



### M6 – On-grid Mount – T-grid ceiling

#### What is Included in this package:

M6-P0 – M6 Cable Mounting Installation without Power

M6-P1 – M6 Cable Mounting Installation with Power

#### M6 – P0

- A/C WIRE GRIPPER (x1)
- CADDY IDS CLIP (x1)
- COLLAR (x1)
- MOLDED CANOPY (x1)



#### M6 – P1

- A6 POWER ADAPTER BRACKET (x1)
- A/C WIRE GRIPPER (x1)
- CADDY IDS CLIP (x1)
- COLLAR (x1)
- HEX NUT, 10-24 (x2)
- ELEC, FLEX CONDUIT ½: #XC-241 (x1)
- SCREW, 10-24 X 9/16" (x2)
- MOLDED CANOPY (x1)
- HEYCO BUSHING SNAP (x1)
- HEYCO BUSHING STRAIN (X2)

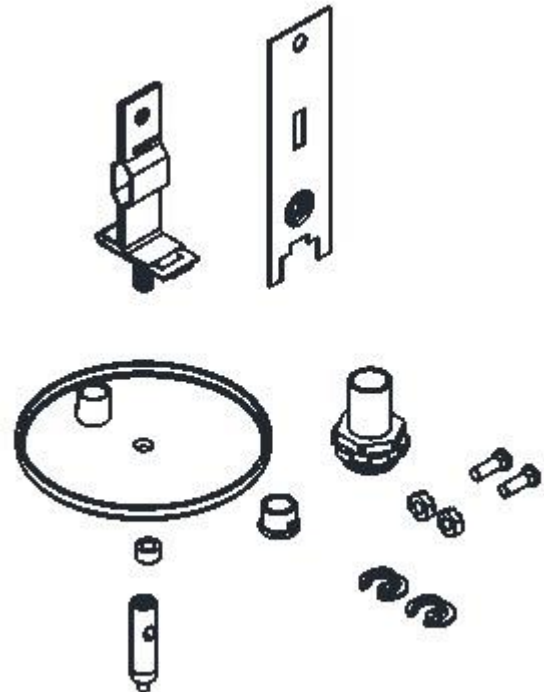

**PLEASE RETAIN PACKAGE FOR FUTURE REFERENCE**

*TOOLS REQUIRED: Phillips screwdriver, Flat-head screwdriver, #2 Robertson screwdriver (optional), A/C wire cutters, Pliers*

### 1 Install ceiling mounting components non-power

**ATTENTION:** Install in accordance to national and local electrical codes and building codes.

**ATTENTION:** Refer to associated installation instruction to complete installation (e.g, leveling, joining, powered and non powered mounts.)

This mounting system is available for 1", 9/16", or 9/16" x 5/16" screw –slot t-bar grid systems.

**Important: Mounting system will support a MAXIMUM 65lbs LOAD.**

Note: Power mount requires use of a 4" square electrical junction box (contractor supplied).

#### NON-POWER MOUNT (Refer to Figure 1)

1. Remove ceiling tiles at mount location.
2. Disassemble t-bar clip and lock into place around t-bar.
3. Secure t-bar clip to structure above using an approved hanger wire.
4. Slide the canopy overtop the t-bar clip bolt, then thread gripper onto the bolt. Fully tighten the gripper.
5. Insert crimp end of A/C cable into luminaire. Feed free end of A/C cable into gripper.
6. After cables have been secured, carefully lower luminaire until supported by cable.
7. Cut excess cable after the desired height is determined and luminaire is level.
8. If applicable, make appropriate power connections at fixture level.
9. Replace ceiling tiles.

#### POWER MOUNT (Refer to Figures 2 to 6)

1. Remove ceiling tiles at mount location.
2. Disassemble t-bar clip and lock into place around t-bar.
3. Secure junction box bracket to t-bar clip using flat-top screw and locknut.
4. Attach an approved hanger wire from structure above to junction box bracket.
5. Attach junction box to bracket using flat-top screw and locknut. Junction box should be oriented with three knockouts facing down.

Continue on next page

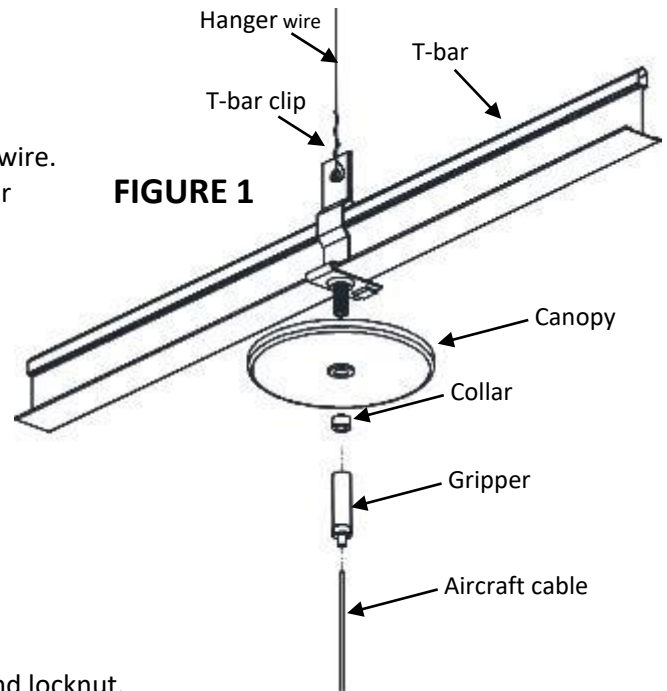

**FIGURE 1**

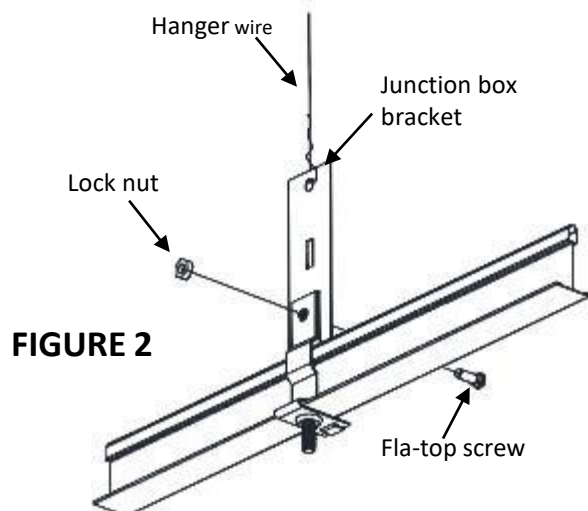

**FIGURE 2**

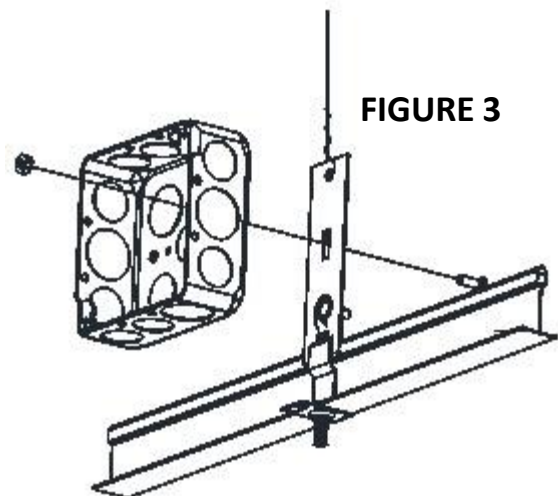

**FIGURE 3**



### POWER MOUNT (cont.)

6. Attach flex-conduit connector to center knockout in bottom of junction box.
7. Slide canopy over the t-bar clip bolt, then thread the gripper onto the bolt. Fully tighten the gripper.
8. Install power cord, make required electrical connections, and install junction box cover.
9. Insert crimp end of A/C cable into luminaire. Feed free end of A/C cable into gripper.
10. After cables have been secured, carefully lower luminaire until supported by cable.
11. Cut excess cable after the desired height is determined and luminaire is level.
12. If applicable, make appropriate power connections at fixture level.
13. Notch ceiling tile to clear the flex-conduit connector.
14. See Figure 6 for cutting dimensions.
15. Replace ceiling tiles.

**FIGURE 4**

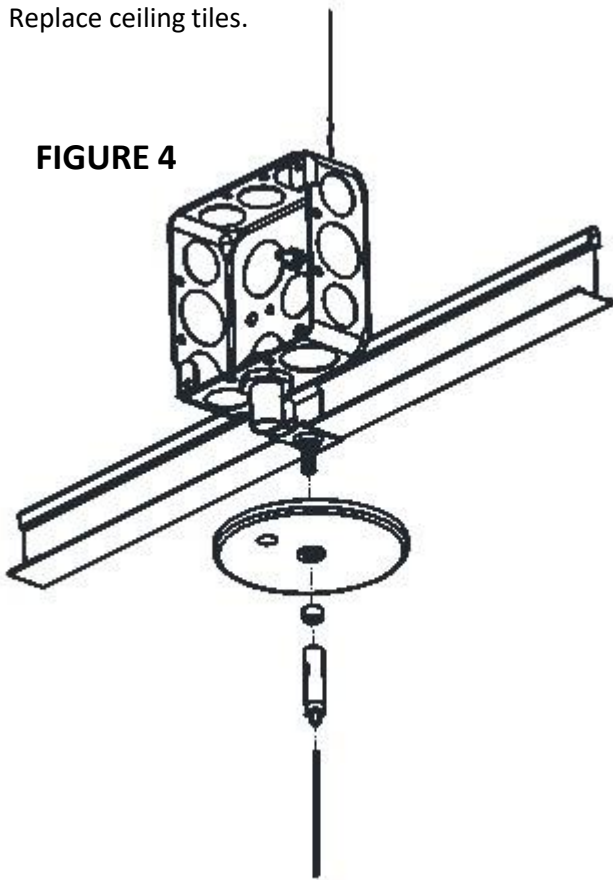

**FIGURE 5**

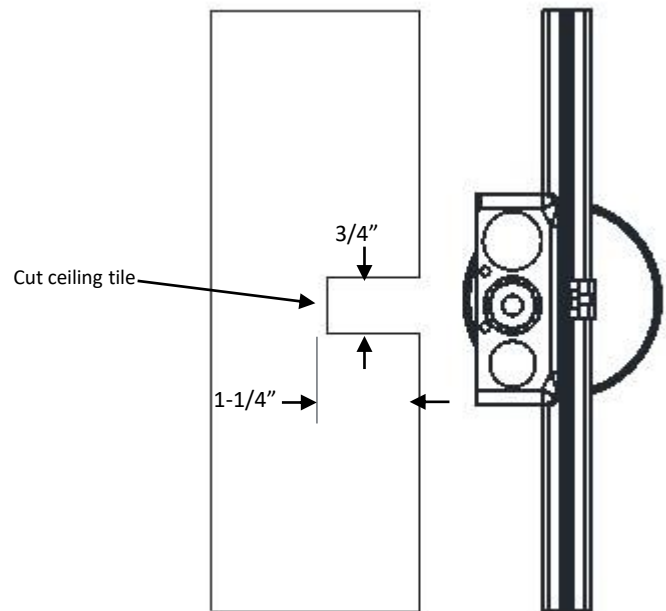
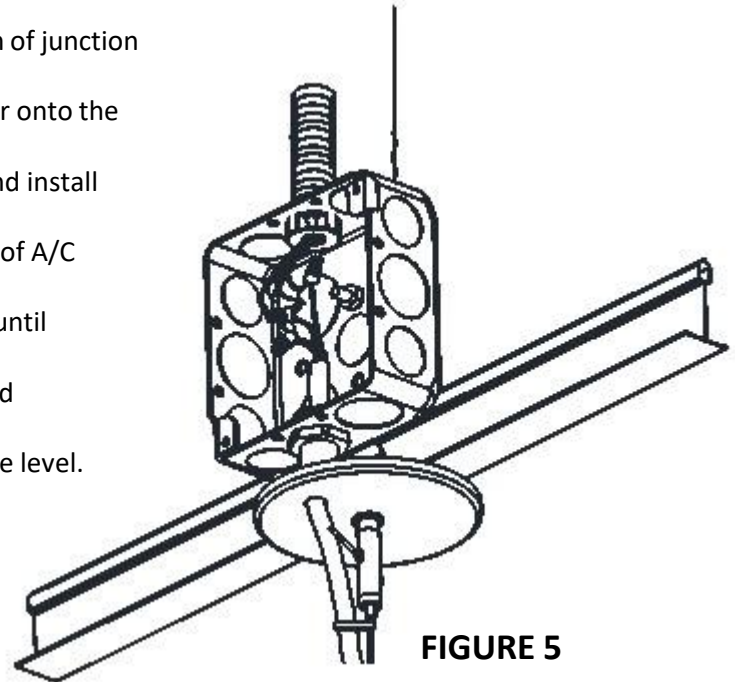

**FIGURE 6**

**! ATTENTION: Install in accordance with local and national building and electric codes.**

