



The Domus Series of products are all designed to compliment each other and bring balance to any environment. Their charm is undeniable. Simplicity, refinement and elegance, all fuse together to create harmonious beauty through designed equilibrium. Domus Series is available in multiple size of post tops, pendants, and bollard.

Project: _____

Location: _____

Cat.No: _____

Type: _____

Lamps: _____ Qty: _____

Notes: _____

Ordering guide

example: DOSB1-50MH-120-PH7-BE2TX

Product	Lamp	Voltage	Options	Finish ¹
DOSB1				
DOSB1	20W16LED4K	120 120V	PH7 Photoelectric cell	BE2TX Midnight Blue Textured
	30W16LED4K	208 208V	VPA Vandalproof hardware	BE6TX Ocean Blue Textured
		240 240V		BE8TX Royal Blue Textured
		277 277V		BG2TX Sandstone Gold Textured
				BKTX Black Textured
				BRTX Bronze Textured
				GN4TX Blue Green Textured
				GN6TX Forest Green Textured
				GN8TX Dark Forest Green Textured
				GNTX Green Textured
				GY3TX Medium Grey Textured
				RD2TX Burgundy Textured
				RD4TX Scarlet Textured
				WHTX White Textured
				NP Natural Alum.
				TG Hammer-tone
				TS Hammer-tone Silver

1. Consult Lumec's Color Chart for complete specifications.

Socket: GX24Q-2 (18W), GX24Q-3 (26 or 32W), GX24Q-4 (42W), triple tube compact fluorescent (lamp not included).

DOSB1 DOS Series

Bollard

Luminaires

Conform to the UL 1598 and CSA C22.2 No. 250.0-08 standards.

DOSB1

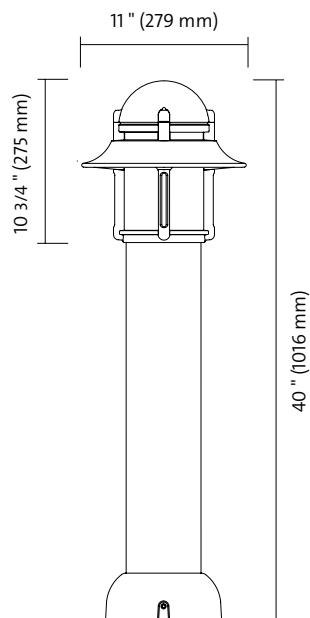

Anchor Plate

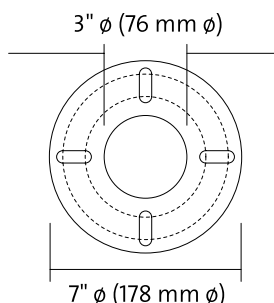

Bolt circle
5-1/2" (140mm)
B.C. possible:
from 4-3/8" to 6" (111mm to 152mm)

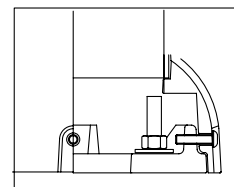

Mounting details

Comes with 4 steel anchor bolts,
3/8" x 12" (10mm x 305mm),
4 nuts and 4 washers.

Important: Do not obstruct space between anchor plate and concrete base.

Specifications

Hood

Made from cast (356) aluminum, mechanically assembled.

Housing

Round shape, made from cast (356) aluminum, c/w one louver, welded to the base.

Ballast

High power factor of 90%. Assembled on a unitized removable tray with quick disconnect plug.

Base

Made from aluminum, 5" (127mm) outside diameter, welded to the base cover.

Base cover

Made from cast (356) aluminum, mechanically secured to the anchor plate.

Finish

"Hot dip" chemical etching preparation. Lumital™ polyester powder coat finish. Excellent color retention as per #ASTM D2244, and outstanding salt-spray resistance according to #ASTM D2247 testing procedures.

