

EMI52B Emergency Spitfire

Mounting instruction

Indoor
Use
Only

IEC
60598-2-22

IP20

RoHS

Type Des.	Input Power	Emergency Power	Lumen	Battery	Function	Voltage	Frequency	Class	
EMI52B Emergency Spitfire	1.6W	2W	330lm	LiFePO ₄ 3.2V 3.3Ah	Self-test	220-240V~	50/60Hz	II	0.318

ALWAYS SWITCH OFF THE
MAINS SUPPLY BEFORE
INSTALLATION OR SERVICING

Signify (China) Investment Co., Ltd.
Address: Building No. 9, Lane 888, Tianlin Road,
Minhang District, Shanghai, China China Postal
code: 200233

Data subject to change without notice

PHILIPS
Philips and the Philips shield emblem are registered trademarks of Koninklijke Philips N.V.

3

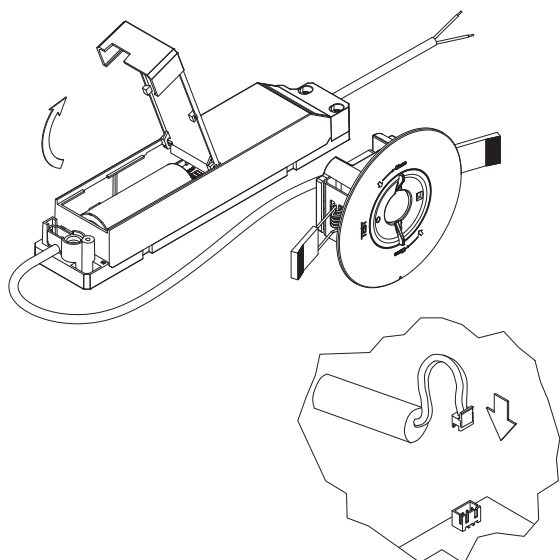

Connect battery to converter

4

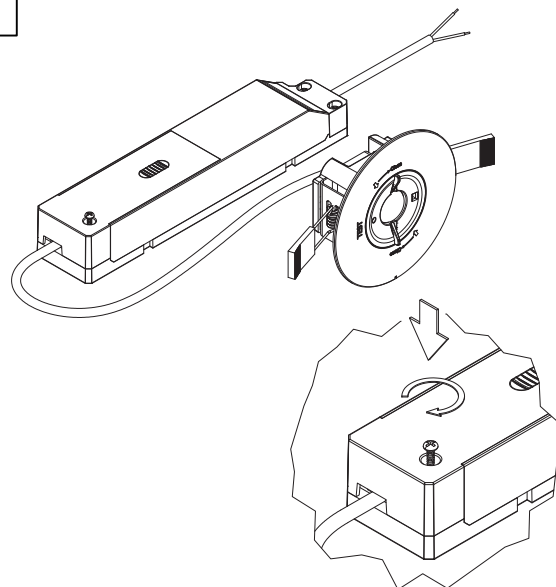

5

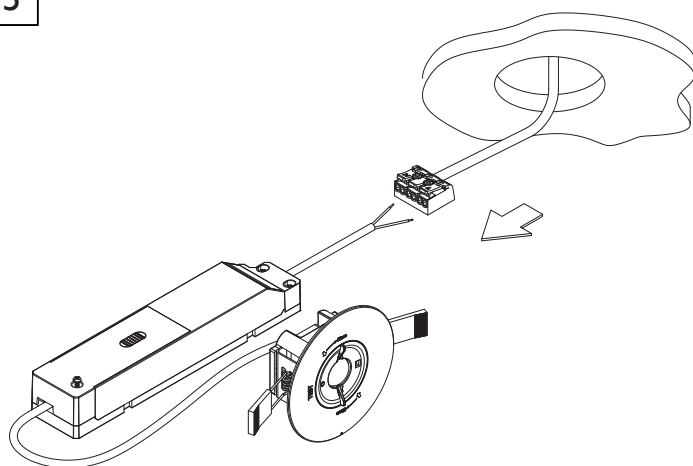
**LUMINAIRE**

Brown (L)

Blue (N)

MAINS SUPPLY

Brown (Live)

Blue (Neutral)

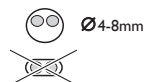
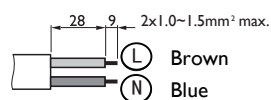
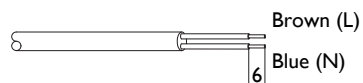

6

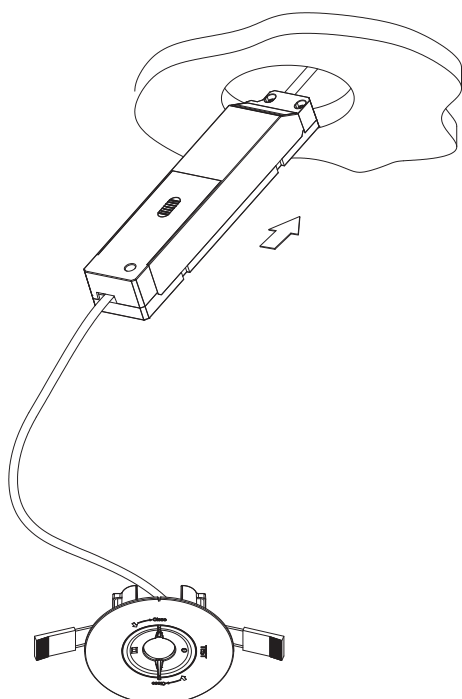

7

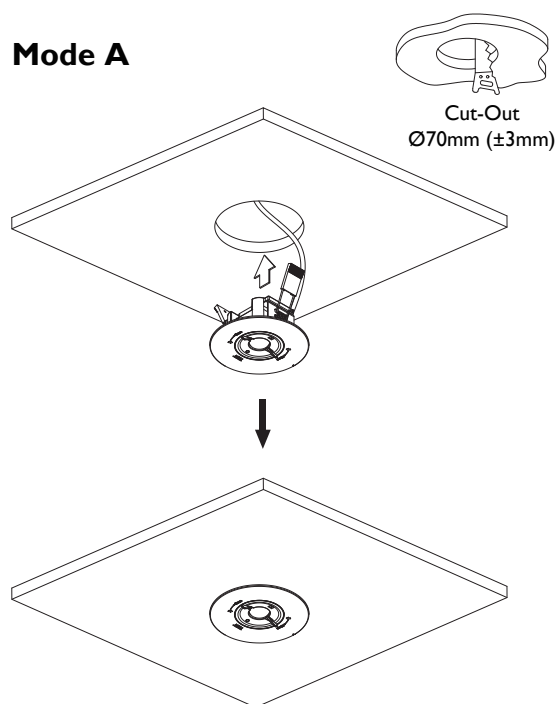
Mode A

8

Mode B

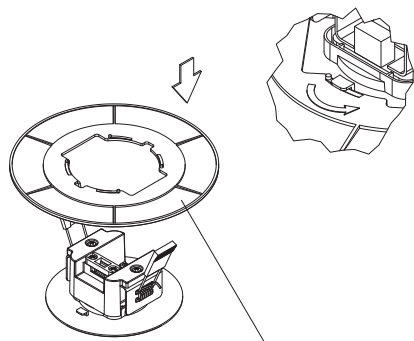

EMI56Z
Emergency Spitfire inst.cover
not supplied

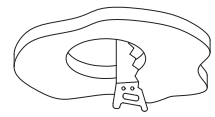

Cut-Out
Ø130mm (±3mm)

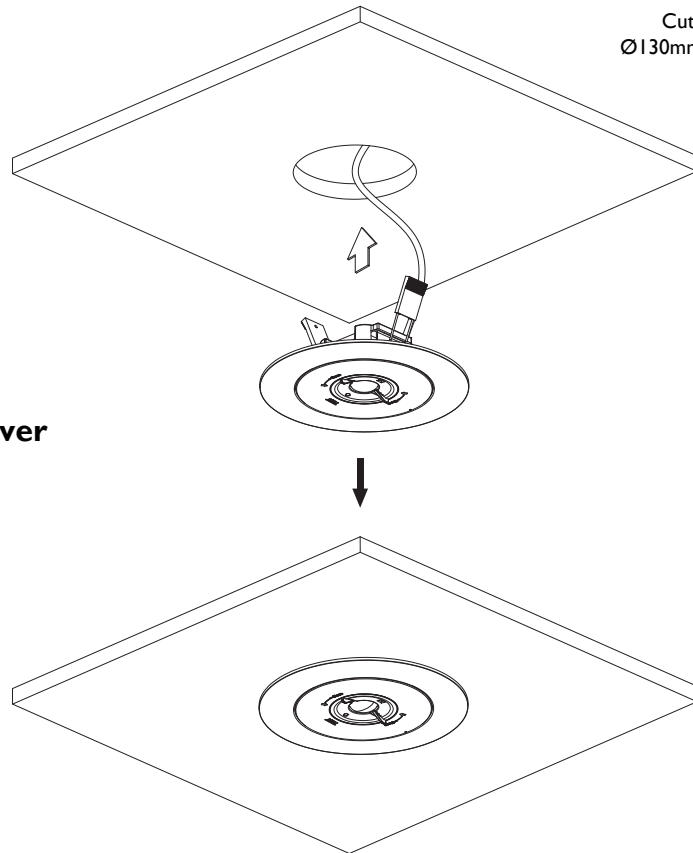

9

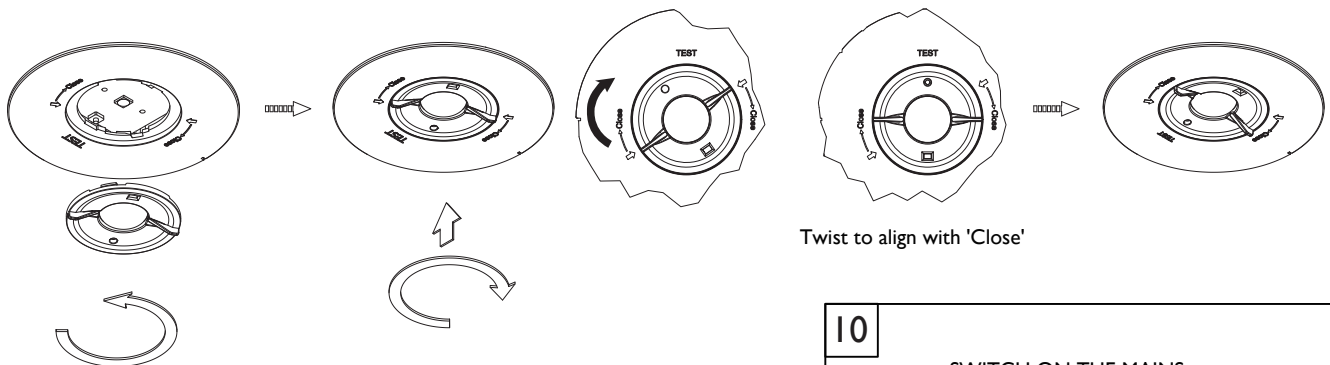

Twist to align with 'Close'

Only for
lens replacement

10

SWITCH ON THE MAINS
SUPPLY AFTER
INSTALLATION OR
SERVICING

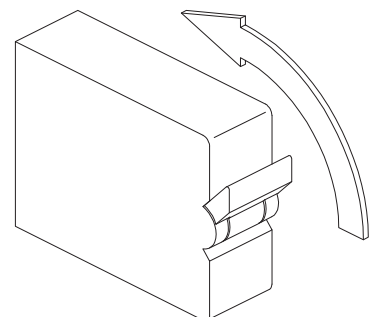

Type Des.	Run Current(A) @220V	Start (Inrush) Current(A) / Ipeak (A)	Start Current Duration (μ s) / T (@50% of Ipeak) (μ s)	Touch current or protective conductor current (mA)	MCB Type B 16A Max no. fitting (pcs)	MCB Type C 16A Max no. fitting (pcs)
EM152B Emergency Spitfire	0.02	4.6	4.8	0.03	297	495

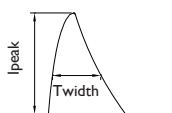

1. For indoor use only.
2. The luminaire complies with IEC60598-1 IEC 60598-2-22.
The luminaire must be installed by a qualified electrician and wired in accordance with the latest IEE Electrical regulations or the national requirements.
3. Turn off the power supply before checking, installation, maintenance or moving.
4. Do not switch on before complete installation.
5. The light source and/or controller contained in this luminaire shall only be replaced by the manufacturer or his service agent or a similar qualified person.
6. Batteries shall only be replaced by the manufacturer or his service agent or a similar qualified person.
7. Batteries should be replaced when the luminaire no longer meets the 3 hours duration performance.
8. Product mains surge immunity is 1/2KV (diff. / comm. mode). To prevent excessive currents and voltages from damaging the device, make sure that the power supply input is equipped with additional protection devices such as surge protectors. For any questions regarding the product's surge protection, please consult the manufacturer's professional.



Please inform yourself about the local waste disposal, separation and collection system for electrical and electronic products and packaging. Please act according to your local rules and do not dispose your old product and packaging with your normal household waste. The correct disposal of the packaging, your product and/or batteries will help prevent potential negative consequences for the environment and human health. Batteries should be disposed separately from the municipal waste stream via designated collection facilities. When disposing a product that contains non-user replaceable batteries, the non-user replaceable batteries shall be removed by a professional.

Testing Record

Product: _____

Location: _____

Installation Date: _____

Month	Functional/Duration	Year 1	Year 2	Year 3	Year 4	Year 5
1						
2						
3						
4						
5						
6						
7						
8						
9						
10						
11						
12						

EM152B Emergency Spitfire

Specifications For Self Test

EM152B

Function Test









The function test is conducted every month for 3 minutes to check whether the battery connection is abnormal and discharge the battery and the connection of LED module.

Duration Test

An initial duration test is conducted when the battery is connected to the controller for the first time and connected to mains, but after 24 hours charging.

The yearly duration test is conducted for 3 hours on one day within the 300th day to the 365th day every year. It will also check the connection of battery and LED module.

Description corresponding to the color and status of the charge indicator

Charge Indicator Color	Status	On Time (Seconds)	Off Time (Seconds)	Description
Green	 Permanent on	/	/	Normal status when mains connected
	 Slow flash	1s	1s	Duration test running
	 Fast flash	0.2s	0.2s	Function test running
	 Normal flash three times only	0.5s	0.5s	Time reset
Red	 Permanent on	/	/	Battery connection is abnormal or failure
	 Slow flash	1s	1s	Lamp connection is abnormal or failure
	 Fast flash	0.2s	0.2s	Duration failure - the capacity of the battery is decay
Both Off	 Off	/	/	Emergency mode

It should be taken to check connectivity or replace the abnormal battery or lamp

Test button for manual inspection on function test or duration test

Mode of operation

Mode	Description
Press for <2s	Simulate emergency mode.
Press for 3-5s	Start duration test manually. The test can be aborted by pressing off (1-2s). * Must be conducted when the initial duration test finished and after another 24 hours battery charging.
Press for 5-8s	Start Function test manually for 60s. The test can be aborted by pressing off (1-2s).
Press for >10s	Time Reset.

Note:

When the mains is on, the green indicator will be permanent on. It will check the connection of battery and LED module. If it is a non-maintained fitting, the connection of LED module no need to be checked. When the mains is off, no test will perform.

The luminaires which perform the function and duration tests must be connected to the mains supply for at least uninterrupted 24 hours. If the mains is off during these tests, the tests will be postponed for 3 days.

When the fault is corrected, the indicator will only be reset to its normal status after mains reconnected or test switch pressed.

An accuracy of the timing of the test interval is ensured that it has an accuracy of ± 75 s per week. The timing function will be retained through periods of mains supply failure or interruption for up to 7 days.

EMI52B Emergency Spitfire

Storage

EM152B

1. The battery should be preserved at the clean and dry environment, do not exceed storage time as following definition.
2. Storage time: battery is charged in ex-work condition (as per required law of dangerous good needs or UN38.3), for ensuring battery performance, do not exceed storage time as following definition.
3. -20°C to 50°C, <1 month, The battery should be recharged every 1 month.
4. -20°C to 40°C, 1-3 months, The battery should be recharged every 1 month.
5. -20°C to 35°C, >3 months, The battery should be recharged every 3 months
6. If the battery is preserved for a long time (more than 9 months), the battery should be discharged and recharged once. Even so, it will impact the battery performance.
7. If LFP battery is stored for more than 3 months at temperature above 35°C, may need supplemental charge before its use with luminaire. (Refer battery datasheet for final recommendation).