

The Signify logo, featuring a stylized 'S' inside a circle followed by the word 'signify' in a lowercase, sans-serif font.

ClassicStreet

Echoing the past,
shaping the future

The 'Interact ready' logo, consisting of a stylized 'S' icon and the text 'interact ready'.The 'LEDgine' logo, featuring a grid of dots and the text 'LEDgine'.

Always in style

Timeless elegance, that is the heart of the new ClassicStreet range. The design is reminiscent of the iconic beauty of 20th-century street lanterns, while meeting today's functional public lighting requirements.

City planners will appreciate all the benefits of LED technology: energy savings, long lifetime, low maintenance and digital connectivity options. And for a city's inhabitants, the range offers a striking addition to their cityscape, with luminaires that feel equally at home in established and new neighborhoods.



Contents



Introduction	04	Service tag	10
Application areas	06	Serviceability	11
Family range	07	System-ready architecture ..	12
Lighting performance	08	Dimensional drawings	13
LEDgine	09	Product specifications	15

Elegance and performance go hand in hand

Part of a city's charm lies in the interplay between its older and newer areas. Along the city streets, you can feel echoes of the past and also the promise of the future – and this is exactly what ClassicStreet reflects. The gently curved design, together with dedicated brackets and poles, creates a contemporary look that beautifies your city. At the same time, the advanced LEDgine optimized light engine delivers outstanding levels of lighting and energy performance. The luminaires' styling is not only suitable for historical and traditional architectural settings, but feels equally at home in more modern urban environments.



Attractive and versatile

From the drawing board to its final execution, we developed ClassicStreet to follow a well-thoughtout approach to urban illumination. It brings together elegant and subtle details, softened proportions and a contemporary mindset. All of which makes ClassicStreet the ideal luminaire for historical and traditional architectural settings, but feels equally at home in more modern urban environments.



Comfort and ambiance

The urban landscape can be overwhelming, so it is important for people to feel safe and comfortable in your city. ClassicStreet offers an optional diffusing solution that combines comfort and performance. Special attention was paid in the technical design to avoid the typical chessboard and cross-effects shadows on the floor. This enhances the lighting uniformity, which contributes to a more pleasant city atmosphere and to citizens' well-being.

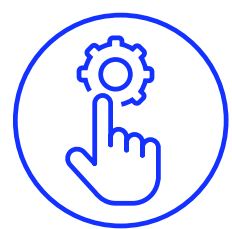

Excellent value

ClassicStreet is the perfect solution for both renovation areas and new installations. The LEDgine optimized light engine delivers outstanding energy performance. And the range's styling, high-quality finishing and optical performance make this range the right solution for all kinds of residential streets, parks, squares and city centers.

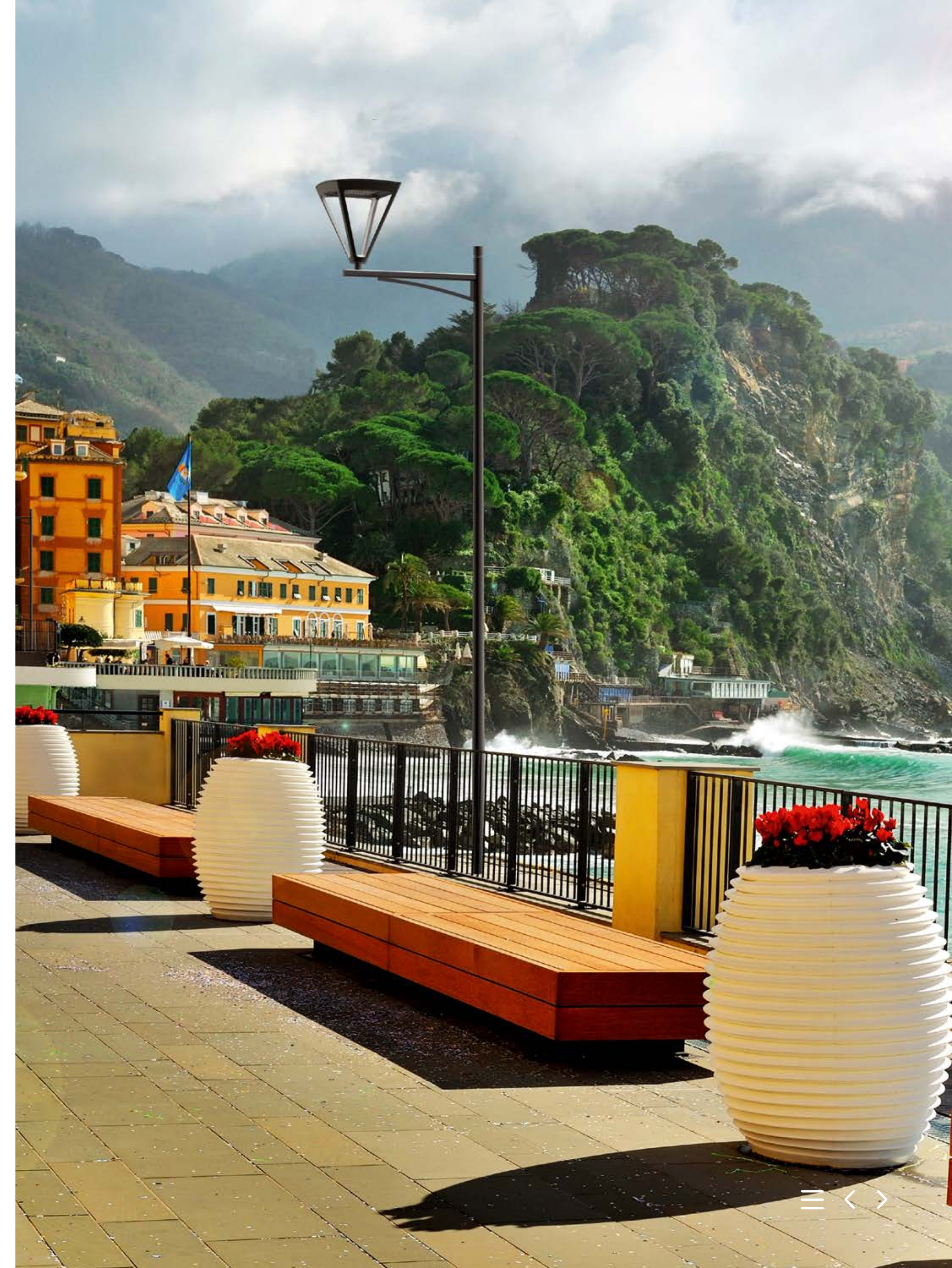



The best of both worlds

The idea behind ClassicStreet was to unite the best of both worlds. The classic elements in its design hark back to the familiar shapes of traditional street lanterns, while the execution is contemporary in every detail. The result is a luminaire that will stand the test of time.

“Classic design meets future-proof technology”

The design of these complete sets is meant to reflect a classical yet still contemporary feeling. It echoes completely the iconic form of the 20th century street lanterns but the execution of its details and proportions are soft, radiused and contemporary.

Flexibility first

This approach to detailing makes the overall design more flexible in terms of integration into existing environments. At first glance, the luminaires have a silhouette that is square and flat, but a closer inspection reveals that the edges have been slightly curved and softened to give them a more 21st-century appeal.

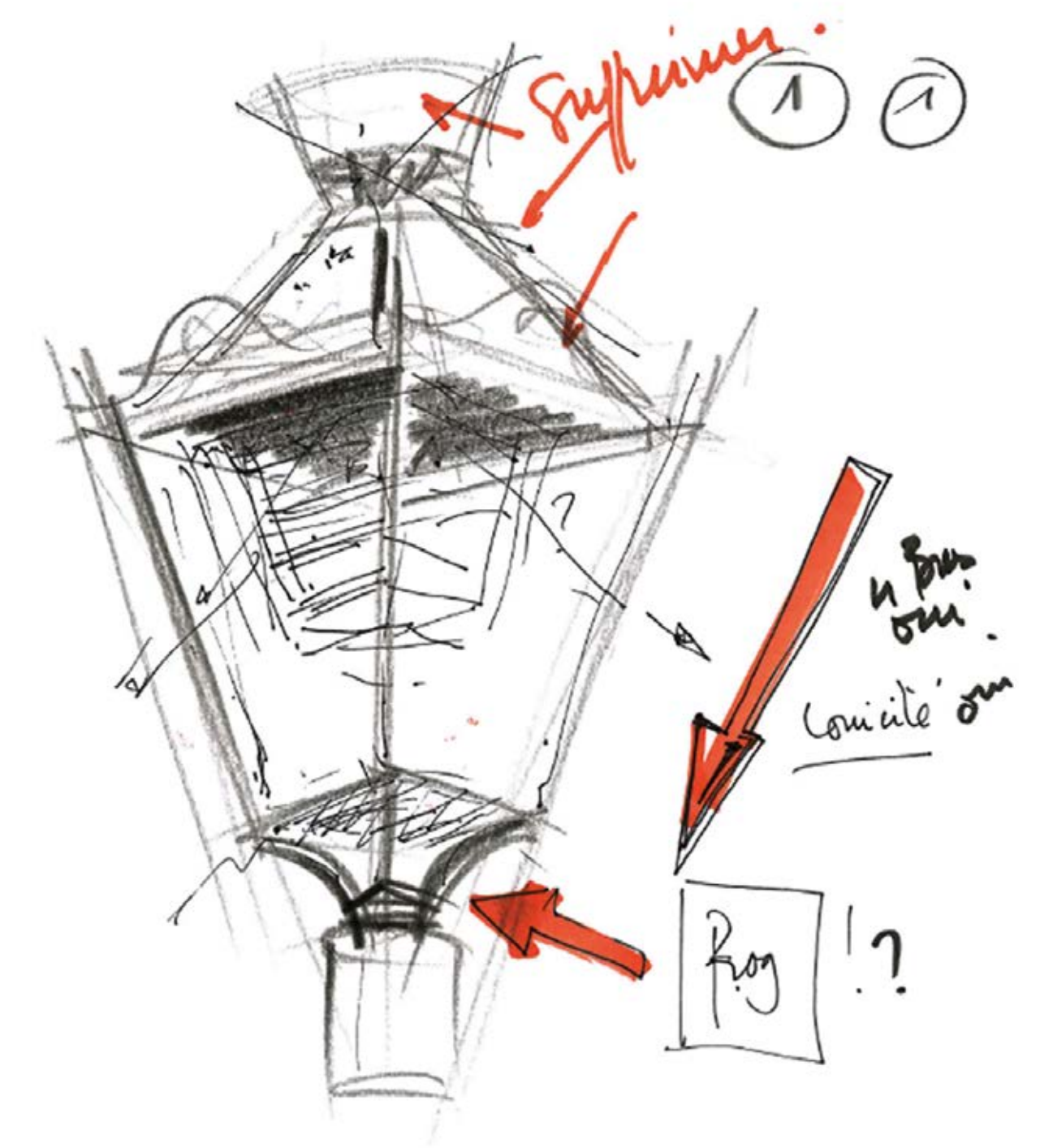

Application areas

ClassicStreet has a well-balanced design with retro styling and a modern look. Thanks to this timeless esthetic, it is suitable for enhancing all types of city centers or urban areas – from historical or heritage districts to more contemporary, modern city zones.

Designed around its LEDgine optimized platform, ClassicStreet delivers outstanding levels of lighting and energy performance. Its different types of fixation or poles and brackets offer a high degree of flexibility, not only in terms of integration with the architectural context, but also in its range of applications.

ClassicStreet is part of our Urban Inspiration lighting portfolio. It incorporates all the necessary technical and functional features of city lighting, and also has a strong focus on the emotional and social value of light. In this way, it helps you create the right ambience in your city, enhance people's well-being and make the city more livable. For every application we have a number of solutions that will inspire you and enhance your urban landscape, while also fulfilling all of your specific feature requirements.

The ClassicStreet application areas include:

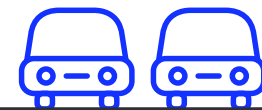

Parking areas, residential areas and side streets

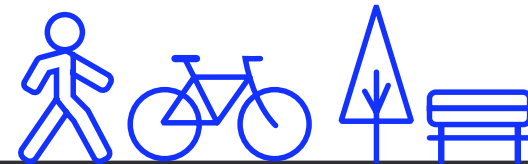

Squares, parks, playgrounds, cycle paths and footpaths



City centers, shopping and pedestrian areas



Family range

The ClassicStreet range was designed for use in urban centers and city areas where heritage, ambience, comfortable lighting and attractive design play an important role.

With its softened curves and high-quality finishing, ClassicStreet is an easy and elegant fit in any urban environment. The gently curved design, together with the dedicated brackets and poles, creates a contemporary look that beautifies your city and creates distinctive and warm ambiances – at night and during the day.



Post-top pole
Ø 60 mm

Post-top pole
Ø 76 mm



Post-top ClassicStreet
bracket with dedicated post-
top ClassicStreet luminaire



Suspended ClassicStreet
bracket with dedicated
suspended ClassicStreet
luminaire

Suspended mounting
using a brass threaded
spigot 1'G

Complete sets

ClassicStreet comes with a choice of poles and brackets so that you can always find the perfect fit for both classical and more modern architectural contexts. These ready-to-use complete sets have a design that is reminiscent of the classical street atmosphere, combined with a contemporary and distinctive look. The brackets all have a dedicated interface that matches the range of luminaires, for optimum design integration and ease of installation.

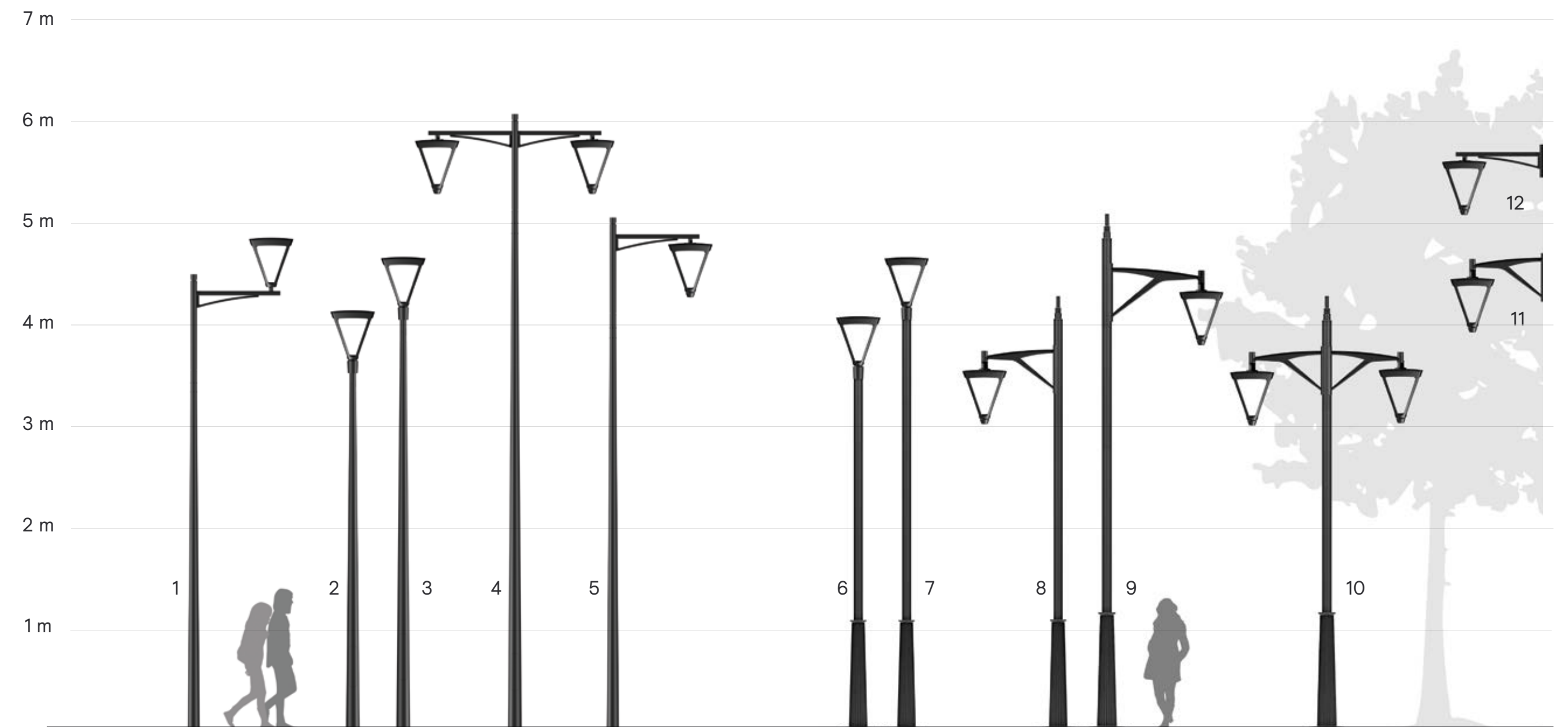

- 1 ClassicStreet + ClassicStreet single arm bracket post-top + Accante pole 3,5 m
- 2 ClassicStreet + Ø 60 Accante pole 3,5 m
- 3 ClassicStreet + Ø 60 Accante pole 4 m
- 4 ClassicStreet + ClassicStreet double arm bracket suspended + Accante pole 5 m
- 5 ClassicStreet + ClassicStreet single arm bracket suspended + Accante pole 4 m
- 6 ClassicStreet + Faro post-top pole 3,5 m

- 7 ClassicStreet + Faro post-top pole 4 m
- 8 ClassicStreet + Faro bracket + Faro applique pole 4,7 m
- 9 ClassicStreet + Faro bracket + Faro applique pole 5,5 m
- 10 ClassicStreet + Faro double brackets + Faro applique pole 4,7 m
- 11 ClassicStreet + Faro wall mounted bracket
- 12 ClassicStreet + ClassicStreet wall mounted bracket

Lighting performance

Best-in-class lighting and energy performance enabled by the LEDgine optimized platform offering application tailored optics, which helps maximize energy efficiency

Portfolio of optics

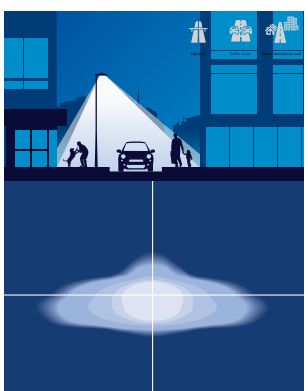
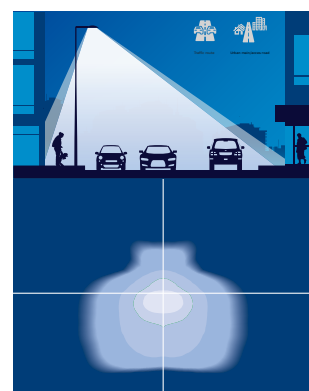
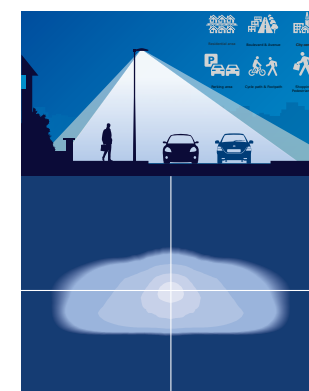
DN10	DM11	DM50
		
Narrow distribution for luminance classes	Medium distribution for luminance classes	Medium distribution for illuminance classes

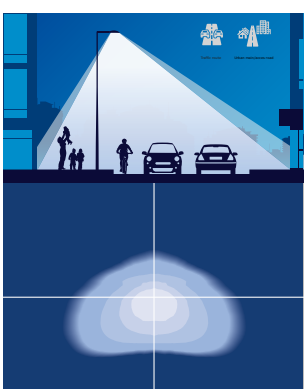
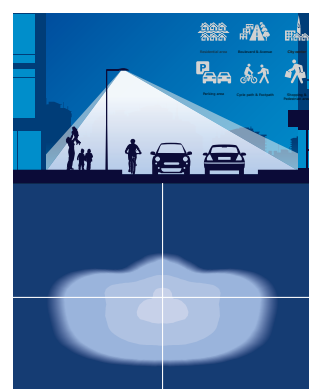
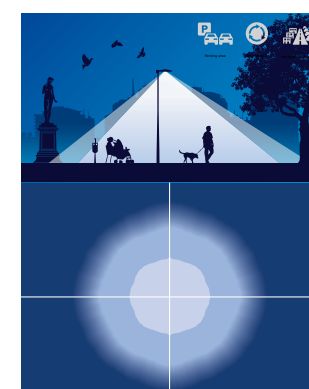
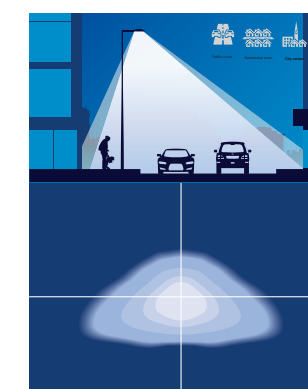
DW10	DW50	DX10	DS50
			
Wide distribution for luminance classes	Wide distribution for illuminance classes	Extra wide distribution for illuminance classes	Symmetrical distribution for central arrangement



The right solution for outdoor applications: LEDgine



Our latest generation LEDgine optimized light engine offers the flexibility to further optimize your preferences for luminaire efficacy and cost aspects. The LEDgine optimized light engine covers a wide range of standard fluxes and a full range of standard optics is available to cover a wide range of applications. Moreover, where needed we can support you to tune and optimize your project solutions as to fluxes and light distributions further. The three pillars that characterize the light engines are standardized optics, standard engines and tailor-made solutions.



Luminaire efficacy optimization: LEDgine optimized

LED count and glass options optimizing system lm/W supporting high energy savings.

High flux per area enabling use of compact lower cost luminaire sizes.

Standard engine
High performance across portfolios.

Using a standard engine across different luminaire ranges means you can optimally benefit from the latest LED upgrades without changing light distributions, so design continuity is assured. Standard flux packages are pre-defined across product ranges. Flux and thereby energy minimization is achieved by using best possible lumen maintenance (up to L98 or CLO solutions). The LEDgine optimized engine benefits from more LEDs per area contributing to more compact and cost effective solutions. Standard engines minimize spare components which are easy to configure by using our Service tag application.

Standardized optics
A perfect application fit. A wide range of light distributions ensure a perfect fit for many applications.

The optics offer flexibility, enabling standardization over applications with a good performance across a wide range of geometries – as well as design parameters such as tilt and overhang. The optics comply with national and European road lighting standards.

Tailor-made solutions
Tuning to project preferences.

We can support you with to customize solutions which of course can become your standard! Using a variety of LED counts it enables to build the exact required flux in a perfect balance between energy consumption, luminaire cost/type and operational life. Based on project parameters the best optical fit can be selected and when required light distributions can be customized for best application fit and to maximize energy savings.

Signify Service tag

Service tag from Signify is a unique QR code-based LED luminaire asset identification system that provides detailed information on specification and spare parts. The system simplifies the installation and maintenance of lighting infrastructure by utilizing cloud technology. Service tag also plays a key role in the circular design of our lighting solutions, as it extends their service life and reduces maintenance efforts, ensuring efficient servicing and avoiding waste.



How it works

Every luminaire is equipped with a unique QR code. All relevant asset data is stored in the service cloud, including detailed luminaire specification, User data (geo location, project-location, external ID, notes, etc.) and information on spare parts and accessories. By scanning the QR code on the packaging or luminaire with the Signify Service tag app, this information becomes instantly accessible, offering invaluable benefits.

Your benefits at a glance



During installation



#1. Download the app

Download the Service tag app from the App store or Play store on your mobile device (iOS or Android).



#2. Register the luminaire

Register the luminaire by simply scanning the QR code on the packaging or luminaire. The system automatically identifies the type of each luminaire.



#3. Create a group QR code

If you have multiple luminaires, it's possible to use the Service tag app to combine individual luminaires into a group. Each group will have its own unique group QR code.

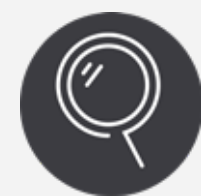

#4. Luminaire information

Scan the QR code on your luminaire for easy access to the installation manual.

During service/maintenance



#1. Spare parts identification

Use the Service tag app to view a luminaire's spare parts, which contains all necessary information for quick ordering.



#2. Spare parts programming

Quickly program a spare driver using the Service tag app—without needing a faulty driver on hand. Scan the QR code of a luminaire with your device, press "Program" and the spare driver receives the right settings for this specific luminaire.



Easy installation and commissioning

- Access to product details, manuals and spare parts
- Helps avoid errors



Simplified maintenance

- Detailed information on products
- Quick access to relevant information means less time required for repairs or replacements



Asset management

- Real-time tracking of assets
- Simplified management of replacements, upgrades and warranty information

Learn more at signify.com/global/service-tag

Serviceability

ClassicStreet was designed to last a lifetime. To ensure easy maintenance it is very easy to access and service the most critical components, like the driver. ClassicStreet allows you to quickly reach in and replace the driver on site within a couple of minutes, using only a screwdriver. Simply follow the six easy steps below.



Step 1:
Unscrew four screws to open the cover

Step 2:
Remove the cover, which is installed with a safety cord

Step 3:
Return the cover onto the frame of the luminaire and unscrew the four screws of the mask

Step 4:
The driver is now easily accessible



Step 5:
Loosen two screws and unscrew a third screw to remove the driver

Step 6:
Return the cover onto the frame of the luminaire and close it by screwing the four screws of the cover

System ready architecture

The digital and smart city era is accelerating fast. To keep pace, cities need luminaires that are not only designed for today's technologies, but are prepared for future advances and upgrades. The System ready architecture gives you a scalable foundation that you can build on whenever your city is ready to opt into new advances in technology. So you can take light beyond illumination into a dynamic world of sensor-rich lighting – whenever you're ready.

Upgrade now or later

ClassicStreet is a System ready luminaire, coming with universal sockets on top of the luminaire, so all you have to do is click in controllers or sensors to activate new applications. That means you can install your luminaires today and mount controllers and sensors at a later date – without any hassle.

An open platform

Our System ready luminaires use state-of-the-art architectures and components. Because they are SR & ZD4i Certified, they are compatible with all components released in our SR program. This ensures you'll always be ready for the latest innovations that will enable you to get more out of your lighting infrastructure.



Future-proof upgrades

System ready luminaires can be paired with sensors and controllers now or later. A city solution that is completely flexible and scalable.



Plug and play

Designed for hassle-free installation, controllers and sensors can be mounted without opening the luminaire.



Aesthetic design

The small, unobtrusive form factor can be mounted discreetly on luminaires.



Standardized technology

Thanks to Zhaga standardization and the SR & ZD4i Certified program, you will have access to preferred technology, allowing you to make use of innovations from different suppliers.



Open innovation platform

Using this System ready architecture gives you access to new innovations that could enhance your lighting even further in the future.

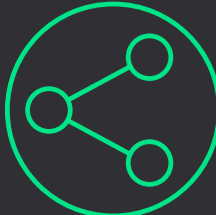

Flexibility

The Zhaga 4 Pin socket can be mounted on the top, of the luminaire, giving you the flexibility to choose from all sources of sensor applications. The IP66 rating also ensures there is no risk of water ingress.

Ready to be connected to Interact



Interact is a connected LED lighting management system which helps you improve services, enhance safety, beautify public spaces, encourage civic pride, and increase energy efficiency in your city. The system allows you to tap into a wide range of both lighting and non lighting benefits such as dimming, presence detection, noise or air quality monitoring, and incident detection. ClassicStreet is ready to connect with Interact when you are.

For more information about Interact in cities visit:

www.interact-lighting.com/city

Get more value out of your lighting infrastructure

Control and monitor your street lighting remotely and immediately identify lighting failures using a single dashboard application. With full control of your city lighting you can identify opportunities for further energy savings by dimming, scheduling and zoning. Interact enables you to reduce CO₂ emissions, meet sustainability targets and reduce costs, enabling you to reinvest the savings into other areas of your city's infrastructure.

The Open API's of the system allows it to be integrated into your other city management systems and allows your existing partners or independent third parties to use it as a platform for future innovation.



Dimensional drawings

BDP794
Post-top with Spigot
Ø 60 or 76 mm

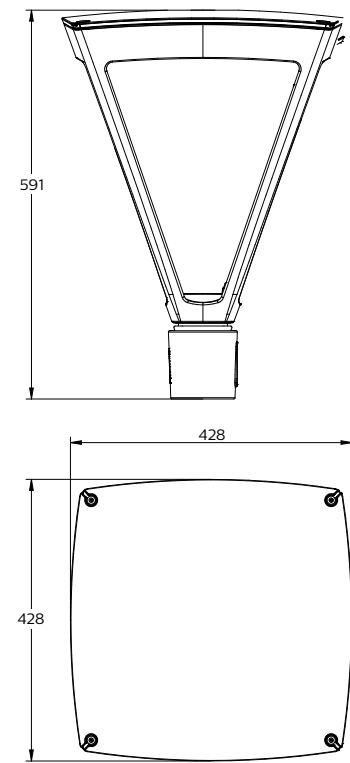

BSP794
Suspended
1'G

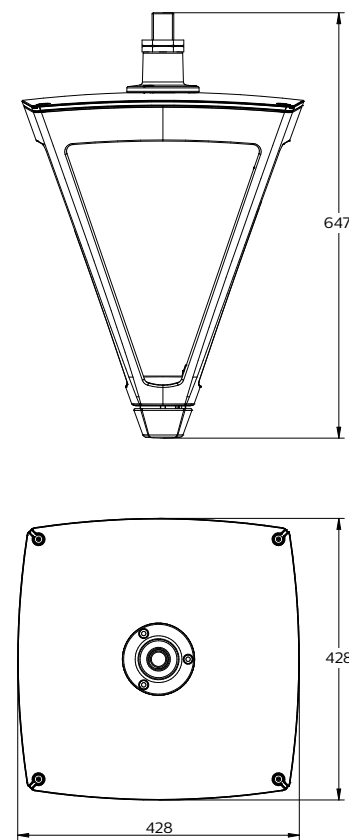

BVP794
Suspended ClassicStreet
luminaire for suspended
ClassicStreet bracket

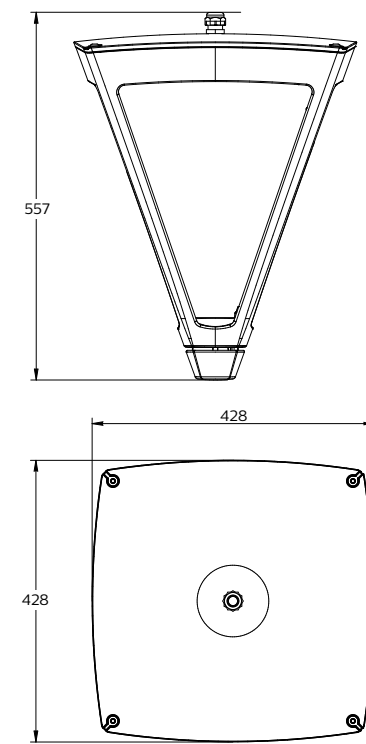

BPP794
Post-top ClassicStreet
luminaire for post-top
ClassicStreet bracket

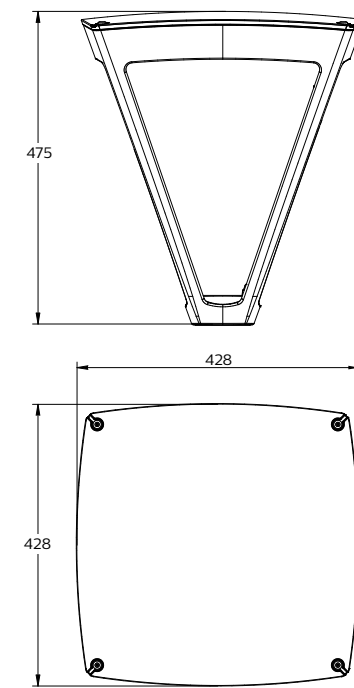

BDP794
Ø 60 or 76 mm Spigot

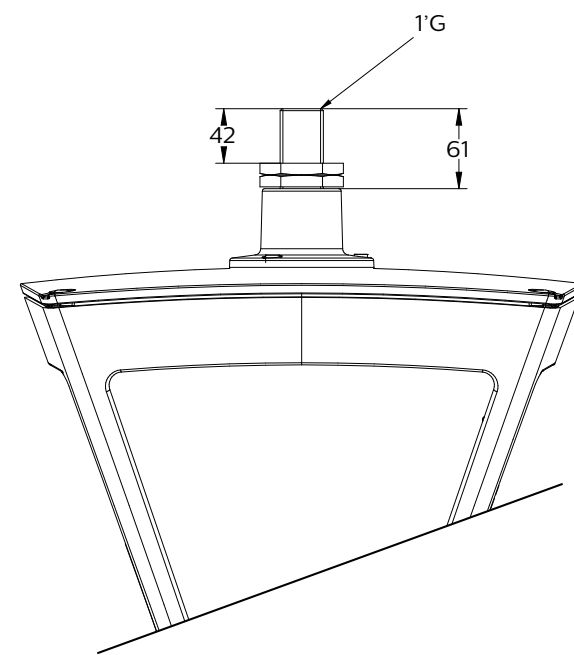
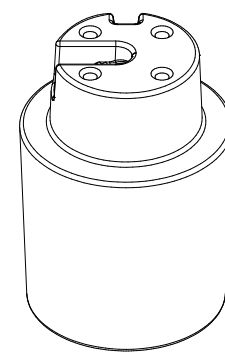
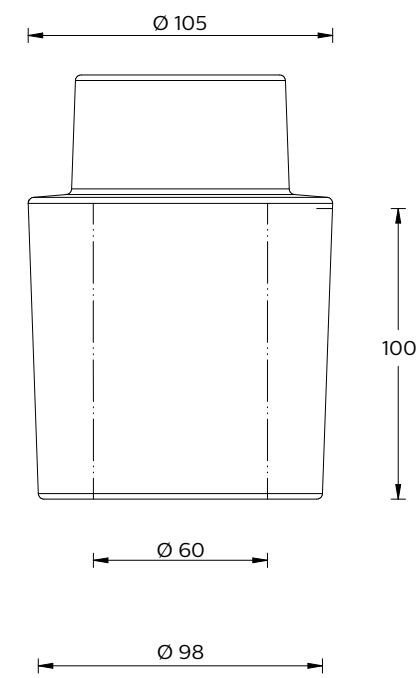
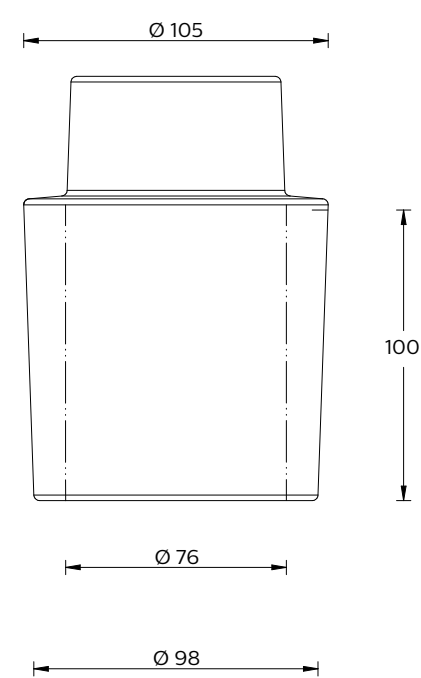

Brackets for Ø 60 poles

JGB795 MBP-T 750 60

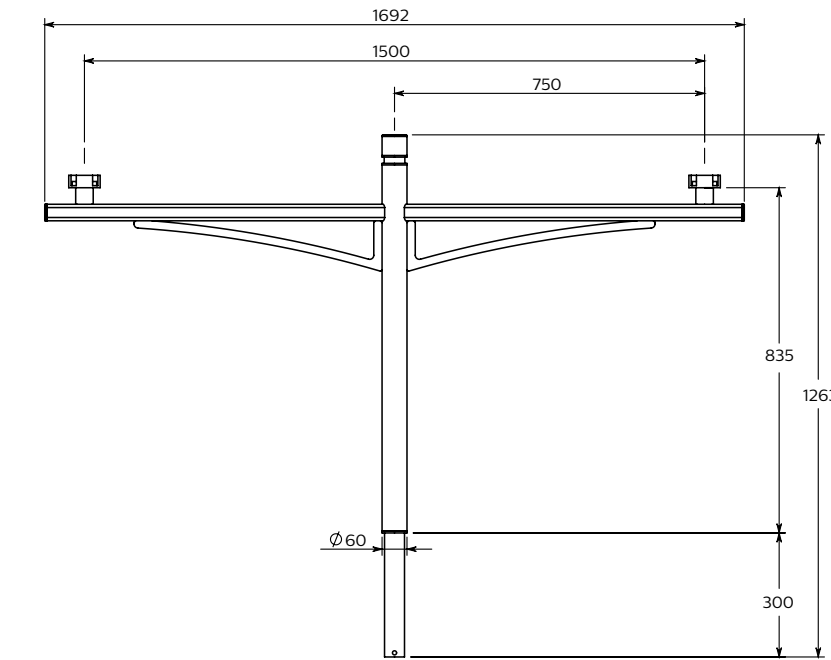

JGB795 MBP-S 750 60

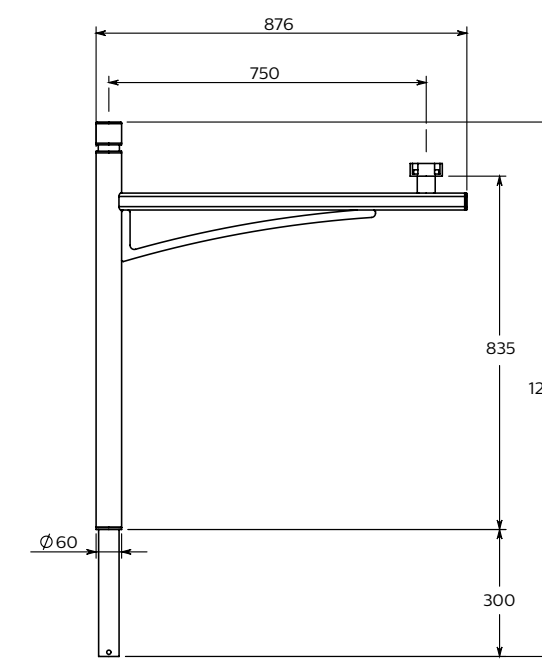

JGB794 MBP-T 750 60

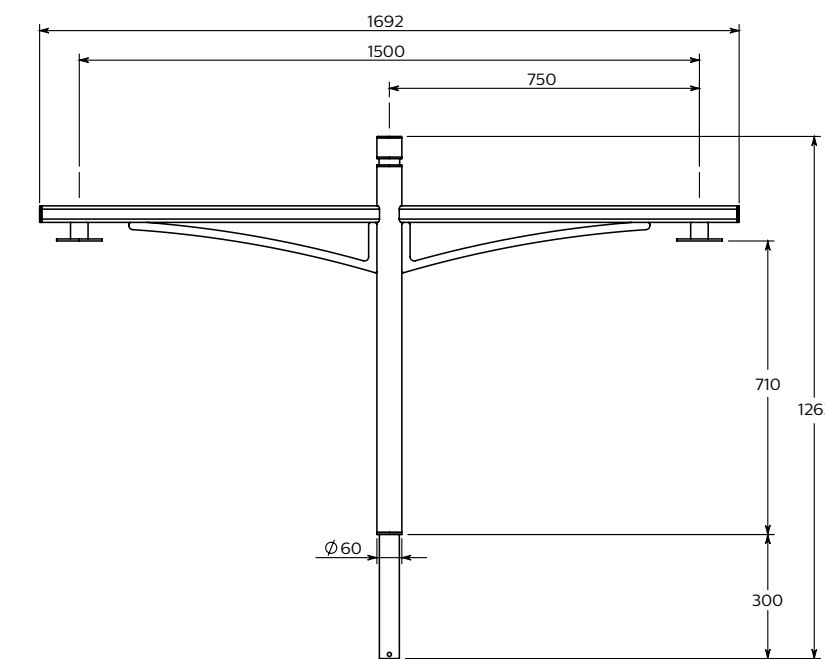

JGB794 MBP-S 750 60

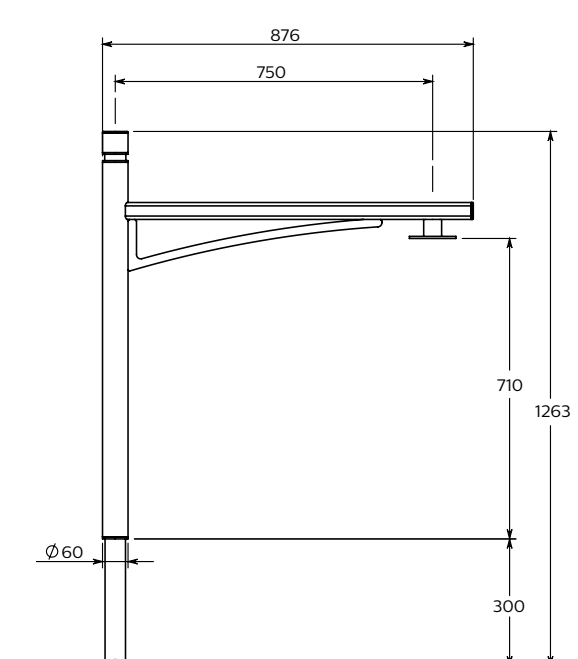

JGB795 MBW 750

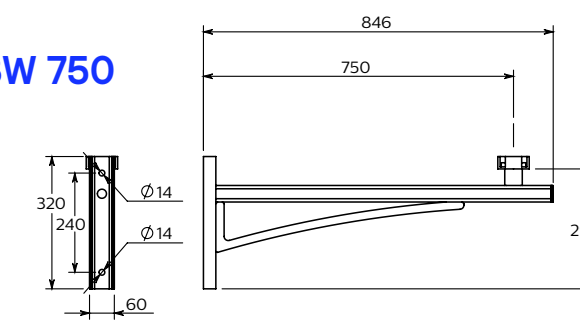

JGB794 MBW 750

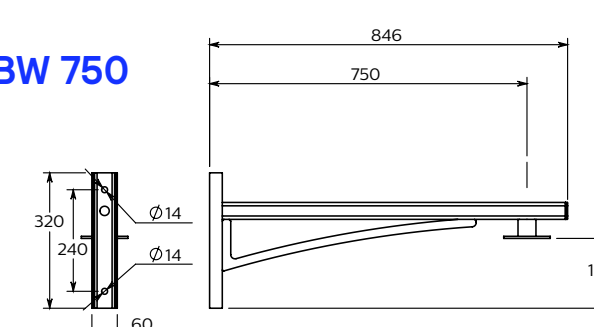

Dimensional drawings

Brackets for Ø 76 poles

JGB795 MBP-S 750 76

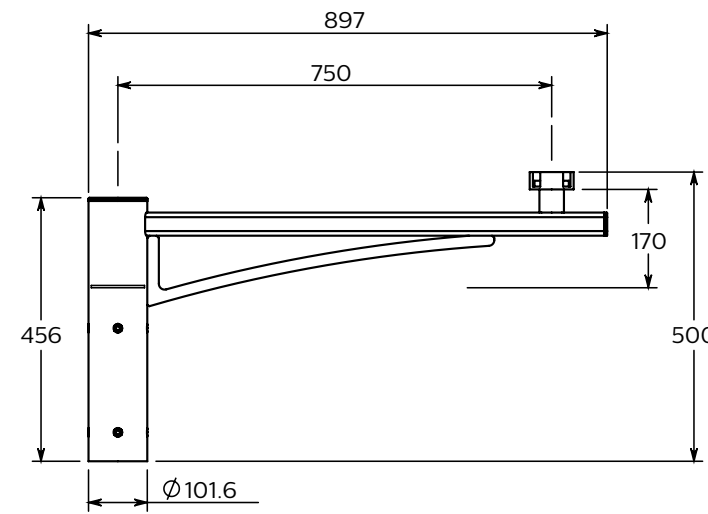

JGB795 MBP-S 750 76

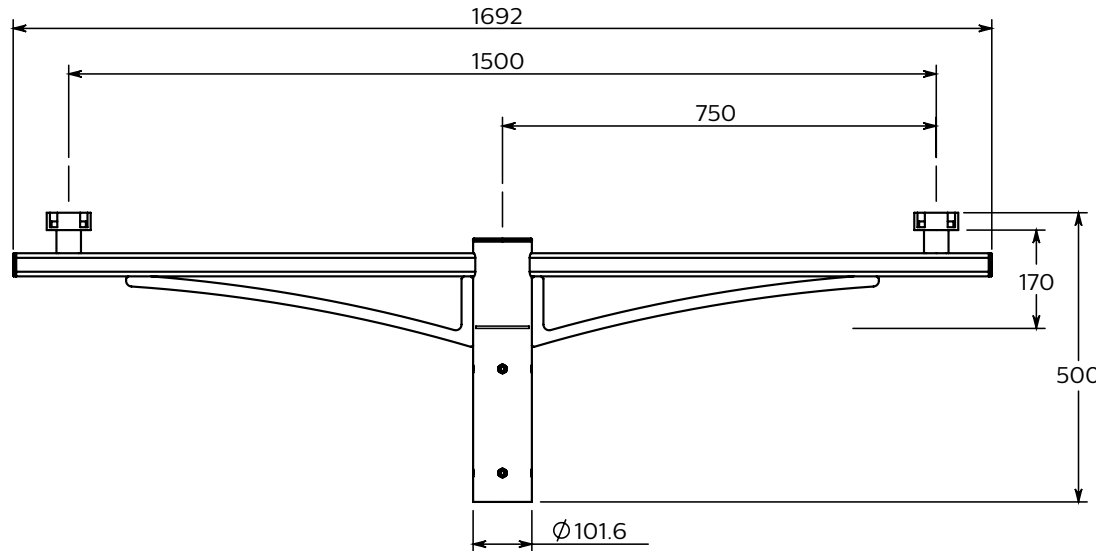

JGB794 MBP-S 750 76

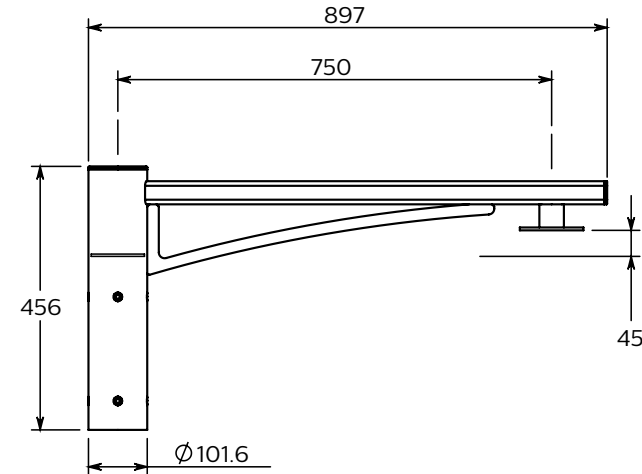

JGB794 MBP-T 750 76

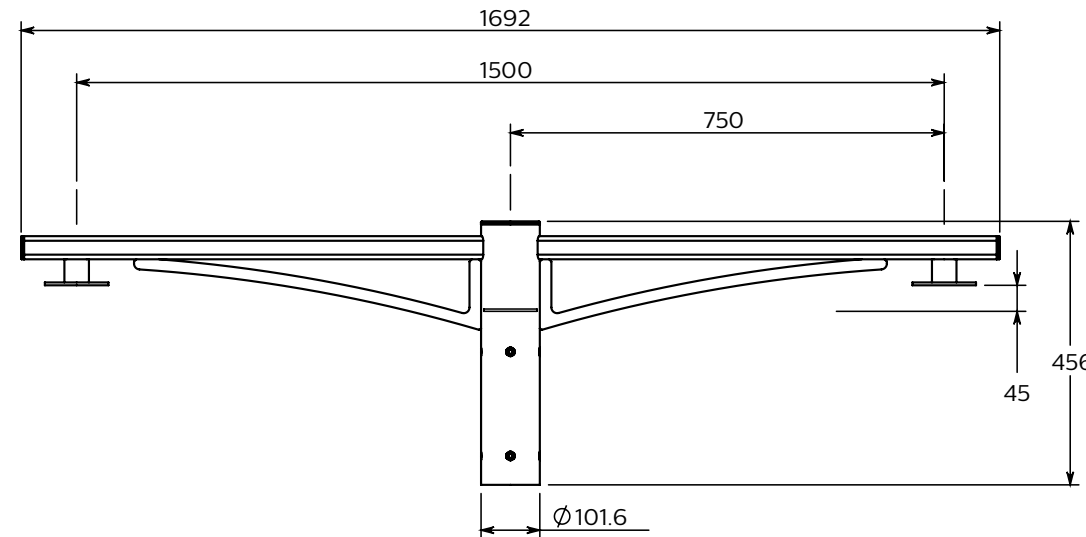

Faro applique pole

YHM700

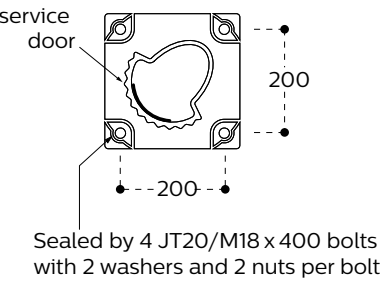
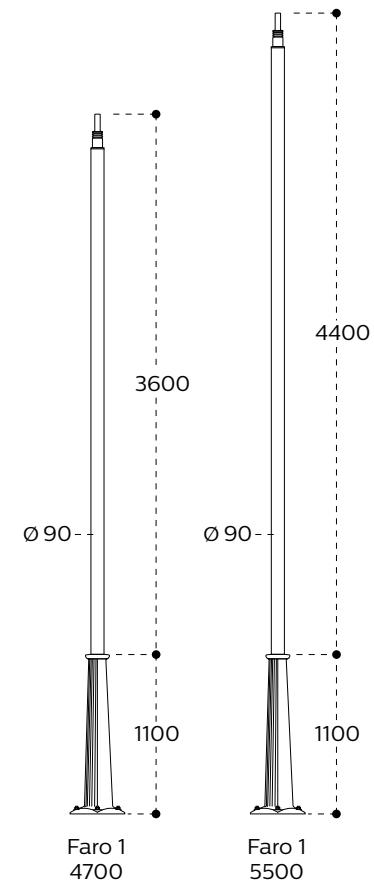

Faro post-top pole

YHM702

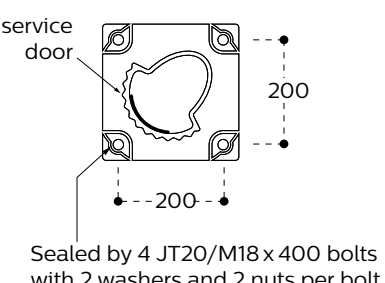
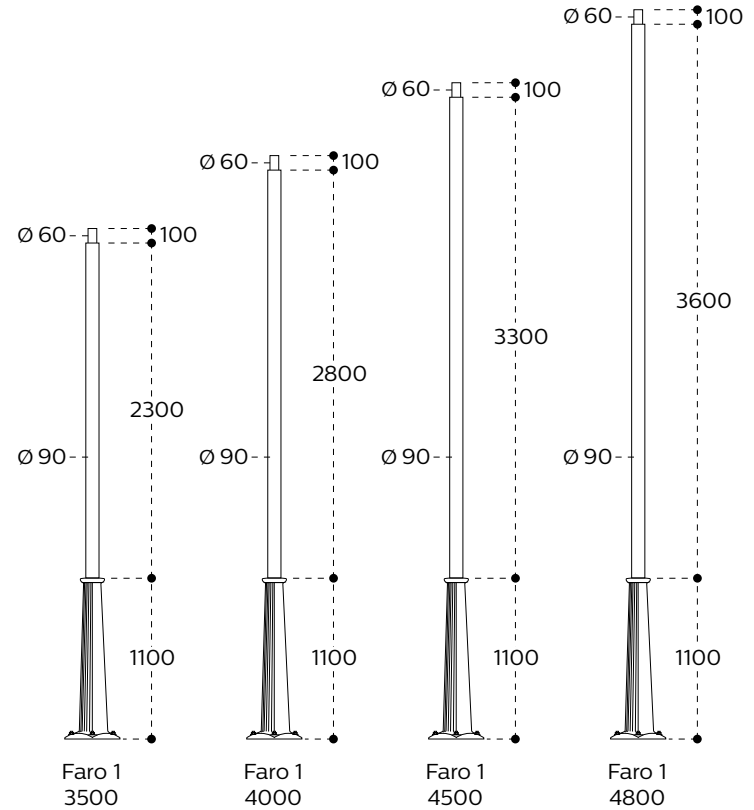

Faro brackets

40 bracket - JGP700 MBP 400

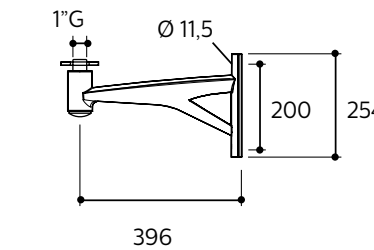

70 bracket - JGP700 MBP 700

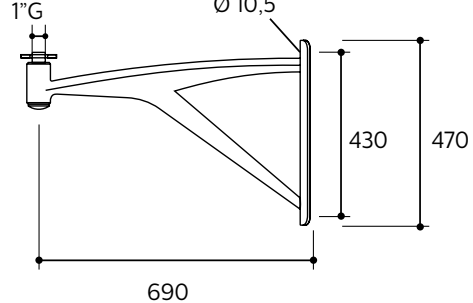

90 bracket - JGP700 MBP 900

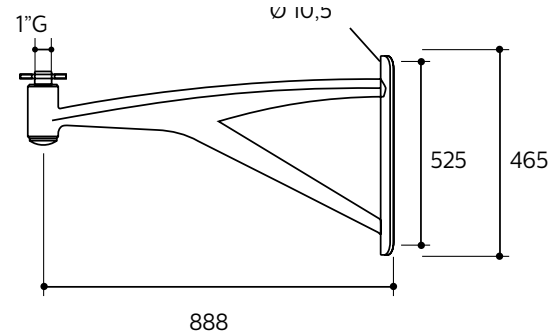

Product specifications

Type	BDP794 (post-top version) BSP794 (suspended version) BPP794 (post-top version for dedicated bracket) BVP794 (suspended version for dedicated bracket)
Correlated Color Temperature	2200K, 2700K, 3000K, 4000K
Color Rendering Index	80, 70
Luminous flux (source flux)	1,800 - 11,500 depending on configuration
Power	10 W - 67 W depending on configuration
Luminaire efficacy	Up to 128 lm/W
Useful life	100,000 hours at L90B10 minimum
Optic	Distribution medium (DM, DN), pedestrian crossing, symmetrical, wide and extra wide, louver
Optical cover	Tempered flat glass clear (FG), diffusing flat glass (GF) (optional)
Warranty	5 years
Installation	Post-top: 60 and 76 mm, suspended 1'G
CLO	Available

Connectivity	Interact, Signify outdoor multisensor
Driver	Xitanium driver
Operating temperature range	-40 °C < T _o < 50 °C
Mains voltage	220-240 V / 50-60 Hz
Electrical class	Class I and Class II
Color	Black 9005 or ultra-dark grey Other RAL and AKZO Futura colors available on request
IP rating	IP66
IK rating	IK09 clear flat glass, IK08 diffused flat glass
Weight	12.3 kg
Scx	0.15 m ²
Surge protection	6 kV (standard) - 10 kV (optional)
Certification	CE-ENEC-ENEC+

LED configurations

ClassicStreet 10 LED board:

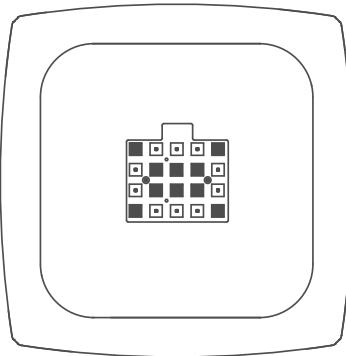

ClassicStreet 14 LED board:

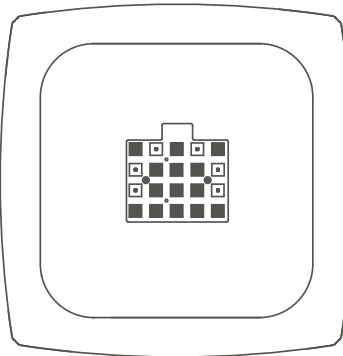

ClassicStreet 20 LED board:

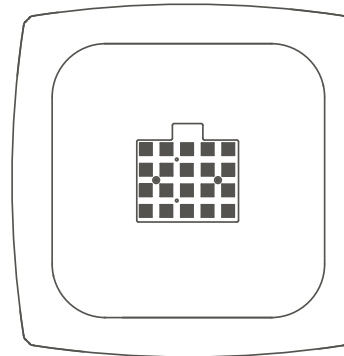

ClassicStreet 30 LED board:

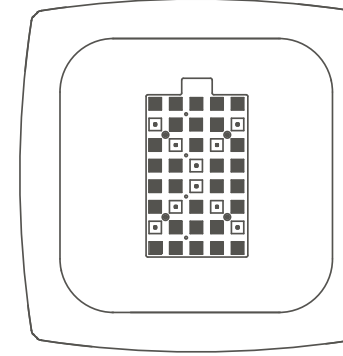

ClassicStreet 40 LED board:

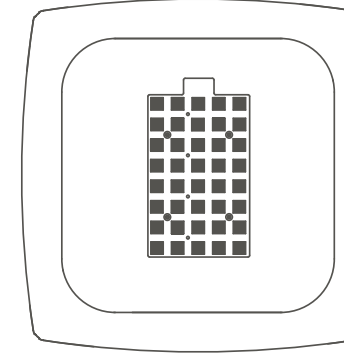

Specifications complete sets

Pole specifications	ClassicStreet bracket	Faro bracket
Material	Steel	Aluminum
Mounting to luminaire	Dedicated interface post-top or suspended	1" (34 PdG) post-top or suspended
Mounting to support	Single or double arm bracket tenon for pole top Ø 60 mm or cap for pole top Ø 76 mm	
	Pole mounting bracket with 2 points and fixing center 240 mm	Pole mounting bracket with 2 points and fixing center depending on bracket length (255 mm / 430 mm / 565 mm)
Tilt angle	0°	
Color	Black N9 (MN332L) or ultra-dark grey Other RAL and AKZO Futura colors available on request Other RAL or AKZO colors available on request	
Certification	CE certification in accordance with standard EN40	

Bracket specifications	Faro post-top pole	Faro applique pole
Material	Aluminum	
Pole height	3.5 m, 4 m, 4.5 m and 4.8 m	4.7 m and 5.5 m
Installation type	Flange plate	
Color	Black 9005 or ultra-dark grey Other RAL and AKZO Futura colors available on request	
Certification	CE certification in accordance with standard EN40	

You and Signify – a reliable partnership

Signify is the world leader in connected LED lighting systems, software and services. We proudly bring to market the best lighting brands in the world, including Signify, Philips and Interact.

We believe in close cooperation before, during, and after every project. Our local teams provide the support and information you need—with flexible, on-time delivery and reliable product availability.

To help you stay ahead, the [Signify Lighting Academy](#) offers a comprehensive range of educational resources to grow your expertise and earn certification.

Our global brands

Signify

Signify represents our commitment to sustainable innovation. As our leading brand for connected lighting systems, luminaires and components for the specification project business, Signify solutions serve the segments where we collaborate most closely with our customers.

Signify interact

Signify Interact is our IoT software platform for managing smart lighting systems and unlocking the value of the data they collect. Easy to install and configure, Interact supports a wide range of applications—from small offices to entire cities.

PHILIPS

Philips stands for quality and energy efficiency in lighting. It is our leading brand for innovative, off-the-shelf lighting products for professionals and consumers alike.

Get more info on our products, services and tools:

[signify.com/installers](https://www.signify.com/installers)

[signify.com/specifier](https://www.signify.com/specifier)



Driven by responsible innovation

Signify and the Mercedes-AMG PETRONAS F1 Team share a passion for technology and a desire to push the boundaries of what is possible.

Our innovations in lighting serve the well-being and performance of the team, deliver powerful experiences, both trackside and at home, and help the team pursue its ambition to become one of the most sustainable in sport.

Learn more at

[signify.com/partnership](https://www.signify.com/partnership)

Signify is Official Lighting Partner of Mercedes-AMG PETRONAS F1 Team

 Signify



Official Lighting Partner



the meaning of light