

Pureline Slim 50mm

SP780/780X

Mounting Instruction

4415 109 28500

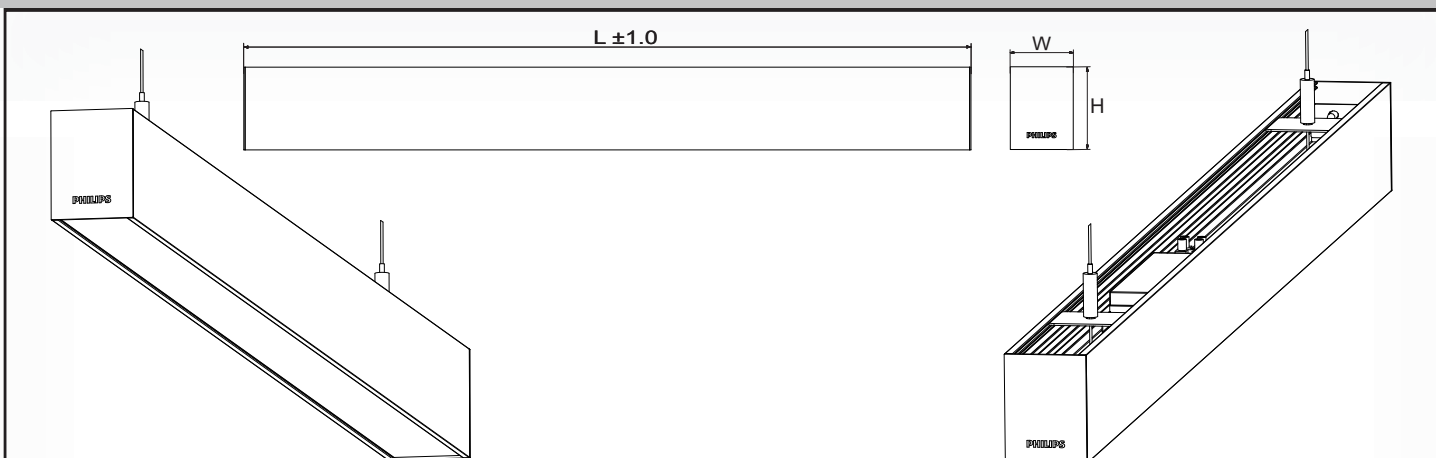
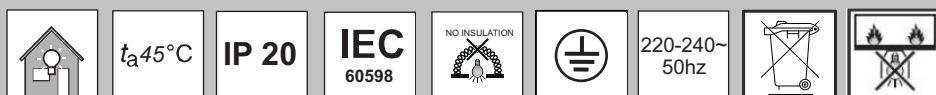

Type	Dimensions L x W x H mm	Voltage	Frequency	Kg
SP780 H W5L112	1126 x 53 x 70	220-240V~	50Hz	1.9
SP780X H W5L112	1126 x 53 x 70	220-240V~	50Hz	1.9
SP780 H W5L168	1686 x 53 x 70	220-240V~	50Hz	2.6
SP780X H W5L168	1686 x 53 x 70	220-240V~	50Hz	2.6
SP780 H W5L224	2248 x 53 x 70	220-240V~	50Hz	3.8
SP780X H W5L224	2248 x 53 x 70	220-240V~	50Hz	3.8

Legend	
SP	Suspended Mounting
780	Down Standalone Version
780X	Down Continuous Version
H	H Section
OD	Opaque Version
OC	Prismatic Version
W5	Width 53mm
L112	Length 4 Feet
L168	Length 6 Feet
L224	Length 8 Feet

1 Suspension Cable adjustment

IMPORTANT: Do not force cable into adjuster. To insert cable into adjuster, follow the steps below.

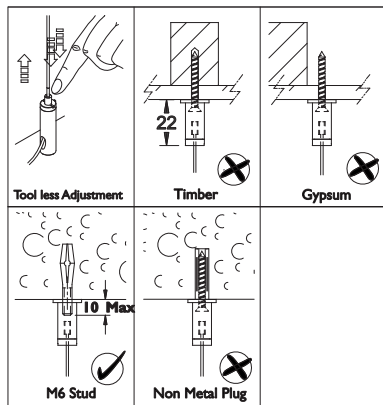

1. CUT

If required, cut cables ends cleanly prior to inserting into adjuster.

2. INSERT

Carefully insert cable from top end. if cable does not insert easily or becomes jammed, use the release tool to remove tool to remove cable. Trim cable ends again and repeat process. **DO NOT BEND OR LOOP CABLE BELOW BOTTOM OF ADJUSTER.**

3. TEST

Once cable is inserted, apply a 12Kg point load to each mount bracket to ensure all connections are secure.

2 Suspension Cable fixing location (recommended)

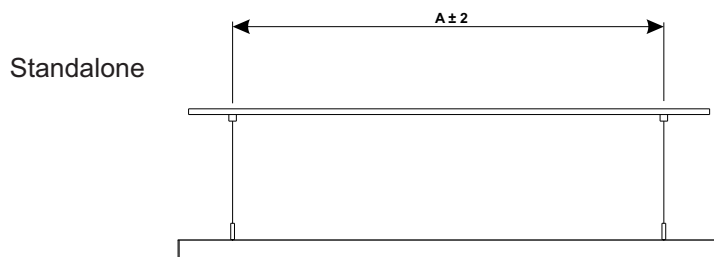

Continuous

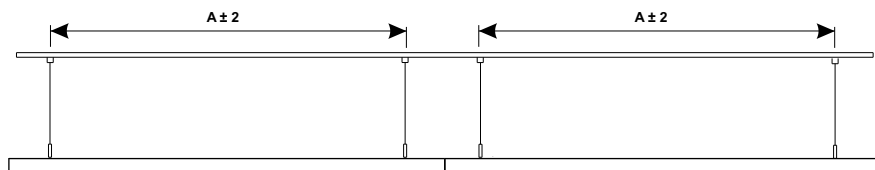

Continuous	No. of Suspensions	A
4' Version	2	800
6' Version	2	1360
8' Version	2	1900

Continuous	No. of Suspensions	A
4' Version	2	800
6' Version	2	1360
8' Version	2	1900

Supplied suspension cable length is 1m
All dimensions in mm

3 Luminaire mounting

A) For standalone version, fix the suspension wire with hex screw (Provided in Accessories bag) to suspension bracket. slide at desired location.

B) For continuous version, follow the process A.

C) For mounting height adjustment and to level the fixture , squeeze the tip of the bottom part and pull the suspension wire to desire height.

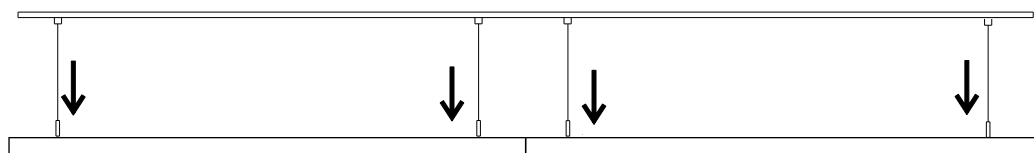

LEVEL VERTICALLY

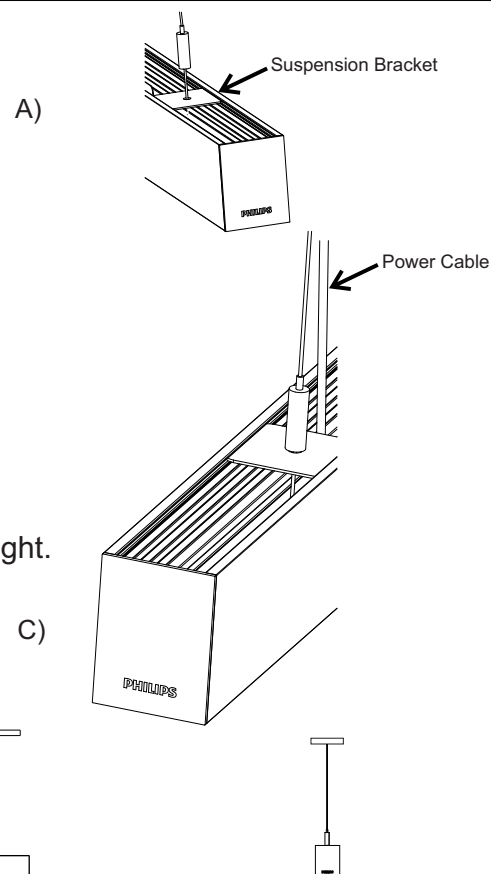

LEVEL HORIZONTAL

D) Ensure fixture is level end to end. Support fixture from below and use adjuster release tool to make final height adjustments. Check level by spirit level in both the planes, Horizontal and Vertical.

4 Joining of Luminaires - Continuous mounting

- 1) Both the suspended luminaires is connected in one movement as shown below and fix with M5 hex screw with nut (x2).

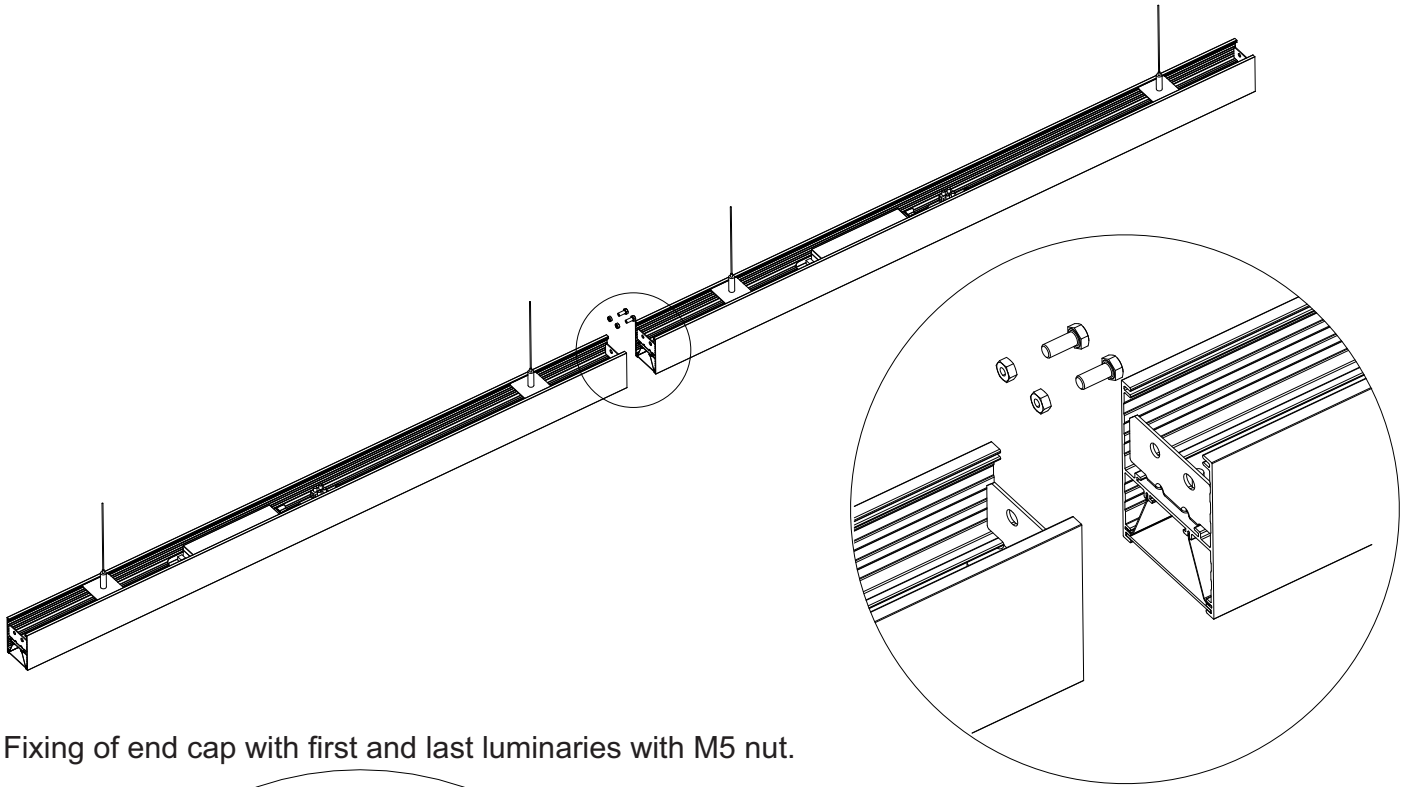

- 2) Fixing of end cap with first and last luminaires with M5 nut.

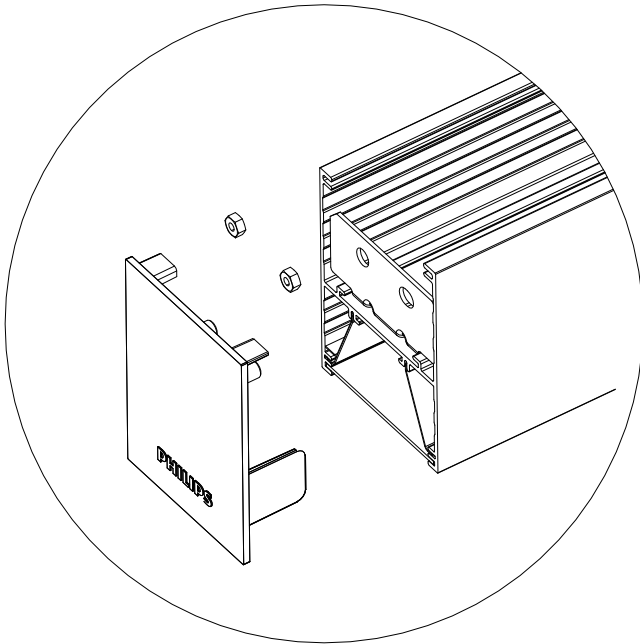

- 3) Complete electrical connections at joints by using supplied click connector .
Tuck the wire properly on the side or above the of bracket.

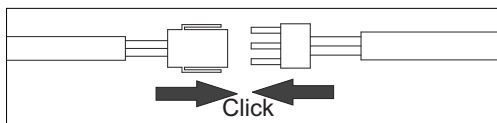

- 4) Pass the wire harness provided as accessory from the first fixture in the row and complete connection with click connector as above.

Notes: Turn off the power before installation to avoid possible electrical shock.

- 5) Raise the complete row of fixtures to ceiling with adequate support and at each end of the module, insert suspension cables into fixture and ensure fixtures are vertically and horizontally as per the installation instructions for suspension cable supplied.

Supply Connection (Place Driver plate assembly behind the ceiling after connection)

Connect the transparent cable from luminaire with 3-Pole connector on driver output side, LED+, LED- (DC power supply), and earth connection.

Connect mains supply cable (AC power) with the 3-Pole connector on the driver plate.(L-N-E)

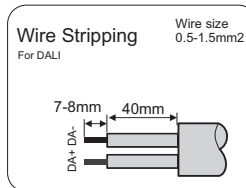
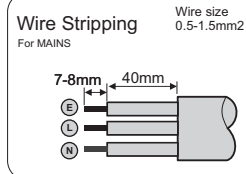

Mains Connections for PSU series

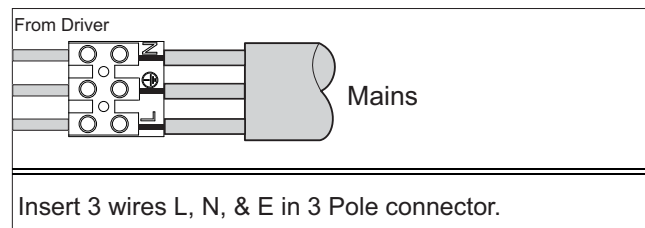

NOTE: DO NOT OPEN ANY OTHER SCREWS
(open only Connector screws)

Mains Connections for PSD series

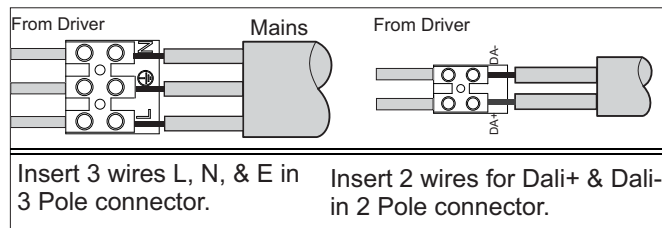

Caution

1. "The light source of this luminaire is not replaceable. when the light source reaches its end of life the whole luminaire shall be replaced".



2. Do not stare at the operating light source.
3. If the external flexible cable or cord of this luminaire is damaged, it shall be exclusively replaced by the manufacturer or his service agent or a similar qualified person in order to avoid a hazard.

Warning



1. Choosing an appropriate fixing to suit the mounting surface is the responsibility of the installer.
2. The luminaire shall be installed by a qualified electrician and wired in accordance with the latest IEE electrical regulations or the national requirements.
3. The luminaire should be earthened properly for Safety and Performance.
4. Do not switch on before complete installation.

Maintenance

Ensure power supply is switched off before attempting any maintenance work.

The luminaire must be used within the applicable product specifications, installation instruction and environmental conditions for storage & operations according to application guidelines provided by Signify for product warranty to be valid.