

Installation Guide

— Philips CorePro LEDtube Mains T5

Installation Guidance:

Fluorescent tubes with HF ballast system can be simply replaced by this Philips TLED and fluorescent starter to Philips LEDtube starter (EMP)* and starter holder.



Packing Incl. Philips LEDtube starter (EMP)



LED starter holder (to fix the LED Starter)
Replace starter type:
Philips LEDtube starter T5

Packaging list:
Philips LED tube 1 pc
Warning sticker 1 pc
EMP starter 1 pc
Starter holder 1 pc

SYMBOL	MEANING
	DO NOT USE WITH DIMMERS
	NEED TO BE USED WITH LED REPLACEMENT STARTER EMP
	NEED TO BE USED IN DRY CONDITIONS OR IN A LUMINAIRE THAT PROVIDES PROTECTION



•Product is not for use in emergency luminaires or exit lights designed for double-capped fluorescent lamps

•Philips LEDtube is designed to fit in standard IEC compliant G5 bi-pin lampholders.

DISCLAIMER:

Signify does not accept any liability for any damages for installations not performed according to this guide or not performed by a qualified electrician.



Please inform yourself about the local waste disposal, separation and collection system for electrical and electronic products and packaging. Please act according to your local rules and do not dispose your old product and packaging with your normal household waste. The correct disposal of the packaging, your product and/or batteries will help prevent potential negative consequences for the environment and human health. Batteries should be disposed separately from the municipal waste stream via designated collection facilities. When disposing a product that contains non-user replaceable batteries, the non-user replaceable batteries shall be removed by a professional.

© 2025 Signify Holding

©ignify

All rights reserved. Reproduction in whole or in part is prohibited without the prior written consent of the copyright owner. The information presented in this document does not form part of any quotation or contract, is believed to be accurate and reliable and may be changed without notice. No liability will be accepted by the publisher for any consequence of its use. Publication thereof does not convey nor imply any license under patent or other industrial or intellectual property rights. Philips and the Philips Shield Emblem are registered trademarks of Koninklijke Philips N.V. and are used under license

06/2025

www.philips.com/lighting

3241 663 14861

Installation on Direct Mains

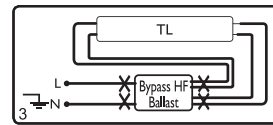
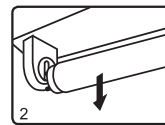
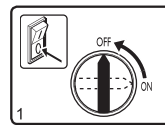

HF (High Frequency Electronic Ballast) Ballast based System

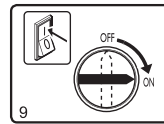
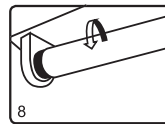
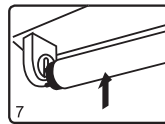
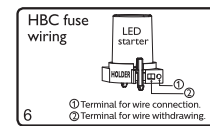
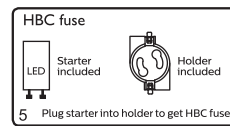
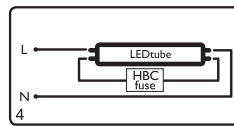

This fixture has been modified and can no longer operate the originally specified FL.

WARNING:The manufacturer of the original luminaire will no longer be responsible for the compliance of the modified product. Any modifications made to the original luminaire may alter the safety aspects of the original luminaire; hence compliance assessments of the original luminaire may no longer be applicable to the modified luminaire.

WARNING:The supplied warning sticker shall be placed on the luminaire and shall be visible during lamp replacement.

WARNING:A fuse shall be used to protect a fluorescent lamp that is inadvertently installed against short circuits.

Each fuse shall—
(a) be of the 250V HBC type;
(b) have a 2 A max. quick-acting type rating; and
(c) be used to protect a maximum of two lamps.
NOTE: A quick-acting type fuse is defined in the IEC 60127 series as 'Type F'.
The luminaire shall have a fuse replacement rating label.
WARNING:The rating of the lamp shall not exceed the maximum wattage of the lamp that it is intended to replace or the total wattage of the replacement lamps shall not exceed the maximum wattage of the luminaire.

Warning - This lamp may not be suitable for use in all applications where a traditional fluorescent lamp has been used. The temperature range of this lamp is more restricted. In cases of doubt regarding the suitability of the application the manufacturer of this lamp should be consulted. This lamp is designed for general lighting service (excluding e.g. explosive atmospheres).

NOTE: Manufacturers should specify minimum requirements for the operations of their lamps, including spacing, enclosure design and temperature limitations.

Signify Australia Limited
65 Epping Road, North Ryde,
NSW, 2113 Australia
Toll Free number: 1300 304 040
www.philips.com/lighting

Signify New Zealand Limited
123 Carlton Gore Road
Newmarket, Auckland 1023
New Zealand
Tel: 0800 4 LAMPS (52677)



PHILIPS