

PHILIPS

**FlexBlend
Surface-Mounted,
Suspended**

**SM340C
SP340P**

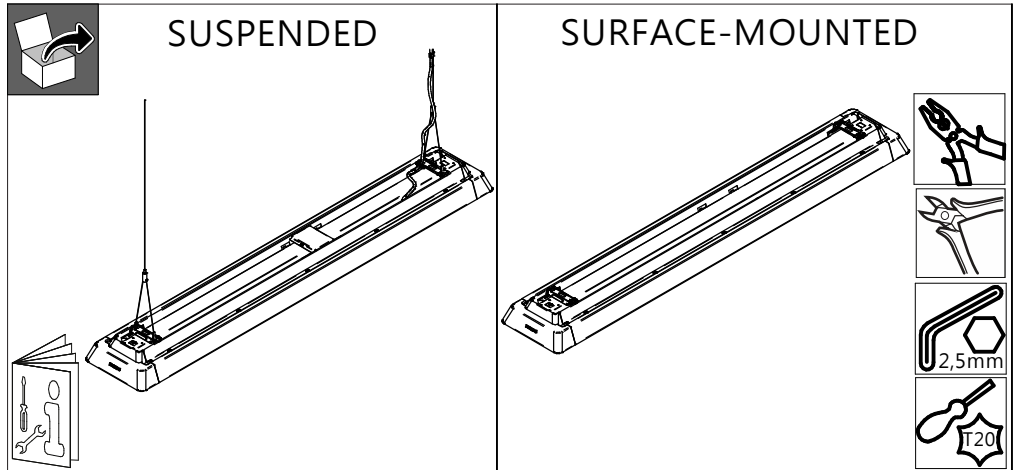

Emergency Lighting Installation instructions



	Glow Wire
MLO	650°C
PCS/OPAL	850°C

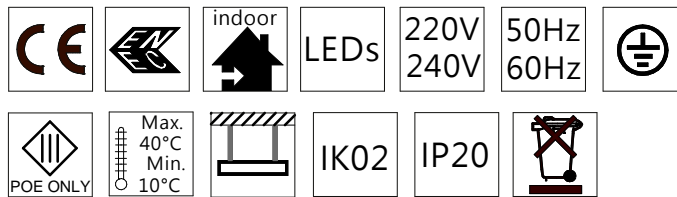

1 Date of instalation

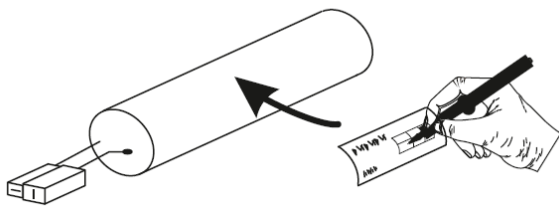

2 Log book

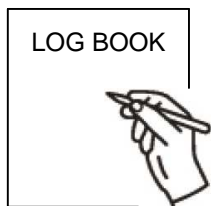

TEST HIGH VOLTAGE: MAX. 1500 V

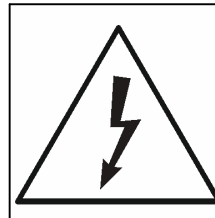

3

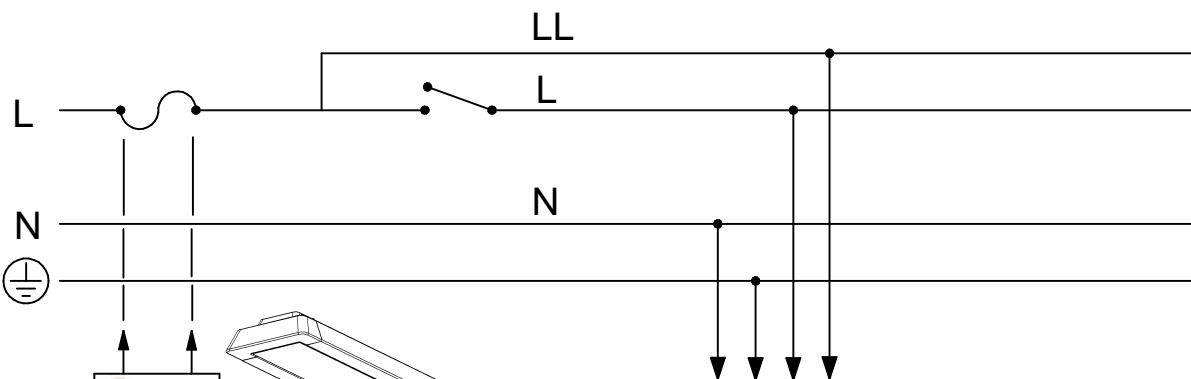

4

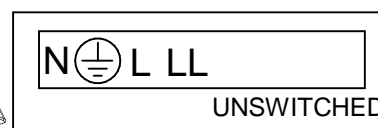
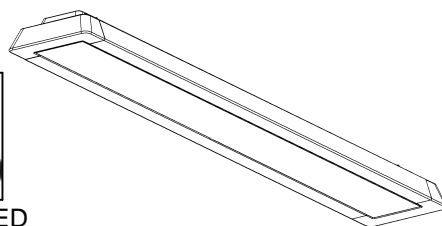
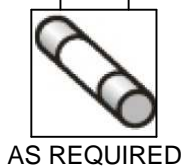

5 Charge time

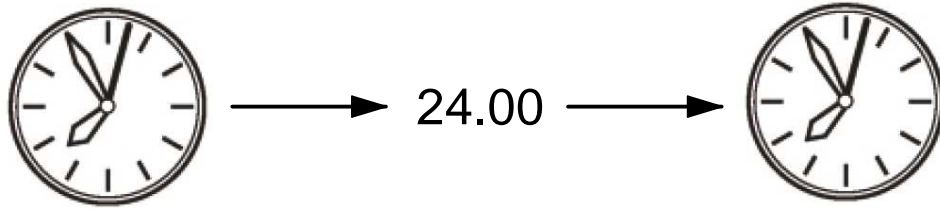

6 Test minimum 5 seconds

7 Battery replacement instruction

7a

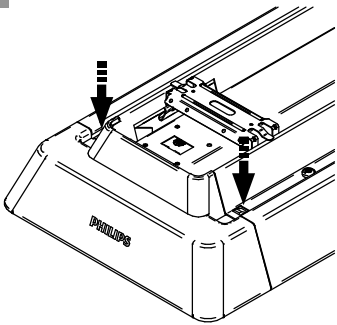

7b

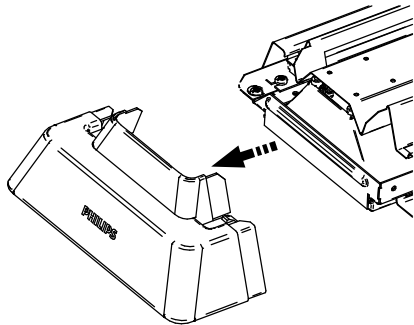

7c

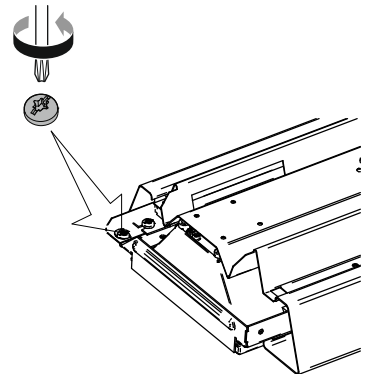

7d

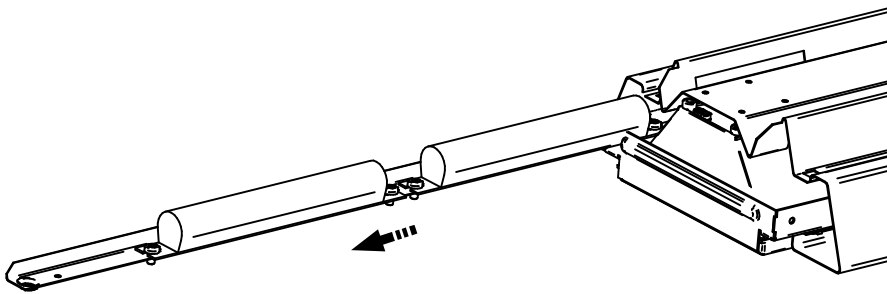

7e

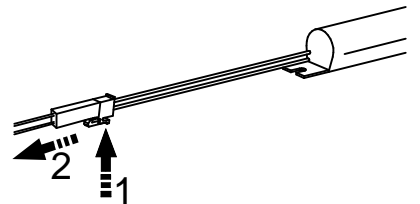

7f

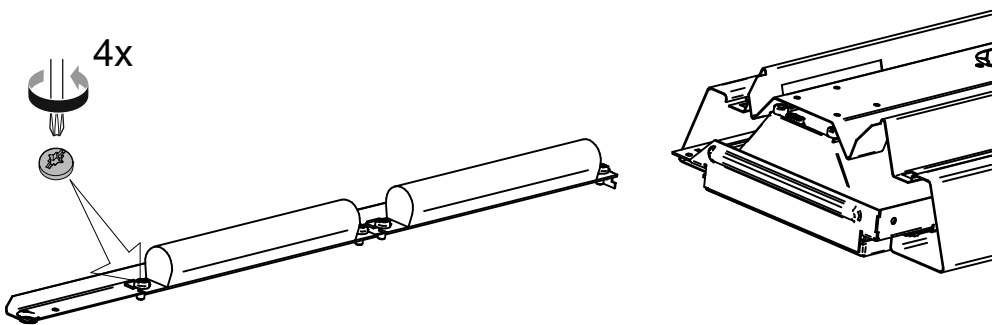

7g

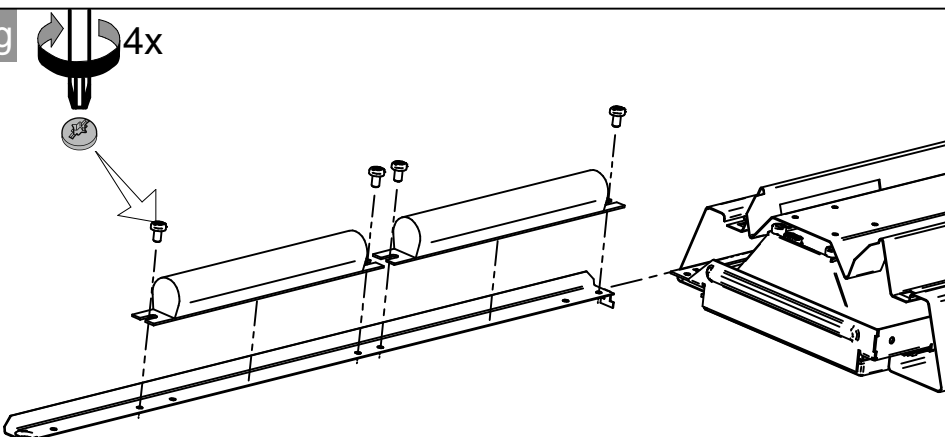

7h

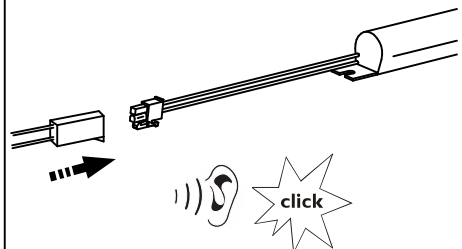

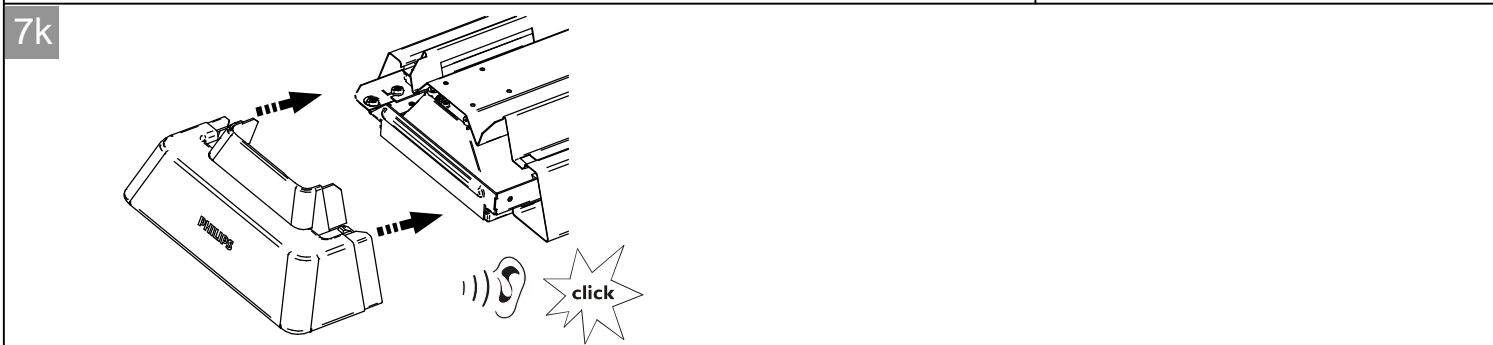
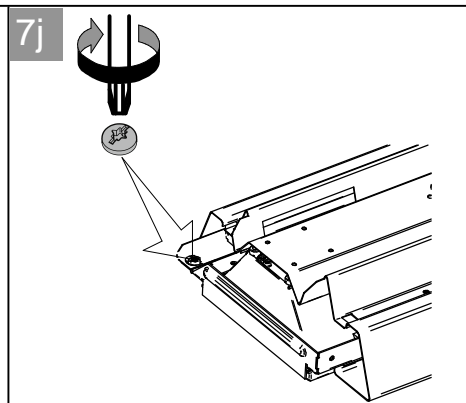
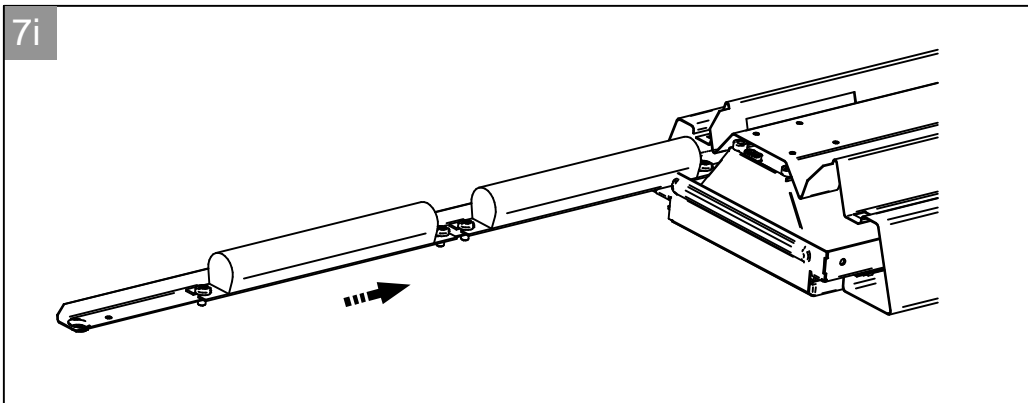

8 Electrical connection for Suspended version

2x

min. 5x0.5mm²
max. 5x2.5mm²

BROWN
GREEN/YELLOW
BLUE
BLACK
GRAY

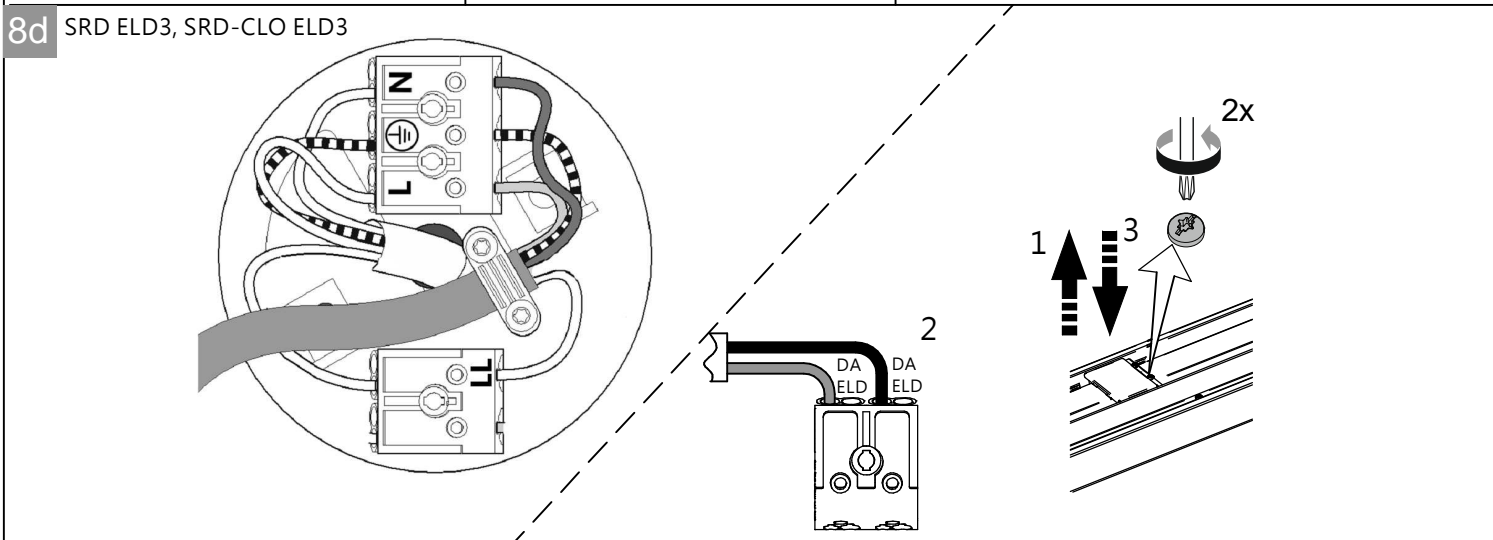
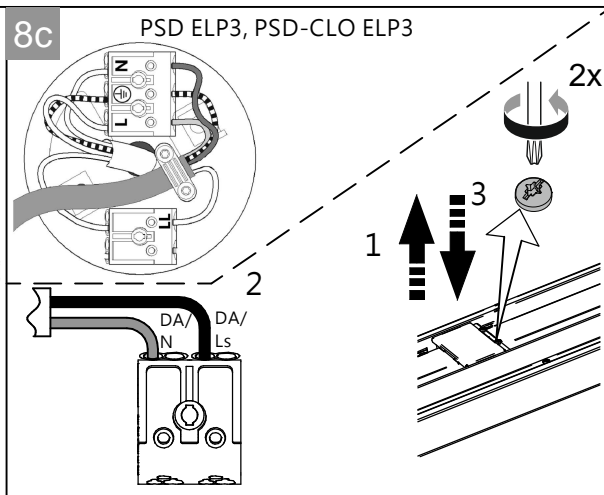
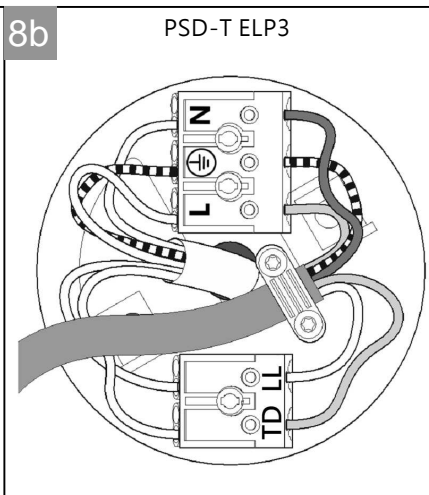
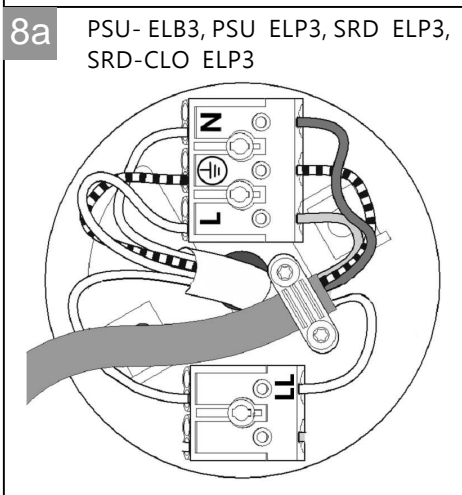

8e PSD-T ELD3

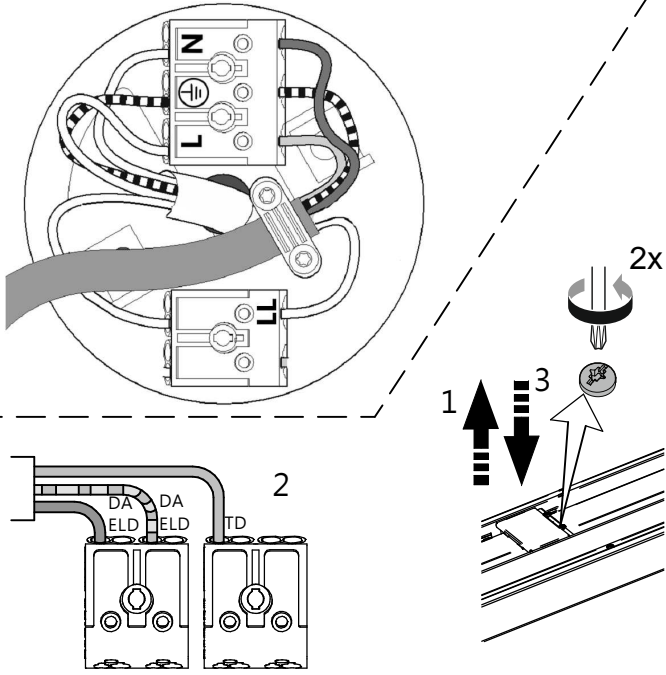

8f PSD ELD3, PSD-CLO ELD3

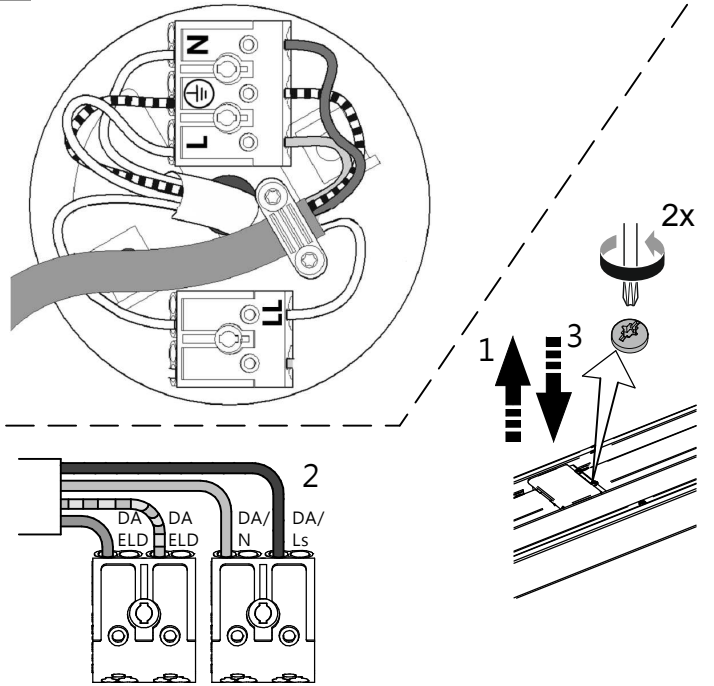

9 Electrical connection for Surface Mounted version

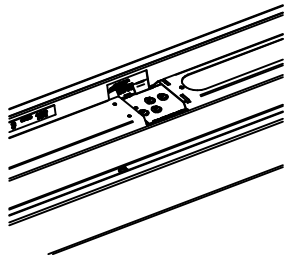
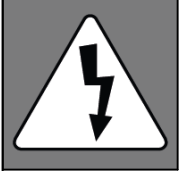

min. 5x0.5mm²
max. 5x2.5mm²

BROWN
GREEN/YELLOW
BLUE
BLACK
GRAY

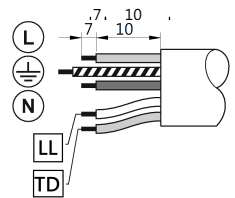

9a PSU- ELB3, PSU ELP3, SRD ELP3, SRD-CLO ELP3

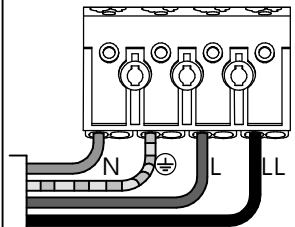

9b PSD-T ELP3

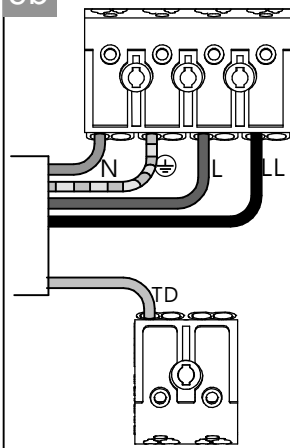

9c PSD ELP3, PSD-CLO ELP3

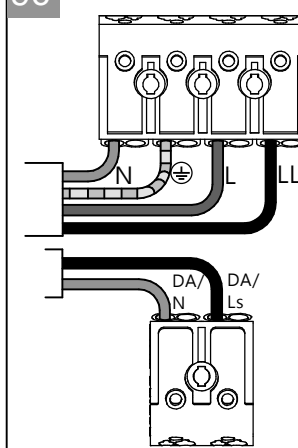

9d SRD ELD3, SRD-CLO ELD3

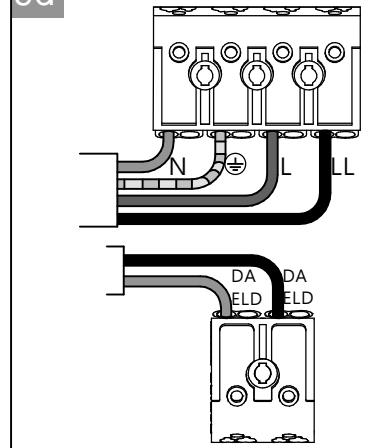

9e PSD-T ELD3

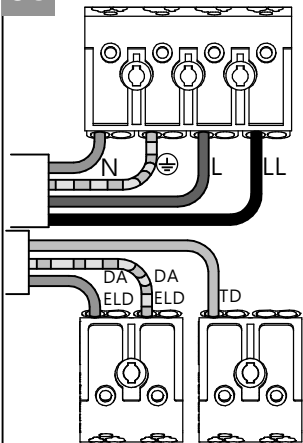

9f PSD ELD3, PSD-CLO ELD3

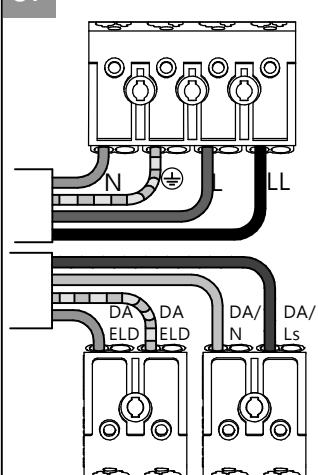

9g Interact Office Wired (PoE ELE 1/3)

Condition Philips to specify to the customers (instruction):
> to use UTP (Unshielded Twisted Pair) CAT5E or CAT6 cable
> the maximum length of the cable to be 20 meters.
Apply a minimum radius of the Ethernet cable of 4x the cable diameter.

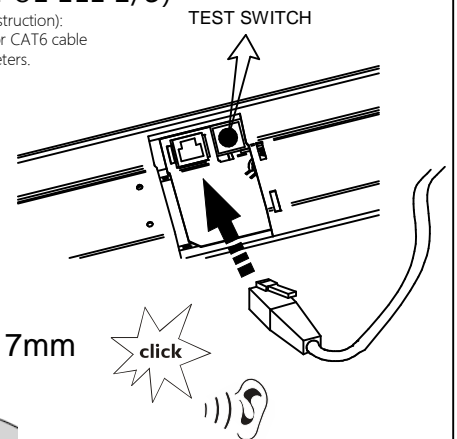
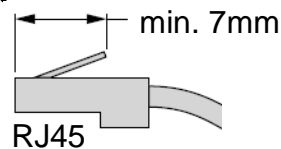
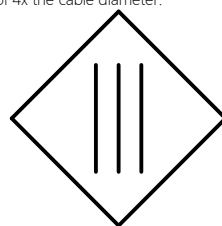

Emergency Light type	Driver		Duration	Number of battery cells	Nominal voltage	Rated lumen output	Symbol
	type	power					
On board integrated EL*	TrustSight BASIC	3-5W	3 h	I NIMH 4,8V 4.0Ah 19.2Wh	220...240V 50/60Hz	PCS=500lm/3hrs MLO/O=400lm/3hrs	ELB3
	TrustSight PRO	3-5W	3 h	I NIMH 4,8V 4.0Ah 19.2Wh	220...240V 50/60Hz		ELP3
	TrustSight DALI	3-5W	3 h	I NIMH 4,8V 4.0Ah 19.2Wh	220...240V 50/60Hz		ELD3
	ILB EM LED Driver	3W	3 h	NiMH 7.2V 2500mAh	16...38V 50/60Hz	ELE3	
	ILB EM LED Driver	6W	1 h	NiMH 7.2V 2500mAh	16...38V 50/60Hz	PCS=500lm/1hrs MLO/O=400lm/1hrs	ELE1

* LED indicators status

LED indicator (colour / flashing)	Error condition	Cause	Solution
Green / no		System OK, battery fully charged	
no indication		mains off, EM mode, Rest mode, test in progress	
Green / slow		System OK, battery is charging	
Green / fast		System OK, recently tested (< 5 days, Australia mode only)	
RED / no	Battery voltage too high or too low	No battery connected	Connect a battery
		Wrong or bad battery connected	Replace battery
RED / fast	Output voltage too low or too high	Wrong LED load connected	Connect a right load and perform functional test
		no load connected or output shorted	Connect a right load and perform functional test
RED / slow	Failed test due to battery	Battery end of life	Replace battery and perform a duration test.
		Charger failure	replace driver
		DALI identify device	

RED -Green/ fast

Fast flashing: $f = 2 \text{ Hz}$ (on-time = 250 ms, off-time = 250 ms)

Slow flashing: $f = 0.66 \text{ Hz}$ (on-time = 250 ms, off-time = 1250 ms)

Maintenance instructions

To assure the lighting quality of this unique LED lighting concept there are a few instructions regarding the maintenance of this LED luminaire:

- Do not touch electronic components!
Electronic components are under high voltage.
Electronic components are ESD sensitive.
- During installation or when maintaining the luminaire please use static free gloves to avoid marks on the luminaire.
- To remove dirt and spots use the following:
 - Dust: only use micro fiber cloths
 - Fingerprints, etc.: use a cleaner for synthetic materials with antistatic properties.
- Do not stare into the LED light beam.
- To avoid scratches and dirt on optical parts remove protective foil after installation.
- The luminaire shall be installed by a qualified electrician and wired in accordance with the latest IEE electrical regulations or the national requirements.
- The lightsource is not replaceable. In case of damage replace the luminaire.
- Driver insulation: Basic according to IEC 61847-1

