

PHILIPS

WL060V

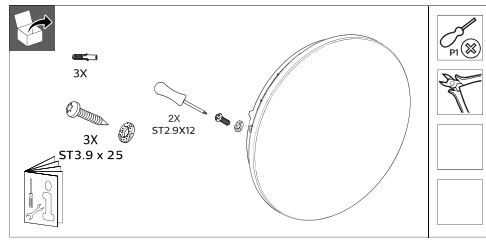

| | Light source of energy efficiency | | | | kg |
|-------------------|-----------------------------------|-------|-------|-----|-----|
| | System lumen (lm) | P (W) | class | | |
| WL060V LED11S | 1100 | 11 | D | 285 | 0.5 |
| WL060V LED17S | 1700 | 17 | E | 345 | 0.7 |
| WL060V LED17S MDU | 1700 | 19 | E | 240 | 0.7 |

Dimensions in mm



- The luminaire shall be installed by a qualified electrician and wired in accordance with the latest IEE electrical regulations or the national requirements.
 - This luminaire is not suitable for use as emergency lighting. The source contained in this luminaire shall only be replaced by the manufacturer or his service agent or a similar qualified person.

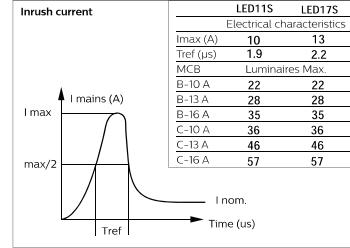
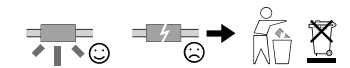

0000.000.00000
 ©2021 signify Holding. All rights reserved
 Printed in China
 Data subject to change without notice
 Keep for future reference: www.philips.com/lighting

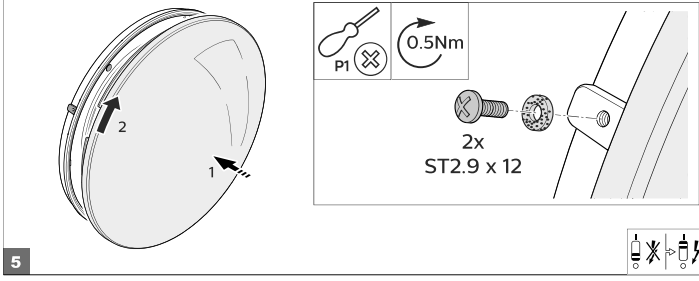
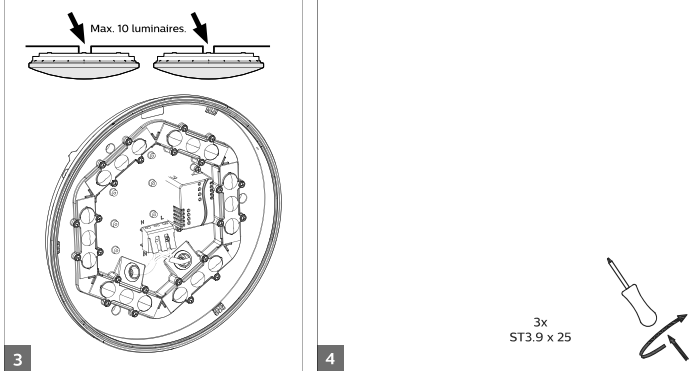
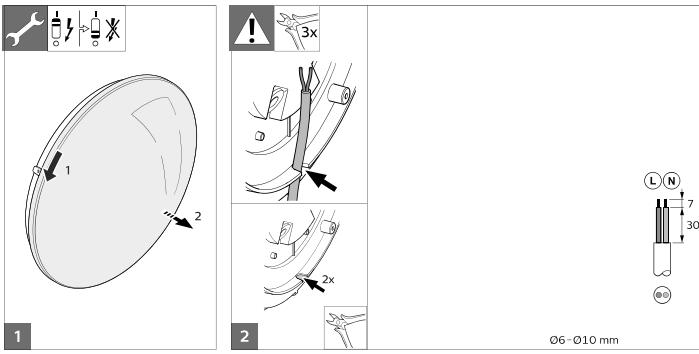

HF Motion Sensor (For WL0 0V LED17S MDU only)

By selecting the combination on the DIP switch, sensor data can be precisely set for each specific application.

| | 1 | |
|----|----|------|
| I | ON | 100% |
| II | - | 50% |

Detection area. (default 100%) show patterns.
 Detection area can be reduced by

| | 2 | 3 | |
|-----|----|----|-------|
| I | ON | ON | 5S |
| II | ON | - | 1min |
| III | - | ON | 5min |
| IV | - | - | 10min |

| | 4 | 5 | |
|-----|----|----|----------|
| I | ON | ON | 5Lux |
| II | ON | - | 25Lux |
| III | - | ON | 50Lux |
| IV | - | - | Disable* |

| | 8 | |
|----|----|-----|
| I | ON | 10% |
| II | - | 25% |

| | 6 | 7 | |
|-----|----|----|-------|
| I | ON | ON | 0S |
| II | ON | - | 1min |
| III | - | ON | 10min |
| IV | - | - | ∞ |

- The Ledinaire Wall-mounted needs to be installed side-by-side in the same direction. The distance between each of the luminaires should be kept at least 3m to avoid mutual interference.
- Please pay attention to the installation environment:
 - Avoid high-density objects such as: metal, glass, concrete walls, etc., within the sensor detection area.
 - Avoid moving signals within the sensor detection area such as: fan, DC motor, sewer pipe, air outlet, heavy rainfall, motion behind a thin wall etc. This to avoid false triggers of the sensor.
 - Avoid shock & vibration in the environment of the application.
- In order to reach the common sensor distance the object move speed should be less than 1m/S. If an object moves with speed higher than 1m/s the detection distance will decrease.
- It is advised not to install a luminaire on a wooden surface. In case it must be installed on a wooden surface, the wood thickness must be more than 15cm.
- To avoid smaller detection range or abnormal operation, the Ledinaire Wall-mounted should not be installed in close distance to large areas of metal and glass (separation distance at least 1 m). Please reduce detection area setting or contact Signify to confirm the situation once the Ledinaire Wall-mounted works fails.

