



The ultimate in retail flexibility and performance

StyliD Evo

With StyliD Evo, retailers can enjoy the superior quality of light and market-leading energy efficiency of PerfectAccent optics in a series of flexible and future-proof projectors. StyliD Evo projectors are easy to reconfigure with quick and easy optic upgrades that require no tools. They also support frequent changes in store layouts, as the StyliD Evo projector can be easily repositioned on the track or Maxos fusion backbone. Covering a wide range of lighting applications, from lower light levels in convenience formats to high-ceiling installations where very high light output is required, StyliD offers continuity for every retail concept. StyliD Evo can be mounted on 3C or DALI track (ST770T, ST780T), on Maxos fusion (ST770S, ST780S, ST770X), or into the ceiling with a semi-recessed version (ST770B). All StyliD Evo projectors with PerfectAccent reflectors are certified as a circular lighting product and offer multiple system integration and dimming options, including wired as well as wireless. For prolonged shelf life and better visual representation of food, reducing food waste and increasing sales, fresh food LED lighting recipes are available. Check out our Fashion and Food catalog pages to find out more about PremiumWhite, PremiumColor, Fresh Meat, Rosé, Frost and Champagne.

Benefits

- Attract shoppers with more sparkle and superior eye comfort
- Easy to reposition and upgrade for frequent store updates
- Best-in class efficacy to reduce carbon footprint and save on energy use
- Certified as circular lighting with PerfectAccent high-efficacy reflectors

StyliD Evo

Features

- Easy optic replacement or upgrades that require no tools
- Available with PerfectAccent high-efficacy reflectors
- Optional front glass (advised in dusty environments)
- Up to 6000 lm output for high installation heights
- Available with fresh food LED lighting recipes and LED flavors
- Wired (DALI) and wireless connectivity options
- High intensity oval beam allows increased luminaire spacing when lighting fresh food counters or wordmarks on the wall

Application

- Convenience stores
- Supermarkets & hypermarkets
- Large Retail formats

Warnings and Safety

- All photometrical data is calculated without optional front glass. Flux should be reduced by 3.5% when using a front glass
- Cleaning of the optic should only be done with pressurized air. Touching the LED or reflector is forbidden. For food preparation areas and areas with high levels of dust, the use of the optional front glass is strongly advised, as it can be cleaned with a (dry) microfiber cloth.
- During maintenance, the product must be switched off and cooled down
- The product must be installed out of arm's reach. Manipulating the product when hot is only possible with an insulated glove

Versions



StyliD Evo Compact ST770B white,
semi recessed



StyliD Evo Compact HR for maxos
fusion



StyliD Evo Performance ST780T
white, track version



StyliD Evo Compact ST770T black,
track version

Dimensional drawing

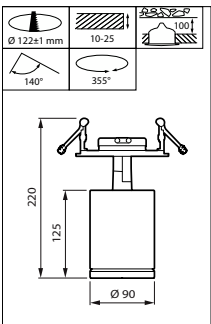
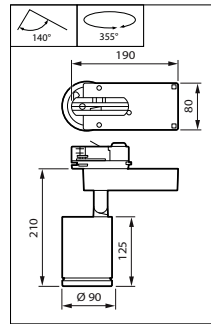
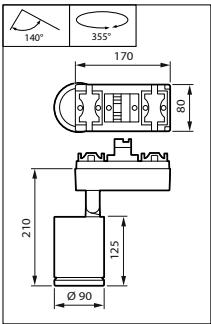
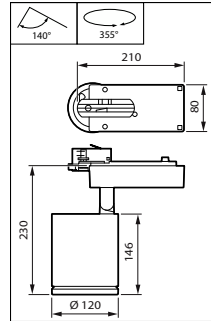
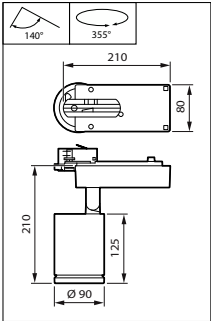

Product details



Aiming indication, with marking for Indoor Positioning operation



StyliD Evo Compact black, side view

StyliD Evo

Product details



Aiming indication, with marking for Indoor Positioning operation



StyliD Evo Compact white, side view



StyliD Evo ST770B semi recessed installation rim



OptiShield protects the optical compartment from bugs and dust



StyliD Evo Compact HR



StyliD Evo Compact in white, full rotation flexibility



StyliD Evo Compact white, front view



OptiShield protects the optical compartment from bugs and dust

StyliD Evo

Product details



Aiming indication, with marking for Indoor Positioning operation



StyliD Evo Performance white, side view



StyliD Evo Compact black, front view



StyliD Evo Performance white, front view



OptiShield protects the optical compartment from bugs and dust



StyliD Evo Exploded View



StyliD Evo Compact in black, full rotation flexibility



StyliD Evo Performance in white, full rotation flexibility

General Information

Driver included	Yes
Light source replaceable	No
Number of gear units	1 unit
Service tag	Yes

Light Technical

Beam angle of light source	120 degree(s)
----------------------------	---------------

Operating and Electrical

Protection class IEC	Safety class II
Input Voltage	220 to 240 V
Line Frequency	50 to 60 Hz
Suitable for random switching	No

Mechanical and Housing

Mech. impact protection code	IK02
Ingress protection code	IP20

Approval and Application

Ambient temperature range	+10 to +35 °C
CE mark	Yes
ENEC mark	ENEC mark
Flammability mark	For mounting on normally flammable surfaces
Glow-wire test	Temperature 650 °C, duration 30 s
Flickering value (PstLM) - Flickering value as per EN 61000-3-3	1
Stroboscopic effect visibility measure (SVM)	0.5

Initial Performance (IEC Compliant)

Luminous flux tolerance	+/-10%
-------------------------	--------

Light Technical (1/2)

Order Code	Full Product Name	Correlated Color	Color	Luminous Efficacy (rated) (Nom)	Luminous Flux
		Temperature (Nom)	rendering index (CRI)		
97669900	ST770B 39S/840 PSU-E VWB FG WH	4000 K	>80	147 lm/W	3,900 lm
97682800	ST770S 39S/930 DIA-VLC HWB BK	3000 K	>90	129 lm/W	3,900 lm
97755900	ST780T 49S/830 PSU MB FG WH	3000 K	>80	139 lm/W	4,900 lm
97698900	ST770T 27S/830 DIA-VLC OVL-H WH	3000 K	>80	131 lm/W	2,700 lm
97699600	ST770T 27S/830 PSU MB FG WH	3000 K	>80	136 lm/W	2,700 lm
97700900	ST770T 27S/840 PSU VWB FG WH	4000 K	>80	142 lm/W	2,700 lm
97713900	ST770T 39S/830 PSU MB FG WH	3000 K	>80	142 lm/W	3,900 lm
97693400	ST770T 17S/930 PSU MB FG BK	3000 K	>90	135 lm/W	1,700 lm
97708500	ST770T 27S/ROSE PSU MB FG BK	2200 K	>80	90 lm/W	2,800 lm

Light Technical (2/2)

Order Code	Full Product Name	Optic type	Order Code	Full Product Name	Optic type
97669900	ST770B 39S/840 PSU-E VWB FG WH	Very wide beam	97699600	ST770T 27S/830 PSU MB FG WH	Medium beam
97682800	ST770S 39S/930 DIA-VLC HWB BK	High-reflective metal reflector Wide beam 40 to 80 degrees	97700900	ST770T 27S/840 PSU VWB FG WH	Very wide beam
97755900	ST780T 49S/830 PSU MB FG WH	Medium beam	97713900	ST770T 39S/830 PSU MB FG WH	Medium beam
97698900	ST770T 27S/830 DIA-VLC OVL-H WH	Oval horizontal beam	97693400	ST770T 17S/930 PSU MB FG BK	Medium beam
			97708500	ST770T 27S/ROSE PSU MB FG BK	Medium beam

Operating and Electrical

Order Code	Full Product Name	Power Consumption	Order Code	Full Product Name	Power Consumption
97669900	ST770B 39S/840 PSU-E VWB FG WH	29 W	97698900	ST770T 27S/830 DIA-VLC OVL-H WH	20.5 W
97682800	ST770S 39S/930 DIA-VLC HWB BK	31.5 W	97699600	ST770T 27S/830 PSU MB FG WH	19.6 W
97755900	ST780T 49S/830 PSU MB FG WH	37.5 W	97700900	ST770T 27S/840 PSU VWB FG WH	19.6 W

Order Code	Full Product Name	Power Consumption
97713900	ST770T 39S/830 PSU MB FG WH	29 W
97693400	ST770T 17S/930 PSU MB FG BK	11.8 W

Order Code	Full Product Name	Power Consumption
97708500	ST770T 27S/ROSE PSU MB FG BK	31 W

Controls and Dimming

Order Code	Full Product Name	Dimmable	Maximum dim level
97669900	ST770B 39S/840 PSU-E VWB FG WH	No	Not applicable
97682800	ST770S 39S/930 DIA-VLC HWB BK	Yes	1%
97755900	ST780T 49S/830 PSU MB FG WH	No	Not applicable
97698900	ST770T 27S/830 DIA-VLC OVL-H WH	Yes	1%
97699600	ST770T 27S/830 PSU MB FG WH	No	Not applicable

Order Code	Full Product Name	Dimmable	Maximum dim level
97700900	ST770T 27S/840 PSU VWB FG WH	No	Not applicable
97713900	ST770T 39S/830 PSU MB FG WH	No	Not applicable
97693400	ST770T 17S/930 PSU MB FG BK	No	Not applicable
97708500	ST770T 27S/ROSE PSU MB FG BK	No	Not applicable

Mechanical and Housing

Order Code	Full Product Name	Housing Color
97669900	ST770B 39S/840 PSU-E VWB FG WH	White
97682800	ST770S 39S/930 DIA-VLC HWB BK	Black
97755900	ST780T 49S/830 PSU MB FG WH	White
97698900	ST770T 27S/830 DIA-VLC OVL-H WH	White
97699600	ST770T 27S/830 PSU MB FG WH	White

Order Code	Full Product Name	Housing Color
97700900	ST770T 27S/840 PSU VWB FG WH	White
97713900	ST770T 39S/830 PSU MB FG WH	White
97693400	ST770T 17S/930 PSU MB FG BK	Black
97708500	ST770T 27S/ROSE PSU MB FG BK	Black

Initial Performance (IEC Compliant)

Order Code	Full Product Name	Initial chromaticity
97669900	ST770B 39S/840 PSU-E VWB FG WH	(0.382,0.380)<3
97682800	ST770S 39S/930 DIA-VLC HWB BK	(0.434,0.403)<2
97755900	ST780T 49S/830 PSU MB FG WH	(0.434,0.403)<3
97698900	ST770T 27S/830 DIA-VLC OVL-H WH	(0.434,0.403)<3
97699600	ST770T 27S/830 PSU MB FG WH	(0.434,0.403)<3

Order Code	Full Product Name	Initial chromaticity
97700900	ST770T 27S/840 PSU VWB FG WH	(0.382,0.380)<3
97713900	ST770T 39S/830 PSU MB FG WH	(0.434,0.403)<3
97693400	ST770T 17S/930 PSU MB FG BK	(0.434,0.403)<2
97708500	ST770T 27S/ROSE PSU MB FG BK	(0.478,0.382)<2

Product Data

Order Code	Full Product Name	Product family code
97669900	ST770B 39S/840 PSU-E VWB FG WH	ST770B
97682800	ST770S 39S/930 DIA-VLC HWB BK	ST770S
97755900	ST780T 49S/830 PSU MB FG WH	ST780T
97698900	ST770T 27S/830 DIA-VLC OVL-H WH	ST770T
97699600	ST770T 27S/830 PSU MB FG WH	ST770T

Order Code	Full Product Name	Product family code
97700900	ST770T 27S/840 PSU VWB FG WH	ST770T
97713900	ST770T 39S/830 PSU MB FG WH	ST770T
97693400	ST770T 17S/930 PSU MB FG BK	ST770T
97708500	ST770T 27S/ROSE PSU MB FG BK	ST770T

Polar Wide Diagrams

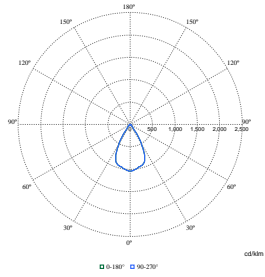

Polar Normal (separate) - ST770TI - 910505101224

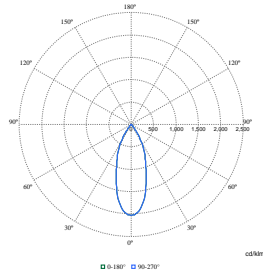

Polar Normal (separate) - ST770TI - 910505101368

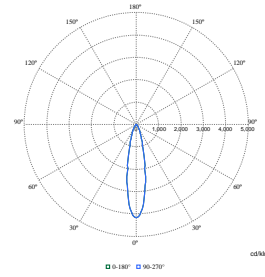

Polar Normal (separate) - ST770TI - 910505101384

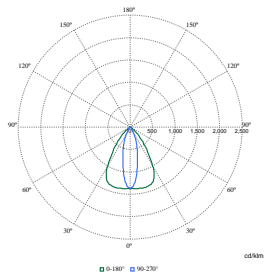

Polar Normal (separate) - ST770TI - 910505101383

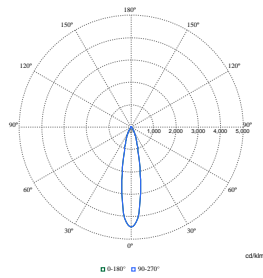

Polar Normal (separate) - ST780TI - 910505101441

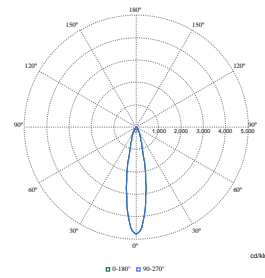

Polar Normal (separate) - ST770TI - 910505101378

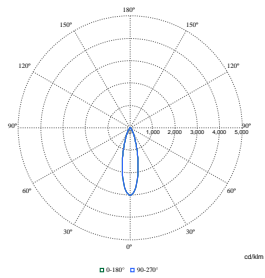

Polar Normal (separate) - ST770TI - 910505101393

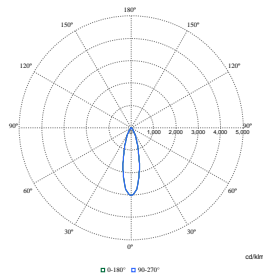

Polar Normal (separate) - ST770TI - 910505101398

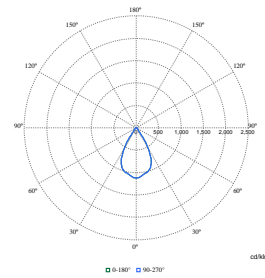

Polar Normal (separate) - ST770TI - 910505101385

