

# FlexBlend - Unlocking the potential of LED lighting in offices

## FlexBlend Recessed

Office owners and staff responsible for lighting operations are searching for high quality yet energy-efficient lighting that complies with norms and regulations. Designed to support these needs, Philips FlexBlend is enabling building owners to fully optimize their lighting operations, by offering office-compliant lighting with an attractive return on investment. Furthermore, FlexBlend provides the required flexibility by being easy applied on different ceiling types as well as in different office spaces like open office or meeting rooms. Though technology is changing fast, the ideal lighting solution is also expected to be ready to incorporate innovations and future advances that can help optimize operations further. For this reason, Philips FlexBlend is also ready to be connected to controls such as Actilume or used together with the Philips SpaceWise lighting system. It can also be connected to software-based lighting systems like Interact Office, which provides the luminaire with further intelligence and enables it to collect valuable data about its environment

### Benefits

- High-quality office-compliant lighting
- Choice of three different exit-windows
- Fast return on investment
- Application flexibility
- Scalable and ready to be connected to controls and lighting systems

# FlexBlend Recessed

## Features

- Fully office-compliant (UGR <19)
- Homogenous and uniform light effect
- Dimensional variety, local options
- Various mounting options
- Integrated sensors
- Can be combined with Philips ActiLume and SpaceWise systems
- Ready to be connected to software based lighting systems such as Interact Office

## Application

- Offices
- Education
- Healthcare
- Banks

## Versions



FlexBlend Recessed-RC340B  
W30L120 MLO VPC



FlexBlend Recessed RC340B  
W60L60 PCS VPC

## Dimensional drawing

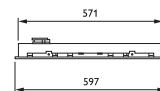
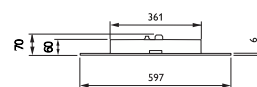
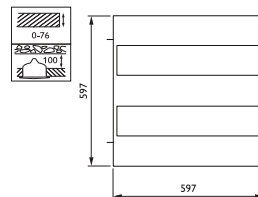
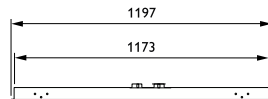
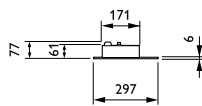

# FlexBlend Recessed

## Product details



FlexBlend Recessed-  
RC340B\_W60L60\_Backcover\_VP  
C



FlexBlend Recessed-  
RC340B\_PCS\_DPP



O\_FlexBlend Recessed-  
RC340B\_W60L60\_PCS\_VPC



FlexBlend Recessed RC340B PIP  
Open



FlexBlend Recessed-RC340B PIP  
Closed

FlexBlend Recessed

General Information	
Driver included	Yes
Light source replaceable	No
Number of gear units	1 unit
Service tag	Yes
Light Technical	
Beam angle of light source	120 degree(s)
Correlated Color Temperature (Nom)	4000 K
Color rendering index (CRI)	>90
Optic type	Wide beam
Operating and Electrical	
Protection class IEC	Safety class I
Input Voltage	220 to 240 V
Line Frequency	50 to 60 Hz
Suitable for random switching	Yes
Controls and Dimming	
Dimmable	Yes
Maximum dim level	1%
Mechanical and Housing	
Housing Color	White
Mech. impact protection code	IK02
Emergency Operation	
Central Emergency	Yes
Emergency lighting	DC operated central emergency lighting
Approval and Application	
Ambient temperature range	+10 to +40 °C
CE mark	Yes
ENEC mark	ENEC mark
Flammability mark	For mounting on normally flammable surfaces
Flickering value (PstLM) - Flickering value as per EN 61000-3-3	1
Stroboscopic effect visibility measure (SVM)	0.4
Initial Performance (IEC Compliant)	
Initial chromaticity	(0.38, 0.37) SDCM ≤3
Luminous flux tolerance	+/-10%
Over Time Performance (IEC Compliant)	
Driver failure rate at 5000 h	0.01 %
Product Data	
Product family code	RC340B

Light Technical

Order Code	Full Product Name	Luminous Efficacy (rated)	
		(Nom)	Luminous Flux
910925867030	RC340B 42S/940 DEIA W30L120 VPC MLO W3W2	93 lm/W	4,200 lm
910925866973	RC340B 36S/940 DEIA W60L60 VPC PCS	138 lm/W	3,600 lm

# FlexBlend Recessed

## Operating and Electrical

Order Code	Full Product Name	Power Consumption
910925867030	RC340B 42S/940 DEIA W30L120 VPC MLO W3W2	45 W

Order Code	Full Product Name	Power Consumption
910925866973	RC340B 36S/940 DEIA W60L60 VPC PCS	26 W

## Mechanical and Housing

Order Code	Full Product Name	Ingress protection code
910925867030	RC340B 42S/940 DEIA W30L120 VPC MLO W3W2	IP20/40

Order Code	Full Product Name	Ingress protection code
910925866973	RC340B 36S/940 DEIA W60L60 VPC PCS	IP20/54

## Approval and Application

Order Code	Full Product Name	Glow-wire test
910925867030	RC340B 42S/940 DEIA W30L120 VPC MLO W3W2	Temperature 650 °C, duration 30 s

Order Code	Full Product Name	Glow-wire test
910925866973	RC340B 36S/940 DEIA W60L60 VPC PCS	Temperature 850 °C, duration 30 s

## Polar Wide Diagrams

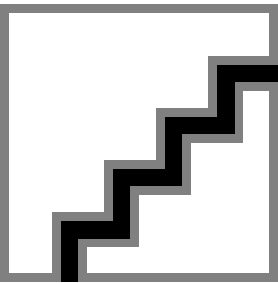

Polar Normal (separate) - RC340BI - 910925867030

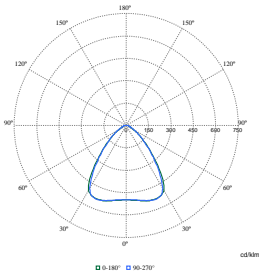

Polar Normal (separate) - RC340BI - 910925866973

