



## Wireless connectivity for outdoor lighting control. A device that transforms any streetlight into an individually controllable and remotely managed luminaire.

RF Mesh is a networked controls system based on two-way wireless communication using the latest mesh network technology. The system enables individual light points to be controlled remotely and to be managed via online platforms. Lighting operators can control remotely the outdoor lighting infrastructure setting dimming levels to achieve considerable energy savings and can get real time feedback from the luminaires reducing operating and maintenance costs via accurate scheduling of on-site maintenance service tasks, while improving both the quality and reliability of outdoor lighting.

### Benefits

- High network redundancy and reliability with Sub gig mesh network (868MHz, 924MHz, 922MHz)
- Optimized RF Mesh network for lighting applications
- Quick and error free commissioning with mobile tools
- Firmware upgrade without impacting the light operation

### Applications

- Road and Street

### Features

- Retrofit light controls for LED Luminaires with ZHAGA or NEMA socket or 20MM Conduit

- Freedom to select any dimmable driver supplier using 1-10v, DALI, SR and D4i
- Built in light sensor to prevent day burning

- Built in GPS for accurate positioning
- Retrofit versions to meet regional requirements

## Versions

ZHAGA ; CE only; Light grey, light sensor, GPS

LLC745x Product Image2



NEMA 5PIN AC LV; IEC only  
Light Grey, light sensor, GPS



## Dimensional drawing

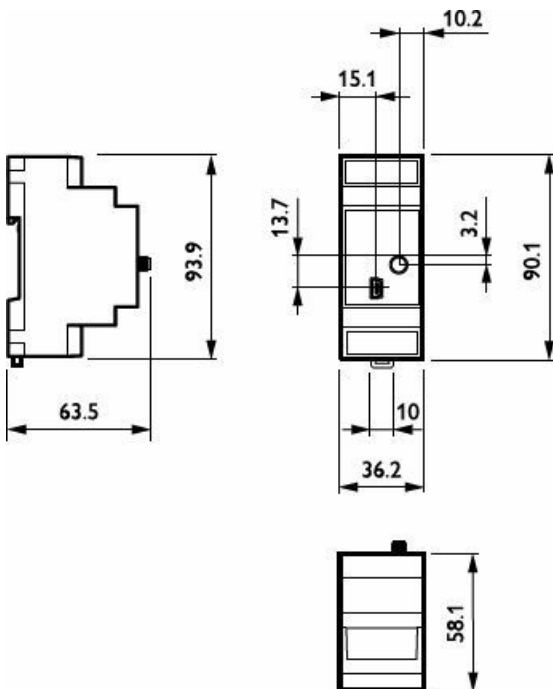

LCN7310/00 Starsense Wireless SC RF mod.