



## End-to-end wireless intelligent management system for your outdoor lighting

Starsense Wireless is a networked controls system based on two-way wireless communication using the latest in mesh network technology. The system enables individual light points to be controlled remotely and to be managed via online platforms, like CityTouch. Lighting operators can control remotely the outdoor lighting infrastructure setting dimming levels to achieve considerable energy savings and can get real time feedback from the luminaires reducing operating and maintenance costs via accurate scheduling of on-site maintenance service tasks, while improving both the quality and reliability of outdoor lighting.

### Benefits

- Very low efforts, quick and error free commissioning
- Reliable system: long range, limited interference
- No software installation costs, easy access from everywhere, automatic back-ups

### Applications

- Designed for highways, roads and street lighting, including areas like parking lots

### Features

- Auto commissioning based on collected asset information
- Sub-GHz (868 MHz) frequency for communication
- User friendly, web-based end-user interface

- Freedom to select any dimmable driver supplier using DALI or 1-10 V

- Future-proof: scalable network and upgradeable over the air

## Versions

LLC745x Product Image2



NEMA 5PIN AC LV; IEC only  
Light Grey, light sensor,  
GPS



RF Segment controller for  
Global connectivity



## Dimensional drawing

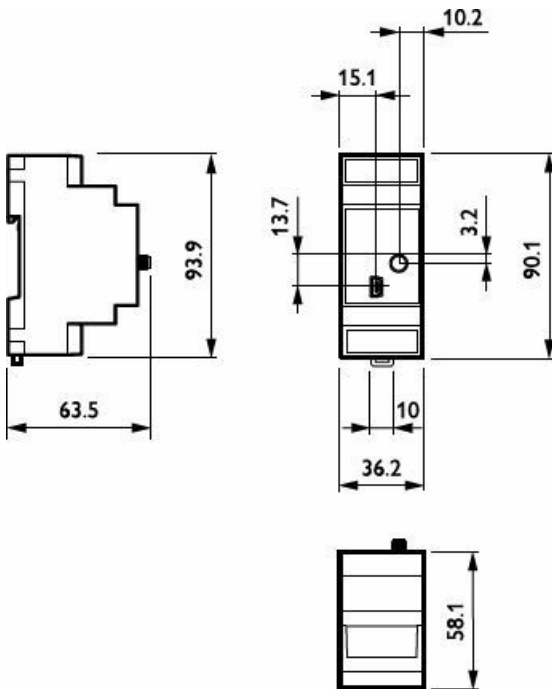

LCN7310/00 Starsense Wireless SC RF mod.