



Wireless connectivity for outdoor lighting control. A device that transforms any streetlight into an individually controllable and remotely managed luminaire.

RF Mesh is a networked controls system based on two-way wireless communication using the latest mesh network technology. The system enables individual light points to be controlled remotely and to be managed via online platforms. Lighting operators can control remotely the outdoor lighting infrastructure setting dimming levels to achieve considerable energy savings and can get real time feedback from the luminaires reducing operating and maintenance costs via accurate scheduling of on-site maintenance service tasks, while improving both the quality and reliability of outdoor lighting.

Benefits

- High network redundancy and reliability with Sub gig mesh network (868MHz, 924MHz, 922MHz)
- Optimized RF Mesh network for lighting applications
- Quick and error free commissioning with mobile tools
- Firmware upgrade without impacting the light operation

Applications

- Road and Street

Features

- Retrofit light controls for LED Luminaires with ZHAGA or NEMA socket or 20MM Conduit

- Freedom to select any dimmable driver supplier using 1-10v, DALI, SR and D4i
- Built in light sensor to prevent day burning

- Built in GPS for accurate positioning
- Retrofit versions to meet regional requirements

Versions

ZHAGA ; CE only; Light grey, light sensor, GPS



LLC745x Product Image2



ZHAGA ; CE only; dark grey, light sensor, GPS



RF Segment controller Module



LCA7307 Product Image

NEMA 5PIN AC LV; CE Dark Grey, light sensor, GPS



RF Segment controller for Global connectivity

20MM AC LV; CE Light Grey, light sensor, No GPS



20MM AC LV; CE Dark Grey, light sensor, No GPS



Dimensional drawing

Product

LCN7340/00 Starsense Wireless SC RF mod.

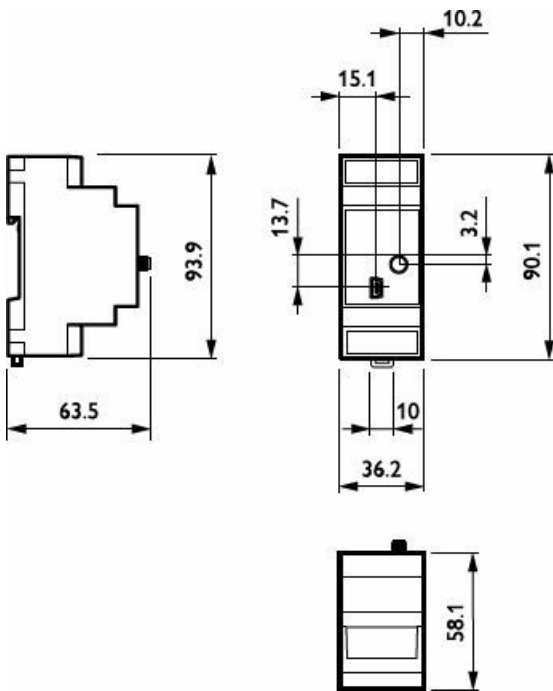
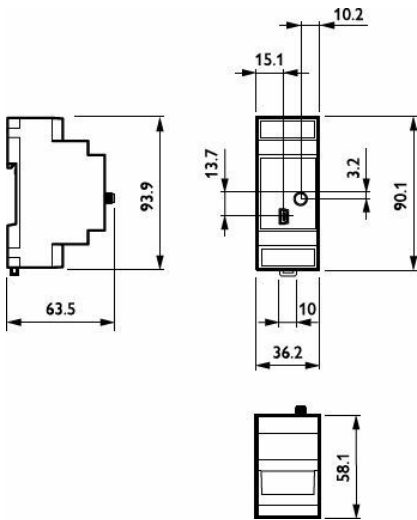

LCN7310/00 Starsense Wireless SC RF mod.