



# OccuSwitch – a smart move

## OccuSwitch

The OccuSwitch is a movement detector with a built-in switch. It will switch the lights off in a room or area when it is vacated and thus save up to 30% on electricity. The OccuSwitch can switch any load of up to 6 A and control an area of between 20 and 25 m<sup>2</sup>. A detachable mains connector enables easy installation and mounting of the OccuSwitch in the ceiling, a separate Wieland cable is available for easy, fast and trouble-free installation.

### Benefits

- Energy savings of up to 30% and good pay-back
- Energy savings of up to 30% and good pay-back
- Works with almost all lamp- and luminaire types
- Works with almost all lamp- and luminaire types
- Easy to install, enables even faster installation by optional Wieland connectors.
- Easy to install, enables even faster installation by optional Wieland connectors.

### Features

- OccuSwitch has a smart timer that will extend the delay time by 10 minutes if movement is detected shortly after switch-off, assuming that the area is still in use but there is very little movement
- OccuSwitch has a smart timer that will extend the delay time by 10 minutes if movement is detected shortly after switch-off, assuming that the area is still in use but there is very little movement
- The OccuSwitch has a retractable shield that can be used to shield off areas, e.g. corridors, adjacent to the area the OccuSwitch is controlling
- The OccuSwitch has a retractable shield that can be used to shield off areas, e.g. corridors, adjacent to the area the OccuSwitch is controlling

## Application

- The OccuSwitch is designed for use in offices, schools and similar applications, including toilets, storage rooms, etc
- The OccuSwitch is designed for use in offices, schools and similar applications, including toilets, storage rooms, etc
- It is optimized for recessed ceiling mounting and for mounting heights between 2.5 and 4 meters
- It is optimised for recessed ceiling mounting and for mounting heights between 2.5 and 4 metres
- The surface box also enables surface mounting, with either recessed wiring or surface-mounted ducts
- The surface box also enables surface mounting, with either recessed wiring or surface-mounted ducts

## Versions



GPPR LOCCSWii 0002



GPPR LOCCSWii 0004



SES LCM106x

## Dimensional drawing

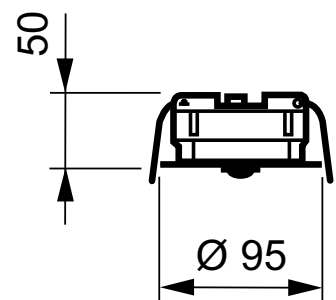
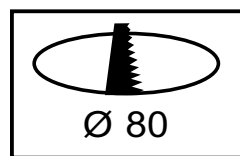
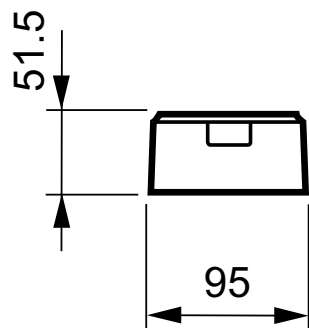

Dimensional drawing

