



# Compact ignitors for flexible luminaire design

## HID ignitors for MK4 semi-parallel systems

HID ignitors for semi-parallel systems

### Benefits

- Wide range of lamps covered by one ignitor 35-600 W
- Digital versions ensure longer lifetime than series ignitors, and silent operation
- Smaller dimensions than predecessors mean it fits more easily into compact luminaires

### Features

- Designed to ensure maximum performance with new MK4 ballasts
- Semi-parallel ignitor will only work in semi-parallel circuits and must be matched with the relevant ballast
- Ignitors equipped with screw terminal blocks as standard
- Lightweight and compact products
- Current flows through ignitor only at lamp start-up

### Application

- Outdoor lighting

# HID ignitors for MK4 semi-parallel systems

## Dimensional drawing

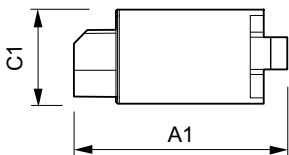
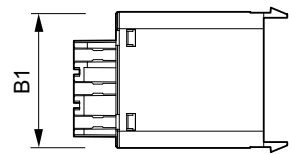
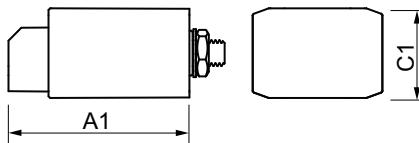
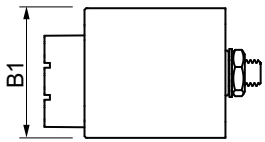
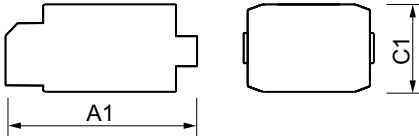
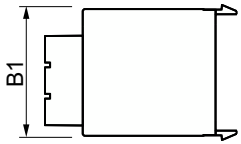

Product	A1	B1	C1
SKD 578 220-240V 50/60Hz	63.5 mm	40.5 mm	28 mm

Product	A1	B1	C1
SKD 578-S 220-240V 50/60Hz	67.5 mm	40.5 mm	28.0 mm

Product
SKD 578 220-240V 50/60Hz

