



Full cut out size, Full CCT Range, Full lumen output, Recessed Installation

SmartBright Pro Downlight gen2

The SmartBright Pro Downlight comes offering reliable lighting performance with recessed installation, suitable for diversified applications. Full cut out size from D75 to D200, full CCT range covering 3000K, 4000K and 6500K, lumen output covers 400lm to 2000lm, eye comfort experience with low flicker lighting can attract you more with its elegant design.

Benefits

- Recessed Installation
- Elegant look & feel
- Eye comfort experience with low flicker lighting
- CB / EMC compliance product with Philips brand promise

Features

- Cut out: D75, D100, D125, D150, D175, D200
- 4 CCT: 3000K, 4000K and 6500K
- Input voltage is 220-240V
- PF0.9
- Efficacy: up to 110lm/W
- CRI80
- IP44(front)/IP20(back)
- lifetime: 50khrs @L70&Ta25°C
- Working temperature: -20°C to +40°C

SmartBright Pro Downlight gen2

Application

- Residential
- Hospitality
- Retail
- Shopping mall
- Hotels

Versions



Smartbright Pro Downlight gen2

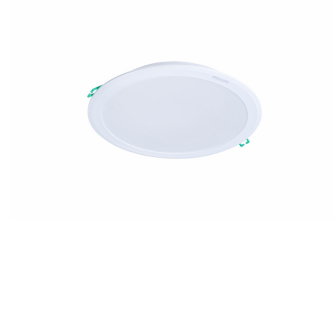

Smartbright Pro Downlight gen2

Dimensional drawing

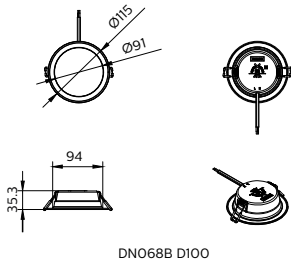

DN068B D100

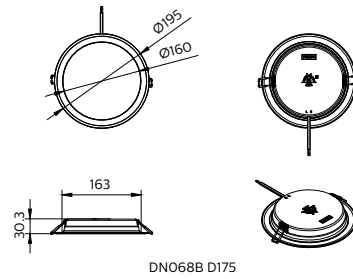

DN068B D175

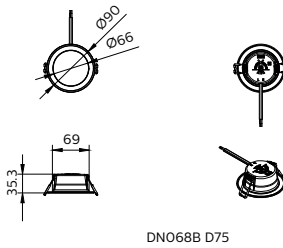

DN068B D75

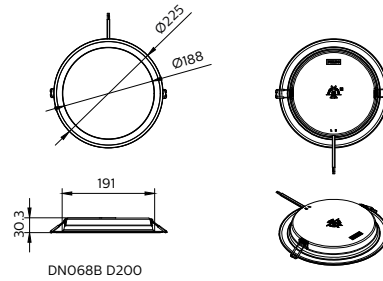

DN068B D200

SmartBright Pro Downlight gen2

Dimensional drawing

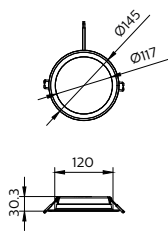

DN068B D125

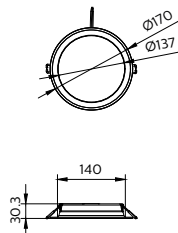

DN068B D150



SmartBright Pro Downlight gen2

General Information

Driver included	Yes
Gear	EB
Number of gear units	1 unit

Light Technical

Beam angle of light source	110 degree(s)
Color rendering index (CRI)	80
Number of light sources	1
Optic type	Beam angle 110°

Operating and Electrical

Protection class IEC	Safety class II
Input Voltage	220 to 240 V
Line Frequency	50 or 60 Hz
Suitable for random switching	No

Controls and Dimming

Dimmable	-
Maximum dim level	Not applicable

Mechanical and Housing

Optical cover type	Polycarbonate micro lens optic
Housing Color	White
Mech. impact protection code	IK03
Ingress protection code	IP20(IP44 front)

Approval and Application

Ambient temperature range	-20 to +40 °C
CE mark	No
ENEC mark	-
Flammability mark	For mounting on normally flammable surfaces
Glow-wire test	Temperature 650 °C, duration 30 s

Initial Performance (IEC Compliant)

Luminous flux tolerance	+/-10%
-------------------------	--------

Light Technical

Order Code	Full Product Name	Correlated Color	Luminous Efficacy	
		Temperature (Nom)	(rated) (Nom)	Luminous Flux
911401861587	DN068B G2 LED6/830 PSU D100	3000 K	105 lm/W	570 lm
911401861687	DN068B G2 LED6/840 PSU D100	4000 K	110 lm/W	600 lm
911401861787	DN068B G2 LED6/865 PSU D100	6500 K	110 lm/W	600 lm
911401861887	DN068B G2 LED9/830 PSU D100	3000 K	105 lm/W	855 lm
911401861987	DN068B G2 LED9/840 PSU D100	4000 K	110 lm/W	900 lm
911401862087	DN068B G2 LED9/865 PSU D100	6500 K	110 lm/W	900 lm
911401861287	DN068B G2 LED4/830 PSU D75	3000 K	100 lm/W	380 lm
911401861387	DN068B G2 LED4/840 PSU D75	4000 K	105 lm/W	400 lm
911401861487	DN068B G2 LED4/865 PSU D75	6500 K	105 lm/W	400 lm
911401863687	DN068B G2 LED19/830 PSU D200	3000 K	105 lm/W	1,900 lm
911401863787	DN068B G2 LED20/840 PSU D200	4000 K	110 lm/W	2,000 lm
911401863887	DN068B G2 LED20/865 PSU D200	6500 K	110 lm/W	2,000 lm
911401862187	DN068B G2 LED9/830 PSU D125	3000 K	105 lm/W	855 lm
911401862287	DN068B G2 LED9/840 PSU D125	4000 K	110 lm/W	900 lm
911401862387	DN068B G2 LED9/865 PSU D125	6500 K	110 lm/W	900 lm
911401862487	DN068B G2 LED12/830 PSU D125	3000 K	105 lm/W	1,235 lm
911401862587	DN068B G2 LED13/840 PSU D125	4000 K	110 lm/W	1,300 lm
911401862687	DN068B G2 LED13/865 PSU D125	6500 K	110 lm/W	1,300 lm
911401862787	DN068B G2 LED11/830 PSU D150	3000 K	105 lm/W	1,140 lm
911401862887	DN068B G2 LED12/840 PSU D150	4000 K	110 lm/W	1,200 lm
911401862987	DN068B G2 LED12/865 PSU D150	6500 K	110 lm/W	1,200 lm
911401863087	DN068B G2 LED15/830 PSU D150	3000 K	105 lm/W	1,520 lm
911401863187	DN068B G2 LED16/840 PSU D150	4000 K	110 lm/W	1,600 lm
911401863287	DN068B G2 LED16/865 PSU D150	6500 K	110 lm/W	1,600 lm
911401863387	DN068B G2 LED14/830 PSU D175	3000 K	105 lm/W	1,524 lm
911401863487	DN068B G2 LED15/840 PSU D175	4000 K	110 lm/W	1,500 lm

SmartBright Pro Downlight gen2

Order Code	Full Product Name	Correlated Color Temperature (Nom)	Luminous Efficacy (rated) (Nom)	Luminous Flux
911401863587	DN068B G2 LED15/865 PSU D175	6500 K	110 lm/W	1,500 lm

Operating and Electrical

Order Code	Full Product Name	Power Consumption
911401861587	DN068B G2 LED6/830 PSU D100	5.5 W
911401861687	DN068B G2 LED6/840 PSU D100	5.5 W
911401861787	DN068B G2 LED6/865 PSU D100	5.5 W
911401861887	DN068B G2 LED9/830 PSU D100	8 W
911401861987	DN068B G2 LED9/840 PSU D100	8 W
911401862087	DN068B G2 LED9/865 PSU D100	8 W
911401861287	DN068B G2 LED4/830 PSU D75	3.8 W
911401861387	DN068B G2 LED4/840 PSU D75	3.8 W
911401861487	DN068B G2 LED4/865 PSU D75	3.8 W
911401863687	DN068B G2 LED19/830 PSU D200	18 W
911401863787	DN068B G2 LED20/840 PSU D200	18 W
911401863887	DN068B G2 LED20/865 PSU D200	18 W
911401862187	DN068B G2 LED9/830 PSU D125	8 W
911401862287	DN068B G2 LED9/840 PSU D125	8 W

Order Code	Full Product Name	Power Consumption
911401862387	DN068B G2 LED9/865 PSU D125	8 W
911401862487	DN068B G2 LED12/830 PSU D125	12 W
911401862587	DN068B G2 LED13/840 PSU D125	12 W
911401862687	DN068B G2 LED13/865 PSU D125	12 W
911401862787	DN068B G2 LED11/830 PSU D150	11 W
911401862887	DN068B G2 LED12/840 PSU D150	11 W
911401862987	DN068B G2 LED12/865 PSU D150	11 W
911401863087	DN068B G2 LED15/830 PSU D150	15 W
911401863187	DN068B G2 LED16/840 PSU D150	15 W
911401863287	DN068B G2 LED16/865 PSU D150	15 W
911401863387	DN068B G2 LED14/830 PSU D175	14 W
911401863487	DN068B G2 LED15/840 PSU D175	14 W
911401863587	DN068B G2 LED15/865 PSU D175	14 W

Initial Performance (IEC Compliant)

Order Code	Full Product Name	Initial chromaticity
911401861587	DN068B G2 LED6/830 PSU D100	(0.44, 0.40) SDCM≤6
911401861687	DN068B G2 LED6/840 PSU D100	(0.38, 0.38) SDCM≤6
911401861787	DN068B G2 LED6/865 PSU D100	(0.31, 0.34) SDCM≤6
911401861887	DN068B G2 LED9/830 PSU D100	(0.44, 0.40) SDCM≤6
911401861987	DN068B G2 LED9/840 PSU D100	(0.38, 0.38) SDCM≤6
911401862087	DN068B G2 LED9/865 PSU D100	(0.31, 0.34) SDCM≤6
911401861287	DN068B G2 LED4/830 PSU D75	(0.44, 0.40) SDCM≤6
911401861387	DN068B G2 LED4/840 PSU D75	(0.38, 0.38) SDCM≤6
911401861487	DN068B G2 LED4/865 PSU D75	(0.31, 0.34) SDCM≤6
911401863687	DN068B G2 LED19/830 PSU D200	(0.44, 0.40) SDCM≤6
911401863787	DN068B G2 LED20/840 PSU D200	(0.38, 0.38) SDCM≤6
911401863887	DN068B G2 LED20/865 PSU D200	(0.31, 0.34) SDCM≤6
911401862187	DN068B G2 LED9/830 PSU D125	(0.44, 0.40) SDCM≤6
911401862287	DN068B G2 LED9/840 PSU D125	(0.38, 0.38) SDCM≤6

Order Code	Full Product Name	Initial chromaticity
911401862387	DN068B G2 LED9/865 PSU D125	(0.31, 0.34) SDCM≤6
911401862487	DN068B G2 LED12/830 PSU D125	(0.44, 0.40) SDCM≤6
911401862587	DN068B G2 LED13/840 PSU D125	(0.38, 0.38) SDCM≤6
911401862687	DN068B G2 LED13/865 PSU D125	(0.31, 0.34) SDCM≤6
911401862787	DN068B G2 LED11/830 PSU D150	(0.44, 0.40) SDCM≤6
911401862887	DN068B G2 LED12/840 PSU D150	(0.38, 0.38) SDCM≤6
911401862987	DN068B G2 LED12/865 PSU D150	(0.31, 0.34) SDCM≤6
911401863087	DN068B G2 LED15/830 PSU D150	(0.44, 0.40) SDCM≤6
911401863187	DN068B G2 LED16/840 PSU D150	(0.38, 0.38) SDCM≤6
911401863287	DN068B G2 LED16/865 PSU D150	(0.31, 0.34) SDCM≤6
911401863387	DN068B G2 LED14/830 PSU D175	(0.44, 0.40) SDCM≤6
911401863487	DN068B G2 LED15/840 PSU D175	(0.38, 0.38) SDCM≤6
911401863587	DN068B G2 LED15/865 PSU D175	(0.31, 0.34) SDCM≤6

SmartBright Pro Downlight gen2

