



# Long-lasting, reliable solution

## HID-HighPower for SON/MH/HPL/HPI

Encapsulated ballasts for use with SON (T) (Plus), HPL, HPI and MH lamps with rated wattages of 1000 W and above

### Benefits

- Protected from overheating – outstanding product lifetime of 15 years average
- Minimal watt losses thanks to orthocyclic winding process
- Ideal for pole mounting

### Features

- Excellent resistance to chemical impact, humid conditions and environmental stress crack
- Class I rated (i.e. with earthing facility)
- Equipped with screw terminal blocks as standard
- Separate earth terminal (HID 'Heavy Duty')
- Ballasts for alternative mains voltages/frequencies available upon request

### Application

- Outdoor lighting (most popular application areas: sports and area lighting)

# HID-HighPower for SON/MH/HPL/HPI

## Versions



GPPR BSN-HP L02 L43 L78 PHL



GPPR BHD-HP PHL

## Dimensional drawing

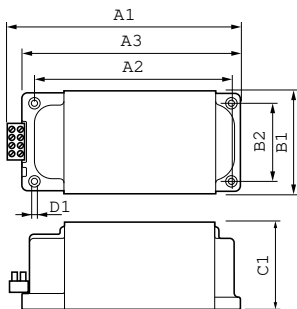
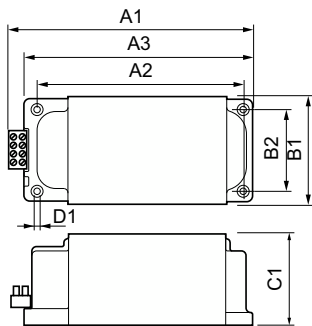
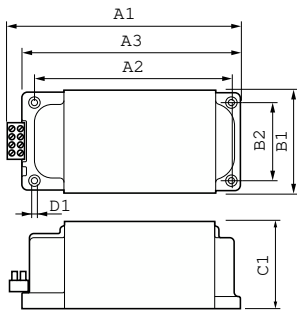

Product	D1	C1	A1	A2	A3	B1	B2
BSN 1000 L78-A2 230/240V 50Hz HP-257	6.5 mm	102.0 mm	257.0 mm	222.0 mm	246.0 mm	117.0 mm	88.0 mm

Product	D1	C1	A1	A2	A3	B1	B2
BHD 2000 L76-A2 380/400/415V 50Hz HP-317	6.5 mm	102.0 mm	317.0 mm	282.0 mm	306.0 mm	117.0 mm	88.0 mm

Product	D1	C1	A1	A2	A3	B1	B2
BHL 1000 L78-A2 230/240V 50Hz HP-207	6.5 mm	102.0 mm	207.0 mm	172.0 mm	196.0 mm	117.0 mm	88.0 mm
BHL 2000 L76-A2 380/400/415V 50Hz HP-317	6.5 mm	102.0 mm	317.0 mm	282.0 mm	306.0 mm	117.0 mm	88.0 mm

# HID-HighPower for SON/MH/HPL/HPI

## Operating and Electrical

Input frequency	50 Hz
Line Frequency	50 Hz

## Operating and Electrical

Order Code	Full Product Name	Input Voltage
913700217503	BSN 1000 L78-A2 230/240V 50Hz HP-257	230 V (default) or 240 V
913700232103	BHD 2000 L76-A2 380/400/415V 50Hz HP-317	380 to 415 V

Order Code	Full Product Name	Input Voltage
913700217303	BHL 1000 L78-A2 230/240V 50Hz HP-207	230 V (default) or 240 V
913700217903	BHL 2000 L76-A2 380/400/415V 50Hz HP-317	380 to 415 V

