

HID-GreenVision – The electronic solution for growth light applications

HID-GreenVision GP-SON

Full electronic driver for GP-SON 600/1000W lamps

Benefits

- Flexible design-in (PCB in bracket, optimal heat dissipation)
- Low energy consumption
- High number of devices on a MCB (fuse)

Features

- High efficiency: >95%
- Inrush current limiter
- Long lifetime of 30,000 hours, with 90% survivors at Tcase life
- Accurate lamp power stabilization of +/-3% over wide mains voltage range

Application

- Luminaires for assimilation lighting (greenhouses/field pitch)

HID-GreenVision GP-SON

Versions



GP-PR_IGV3GPSN_0001-Product photo

Dimensional drawing

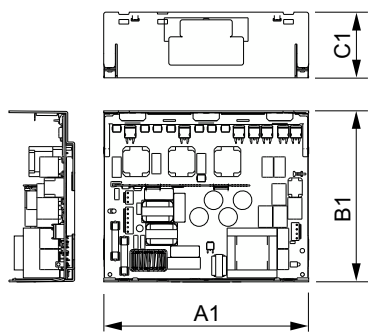

Product	C1	A1	B1
HID-GVIII 1000W/P GP-SON 400V	58 mm	181 mm	150 mm
HID-GVIII 600W/P GP-SON 400V	58 mm	181 mm	150 mm

Product details



HID-GV III GP-SON

