



## Product Description

### HID-Basic Semi-Parallel Economic ballasts for SON/CDM/MH lamps

Impregnated (HID standard) electromagnetic ballasts, of copper/iron construction, for use in combination with an external ignitor, for HID lamps

#### Benefits

- Limited ballast coil volume and reduced weight, with minimum watt losses
- Simple installation and cabling

#### Features

- Orthocyclic winding process
- Ballasts standard equipped with screw terminal blocks
- Earthing while-mounting facility (HID Standard ballasts)

#### Application

- For application with SON, HPI (PLUS) which are used in road lighting, public lighting, industry lighting
- For application with MHN/CDM lamps which are used on shop lighting, exhibition, lobby, city beautification lighting
- HID basic ballasts should be restricted to built-in situations where relative humid is limited

# HID-Basic Semi-Parallel Economic ballasts for SON/CDM/MH lamps

## Versions

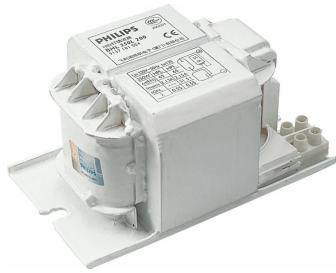

GPPR BCSONE 0001

## Dimensional drawing

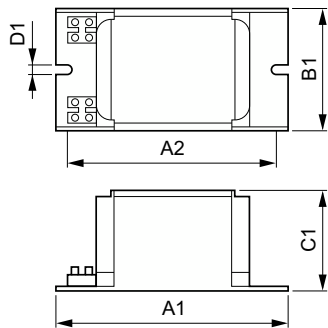

Product	D1	C1	A1	A2	B1
BSNE 70L 3001 TS	6.3 mm	82 mm	165.0 mm	144 mm	96.0 mm

