



Load controllers do the heavy lifting in the control system

Dynalite Load Controllers

Load controllers receive instructions from the network and adjust their controlled outputs as required. They contain all the elements – power supply, network ports, output circuits, and the microprocessor management – needed to operate the lighting groups for which they are responsible. All channel naming information, channel addressing, area addressing, and channel scene levels are stored within the memory of the load controller. Dynalite has a wide range of load controllers that can be mixed and matched to support various project requirements and multiple luminaire types. The load controller range features different types of output circuits for switching, leading/ trailing edge dimming, PWM dimming, DALI, and 0-10 V control. Controllers offer a range of channel capacities from 2-20A, as well as a choice of wall or DIN rail mounting options.

Application

- Industrial
- Education
- Healthcare
- Retail
- Hospitality

Dynalite Load Controllers

Versions



DDBC516FR 5 x 16A Signal Dimmer Controller



DNG232-NA



DDLEDC605-GL



DDMC802 8 x 2A Multipurpose Modular Controller



DMBC110

Dimensional drawing

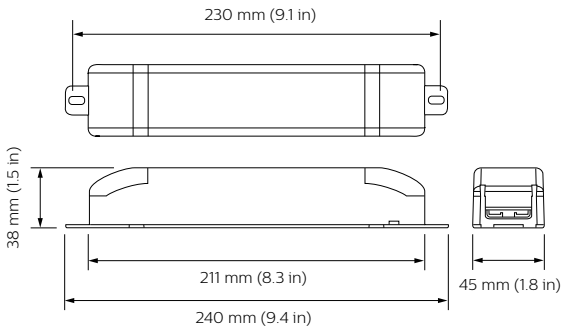
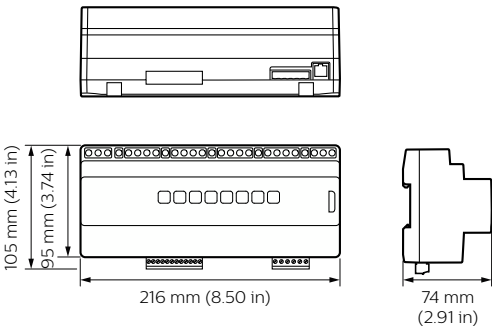

Dimensional drawing

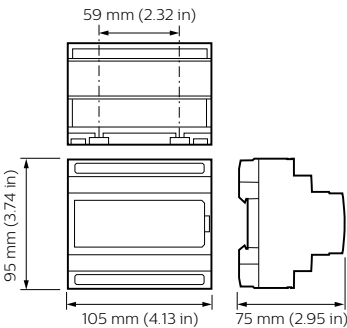
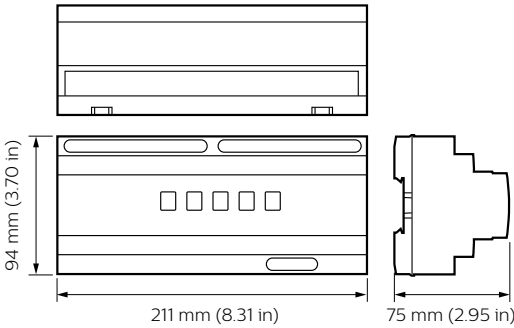
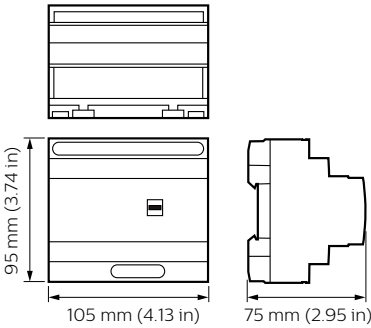
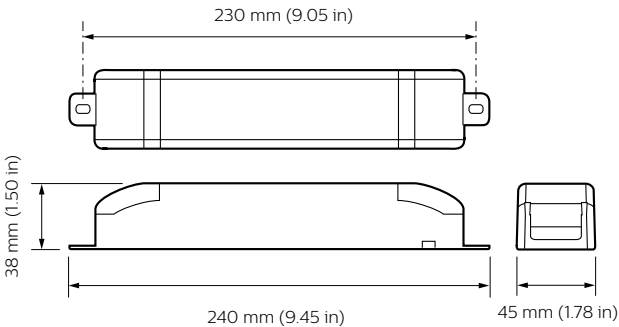
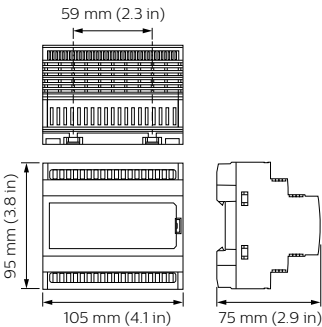

Product details



DDBC516FR 5 x 16A Signal Dimmer
Controller front



DDBC120-DALI MultiMaster DALI
Driver Controller

Dynalite Load Controllers

Product details

Detail photo of the DDLEDC605-GL



DDMC802 front detail

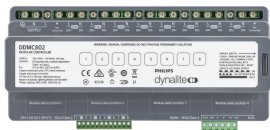

Detail photo of the DMBC110

