

# Great value for road lighting

## StreetStar Gen2

StreetStar Gen2 brings great value for street lighting with its energy-efficient, cost-effective, slim but robust design. It's the perfect option for municipalities and businesses seeking a reliable and sustainable lighting solution. StreetStar Gen2 offers unparalleled value and performance.

### Benefits

- Optimal energy savings: High efficacy for energy savings and sustainability
- Easy installation: Lightweight with adaptable spigot
- Robust and Reliable: Quality components combined with durable design
- Affordable: Enjoy the benefit of energy-saving NOW

### Features

- Energy efficient: 140lm/W for NW
- Easy and flexible mounting: adjustable side-entry and post-top with pre-wired cable
- Slim and robust design: die-cast aluminum structure
- Easy cleaning and maintenance: glass front cover
- Professional lighting design

### Application

- Residential and connecting roads
- Expressway
- Urban roads and parking lots
- Suburban roads and pathways

# StreetStar Gen2

## Versions



StreetStar Gen2

StreetStar Gen2

## Dimensional drawing

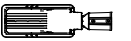
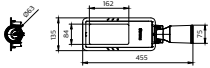

BRP241 30W

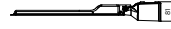
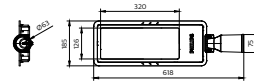

BRP244 90W - 120W

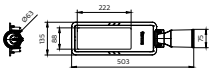

BRP242 40W - 50W

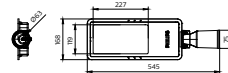

BRP243 60W - 80W

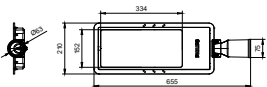

BRP245 130W - 150W

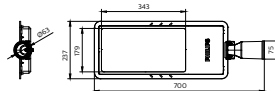

BRP246 160W - 200W

## General Information

Driver included	Yes
Gear	EB

## Light Technical

Color rendering index (CRI)	≥70
-----------------------------	-----

## Controls and Dimming

Dimmable	Fixed
Maximum dim level	Not applicable

## Mechanical and Housing

Optical cover type	Tempered glass
Housing Color	RAL7040
Mech. impact protection code	IK08
Ingress protection code	IP66

## Approval and Application

CE mark	Yes
Flammability mark	-

## Light Technical

Order Code	Full Product Name	Light source color	Correlated Color	
			Temperature (Nom)	Luminous Flux
30413100	BRP243 LED94/WW 70W DMO PSU	730 warm white	3000 K	9,400 lm
30414800	BRP243 LED108/WW 80W DMO PSU	730 warm white	3000 K	10,800 lm
30422300	BRP243 LED98/NW 70W DMO PSU	740 neutral white	4000 K	9,800 lm
30423000	BRP243 LED112/NW 80W DMO PSU	740 neutral white	4000 K	11,200 lm
30412400	BRP242 LED67/WW 50W DMO PSU	730 warm white	3000 K	6,700 lm
30421600	BRP242 LED70/NW 50W DMO PSU	740 neutral white	4000 K	7,000 lm
30411700	BRP241 LED40/WW 30W DMO PSU	730 warm white	3000 K	4,000 lm
30420900	BRP241 LED42/NW 30W DMO PSU	740 neutral white	4000 K	4,200 lm
30415500	BRP244 LED135/WW 100W DMO PSU	730 warm white	3000 K	13,500 lm
30416200	BRP244 LED162/WW 120W DMO PSU	730 warm white	3000 K	16,200 lm
30424700	BRP244 LED140/NW 100W DMO PSU	740 neutral white	4000 K	14,000 lm
30425400	BRP244 LED168/NW 120W DMO PSU	740 neutral white	4000 K	16,800 lm
30418600	BRP246 LED243/WW 180W DMO PSU	730 warm white	3000 K	24,300 lm
30419300	BRP246 LED270/WW 200W DMO PSU	730 warm white	3000 K	27,000 lm
30427800	BRP246 LED252/NW 180W DMO PSU	740 neutral white	4000 K	25,200 lm
30428500	BRP246 LED280/NW 200W DMO PSU	740 neutral white	4000 K	28,000 lm
30417900	BRP245 LED202/WW 150W DMO PSU	730 warm white	3000 K	20,200 lm
30426100	BRP245 LED210/NW 150W DMO PSU	740 neutral white	4000 K	21,000 lm

## Operating and Electrical

Order Code	Full Product Name	Power Consumption
30413100	BRP243 LED94/WW 70W DMO PSU	70 W
30414800	BRP243 LED108/WW 80W DMO PSU	80 W
30422300	BRP243 LED98/NW 70W DMO PSU	70 W
30423000	BRP243 LED112/NW 80W DMO PSU	80 W
30412400	BRP242 LED67/WW 50W DMO PSU	50 W
30421600	BRP242 LED70/NW 50W DMO PSU	50 W
30411700	BRP241 LED40/WW 30W DMO PSU	30 W
30420900	BRP241 LED42/NW 30W DMO PSU	30 W
30415500	BRP244 LED135/WW 100W DMO PSU	100 W

Order Code	Full Product Name	Power Consumption
30416200	BRP244 LED162/WW 120W DMO PSU	120 W
30424700	BRP244 LED140/NW 100W DMO PSU	100 W
30425400	BRP244 LED168/NW 120W DMO PSU	120 W
30418600	BRP246 LED243/WW 180W DMO PSU	180 W
30419300	BRP246 LED270/WW 200W DMO PSU	200 W
30427800	BRP246 LED252/NW 180W DMO PSU	180 W
30428500	BRP246 LED280/NW 200W DMO PSU	200 W
30417900	BRP245 LED202/WW 150W DMO PSU	150 W
30426100	BRP245 LED210/NW 150W DMO PSU	150 W

