

StreetSaver – save costs, enjoy quality

StreetSaver gen2

In order to comply with EU regulations passed in 2015, municipalities need to replace all mercury-based lamps with lamps that are mercury-free. However, municipalities often have limited budgets to handle these huge replacement operations, especially in this period of economic austerity. At the same time, municipal authorities are facing tremendous pressure to save energy and to reduce light pollution of the night sky (many mercury installations have a transparent bowl, sending light everywhere). StreetSaver is an affordable, high-quality solution that enables municipalities to address all these issues by changing their mercury-based luminaires to LED systems – and importantly, it only requires a limited investment.

Benefits

- An affordable LED post-top solution with good lighting performance
- High product quality and robust design
- Good lifespan thanks to mid-power LED and 4KV surge protection

Features

- Dedicated LED design
- Aluminium housing and polycarbonate flat glass
- Connection directly at the bottom of the pole thanks to its 6 m cable

Application

- Parks and squares, pedestrian areas
- Commercial squares, parking areas
- Residential areas

StreetSaver gen2

Versions



StreetSaver G2

Dimensional drawing

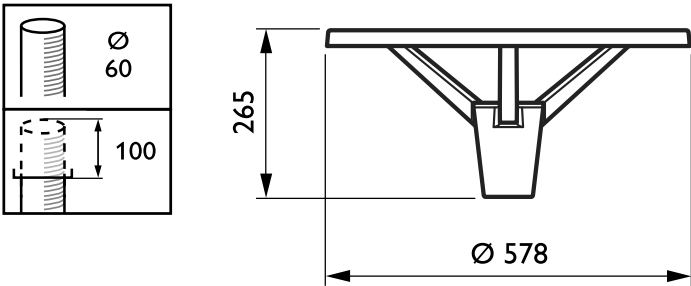

Product details

StreetSaver_G2-DPP.tif



