



Get your city ready for the future with DigiStreet

DigiStreet

Developed with the aim to become your long term partner, the system ready architecture of DigiStreet enables you to enjoy the benefits of connected lighting systems today and also gets the city ready for the innovations to come!. Its two sockets enable you to connect directly to the CityTouch system and is also prepared to connect you to the future innovations of IoT. Next to this, each individual luminaire is uniquely identifiable, thanks to the Service tag application. With a simple scan of a QR code, placed on the inside of the mast door, you gain instant access to the luminaire configuration, making maintenance and programming operations faster and easier, no matter what stage of the luminaire's lifetime. DigiStreet is also equipped with dedicated light recipes that: 1) maintain an optimal ecosystem for bats or 2) preserve a dark night sky.

Benefits

- Prepared for the future, it is easy to upgrade directly after installation or later with future CMS nodes and sensors to enable new functionalities
- Large availability of lense optics to match international road and street geometries
- Equipped with Service tag, a QR-based identification system that makes each luminaire uniquely identifiable and provides maintenance, installation and spare part information

Features

- Easy luminaire identification due to the Service tag
- High efficacy up to 161 lm/W
- Choice of 30+ different beams and different internal louvers
- Surge protection, 10 kV
- L-tune tool available
- Lifetime 100Khrs up to L96 at Tq +25 °C
- Internal louver (optional)

Application

- Traffic routes and main access road
- Urban and residential area
- City centers and main streets
- Cycle paths, footpaths and pedestrian crossings

Versions



Digistreet-BGP760

Digistreet-BGP763-DP04

Dimensional drawing

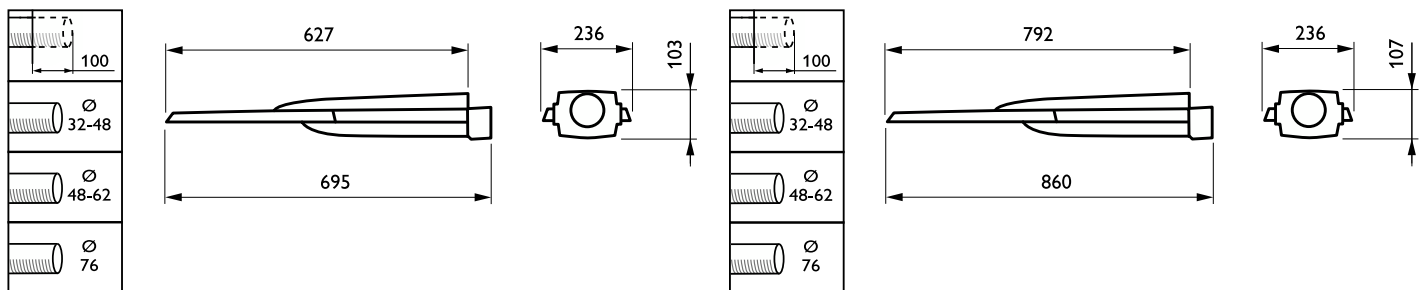

Dimensional drawing

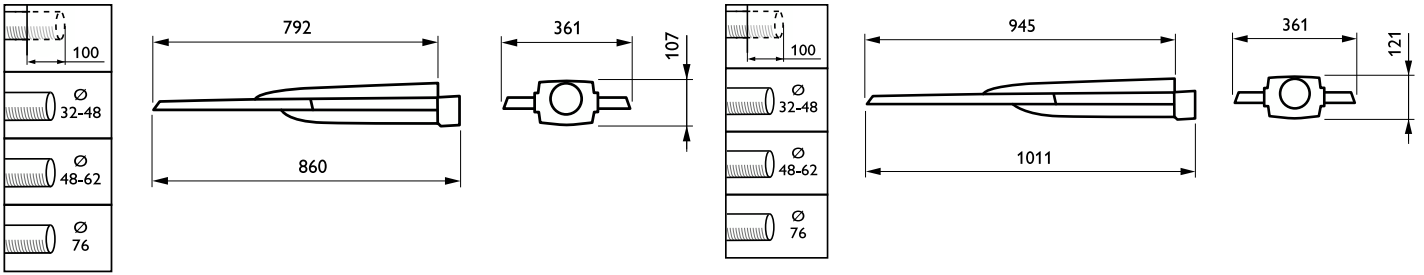

Product details

Digistreet-BGP760-DP06.tif



Digistreet-BGP760-DP09.tif



Digistreet-BGP760-DP10.tif



Digistreet-BGP760-DP11.tif



Digistreet-BGP761-DP17.tif



Digistreet-BGP761-DP18.tif

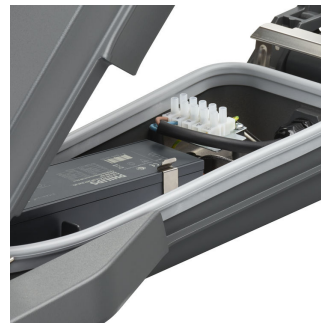

Product details

Digistreet-BGP761-DP19.tif

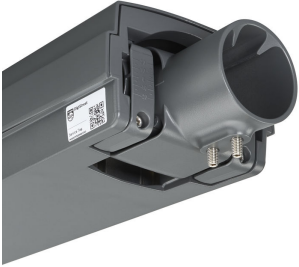

Digistreet-BGP761-DP20.tif



Digistreet-BGP761-DP21.tif



Digistreet-BGP761-DP22.tif



Digistreet-BGP761-DP23.tif



Digistreet-BGP761-DP24.tif



Digistreet-BGP761-DP25.tif



Digistreet-BGP761-DP26.tif



General Information	
Driver included	Yes
Light source replaceable	Yes
Service tag	Yes
Light Technical	
Upward light output ratio	0
Mechanical and Housing	
Optical cover type	Flat glass
Housing Color	Dark gray
Mech. impact protection code	IK09
Ingress protection code	IP66
Standard tilt angle side entry	0°
Standard tilt angle posttop	0°
Approval and Application	
CE mark	Yes
Flammability mark	-

General Information

Order Code	Full Product Name	Lamp family		Number of gear units
		Gear	code	
910925866220	BGP762 LED120-/830 II DN11 DGR D11 76	-	LED120	1 unit
910925866221	BGP762 LED159-/830 II DM70 DGR DDF27 D18	-	LED159	1 unit
910925866222	BGP762 LED129-/740 I DM11 DGR 32-48	-	LED129	1 unit
910925866224	BGP762 LED110-/740 I DN10 DGR 32-48	-	LED110	1 unit
910925866226	BGP762 LED180-/740 I DX10 DGR 32-48	-	LED180	1 unit
910925866228	BGP762 LED139-/830 II DM11 DGR D9 62	-	LED139	1 unit
910925866229	BGP762 LED170-/830 II DW10 DGR 76	-	LED170	1 unit
910925866245	BGP762 LED200-/740 I DW50 DGR 62	-	LED200	1 unit
910925866246	BGP762 LED210-/740 II DX70 DGR 76	-	LED210	1 unit
910925866252	BGP762 LED220-/740 II DW10 DGR SRG10 62	-	LED220	1 unit
910925863554	BGP760 LED10-/740 I DM10 DGR 32-48	EB	LED10	1 unit
910925863555	BGP760 LED12-/830 II DM11 DGR D9 62	EB	LED12	1 unit
910925863556	BGP760 LED14-/740 I DN10 DGR 32-48	EB	LED14	1 unit
910925863557	BGP760 LED16-/830 II DN11 DGR D11 62	EB	LED16	1 unit
910925863560	BGP760 LED22-/740 I DM50 DGR 32-48	EB	LED22	1 unit
910925863563	BGP760 LED30-/830 II DW10 DGR 62	EB	LED30	1 unit
910925863566	BGP760 LED44-/740 I DW50 DGR 32-48	EB	LED44	1 unit
910925863567	BGP760 LED49-/740 II DX70 DGR 62	EB	LED49	1 unit
910925866249	BGP763 LED300-/740 I DW50 DGR 62	-	LED300	2 units
910925866250	BGP763 LED260-/740 I DX10 DGR 32-48	-	LED260	2 units
910925866251	BGP763 LED340-/740 II DW10 DGR SRG10 62	-	LED340	2 units
910925866230	BGP761 LED45-/740 I DM10 DGR 32-48	-	LED45	1 unit
910925866231	BGP761 LED74-/740 I DM50 DGR 32-48	-	LED74	1 unit
910925866232	BGP761 LED94-/740 I DX10 DGR 32-48	-	LED94	1 unit
910925866234	BGP761 LED55-/740 I DN10 DGR 32-48	-	LED55	1 unit
910925866235	BGP761 LED84-/740 I DS50 DGR 32-48	-	LED84	1 unit
910925866238	BGP761 LED50-/830 II DM11 DGR D9 62	-	LED50	1 unit
910925866239	BGP761 LED79-/830 II DM70 DGR DDF27 D18	-	LED79	1 unit
910925866240	BGP761 LED59-/830 II DN11 DGR D11 62	-	LED59	1 unit
910925866241	BGP761 LED90-/740 II DW10 DGR 62	-	LED90	1 unit
910925866497	BGP761 LED119/740 I DM10 DGR 62 S	-	LED119	1 unit

Light Technical (1/2)

Order Code	Full Product Name	Luminaire light beam spread	Light source color	Correlated	Color
				Color Temperature (Nom)	rendering index (CRI)
910925866220	BGP762 LED120-/830 II	53° x 71°	830	3000 K	80
	DN11 DGR D11 76		warm white		
910925866221	BGP762 LED159-/830 II	-	830	3000 K	80
	DM70 DGR		warm white		
	DDF27 D18		white		
910925866222	BGP762 LED129-/740 I	160° - 42° x 54°	740	4000 K	70
	DM11 DGR 32-48		neutral white		

Order Code	Full Product Name	Luminaire light beam spread	Light source color	Correlated	Color
				Color Temperature (Nom)	rendering index (CRI)
910925866224	BGP762 LED110-/740 I	68° x 158°	740	4000 K	70
	DN10 DGR 32-48		neutral white		
910925866226	BGP762 LED180-/740 I	150° - 43° x 67°	740	4000 K	70
	DX10 DGR 32-48		neutral white		
910925866228	BGP762 LED139-/830 II	160° - 42° x 54°	830	3000 K	80
	DM11 DGR D9 62		warm white		

Order Code	Full Product Name	Luminaire light beam spread	Light source color	Correlated Color Temperature (Nom)	Color rendering index (CRI)
910925866229	BGP762 LED170-/830 II DW10 DGR 76	61° x 150°	830 warm white	3000 K	80
910925866245	BGP762 LED200-/740 I DW50 DGR 62	152° - 24° x 66°	740 neutral white	4000 K	70
910925866246	BGP762 LED210-/740 II DX70 DGR 76	106° x 86°	740 neutral white	4000 K	70
910925866252	BGP762 LED220-/740 II DW10 DGR SRG10 62	61° x 150°	740 neutral white	4000 K	70
910925863554	BGP760 LED10-/740 I DM10 DGR 32-48	157° - 33° x 55°	740 neutral white	4000 K	70
910925863555	BGP760 LED12-/830 II DM11 DGR D9 62	160° - 42° x 54°	830 warm white	3000 K	80
910925863556	BGP760 LED14-/740 I DN10 DGR 32-48	68° x 157°	740 neutral white	4000 K	70
910925863557	BGP760 LED16-/830 II DN11 DGR D11 62	53° x 71°	830 warm white	3000 K	80
910925863560	BGP760 LED22-/740 I DM50 DGR 32-48	154° - 31° x 54°	740 neutral white	4000 K	70
910925863563	BGP760 LED30-/830 II DW10 DGR 62	61° x 150°	830 warm white	3000 K	80
910925863566	BGP760 LED44-/740 I DW50 DGR 32-48	152° - 24° x 66°	740 neutral white	4000 K	70
910925863567	BGP760 LED49-/740 II DX70 DGR 62	106° x 44°	740 neutral white	4000 K	70
910925866249	BGP763 LED300-/740 I DW50 DGR 62	152° - 24° x 66°	740 neutral white	4000 K	70

Order Code	Full Product Name	Luminaire light beam spread	Light source color	Correlated Color Temperature (Nom)	Color rendering index (CRI)
910925866250	BGP763 LED260-/740 I DX10 DGR 32-48	150° - 43° x 67°	740 neutral white	4000 K	70
910925866251	BGP763 LED340-/740 II DW10 DGR SRG10 62	61° x 150°	740 neutral white	4000 K	70
910925866230	BGP761 LED45-/740 I DM10 DGR 32-48	157° - 33° x 55°	740 neutral white	4000 K	70
910925866231	BGP761 LED74-/740 I DM50 DGR 32-48	154° - 31° x 54°	740 neutral white	4000 K	70
910925866232	BGP761 LED94-/740 I DX10 DGR 32-48	150° - 43° x 67°	740 neutral white	4000 K	70
910925866234	BGP761 LED55-/740 I DN10 DGR 32-48	68° x 157°	740 neutral white	4000 K	70
910925866235	BGP761 LED84-/740 I DS50 DGR 32-48	32° x 29°	740 neutral white	4000 K	70
910925866238	BGP761 LED50-/830 II DM11 DGR D9 62	160° - 42° x 54°	830 warm white	3000 K	80
910925866239	BGP761 LED79-/830 II DM70 DGR DDF27 D18	-	830 warm white	3000 K	80
910925866240	BGP761 LED59-/830 II DN11 DGR D11 62	53° x 71°	830 warm white	3000 K	80
910925866241	BGP761 LED90-/740 II DW10 DGR 62	61° x 150°	740 neutral white	4000 K	70
910925866497	BGP761 LED119/740 I DM10 DGR 62 S	157° - 33° x 55°	740 neutral white	4000 K	70

Light Technical (2/2)

Order Code	Full Product Name	Luminous Flux	Number of light sources	Optic type outdoor
910925866220	BGP762 LED120-/830 II DN11 DGR D11 76	10,800 lm	-	Distribution narrow 11
910925866221	BGP762 LED159-/830 II DM70 DGR DDF27 D18	13,920 lm	-	Distribution medium 70
910925866222	BGP762 LED129-/740 I DM11 DGR 32-48	11,830 lm	-	Distribution medium 11
910925866224	BGP762 LED110-/740 I DN10 DGR 32-48	10,010 lm	-	Distribution narrow 10
910925866226	BGP762 LED180-/740 I DX10 DGR 32-48	15,480 lm	-	Distribution extra wide 10
910925866228	BGP762 LED139-/830 II DM11 DGR D9 62	12,740 lm	-	Distribution medium 11
910925866229	BGP762 LED170-/830 II DW10 DGR 76	15,300 lm	-	Distribution wide 10
910925866245	BGP762 LED200-/740 I DW50 DGR 62	17,200 lm	-	Distribution wide 50
910925866246	BGP762 LED210-/740 II DX70 DGR 76	18,060 lm	-	Distribution extra wide 70
910925866252	BGP762 LED220-/740 II DW10 DGR SRG10 62	19,800 lm	-	Distribution wide 10
910925863554	BGP760 LED10-/740 I DM10 DGR 32-48	900 lm	1	Distribution medium 10
910925863555	BGP760 LED12-/830 II DM11 DGR D9 62	1,092 lm	1	Distribution medium 11
910925863556	BGP760 LED14-/740 I DN10 DGR 32-48	1,274 lm	1	Distribution narrow 10
910925863557	BGP760 LED16-/830 II DN11 DGR D11 62	1,456 lm	1	Distribution narrow 11
910925863560	BGP760 LED22-/740 I DM50 DGR 32-48	2,002 lm	1	Distribution medium 50
910925863563	BGP760 LED30-/830 II DW10 DGR 62	2,730 lm	1	Distribution wide 10

Order Code	Full Product Name	Luminous Flux	Number of light sources	Optic type outdoor
910925863566	BGP760 LED44-/740 I DW50 DGR 32-48	3,784 lm	1	Distribution wide 50
910925863567	BGP760 LED49-/740 II DX70 DGR 62	4,263 lm	1	Distribution extra wide 70
910925866249	BGP763 LED300-/740 I DW50 DGR 62	25,200 lm	-	Distribution wide 50
910925866250	BGP763 LED260-/740 I DX10 DGR 32-48	22,100 lm	-	Distribution extra wide 10
910925866251	BGP763 LED340-/740 II DW10 DGR SRG10 62	29,920 lm	-	Distribution wide 10
910925866230	BGP761 LED45-/740 I DM10 DGR 32-48	4,050 lm	-	Distribution medium 10
910925866231	BGP761 LED74-/740 I DM50 DGR 32-48	6,660 lm	-	Distribution medium 50
910925866232	BGP761 LED94-/740 I DX10 DGR 32-48	8,084 lm	-	Distribution extra wide 10
910925866234	BGP761 LED55-/740 I DN10 DGR 32-48	5,096 lm	-	Distribution narrow 10
910925866235	BGP761 LED84-/740 I DS50 DGR 32-48	7,392 lm	-	Distribution symmetrical 50
910925866238	BGP761 LED50-/830 II DM11 DGR D9 62	4,550 lm	-	Distribution medium 11
910925866239	BGP761 LED79-/830 II DM70 DGR DDF27 D18	6,688 lm	-	Distribution medium 70
910925866240	BGP761 LED59-/830 II DN11 DGR D11 62	5,400 lm	-	Distribution narrow 11
910925866241	BGP761 LED90-/740 II DW10 DGR 62	8,100 lm	-	Distribution wide 10
910925866497	BGP761 LED119/740 I DM10 DGR 62 S	10,680 lm	-	Distribution medium 10

Operating and Electrical

Order Code	Full Product Name	Power Consumption	Surge Protection (Common/Differential)
910925866220	BGP762 LED120-/830 II DN11 DGR D11 76	81 W	Surge protection level until 6 kV differential mode and 8 kV common mode
910925866221	BGP762 LED159-/830 II DM70 DGR DDF27 D18	106 W	Surge protection level until 6 kV differential mode and 8 kV common mode
910925866222	BGP762 LED129-/740 I DM11 DGR 32-48	72 W	Surge protection level until 6 kV differential mode and 8 kV common mode
910925866224	BGP762 LED110-/740 I DN10 DGR 32-48	61 W	Surge protection level until 6 kV differential mode and 8 kV common mode

Order Code	Full Product Name	Power Consumption	Surge Protection (Common/Differential)
910925866226	BGP762 LED180-/740 I DX10 DGR 32-48	100 W	Surge protection level until 6 kV differential mode and 8 kV common mode
910925866228	BGP762 LED139-/830 II DM11 DGR D9 62	91 W	Surge protection level until 6 kV differential mode and 8 kV common mode
910925866229	BGP762 LED170-/830 II DW10 DGR 76	114 W	Surge protection level until 6 kV differential mode and 8 kV common mode
910925866245	BGP762 LED200-/740 I DW50 DGR 62	114 W	Surge protection level until 6 kV differential mode and 8 kV common mode

Order Code	Full Product Name	Power Consumption	Surge Protection (Common/Differential)
910925866246	BGP762 LED210-/740 II DX70 DGR 76	120 W	Surge protection level until 6 kV differential mode and 8 kV common mode
910925866252	BGP762 LED220-/740 II DW10 DGR SRG10 62	126 W	Surge protection level until 10 kV differential mode and 10 kV common mode
910925863554	BGP760 LED10-/740 I DM10 DGR 32-48	6.8 W	Surge protection level until 6 kV differential mode and 8 kV common mode
910925863555	BGP760 LED12-/830 II DM11 DGR D9 62	8 W	Surge protection level until 6 kV differential mode and 8 kV common mode
910925863556	BGP760 LED14-/740 I DN10 DGR 32-48	9 W	Surge protection level until 6 kV differential mode and 8 kV common mode
910925863557	BGP760 LED16-/830 II DN11 DGR D11 62	11.8 W	Surge protection level until 6 kV differential mode and 8 kV common mode
910925863560	BGP760 LED22-/740 I DM50 DGR 32-48	13.8 W	Surge protection level until 6 kV differential mode and 8 kV common mode
910925863563	BGP760 LED30-/830 II DW10 DGR 62	21 W	Surge protection level until 6 kV differential mode and 8 kV common mode
910925863566	BGP760 LED44-/740 I DW50 DGR 32-48	26 W	Surge protection level until 6 kV differential mode and 8 kV common mode
910925863567	BGP760 LED49-/740 II DX70 DGR 62	29.5 W	Surge protection level until 6 kV differential mode and 8 kV common mode
910925866249	BGP763 LED300-/740 I DW50 DGR 62	176 W	Surge protection level until 6 kV differential mode and 8 kV common mode
910925866250	BGP763 LED260-/740 I DX10 DGR 32-48	150 W	Surge protection level until 6 kV differential mode and 8 kV common mode

Order Code	Full Product Name	Power Consumption	Surge Protection (Common/Differential)
910925866251	BGP763 LED340-/740 II DW10 DGR SRG10 62	196 W	Surge protection level until 10 kV differential mode and 10 kV common mode
910925866230	BGP761 LED45-/740 I DM10 DGR 32-48	27 W	Surge protection level until 6 kV differential mode and 8 kV common mode
910925866231	BGP761 LED74-/740 I DM50 DGR 32-48	43.5 W	Surge protection level until 6 kV differential mode and 8 kV common mode
910925866232	BGP761 LED94-/740 I DX10 DGR 32-48	54 W	Surge protection level until 6 kV differential mode and 8 kV common mode
910925866234	BGP761 LED55-/740 I DN10 DGR 32-48	31.5 W	Surge protection level until 6 kV differential mode and 8 kV common mode
910925866235	BGP761 LED84-/740 I DS50 DGR 32-48	49.5 W	Surge protection level until 6 kV differential mode and 8 kV common mode
910925866238	BGP761 LED50-/830 II DM11 DGR D9 62	34 W	Surge protection level until 6 kV differential mode and 8 kV common mode
910925866239	BGP761 LED79-/830 II DM70 DGR DDF27 D18	54 W	Surge protection level until 6 kV differential mode and 8 kV common mode
910925866240	BGP761 LED59-/830 II DN11 DGR D11 62	41 W	Surge protection level until 6 kV differential mode and 8 kV common mode
910925866241	BGP761 LED90-/740 II DW10 DGR 62	51 W	Surge protection level until 6 kV differential mode and 8 kV common mode
910925866497	BGP761 LED119/740 I DM10 DGR 62 S	72 W	Surge protection level until 6 kV differential mode and 8 kV common mode

Controls and Dimming

Order Code	Full Product Name	Dimmable	Maximum dim level
910925866220	BGP762 LED120-/830 II DN11 DGR D11 76	Yes	Not applicable
910925866221	BGP762 LED159-/830 II DM70 DGR DDF27 D18	Yes	50%
910925866222	BGP762 LED129-/740 I DM11 DGR 32-48	No	Not applicable
910925866224	BGP762 LED110-/740 I DN10 DGR 32-48	No	Not applicable
910925866226	BGP762 LED180-/740 I DX10 DGR 32-48	No	Not applicable

Order Code	Full Product Name	Dimmable	Maximum dim level
910925866228	BGP762 LED139-/830 II DM11 DGR D9 62	Yes	Not applicable
910925866229	BGP762 LED170-/830 II DW10 DGR 76	No	Not applicable
910925866245	BGP762 LED200-/740 I DW50 DGR 62	No	Not applicable
910925866246	BGP762 LED210-/740 II DX70 DGR 76	No	Not applicable
910925866252	BGP762 LED220-/740 II DW10 DGR SRG10 62	No	Not applicable
910925863554	BGP760 LED10-/740 I DM10 DGR 32-48	No	Not applicable
910925863555	BGP760 LED12-/830 II DM11 DGR D9 62	Yes	Not applicable
910925863556	BGP760 LED14-/740 I DN10 DGR 32-48	No	Not applicable

Order Code	Full Product Name	Dimmable	Maximum dim level
910925863557	BGP760 LED16-/830 II DN11 DGR D11 62	Yes	Not applicable
910925863560	BGP760 LED22-/740 I DM50 DGR 32-48	No	Not applicable
910925863563	BGP760 LED30-/830 II DW10 DGR 62	No	Not applicable
910925863566	BGP760 LED44-/740 I DW50 DGR 32-48	No	Not applicable
910925863567	BGP760 LED49-/740 II DX70 DGR 62	No	Not applicable
910925866249	BGP763 LED300-/740 I DW50 DGR 62	No	Not applicable
910925866250	BGP763 LED260-/740 I DX10 DGR 32-48	No	Not applicable
910925866251	BGP763 LED340-/740 II DW10 DGR SRG10 62	No	Not applicable

Order Code	Full Product Name	Dimmable	Maximum dim level
910925866230	BGP761 LED45-/740 I DM10 DGR 32-48	No	Not applicable
910925866231	BGP761 LED74-/740 I DM50 DGR 32-48	No	Not applicable
910925866232	BGP761 LED94-/740 I DX10 DGR 32-48	No	Not applicable
910925866234	BGP761 LED55-/740 I DN10 DGR 32-48	No	Not applicable
910925866235	BGP761 LED84-/740 I DS50 DGR 32-48	No	Not applicable
910925866238	BGP761 LED50-/830 II DM11 DGR D9 62	Yes	Not applicable
910925866239	BGP761 LED79-/830 II DM70 DGR DDF27 D18	Yes	50%
910925866240	BGP761 LED59-/830 II DN11 DGR D11 62	Yes	Not applicable
910925866241	BGP761 LED90-/740 II DW10 DGR 62	No	Not applicable
910925866497	BGP761 LED119/740 I DM10 DGR 62 S	Yes	Not applicable

Approval and Application

Order Code	Full Product Name	Glow-wire test
910925866220	BGP762 LED120-/830 II DN11 DGR D11 76	-
910925866221	BGP762 LED159-/830 II DM70 DGR DDF27 D18	-
910925866222	BGP762 LED129-/740 I DM11 DGR 32-48	-
910925866224	BGP762 LED110-/740 I DN10 DGR 32-48	-
910925866226	BGP762 LED180-/740 I DX10 DGR 32-48	-
910925866228	BGP762 LED139-/830 II DM11 DGR D9 62	-
910925866229	BGP762 LED170-/830 II DW10 DGR 76	-
910925866245	BGP762 LED200-/740 I DW50 DGR 62	-
910925866246	BGP762 LED210-/740 II DX70 DGR 76	-
910925866252	BGP762 LED220-/740 II DW10 DGR SRG10 62	-
910925863554	BGP760 LED10-/740 I DM10 DGR 32-48	Temperature 650 °C, duration 5 s
910925863555	BGP760 LED12-/830 II DM11 DGR D9 62	Temperature 650 °C, duration 5 s
910925863556	BGP760 LED14-/740 I DN10 DGR 32-48	Temperature 650 °C, duration 5 s
910925863557	BGP760 LED16-/830 II DN11 DGR D11 62	Temperature 650 °C, duration 5 s
910925863560	BGP760 LED22-/740 I DM50 DGR 32-48	Temperature 650 °C, duration 5 s

Order Code	Full Product Name	Glow-wire test
910925863563	BGP760 LED30-/830 II DW10 DGR 62	Temperature 650 °C, duration 5 s
910925863566	BGP760 LED44-/740 I DW50 DGR 32-48	Temperature 650 °C, duration 5 s
910925863567	BGP760 LED49-/740 II DX70 DGR 62	Temperature 650 °C, duration 5 s
910925866249	BGP763 LED300-/740 I DW50 DGR 62	-
910925866250	BGP763 LED260-/740 I DX10 DGR 32-48	-
910925866251	BGP763 LED340-/740 II DW10 DGR SRG10 62	-
910925866230	BGP761 LED45-/740 I DM10 DGR 32-48	-
910925866231	BGP761 LED74-/740 I DM50 DGR 32-48	-
910925866232	BGP761 LED94-/740 I DX10 DGR 32-48	-
910925866234	BGP761 LED55-/740 I DN10 DGR 32-48	-
910925866235	BGP761 LED84-/740 I DS50 DGR 32-48	-
910925866238	BGP761 LED50-/830 II DM11 DGR D9 62	-
910925866239	BGP761 LED79-/830 II DM70 DGR DDF27 D18	-
910925866240	BGP761 LED59-/830 II DN11 DGR D11 62	-
910925866241	BGP761 LED90-/740 II DW10 DGR 62	-
910925866497	BGP761 LED119/740 I DM10 DGR 62 S	-

Product Data

Order Code	Full Product Name	Product family code
910925866220	BGP762 LED120-/830 II DN11 DGR D11 76	BGP762
910925866221	BGP762 LED159-/830 II DM70 DGR DDF27 D18	BGP762
910925866222	BGP762 LED129-/740 I DM11 DGR 32-48	BGP762
910925866224	BGP762 LED110-/740 I DN10 DGR 32-48	BGP762
910925866226	BGP762 LED180-/740 I DX10 DGR 32-48	BGP762
910925866228	BGP762 LED139-/830 II DM11 DGR D9 62	BGP762
910925866229	BGP762 LED170-/830 II DW10 DGR 76	BGP762
910925866245	BGP762 LED200-/740 I DW50 DGR 62	BGP762
910925866246	BGP762 LED210-/740 II DX70 DGR 76	BGP762

Order Code	Full Product Name	Product family code
910925866252	BGP762 LED220-/740 II DW10 DGR SRG10 62	BGP762
910925863554	BGP760 LED10-/740 I DM10 DGR 32-48	BGP760
910925863555	BGP760 LED12-/830 II DM11 DGR D9 62	BGP760
910925863556	BGP760 LED14-/740 I DN10 DGR 32-48	BGP760
910925863557	BGP760 LED16-/830 II DN11 DGR D11 62	BGP760
910925863560	BGP760 LED22-/740 I DM50 DGR 32-48	BGP760
910925863563	BGP760 LED30-/830 II DW10 DGR 62	BGP760
910925863566	BGP760 LED44-/740 I DW50 DGR 32-48	BGP760
910925863567	BGP760 LED49-/740 II DX70 DGR 62	BGP760

Order Code	Full Product Name	Product family code
910925866249	BGP763 LED300-/740 I DW50 DGR 62	BGP763
910925866250	BGP763 LED260-/740 I DX10 DGR 32-48	BGP763
910925866251	BGP763 LED340-/740 II DW10 DGR SRG10 62	BGP763
910925866230	BGP761 LED45-/740 I DM10 DGR 32-48	BGP761
910925866231	BGP761 LED74-/740 I DM50 DGR 32-48	BGP761
910925866232	BGP761 LED94-/740 I DX10 DGR 32-48	BGP761
910925866234	BGP761 LED55-/740 I DN10 DGR 32-48	BGP761

Order Code	Full Product Name	Product family code
910925866235	BGP761 LED84-/740 I DS50 DGR 32-48	BGP761
910925866238	BGP761 LED50-/830 II DM11 DGR D9 62	BGP761
910925866239	BGP761 LED79-/830 II DM70 DGR DDF27 D18	BGP761
910925866240	BGP761 LED59-/830 II DN11 DGR D11 62	BGP761
910925866241	BGP761 LED90-/740 II DW10 DGR 62	BGP761
910925866497	BGP761 LED119/740 I DM10 DGR 62 S	BGP761

Polar Wide Diagrams

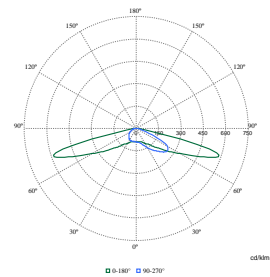
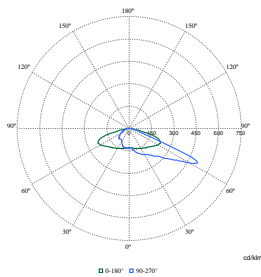
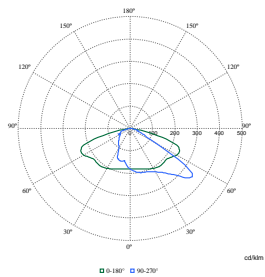

Polar Normal (separate) - BGP762I - 910925866229

Polar Normal (separate) - BGP761I - 910925866232

Polar Normal (separate) - BGP763I - 910925866249

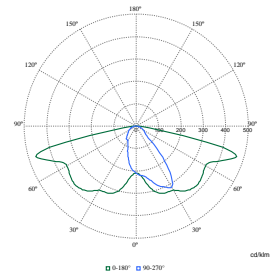
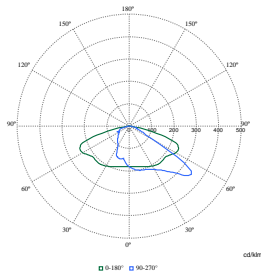
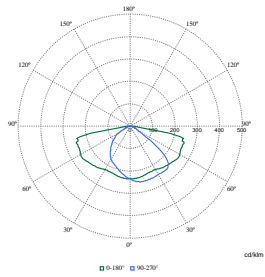

Polar Normal (separate) - BGP762I - 910925866228

Polar Normal (separate) - BGP763I - 910925866251

Polar Normal (separate) - BGP762I - 910925866220

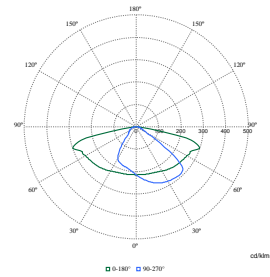
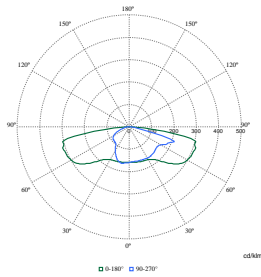
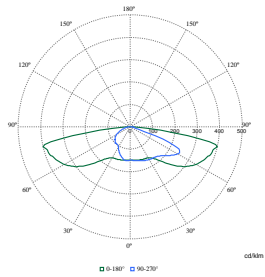

Polar Normal (separate) - BGP762I - 910925866221

Polar Normal (separate) - BGP762I - 910925866246

Polar Normal (separate) - BGP761I - 910925866497

Polar Wide Diagrams

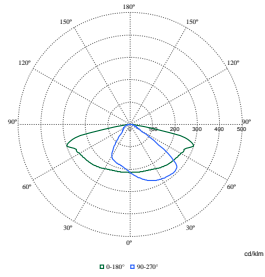

Polar Normal (separate) - BGP7601 - 910925863554

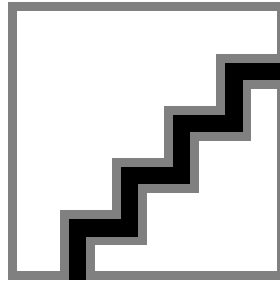

Polar Normal (separate) - BGP7601 - 910925863567

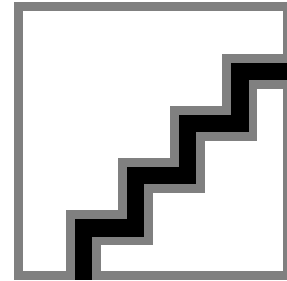

Polar Normal (separate) - BGP7601 - 910925863563

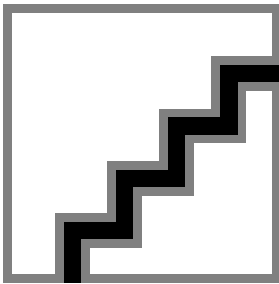

Polar Normal (separate) - BGP7601 - 910925863566

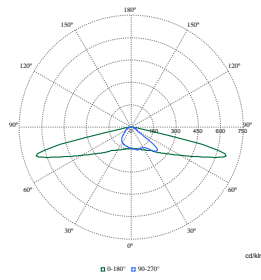

Polar Normal (separate) - BGP7601 - 910925863560

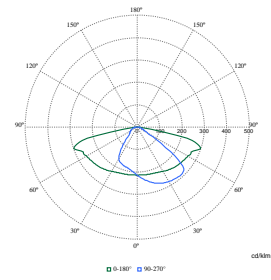

Polar Normal (separate) - BGP7611 - 910925866230

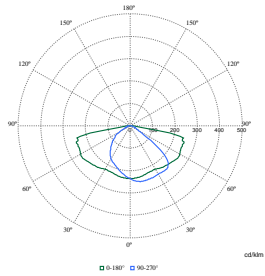

Polar Normal (separate) - BGP7611 - 910925866238

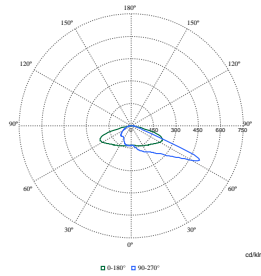

Polar Normal (separate) - BGP7631 - 910925866250

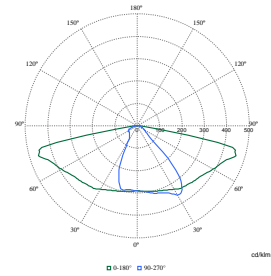

Polar Normal (separate) - BGP7621 - 910925866224

Polar Wide Diagrams

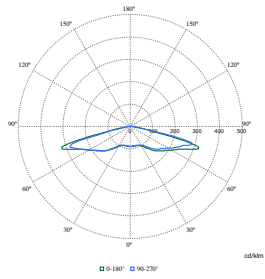

Polar Normal (separate) - BGP7611 - 910925866235

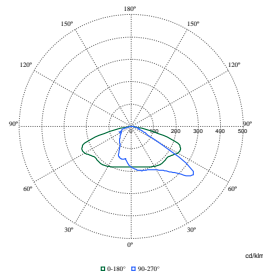

Polar Normal (separate) - BGP7611 - 910925866241

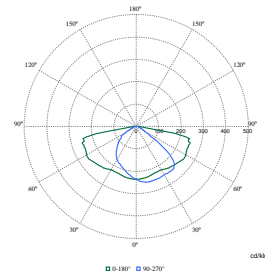

Polar Normal (separate) - BGP7621 - 910925866222

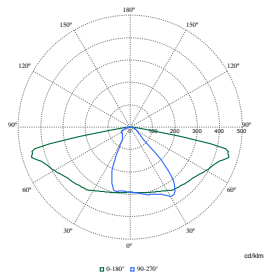

Polar Normal (separate) - BGP7611 - 910925866234

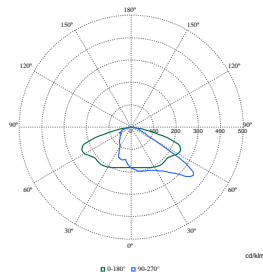

Polar Normal (separate) - BGP7621 - 910925866252

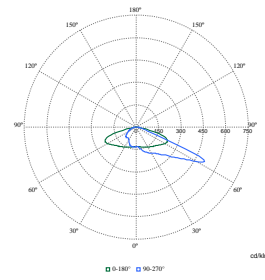

Polar Normal (separate) - BGP7621 - 910925866226

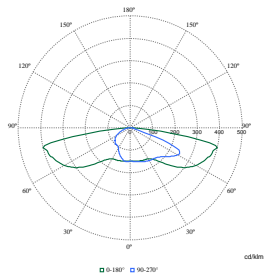

Polar Normal (separate) - BGP7611 - 910925866239

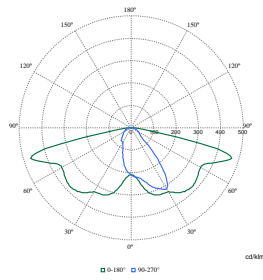

Polar Normal (separate) - BGP7611 - 910925866240

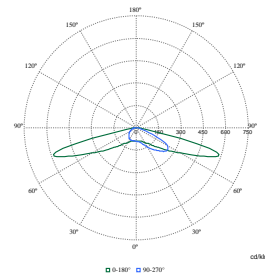

Polar Normal (separate) - BGP7621 - 910925866245

Polar Wide Diagrams

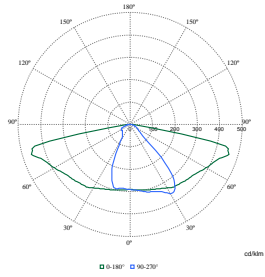

Polar Normal (separate) - BGP7601 - 910925863556

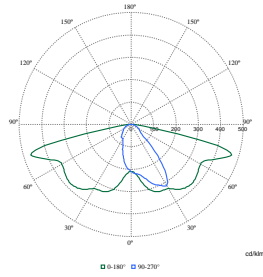

Polar Normal (separate) - BGP7601 - 910925863557

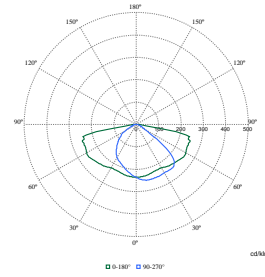

Polar Normal (separate) - BGP7601 - 910925863555

