



Get your city ready for the future with DigiStreet

DigiStreet

Developed with the aim to become your long term partner, the system ready architecture of DigiStreet enables you to enjoy the benefits of connected lighting systems today and also gets the city ready for the innovations to come!. Its two sockets enable you to connect directly to the CityTouch system and is also prepared to connect you to the future innovations of IoT. Next to this, each individual luminaire is uniquely identifiable, thanks to the Service tag application. With a simple scan of a QR code, placed on the inside of the mast door, you gain instant access to the luminaire configuration, making maintenance and programming operations faster and easier, no matter what stage of the luminaire's lifetime. DigiStreet is also equipped with dedicated light recipes that: 1) maintain an optimal ecosystems for bats or 2) preserve a dark night sky.

Benefits

- Prepared for the future, it is easy to upgrade directly after installation or later with future CMS nodes and sensors to enable new functionalities
- Large availability of lense optics to match international road and street geometries
- Equipped with Service tag, a QR-based identification system that makes each luminaire uniquely identifiable and provides maintenance, installation and spare part information

Features

- Easy luminaire identification due to the Service tag
- High efficacy up to 161 lm/W
- Choice of 30+ different beams and different internal louvers
- Surge protection, 10 kV
- L-tune tool available
- Lifetime 100Khrs up to L96 at Tq +25 °C
- Internal louver (optional)

Application

- Traffic routes and main access road
- Urban and residential area
- City centers and main streets
- Cycle paths, footpaths and pedestrian crossings

Versions



Digistreet-BGP762-DP03



Digistreet-BGP763-DP04

Dimensional drawing

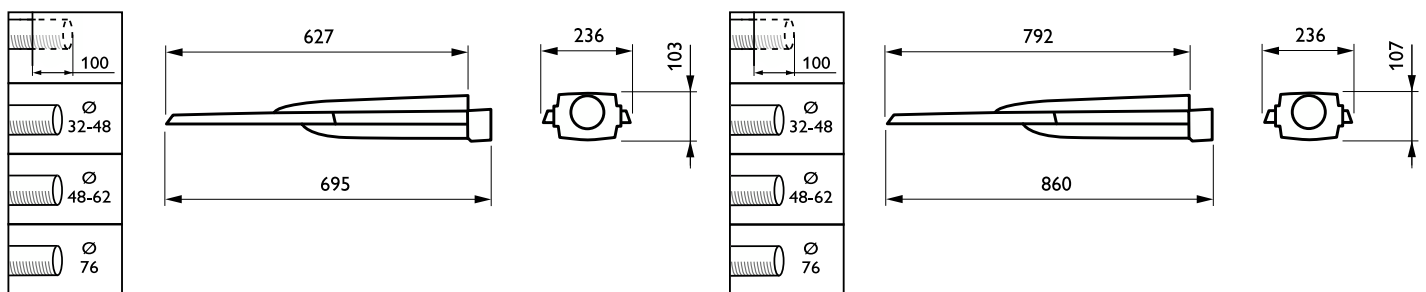

Dimensional drawing

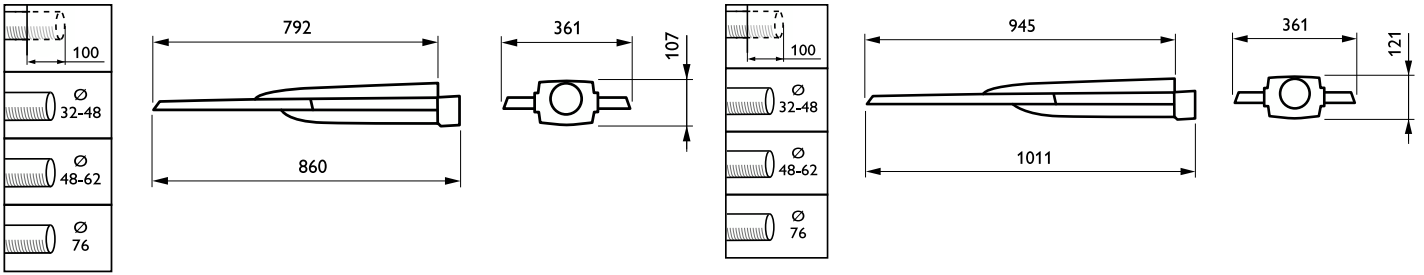

Product details

Digistreet-BGP760-DP06.tif



Digistreet-BGP760-DP09.tif



Digistreet-BGP760-DP10.tif



Digistreet-BGP760-DP11.tif



Digistreet-BGP761-DP17.tif



Digistreet-BGP761-DP18.tif

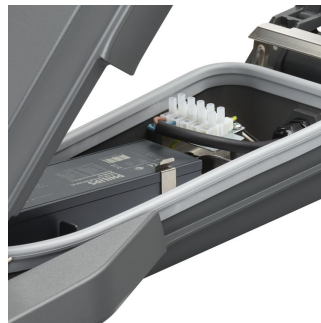

Product details

Digistreet-BGP761-DP19.tif

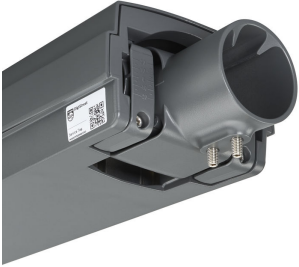

Digistreet-BGP761-DP20.tif



Digistreet-BGP761-DP21.tif



Digistreet-BGP761-DP22.tif



Digistreet-BGP761-DP23.tif



Digistreet-BGP761-DP24.tif



Digistreet-BGP761-DP25.tif



Digistreet-BGP761-DP26.tif



General Information	
Driver included	Yes
Light source replaceable	Yes
Service tag	Yes
Light Technical	
Upward light output ratio	0
Mechanical and Housing	
Optical cover type	Flat glass
Housing Color	Dark gray
Mech. impact protection code	IK09
Ingress protection code	IP66
Standard tilt angle side entry	0°
Standard tilt angle posttop	0°
Approval and Application	
CE mark	Yes
Flammability mark	-

General Information

Order Code	Full Product Name	Gear	Lamp family code	Number of gear units
37827400	BGP762 LED120-/830 II DN11 DGR D11 76	-	LED120	1 unit
37831100	BGP762 LED159-/830 II DM70 DGR DDF27 D18	-	LED159	1 unit
37828100	BGP762 LED129-/740 I DM11 DGR 32-48	-	LED129	1 unit
37826700	BGP762 LED110-/740 I DN10 DGR 32-48	-	LED110	1 unit
37834200	BGP762 LED180-/740 I DX10 DGR 32-48	-	LED180	1 unit
37829800	BGP762 LED139-/830 II DM11 DGR D9 62	-	LED139	1 unit
37833500	BGP762 LED170-/830 II DW10 DGR 76	-	LED170	1 unit
37836600	BGP762 LED200-/740 I DW50 DGR 62	-	LED200	1 unit
37837300	BGP762 LED210-/740 II DX70 DGR 76	-	LED210	1 unit
37838000	BGP762 LED220-/740 II DW10 DGR SRG10 62	-	LED220	1 unit
37679900	BGP760 LED10-/740 I DM10 DGR 32-48	EB	LED10	1 unit
37680500	BGP760 LED12-/830 II DM11 DGR D9 62	EB	LED12	1 unit
37681200	BGP760 LED14-/740 I DN10 DGR 32-48	EB	LED14	1 unit
37682900	BGP760 LED16-/830 II DN11 DGR D11 62	EB	LED16	1 unit
37685000	BGP760 LED22-/740 I DM50 DGR 32-48	EB	LED22	1 unit
37688100	BGP760 LED30-/830 II DW10 DGR 62	EB	LED30	1 unit
37691100	BGP760 LED44-/740 I DW50 DGR 32-48	EB	LED44	1 unit
37692800	BGP760 LED49-/740 II DX70 DGR 62	EB	LED49	1 unit
37842700	BGP763 LED300-/740 I DW50 DGR 62	-	LED300	2 units
37840300	BGP763 LED260-/740 I DX10 DGR 32-48	-	LED260	2 units
37844100	BGP763 LED340-/740 II DW10 DGR SRG10 62	-	LED340	2 units
37693500	BGP761 LED45-/740 I DM10 DGR 32-48	-	LED45	1 unit
37699700	BGP761 LED74-/740 I DM50 DGR 32-48	-	LED74	1 unit
37703100	BGP761 LED94-/740 I DX10 DGR 32-48	-	LED94	1 unit
37695900	BGP761 LED55-/740 I DN10 DGR 32-48	-	LED55	1 unit
37701700	BGP761 LED84-/740 I DS50 DGR 32-48	-	LED84	1 unit
37694200	BGP761 LED50-/830 II DM11 DGR D9 62	-	LED50	1 unit
37700000	BGP761 LED79-/830 II DM70 DGR DDF27 D18	-	LED79	1 unit
37696600	BGP761 LED59-/830 II DN11 DGR D11 62	-	LED59	1 unit
37702400	BGP761 LED90-/740 II DW10 DGR 62	-	LED90	1 unit
05930600	BGP761 LED119/740 I DM10 DGR 62 S	-	LED119	1 unit

Light Technical (1/2)

Order Code	Full Product Name	Luminaire light beam spread	Light source color	Correlated Color Temperature (Nom)	Color rendering index (CRI)
37827400	BGP762 LED120-/830 II DN11 DGR D11 76	53° x 71°	830 warm white	3000 K	80
37831100	BGP762 LED159-/830 II DM70 DGR DDF27 D18	-	830 warm white	3000 K	80
37828100	BGP762 LED129-/740 I DM11 DGR 32-48	160° - 42° x 54°	740 neutral white	4000 K	70

Order Code	Full Product Name	Luminaire light beam spread	Light source color	Correlated Color Temperature (Nom)	Color rendering index (CRI)
37826700	BGP762 LED110-/740 I DN10 DGR 32-48	68° x 158°	740 neutral white	4000 K	70
37834200	BGP762 LED180-/740 I DX10 DGR 32-48	150° - 43° x 67°	740 neutral white	4000 K	70
37829800	BGP762 LED139-/830 II DM11 DGR D9 62	160° - 42° x 54°	830 warm white	3000 K	80
37833500	BGP762 LED170-/830 II DW10 DGR 76	61° x 150°	830 warm white	3000 K	80

Order Code	Full Product Name	Luminaire light beam spread	Light source color	Correlated Color Temperature (Nom)	Color rendering index (CRI)
37836600	BGP762	152° - 24° x	740	4000 K	70
	LED200-/740 I	66°	neutral		
	DW50 DGR 62		white		
37837300	BGP762	106° x 86°	740	4000 K	70
	LED210-/740 II		neutral		
	DX70 DGR 76		white		
37838000	BGP762	61° x 150°	740	4000 K	70
	LED220-/740 II		neutral		
	DW10 DGR SRG10 62		white		
37679900	BGP760	157° - 33° x	740	4000 K	70
	LED10-/740 I	55°	neutral		
	DM10 DGR 32-48		white		
37680500	BGP760	160° - 42° x	830 warm	3000 K	80
	LED12-/830 II	54°	white		
	DM11 DGR D9 62				
37681200	BGP760	68° x 157°	740	4000 K	70
	LED14-/740 I DN10		neutral		
	DGR 32-48		white		
37682900	BGP760	53° x 71°	830 warm	3000 K	80
	LED16-/830 II		white		
	DN11 DGR D11 62				
37685000	BGP760	154° - 31° x 54°	740	4000 K	70
	LED22-/740 I		neutral		
	DM50 DGR 32-48		white		
37688100	BGP760	61° x 150°	830 warm	3000 K	80
	LED30-/830 II		white		
	DW10 DGR 62				
37691100	BGP760	152° - 24° x	740	4000 K	70
	LED44-/740 I	66°	neutral		
	DW50 DGR 32-48		white		
37692800	BGP760	106° x 44°	740	4000 K	70
	LED49-/740 II		neutral		
	DX70 DGR 62		white		
37842700	BGP763	152° - 24° x	740	4000 K	70
	LED300-/740 I	66°	neutral		
	DW50 DGR 62		white		
37840300	BGP763	150° - 43° x	740	4000 K	70
	LED260-/740 I	67°	neutral		
	DX10 DGR 32-48		white		

Order Code	Full Product Name	Luminaire light beam spread	Light source color	Correlated Color Temperature (Nom)	Color rendering index (CRI)
37844100	BGP763	61° x 150°	740	4000 K	70
	LED340-/740 II		neutral		
	DW10 DGR SRG10 62		white		
37693500	BGP761	157° - 33° x	740	4000 K	70
	LED45-/740 I	55°	neutral		
	DM10 DGR 32-48		white		
37699700	BGP761	154° - 31° x 54°	740	4000 K	70
	LED74-/740 I		neutral		
	DM50 DGR 32-48		white		
37703100	BGP761	150° - 43° x	740	4000 K	70
	LED94-/740 I	67°	neutral		
	DX10 DGR 32-48		white		
37695900	BGP761	68° x 157°	740	4000 K	70
	LED55-/740 I		neutral		
	DN10 DGR 32-48		white		
37701700	BGP761	32° x 29°	740	4000 K	70
	LED84-/740 I		neutral		
	DS50 DGR 32-48		white		
37694200	BGP761	160° - 42° x	830 warm	3000 K	80
	LED50-/830 II	54°	white		
	DM11 DGR D9 62				
37700000	BGP761	-	830 warm	3000 K	80
	LED79-/830 II		white		
	DM70 DGR DDF27 D18				
37696600	BGP761	53° x 71°	830 warm	3000 K	80
	LED59-/830 II		white		
	DN11 DGR D11 62				
37702400	BGP761	61° x 150°	740	4000 K	70
	LED90-/740 II		neutral		
	DW10 DGR 62		white		
05930600	BGP761	157° - 33° x	740	4000 K	70
	LED119/740 I	55°	neutral		
	DM10 DGR 62 S		white		

Light Technical (2/2)

Order Code	Full Product Name	Luminous Flux	Number of light sources	Optic type outdoor
37827400	BGP762 LED120-/830 II	10,800 lm	-	Distribution narrow 11
	DN11 DGR D11 76			

Order Code	Full Product Name	Luminous Flux	Number of light sources	Optic type outdoor
37831100	BGP762 LED159-/830 II	13,920 lm	-	Distribution medium 70
	DM70 DGR DDF27 D18			

Order Code	Full Product Name	Luminous Flux	Number of light sources	Optic type outdoor
37828100	BGP762 LED129-/740 I DM11 DGR 32-48	11,830 lm	-	Distribution medium 11
37826700	BGP762 LED110-/740 I DN10 DGR 32-48	10,010 lm	-	Distribution narrow 10
37834200	BGP762 LED180-/740 I DX10 DGR 32-48	15,480 lm	-	Distribution extra wide 10
37829800	BGP762 LED139-/830 II DM11 DGR D9 62	12,740 lm	-	Distribution medium 11
37833500	BGP762 LED170-/830 II DW10 DGR 76	15,300 lm	-	Distribution wide 10
37836600	BGP762 LED200-/740 I DW50 DGR 62	17,200 lm	-	Distribution wide 50
37837300	BGP762 LED210-/740 II DX70 DGR 76	18,060 lm	-	Distribution extra wide 70
37838000	BGP762 LED220-/740 II DW10 DGR SRG10 62	19,800 lm	-	Distribution wide 10
37679900	BGP760 LED10-/740 I DM10 DGR 32-48	900 lm	1	Distribution medium 10
37680500	BGP760 LED12-/830 II DM11 DGR D9 62	1,092 lm	1	Distribution medium 11
37681200	BGP760 LED14-/740 I DN10 DGR 32-48	1,274 lm	1	Distribution narrow 10
37682900	BGP760 LED16-/830 II DN11 DGR D11 62	1,456 lm	1	Distribution narrow 11
37685000	BGP760 LED22-/740 I DM50 DGR 32-48	2,002 lm	1	Distribution medium 50
37688100	BGP760 LED30-/830 II DW10 DGR 62	2,730 lm	1	Distribution wide 10
37691100	BGP760 LED44-/740 I DW50 DGR 32-48	3,784 lm	1	Distribution wide 50

Order Code	Full Product Name	Luminous Flux	Number of light sources	Optic type outdoor
37692800	BGP760 LED49-/740 II DX70 DGR 62	4,263 lm	1	Distribution extra wide 70
37842700	BGP763 LED300-/740 I DW50 DGR 62	25,200 lm	-	Distribution wide 50
37840300	BGP763 LED260-/740 I DX10 DGR 32-48	22,100 lm	-	Distribution extra wide 10
37844100	BGP763 LED340-/740 II DW10 DGR SRG10 62	29,920 lm	-	Distribution wide 10
37693500	BGP761 LED45-/740 I DM10 DGR 32-48	4,050 lm	-	Distribution medium 10
37699700	BGP761 LED74-/740 I DM50 DGR 32-48	6,660 lm	-	Distribution medium 50
37703100	BGP761 LED94-/740 I DX10 DGR 32-48	8,084 lm	-	Distribution extra wide 10
37695900	BGP761 LED55-/740 I DN10 DGR 32-48	5,096 lm	-	Distribution narrow 10
37701700	BGP761 LED84-/740 I DS50 DGR 32-48	7,392 lm	-	Distribution symmetrical 50
37694200	BGP761 LED50-/830 II DM11 DGR D9 62	4,550 lm	-	Distribution medium 11
37700000	BGP761 LED79-/830 II DM70 DGR DDF27 D18	6,688 lm	-	Distribution medium 70
37696600	BGP761 LED59-/830 II DN11 DGR D11 62	5,400 lm	-	Distribution narrow 11
37702400	BGP761 LED90-/740 II DW10 DGR 62	8,100 lm	-	Distribution wide 10
05930600	BGP761 LED119/740 I DM10 DGR 62 S	10,680 lm	-	Distribution medium 10

Operating and Electrical

Order Code	Full Product Name	Power Consumption	Surge Protection (Common/Differential)
37827400	BGP762 LED120-/830 II DN11 DGR D11 76	81 W	Surge protection level until 6 kV differential mode and 8 kV common mode
37831100	BGP762 LED159-/830 II DM70 DGR DDF27 D18	106 W	Surge protection level until 6 kV differential mode and 8 kV common mode
37828100	BGP762 LED129-/740 I DM11 DGR 32-48	72 W	Surge protection level until 6 kV differential mode and 8 kV common mode
37826700	BGP762 LED110-/740 I DN10 DGR 32-48	61 W	Surge protection level until 6 kV differential mode and 8 kV common mode
37834200	BGP762 LED180-/740 I DX10 DGR 32-48	100 W	Surge protection level until 6 kV differential mode and 8 kV common mode

Order Code	Full Product Name	Power Consumption	Surge Protection (Common/Differential)
37829800	BGP762 LED139-/830 II DM11 DGR D9 62	91 W	Surge protection level until 6 kV differential mode and 8 kV common mode
37833500	BGP762 LED170-/830 II DW10 DGR 76	114 W	Surge protection level until 6 kV differential mode and 8 kV common mode
37836600	BGP762 LED200-/740 I DW50 DGR 62	114 W	Surge protection level until 6 kV differential mode and 8 kV common mode
37837300	BGP762 LED210-/740 II DX70 DGR 76	120 W	Surge protection level until 6 kV differential mode and 8 kV common mode
37838000	BGP762 LED220-/740 II DW10 DGR SRG10 62	126 W	Surge protection level until 10 kV differential mode and 10 kV common mode

Order Code	Full Product Name	Power Consumption	Surge Protection (Common/Differential)
37679900	BGP760 LED10-/740 I DM10 DGR 32-48	6.8 W	Surge protection level until 6 kV differential mode and 8 kV common mode
37680500	BGP760 LED12-/830 II DM11 DGR D9 62	8 W	Surge protection level until 6 kV differential mode and 8 kV common mode
37681200	BGP760 LED14-/740 I DN10 DGR 32-48	9 W	Surge protection level until 6 kV differential mode and 8 kV common mode
37682900	BGP760 LED16-/830 II DN11 DGR D11 62	11.8 W	Surge protection level until 6 kV differential mode and 8 kV common mode
37685000	BGP760 LED22-/740 I DM50 DGR 32-48	13.8 W	Surge protection level until 6 kV differential mode and 8 kV common mode
37688100	BGP760 LED30-/830 II DW10 DGR 62	21 W	Surge protection level until 6 kV differential mode and 8 kV common mode
37691100	BGP760 LED44-/740 I DW50 DGR 32-48	26 W	Surge protection level until 6 kV differential mode and 8 kV common mode
37692800	BGP760 LED49-/740 II DX70 DGR 62	29.5 W	Surge protection level until 6 kV differential mode and 8 kV common mode
37842700	BGP763 LED300-/740 I DW50 DGR 62	176 W	Surge protection level until 6 kV differential mode and 8 kV common mode
37840300	BGP763 LED260-/740 I DX10 DGR 32-48	150 W	Surge protection level until 6 kV differential mode and 8 kV common mode
37844100	BGP763 LED340-/740 II DW10 DGR SRG10 62	196 W	Surge protection level until 10 kV differential mode and 10 kV common mode

Order Code	Full Product Name	Power Consumption	Surge Protection (Common/Differential)
37693500	BGP761 LED45-/740 I DM10 DGR 32-48	27 W	Surge protection level until 6 kV differential mode and 8 kV common mode
37699700	BGP761 LED74-/740 I DM50 DGR 32-48	43.5 W	Surge protection level until 6 kV differential mode and 8 kV common mode
37703100	BGP761 LED94-/740 I DX10 DGR 32-48	54 W	Surge protection level until 6 kV differential mode and 8 kV common mode
37695900	BGP761 LED55-/740 I DN10 DGR 32-48	31.5 W	Surge protection level until 6 kV differential mode and 8 kV common mode
37701700	BGP761 LED84-/740 I DS50 DGR 32-48	49.5 W	Surge protection level until 6 kV differential mode and 8 kV common mode
37694200	BGP761 LED50-/830 II DM11 DGR D9 62	34 W	Surge protection level until 6 kV differential mode and 8 kV common mode
37700000	BGP761 LED79-/830 II DM70 DGR DDF27 D18	54 W	Surge protection level until 6 kV differential mode and 8 kV common mode
37696600	BGP761 LED59-/830 II DN11 DGR D11 62	41 W	Surge protection level until 6 kV differential mode and 8 kV common mode
37702400	BGP761 LED90-/740 II DW10 DGR 62	51 W	Surge protection level until 6 kV differential mode and 8 kV common mode
05930600	BGP761 LED119/740 I DM10 DGR 62 S	72 W	Surge protection level until 6 kV differential mode and 8 kV common mode

Controls and Dimming

Order Code	Full Product Name	Dimmable	Maximum dim level
37827400	BGP762 LED120-/830 II DN11 DGR D11 76	Yes	Not applicable
37831100	BGP762 LED159-/830 II DM70 DGR DDF27 D18	Yes	50%
37828100	BGP762 LED129-/740 I DM11 DGR 32-48	No	Not applicable
37826700	BGP762 LED110-/740 I DN10 DGR 32-48	No	Not applicable
37834200	BGP762 LED180-/740 I DX10 DGR 32-48	No	Not applicable
37829800	BGP762 LED139-/830 II DM11 DGR D9 62	Yes	Not applicable
37833500	BGP762 LED170-/830 II DW10 DGR 76	No	Not applicable
37836600	BGP762 LED200-/740 I DW50 DGR 62	No	Not applicable
37837300	BGP762 LED210-/740 II DX70 DGR 76	No	Not applicable
37838000	BGP762 LED220-/740 II DW10 DGR SRG10 62	No	Not applicable
37679900	BGP760 LED10-/740 I DM10 DGR 32-48	No	Not applicable

Order Code	Full Product Name	Dimmable	Maximum dim level
37680500	BGP760 LED12-/830 II DM11 DGR D9 62	Yes	Not applicable
37681200	BGP760 LED14-/740 I DN10 DGR 32-48	No	Not applicable
37682900	BGP760 LED16-/830 II DN11 DGR D11 62	Yes	Not applicable
37685000	BGP760 LED22-/740 I DM50 DGR 32-48	No	Not applicable
37688100	BGP760 LED30-/830 II DW10 DGR 62	No	Not applicable
37691100	BGP760 LED44-/740 I DW50 DGR 32-48	No	Not applicable
37692800	BGP760 LED49-/740 II DX70 DGR 62	No	Not applicable
37842700	BGP763 LED300-/740 I DW50 DGR 62	No	Not applicable
37840300	BGP763 LED260-/740 I DX10 DGR 32-48	No	Not applicable
37844100	BGP763 LED340-/740 II DW10 DGR SRG10 62	No	Not applicable
37693500	BGP761 LED45-/740 I DM10 DGR 32-48	No	Not applicable
37699700	BGP761 LED74-/740 I DM50 DGR 32-48	No	Not applicable

Order Code	Full Product Name	Maximum dim	
		Dimmable	level
37703100	BGP761 LED94-/740 I DX10 DGR 32-48	No	Not applicable
37695900	BGP761 LED55-/740 I DN10 DGR 32-48	No	Not applicable
37701700	BGP761 LED84-/740 I DS50 DGR 32-48	No	Not applicable
37694200	BGP761 LED50-/830 II DM11 DGR D9 62	Yes	Not applicable
37700000	BGP761 LED79-/830 II DM70 DGR DDF27 D18	Yes	50%

Order Code	Full Product Name	Maximum dim	
		Dimmable	level
37696600	BGP761 LED59-/830 II DN11 DGR D11 62	Yes	Not applicable
37702400	BGP761 LED90-/740 II DW10 DGR 62	No	Not applicable
05930600	BGP761 LED119/740 I DM10 DGR 62 S	Yes	Not applicable

Approval and Application

Order Code	Full Product Name	Glow-wire test
37827400	BGP762 LED120-/830 II DN11 DGR D11 76	-
37831100	BGP762 LED159-/830 II DM70 DGR DDF27 D18	-
37828100	BGP762 LED129-/740 I DM11 DGR 32-48	-
37826700	BGP762 LED110-/740 I DN10 DGR 32-48	-
37834200	BGP762 LED180-/740 I DX10 DGR 32-48	-
37829800	BGP762 LED139-/830 II DM11 DGR D9 62	-
37833500	BGP762 LED170-/830 II DW10 DGR 76	-
37836600	BGP762 LED200-/740 I DW50 DGR 62	-
37837300	BGP762 LED210-/740 II DX70 DGR 76	-
37838000	BGP762 LED220-/740 II DW10 DGR SRG10 62	-
37679900	BGP760 LED10-/740 I DM10 DGR 32-48	Temperature 650 °C, duration 5 s
37680500	BGP760 LED12-/830 II DM11 DGR D9 62	Temperature 650 °C, duration 5 s
37681200	BGP760 LED14-/740 I DN10 DGR 32-48	Temperature 650 °C, duration 5 s
37682900	BGP760 LED16-/830 II DN11 DGR D11 62	Temperature 650 °C, duration 5 s
37685000	BGP760 LED22-/740 I DM50 DGR 32-48	Temperature 650 °C, duration 5 s

Order Code	Full Product Name	Glow-wire test
37688100	BGP760 LED30-/830 II DW10 DGR 62	Temperature 650 °C, duration 5 s
37691100	BGP760 LED44-/740 I DW50 DGR 32-48	Temperature 650 °C, duration 5 s
37692800	BGP760 LED49-/740 II DX70 DGR 62	Temperature 650 °C, duration 5 s
37842700	BGP763 LED300-/740 I DW50 DGR 62	-
37840300	BGP763 LED260-/740 I DX10 DGR 32-48	-
37844100	BGP763 LED340-/740 II DW10 DGR SRG10 62	-
37693500	BGP761 LED45-/740 I DM10 DGR 32-48	-
37699700	BGP761 LED74-/740 I DM50 DGR 32-48	-
37703100	BGP761 LED94-/740 I DX10 DGR 32-48	-
37695900	BGP761 LED55-/740 I DN10 DGR 32-48	-
37701700	BGP761 LED84-/740 I DS50 DGR 32-48	-
37694200	BGP761 LED50-/830 II DM11 DGR D9 62	-
37700000	BGP761 LED79-/830 II DM70 DGR DDF27 D18	-
37696600	BGP761 LED59-/830 II DN11 DGR D11 62	-
37702400	BGP761 LED90-/740 II DW10 DGR 62	-
05930600	BGP761 LED119/740 I DM10 DGR 62 S	-

Product Data

Order Code	Full Product Name	Product family code
37827400	BGP762 LED120-/830 II DN11 DGR D11 76	BGP762
37831100	BGP762 LED159-/830 II DM70 DGR DDF27 D18	BGP762
37828100	BGP762 LED129-/740 I DM11 DGR 32-48	BGP762
37826700	BGP762 LED110-/740 I DN10 DGR 32-48	BGP762
37834200	BGP762 LED180-/740 I DX10 DGR 32-48	BGP762
37829800	BGP762 LED139-/830 II DM11 DGR D9 62	BGP762
37833500	BGP762 LED170-/830 II DW10 DGR 76	BGP762
37836600	BGP762 LED200-/740 I DW50 DGR 62	BGP762
37837300	BGP762 LED210-/740 II DX70 DGR 76	BGP762
37838000	BGP762 LED220-/740 II DW10 DGR SRG10 62	BGP762
37679900	BGP760 LED10-/740 I DM10 DGR 32-48	BGP760
37680500	BGP760 LED12-/830 II DM11 DGR D9 62	BGP760
37681200	BGP760 LED14-/740 I DN10 DGR 32-48	BGP760
37682900	BGP760 LED16-/830 II DN11 DGR D11 62	BGP760
37685000	BGP760 LED22-/740 I DM50 DGR 32-48	BGP760
37688100	BGP760 LED30-/830 II DW10 DGR 62	BGP760

Order Code	Full Product Name	Product family code
37691100	BGP760 LED44-/740 I DW50 DGR 32-48	BGP760
37692800	BGP760 LED49-/740 II DX70 DGR 62	BGP760
37842700	BGP763 LED300-/740 I DW50 DGR 62	BGP763
37840300	BGP763 LED260-/740 I DX10 DGR 32-48	BGP763
37844100	BGP763 LED340-/740 II DW10 DGR SRG10 62	BGP763
37693500	BGP761 LED45-/740 I DM10 DGR 32-48	BGP761
37699700	BGP761 LED74-/740 I DM50 DGR 32-48	BGP761
37703100	BGP761 LED94-/740 I DX10 DGR 32-48	BGP761
37695900	BGP761 LED55-/740 I DN10 DGR 32-48	BGP761
37701700	BGP761 LED84-/740 I DS50 DGR 32-48	BGP761
37694200	BGP761 LED50-/830 II DM11 DGR D9 62	BGP761
37700000	BGP761 LED79-/830 II DM70 DGR DDF27 D18	BGP761
37696600	BGP761 LED59-/830 II DN11 DGR D11 62	BGP761
37702400	BGP761 LED90-/740 II DW10 DGR 62	BGP761
05930600	BGP761 LED119/740 I DM10 DGR 62 S	BGP761

Polar Wide Diagrams

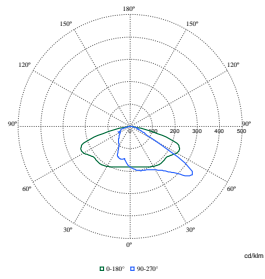

Polar Normal (separate) - BGP7621 - 910925866229

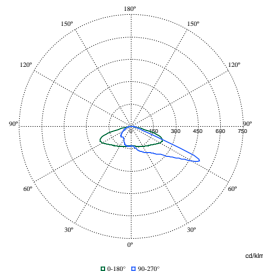

Polar Normal (separate) - BGP7611 - 910925866232

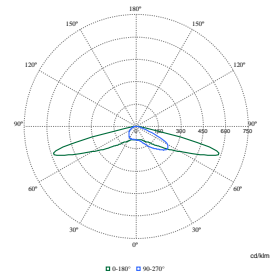

Polar Normal (separate) - BGP7631 - 910925866249

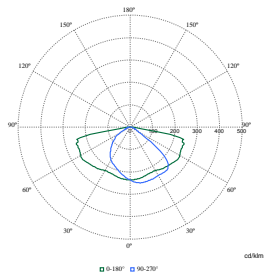

Polar Normal (separate) - BGP7621 - 910925866228

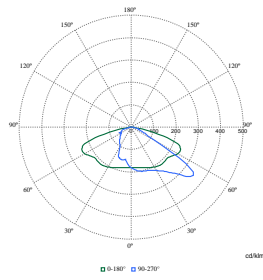

Polar Normal (separate) - BGP7631 - 910925866251

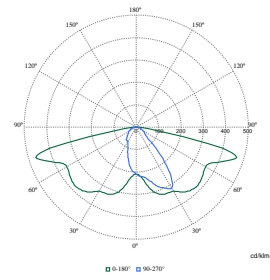

Polar Normal (separate) - BGP7621 - 910925866220

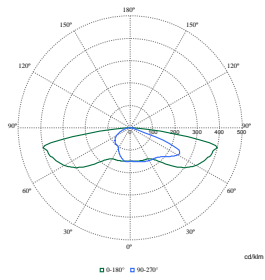

Polar Normal (separate) - BGP7621 - 910925866221

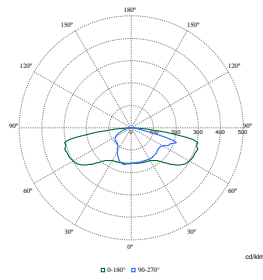

Polar Normal (separate) - BGP7621 - 910925866246

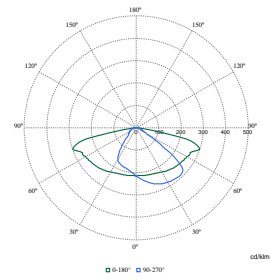

Polar Normal (separate) - BGP7611 - 910925866497

Polar Wide Diagrams

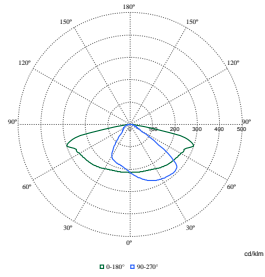

Polar Normal (separate) - BGP7601 - 910925863554

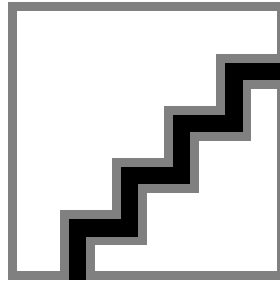

Polar Normal (separate) - BGP7601 - 910925863567

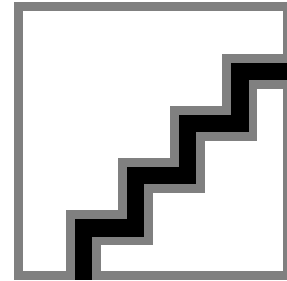

Polar Normal (separate) - BGP7601 - 910925863563

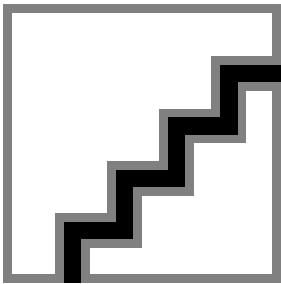

Polar Normal (separate) - BGP7601 - 910925863566

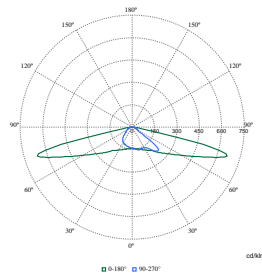

Polar Normal (separate) - BGP7601 - 910925863560

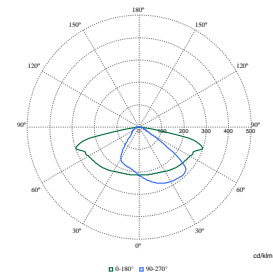

Polar Normal (separate) - BGP7611 - 910925866230

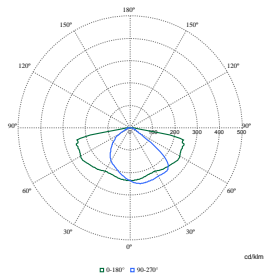

Polar Normal (separate) - BGP7611 - 910925866238

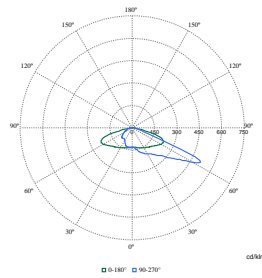

Polar Normal (separate) - BGP7631 - 910925866250

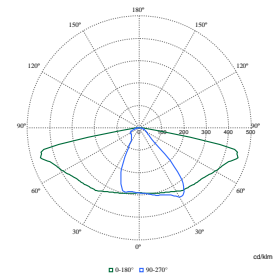

Polar Normal (separate) - BGP7621 - 910925866224

Polar Wide Diagrams

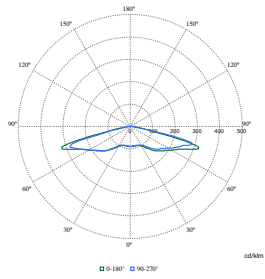

Polar Normal (separate) - BGP7611 - 910925866235

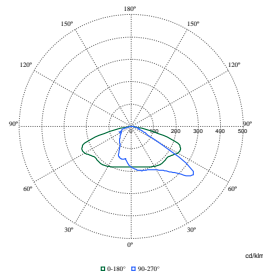

Polar Normal (separate) - BGP7611 - 910925866241

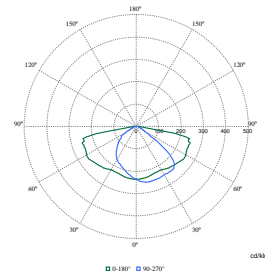

Polar Normal (separate) - BGP7621 - 910925866222

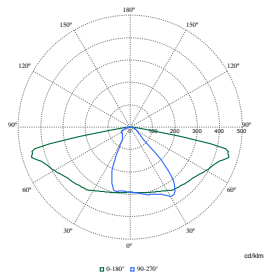

Polar Normal (separate) - BGP7611 - 910925866234

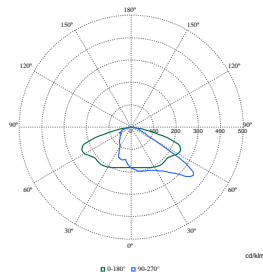

Polar Normal (separate) - BGP7621 - 910925866252

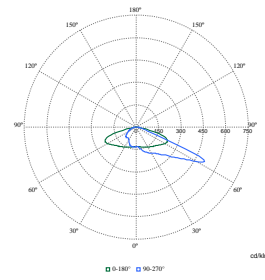

Polar Normal (separate) - BGP7621 - 910925866226

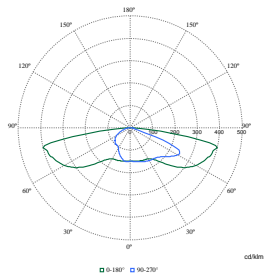

Polar Normal (separate) - BGP7611 - 910925866239

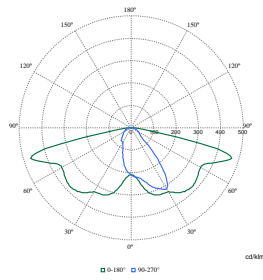

Polar Normal (separate) - BGP7611 - 910925866240

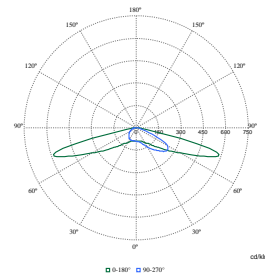

Polar Normal (separate) - BGP7621 - 910925866245

Polar Wide Diagrams

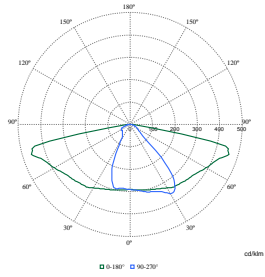

Polar Normal (separate) - BGP760I -
910925863556

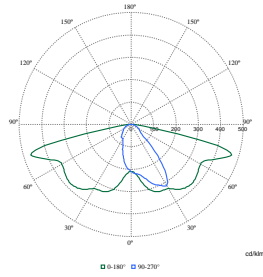

Polar Normal (separate) - BGP760I -
910925863557

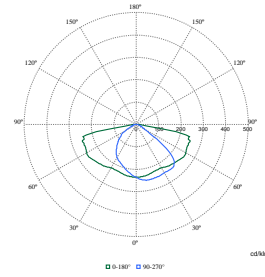

Polar Normal (separate) - BGP760I -
910925863555

