



Luma gen2: the standard in road lighting redefined, with Ultra Efficient performance options

Luma gen2

Luma gen2 is the next generation of the Luma LED luminaire family, fully optimised to become your long-term lighting and innovation partner. While keeping the distinctive design characteristics of the first generation, Luma gen2 gives you the benefits of the latest technologies thanks to its future-proof System Ready architecture, use of optimised Ledgine LED and optical platform ensuring best-in-class lighting performance in a broad range of applications. It also offers improved serviceability. Installation has also become easier and faster, and thanks to the Service tag, you have access to all relevant documentations onsite. Also, the cable feed-through has been redesigned and access to the gear components is easy thanks to top down tool-less access. Luma gen2 also offers all connectivity and dimming options available today and thanks to being System Ready, it can also be paired with lighting management systems such as Interact City or existing and upcoming sensor innovations. The Luma gen2 has been developed to optimise and simplify spare part repair and maintenance work using a new plug-and-play GearFlex module containing all electrical components in an easy to handle and accessible box inside the housing. As a company conscious about the impact of light on the environment and biodiversity, we also equipped the Luma gen2 with dedicated light recipes that help with maintaining the optimal ecosystems for bats or preserve a dark night sky.

Benefits

- Best-in-class efficiency and light performance in a broad range of applications
- Ease of repairs and maintenance via a dedicated GearFlex module
- Easy disassembly at end of life
- Future-ready thanks to the SR (System Ready) socket
- The luminaire is equipped with dedicated light recipes that help to maintain optimal ecosystems for bats, preserve the dark night sky and reduce light pollution
- Equipped with Service tag, a QR-based identification system that makes each luminaire uniquely identifiable and provides maintenance, installation and spare parts information on-site

Features

- Dedicated GearFlex module enabling faster, safer and tool-less maintenance
- Post-industrial recycled plastic material used in the GearFlex module and the white frame around the LED compartment
- >85% recyclable aluminium content
- Cable feed-through for easy installation
- Ready to be connected to Interact connected lighting management systems
- Ready to be paired with third-party lighting management systems and sensors
- Tilt with precision of 2.5 degrees
- Efficacy up to 200 lm /W for selected configurations
- Choice of 40+ different beams and different internal louvres
- flux optimisation tool
- Surge protection up to 10 kV
- Wide range of lumen packages, ranging from 1,000 to 89,000 lm
- Various CCTs ranging from 1800K – 5700K

Application

- Motorways, inter-urban main roads, boulevards and avenues, roundabouts, pedestrian crossings
- Residential streets, side streets, squares, parks, cycle and pedestrian paths, playgrounds
- Parking areas, industrial areas, petrol stations, rail yards, airports, harbours, waterways

Versions

BGP705 Luma gen2 Large

Wattstopper B SPP



Dimensional drawing

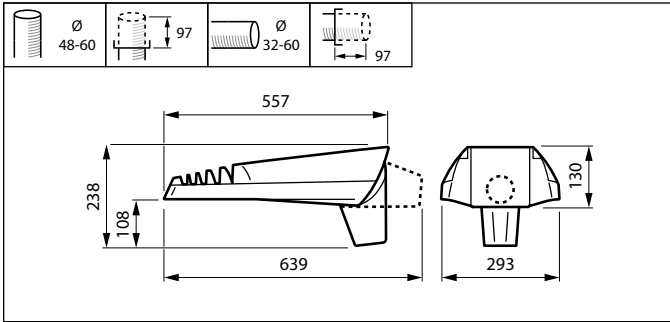
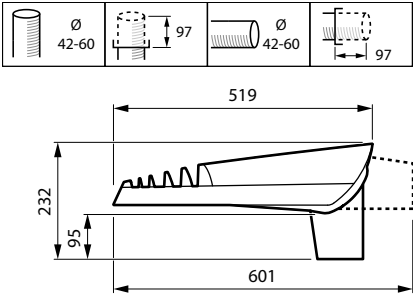
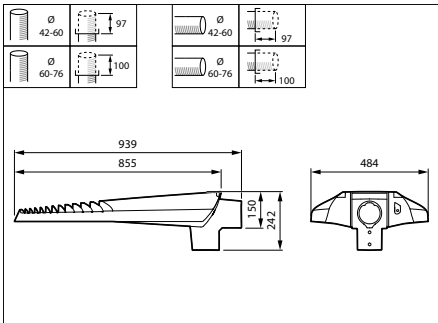
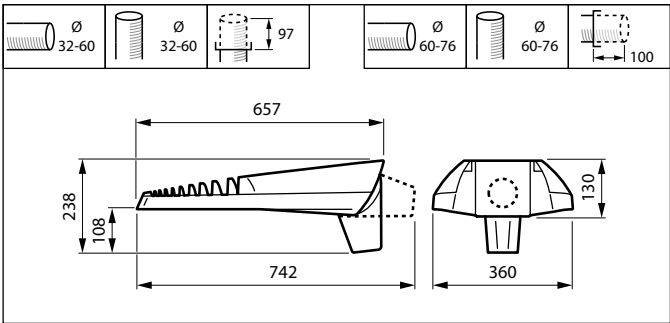

Product details

BGP701 Luma gen2 Nano FG DPP



BGP701 Luma gen2 Nano Open2 DPP



BGP705 Luma gen2 Large FG DPP



BGP705 Luma gen2 Large Open1 DPP



| General Information | |
|--|--|
| Driver included | Yes |
| Light source replaceable | Yes |
| Number of gear units | Unit |
| Service Tag | Yes |
| Light Technical | |
| Upwards light output ratio | 0 |
| Operating and Electrical | |
| Surge Protection (Common/Differential) | Surge protection level until 6 kV differential mode and 8 kV common mode |
| Controls and Dimming | |
| Maximum dim level | Not applicable |
| Mechanical and Housing | |
| Optical cover type | Glass |
| Housing Colour | Grey |
| Ingress protection code | IP66 |
| Standard tilt angle side entry | - |
| Standard tilt angle post-top | 0° |
| Approval and Application | |
| CE mark | Yes |
| Flammability mark | - |

General Information

| Order Code | Full Product Name | Lamp family code |
|------------|--|------------------|
| 10583600 | BGP701 LED8-4S/740 DM11 FG GR 42/60P | LED8 |
| 10584300 | BGP701 LED40-4S/740 DM10 GF SRT SRB 42/6 | LED40 |
| 10585000 | BGP701 LW10 LED50-4S/830 DM11 GF CTGO-DG | LED50 |
| 05966500 | BGP702 LED60-4S/740 DM11 GF SRT SRB 60/7 | LED60 |
| 05967200 | BGP702 LED40-4S/740 DM10 GF SRT SRB 60/7 | LED40 |
| 05968900 | BGP702 LW10 LED50-4S/830 DM11 GF CTGO | LED50 |
| 05974000 | BGP704 LED140-4S/740 DM50 GF SRT SRB 60 | LED140 |
| 05976400 | BGP704 LW10 LED120-4S/830 DM11 GF CTGO | LED120 |
| 10403700 | BGP705 LED150-4S/740 DM11 GF SRT SRB 60/ | LED150 |

Light Technical (1/2)

| Order Code | Full Product Name | Luminaire | Light | Correlated | Colour |
|------------|--|-------------------|-------------------|--------------------------|-----------------------|
| | | light beam spread | source colour | Colour Temperature (Nom) | rendering index (CRI) |
| 10583600 | BGP701 LED8-4S/740 DM11 FG GR 42/60P | 70° x 37° | 740 neutral white | 4000 K | 70 |
| 10584300 | BGP701 LED40-4S/740 DM10 GF SRT SRB 42/6 | 73° x 44° | 740 neutral white | 4000 K | 70 |
| 10585000 | BGP701 LW10 LED50-4S/830 DM11 GF CTGO-DG | 70° x 37° | 830 warm white | 3000 K | 80 |
| 05966500 | BGP702 LED60-4S/740 DM11 GF SRT SRB 60/7 | 70° x 37° | 740 neutral white | 4000 K | 70 |
| 05967200 | BGP702 LED40-4S/740 DM10 GF SRT SRB 60/7 | 73° x 44° | 740 neutral white | 4000 K | 70 |

| Order Code | Full Product Name | Luminaire | Light | Correlated | Colour |
|------------|--|-------------------|-------------------|--------------------------|-----------------------|
| | | light beam spread | source colour | Colour Temperature (Nom) | rendering index (CRI) |
| 05968900 | BGP702 LW10 LED50-4S/830 DM11 GF CTGO | 70° x 37° | 830 warm white | 3000 K | 80 |
| 05974000 | BGP704 LED140-4S/740 DM50 GF SRT SRB 60 | 154° - 31° x 54° | 740 neutral white | 4000 K | 70 |
| 05976400 | BGP704 LW10 LED120-4S/830 DM11 GF CTGO | 70° x 37° | 830 warm white | 3000 K | 80 |
| 10403700 | BGP705 LED150-4S/740 DM11 GF SRT SRB 60/ | 70° x 37° | 740 neutral white | 4000 K | 70 |

Light Technical (2/2)

| Order Code | Full Product Name | Luminous Flux | Optic type outdoor |
|------------|--|---------------|---------------------------|
| 10583600 | BGP701 LED8-4S/740 DM11 FG GR 42/60P | 728 lm | Distribution medium 11 |
| 10584300 | BGP701 LED40-4S/740 DM10 GF SRT SRB 42/6 | 3,600 lm | Distribution medium 10 |
| 10585000 | BGP701 LW10 LED50-4S/830 DM11 GF CTGO-DG | 4,500 lm | Distribution medium 11 |
| 05966500 | BGP702 LED60-4S/740 DM11 GF SRT SRB 60/7 | 5,400 lm | Distribution medium 11 |
| 05967200 | BGP702 LED40-4S/740 DM10 GF SRT SRB 60/7 | 3,600 lm | Distribution medium 10 |

| Order Code | Full Product Name | Luminous Flux | Optic type outdoor |
|------------|--|---------------|---------------------------|
| 05968900 | BGP702 LW10 LED50-4S/830 DM11 GF CTGO | 4,500 lm | Distribution medium 11 |
| 05974000 | BGP704 LED140-4S/740 DM50 GF SRT SRB 60 | 12,740 lm | Distribution medium 50 |
| 05976400 | BGP704 LW10 LED120-4S/830 DM11 GF CTGO | 10,920 lm | Distribution medium 11 |
| 10403700 | BGP705 LED150-4S/740 DM11 GF SRT SRB 60/ | 13,500 lm | Distribution medium 11 |

Operating and Electrical

| Order Code | Full Product Name | Power Consumption |
|------------|--|-------------------|
| 10583600 | BGP701 LED8-4S/740 DM11 FG GR 42/60P | 6.1 W |
| 10584300 | BGP701 LED40-4S/740 DM10 GF SRT SRB 42/6 | 25 W |
| 10585000 | BGP701 LW10 LED50-4S/830 DM11 GF CTGO-DG | 40.5 W |
| 05966500 | BGP702 LED60-4S/740 DM11 GF SRT SRB 60/7 | 38 W |
| 05967200 | BGP702 LED40-4S/740 DM10 GF SRT SRB 60/7 | 25 W |

| Order Code | Full Product Name | Power Consumption |
|------------|--|-------------------|
| 05968900 | BGP702 LW10 LED50-4S/830 DM11 GF CTGO | 40.5 W |
| 05974000 | BGP704 LED140-4S/740 DM50 GF SRT SRB 60 | 83 W |
| 05976400 | BGP704 LW10 LED120-4S/830 DM11 GF CTGO | 91 W |
| 10403700 | BGP705 LED150-4S/740 DM11 GF SRT SRB 60/ | 87 W |

Controls and Dimming

| Order Code | Full Product Name | Dimmable |
|------------|--|----------|
| 10583600 | BGP701 LED8-4S/740 DM11 FG GR 42/60P | No |
| 10584300 | BGP701 LED40-4S/740 DM10 GF SRT SRB 42/6 | No |
| 10585000 | BGP701 LW10 LED50-4S/830 DM11 GF CTGO-DG | Yes |
| 05966500 | BGP702 LED60-4S/740 DM11 GF SRT SRB 60/7 | No |
| 05967200 | BGP702 LED40-4S/740 DM10 GF SRT SRB 60/7 | No |

| Order Code | Full Product Name | Dimmable |
|------------|--|----------|
| 05968900 | BGP702 LW10 LED50-4S/830 DM11 GF CTGO | No |
| 05974000 | BGP704 LED140-4S/740 DM50 GF SRT SRB 60 | No |
| 05976400 | BGP704 LW10 LED120-4S/830 DM11 GF CTGO | No |
| 10403700 | BGP705 LED150-4S/740 DM11 GF SRT SRB 60/ | No |

Mechanical and Housing

| Order Code | Full Product Name | Mech. impact protection code |
|------------|--|------------------------------|
| 10583600 | BGP701 LED8-4S/740 DM11 FG GR 42/60P | IK10 |
| 10584300 | BGP701 LED40-4S/740 DM10 GF SRT SRB 42/6 | IK09 |
| 10585000 | BGP701 LW10 LED50-4S/830 DM11 GF CTGO-DG | IK09 |
| 05966500 | BGP702 LED60-4S/740 DM11 GF SRT SRB 60/7 | IK09 |
| 05967200 | BGP702 LED40-4S/740 DM10 GF SRT SRB 60/7 | IK09 |

| Order Code | Full Product Name | Mech. impact protection code |
|------------|--|------------------------------|
| 05968900 | BGP702 LW10 LED50-4S/830 DM11 GF CTGO | IK09 |
| 05974000 | BGP704 LED140-4S/740 DM50 GF SRT SRB 60 | IK09 |
| 05976400 | BGP704 LW10 LED120-4S/830 DM11 GF CTGO | IK09 |
| 10403700 | BGP705 LED150-4S/740 DM11 GF SRT SRB 60/ | IK09 |

Over Time Performance (IEC Compliant)

| Order Code | Full Product Name | Driver failure rate at 5,000 hours |
|------------|--|------------------------------------|
| 10583600 | BGP701 LED8-4S/740 DM11 FG GR 42/60P | - |
| 10584300 | BGP701 LED40-4S/740 DM10 GF SRT SRB 42/6 | - |
| 10585000 | BGP701 LW10 LED50-4S/830 DM11 GF CTGO-DG | - |
| 05966500 | BGP702 LED60-4S/740 DM11 GF SRT SRB 60/7 | 0.005 % |
| 05967200 | BGP702 LED40-4S/740 DM10 GF SRT SRB 60/7 | 0.005 % |

| Order Code | Full Product Name | Driver failure rate at 5,000 hours |
|------------|--|------------------------------------|
| 05968900 | BGP702 LW10 LED50-4S/830 DM11 GF CTGO | 0.005 % |
| 05974000 | BGP704 LED140-4S/740 DM50 GF SRT SRB 60 | 0.005 % |
| 05976400 | BGP704 LW10 LED120-4S/830 DM11 GF CTGO | 0.005 % |
| 10403700 | BGP705 LED150-4S/740 DM11 GF SRT SRB 60/ | 0.005 % |

Product Data

| Order Code | Full Product Name | Product family code |
|------------|--|---------------------|
| 10583600 | BGP701 LED8-4S/740 DM11 FG GR 42/60P | BGP701 |
| 10584300 | BGP701 LED40-4S/740 DM10 GF SRT SRB 42/6 | BGP701 |
| 10585000 | BGP701 LW10 LED50-4S/830 DM11 GF CTGO-DG | BGP701 |
| 05966500 | BGP702 LED60-4S/740 DM11 GF SRT SRB 60/7 | BGP702 |
| 05967200 | BGP702 LED40-4S/740 DM10 GF SRT SRB 60/7 | BGP702 |

| Order Code | Full Product Name | Product family code |
|------------|--|---------------------|
| 05968900 | BGP702 LW10 LED50-4S/830 DM11 GF CTGO | BGP702 |
| 05974000 | BGP704 LED140-4S/740 DM50 GF SRT SRB 60 | BGP704 |
| 05976400 | BGP704 LW10 LED120-4S/830 DM11 GF CTGO | BGP704 |
| 10403700 | BGP705 LED150-4S/740 DM11 GF SRT SRB 60/ | BGP705 |

Polar Wide Diagrams

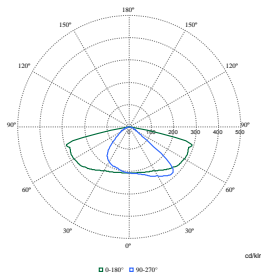
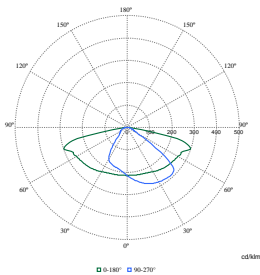
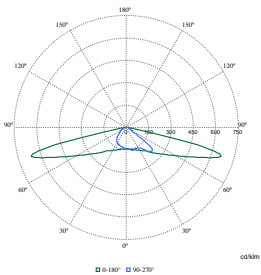

Polar Normal (separate) - BGP704I - 910925866542

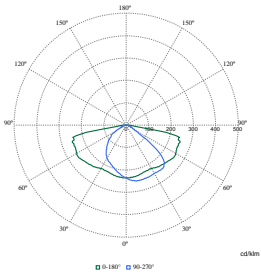

Polar Normal (separate) - BGP702I - 910925866535

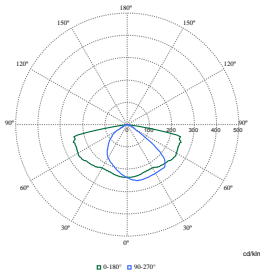

Polar Normal (separate) - BGP702I - 910925866536

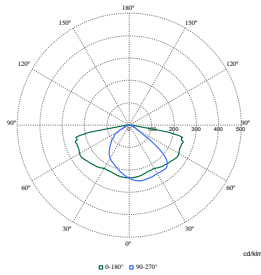

Polar Normal (separate) - BGP702I - 910925866534

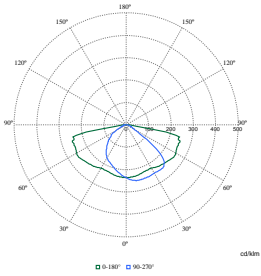

Polar Normal (separate) - BGP704I - 910925866544

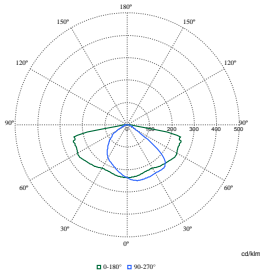

Polar Normal (separate) - BGP705I - 910925867142

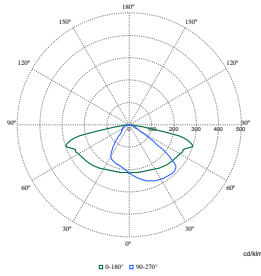

Polar Normal (separate) - BGP701I - 910925867326

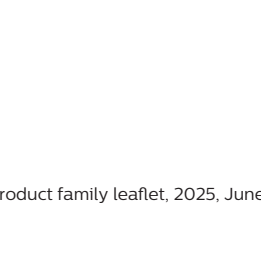

Polar Normal (separate) - BGP701I - 910925867324



Polar Normal (separate) - BGP701I - 910925867325



