



CityCharm Cone – combining ambiance and optimum performance

CityCharm Cone

CityCharm Cone is designed for use in urban areas where comfortable lighting, ambiance and design play an important role. Its unobtrusive appearance makes it a timeless, future-proof luminaire that is ideal for residential areas, parks, footpaths and cycle lanes, where visual comfort and maximum efficiency are key. CityCharm offers a choice of two iconic designs (Cone and Cordoba) and various accessories, enabling you to create a lighting solution that carries your signature, both by day and by night. CityCharm luminaires are also available as a complete set, with a choice of dedicated poles and brackets.

Benefits

- Elegant iconic range focused on comfortable lighting
- Future-proof due to excellent lighting performance and high quality of product and finishing
- Suitable for both renovation projects and new installations thanks to dedicated brackets and

Features

- Choice of luminaire shapes, color effects, and dedicated poles and brackets
- Diffusing tools to create visual comfort and colored parts to enhance ambiance
- A broad lumen range and optics to ensure maximum efficiency at all lighting levels
- Optimized total cost of ownership
- Compatible with all standard and advanced Philips lighting systems and CityTouch Ready
- Easy on-site maintenance of the driver

CityCharm Cone

Application

- Residential areas
- Footpaths and cycle lanes
- Parks and boulevards

Dimensional drawing

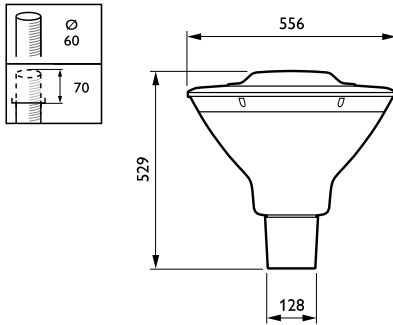

Product details



CityCharm_Cordoba_Cone-
BDS490_BDS491_DGR-DP02.tif



CityCharm_Cone-BDS491_DGR-
DP03.tif

General Information	
Driver included	Yes
Light source replaceable	Yes
Number of gear units	1 unit
Service tag	Yes
Light Technical	
Luminaire light beam spread	360°
Controls and Dimming	
Dimmable	No
Maximum dim level	Not applicable
Mechanical and Housing	
Optical cover type	Polycarbonate bowl/cover
Housing Color	Gray
Mech. impact protection code	IK10
Ingress protection code	IP66
Standard tilt angle side entry	0°
Standard tilt angle posttop	0°
Approval and Application	
CE mark	Yes
Flammability mark	-
Product Data	
Product family code	BDS491

General Information

Order Code	Full Product Name	Gear	Lamp family code
93926000	BDS491 CG25-/740 II A GR H07RN-PX1.5 60	EB	CG25
93927700	BDS491 CG25-/730 II S GR 60	EB	CG25
20195800	BDS491 LED70-/830 I S GRB GR 60	-	LED70
20201600	BDS491 LED30-/830 II DM GRB GR 60	-	LED30
20327300	BDS491 LED20/722 PSU II DM GRB GR H07 60	-	LED20
20192700	BDS491 LED100-/740 I DM GRB DF-S GR CLO	-	LED100
20193400	BDS491 LED10-/740 I DM GRB DF-S GR CLO S	-	LED10
20329700	BDS491 LED40/730 PSU I DW DF-S GR H07 60	-	LED40

Light Technical (1/2)

Order Code	Full Product Name	Light source	Correlated Color	Color rendering	Luminous Flux
		color	Temperature (Nom)	index (CRI)	
93926000	BDS491 CG25-/740 II A GR H07RN-PX1.5 60	740 neutral white	4000 K	70	2,140 lm
93927700	BDS491 CG25-/730 II S GR 60	730 warm white	3000 K	70	2,117 lm
20195800	BDS491 LED70-/830 I S GRB GR 60	830 warm white	3000 K	80	5,670 lm
20201600	BDS491 LED30-/830 II DM GRB GR 60	830 warm white	3000 K	80	2,400 lm
20327300	BDS491 LED20/722 PSU II DM GRB GR H07 60	722 warm white	2200 K	70	1,600 lm

Order Code	Full Product Name	Light source	Correlated Color	Color rendering	Luminous Flux
		color	Temperature (Nom)	index (CRI)	
20192700	BDS491 LED100-/740 I DM GRB DF-S GR CLO	740 neutral white	4000 K	70	7,600 lm
20193400	BDS491 LED10-/740 I DM GRB DF-S GR CLO S	740 neutral white	4000 K	70	800 lm
20329700	BDS491 LED40/730 PSU I DW DF-S GR H07 60	730 warm white	3000 K	70	3,200 lm

Light Technical (2/2)

Order Code	Full Product Name	Number of light sources	Optic type outdoor	Upward light output ratio
93926000	BDS491 CG25-/740 II A GR H07RN-PX1.5 60	15	Asymmetrical	0.03
93927700	BDS491 CG25-/730 II S GR 60	15	Symmetrical	0.03
20195800	BDS491 LED70-/830 I S GRB GR 60	-	Symmetrical	0.0136
20201600	BDS491 LED30-/830 II DM GRB GR 60	-	Distribution medium	0.03
20327300	BDS491 LED20/722 PSU II DM GRB GR H07 60	-	Distribution medium	0.0261

Operating and Electrical

Order Code	Full Product Name	Power Consumption	Surge Protection (Common/Differential)
93926000	BDS491 CG25-/740 II A GR H07RN-PX1.5 60	20 W	Surge protection level until 6 kV differential mode and 8 kV common mode
93927700	BDS491 CG25-/730 II S GR 60	22 W	Surge protection level until 6 kV differential mode and 8 kV common mode
20195800	BDS491 LED70-/830 I S GRB GR 60	53 W	Surge protection level until 6 kV differential mode and 8 kV common mode
20201600	BDS491 LED30-/830 II DM GRB GR 60	23.5 W	Surge protection level until 6 kV differential mode and 8 kV common mode

Approval and Application

Order Code	Full Product Name	Glow-wire test
93926000	BDS491 CG25-/740 II A GR H07RN-PX1.5 60	Temperature 650 °C, duration 5 s
93927700	BDS491 CG25-/730 II S GR 60	Temperature 650 °C, duration 5 s
20195800	BDS491 LED70-/830 I S GRB GR 60	-

Over Time Performance (IEC Compliant)

Order Code	Full Product Name	Driver failure rate at 5000 h
93926000	BDS491 CG25-/740 II A GR H07RN-PX1.5 60	0.05 %
93927700	BDS491 CG25-/730 II S GR 60	0.05 %
20195800	BDS491 LED70-/830 I S GRB GR 60	-
20201600	BDS491 LED30-/830 II DM GRB GR 60	-

Order Code	Full Product Name	Number of light sources	Optic type outdoor	Upward light output ratio
20192700	BDS491 LED100-/740 I DM GRB DF-S GR CLO	-	Distribution medium	0.0351
20193400	BDS491 LED10-/740 I DM GRB DF-S GR CLO S	-	Distribution medium	0.0307
20329700	BDS491 LED40/730 PSU I DW DF-S GR H07 60	-	Distribution wide	0.0322

Order Code	Full Product Name	Power Consumption	Surge Protection (Common/Differential)
20327300	BDS491 LED20/722 PSU II DM GRB GR H07 60	17.2 W	Surge protection level until 6 kV differential mode and 8 kV common mode
20192700	BDS491 LED100-/740 I DM GRB DF-S GR CLO	58 W	Surge protection level until 10 kV differential mode and 10 kV common mode
20193400	BDS491 LED10-/740 I DM GRB DF-S GR CLO S	6.8 W	Surge protection level until 10 kV differential mode and 10 kV common mode
20329700	BDS491 LED40/730 PSU I DW DF-S GR H07 60	26.5 W	Surge protection level until 6 kV differential mode and 8 kV common mode

Order Code	Full Product Name	Glow-wire test
20201600	BDS491 LED30-/830 II DM GRB GR 60	-
20327300	BDS491 LED20/722 PSU II DM GRB GR H07 60	-
20192700	BDS491 LED100-/740 I DM GRB DF-S GR CLO	-
20193400	BDS491 LED10-/740 I DM GRB DF-S GR CLO S	-
20329700	BDS491 LED40/730 PSU I DW DF-S GR H07 60	-

Order Code	Full Product Name	Driver failure rate at 5000 h
20327300	BDS491 LED20/722 PSU II DM GRB GR H07 60	-
20192700	BDS491 LED100-/740 I DM GRB DF-S GR CLO	-
20193400	BDS491 LED10-/740 I DM GRB DF-S GR CLO S	-
20329700	BDS491 LED40/730 PSU I DW DF-S GR H07 60	-

Polar Wide Diagrams

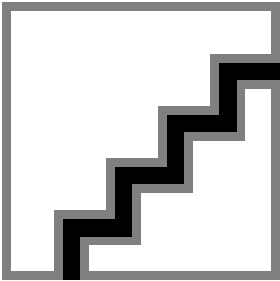

Polar Normal (separate) - BDS490I - 910505017431

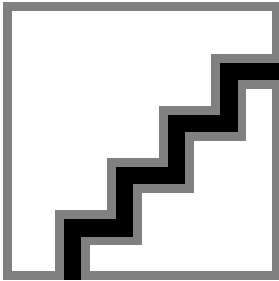

Polar Normal (separate) - BDS490I - 910505017432

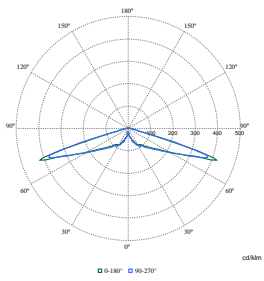

Polar Normal (separate) - BDS490I - 912300024687

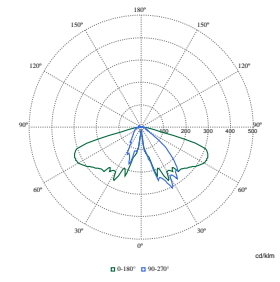

Polar Normal (separate) - BDS490I - 912300024693

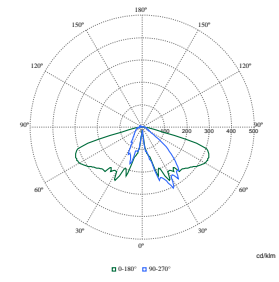

Polar Normal (separate) - BDS490I - 912300024719

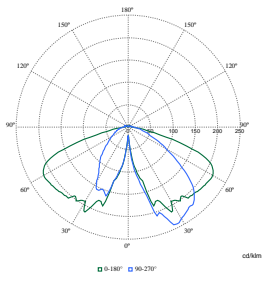

Polar Normal (separate) - BDS490I - 912300024721

