



CityCharm Cone - combining ambiance and optimum performance

CityCharm Cone

CityCharm Cone is designed for use in urban areas where comfortable lighting, ambiance and design play an important role. Its unobtrusive appearance makes it a timeless, future-proof luminaire that is ideal for residential areas, parks, footpaths and cycle lanes, where visual comfort and maximum efficiency are key. CityCharm offers a choice of two iconic designs (Cone and Cordoba) and various accessories, enabling you to create a lighting solution that carries your signature, both by day and by night. CityCharm luminaires are also available as a complete set, with a choice of dedicated poles and brackets.

Benefits

- Elegant iconic range focused on comfortable lighting
- Future-proof due to excellent lighting performance and high quality of product and finishing
- Suitable for both renovation projects and new installations thanks to dedicated brackets and

Features

- Choice of luminaire shapes, color effects, and dedicated poles and brackets
- Diffusing tools to create visual comfort and colored parts to enhance ambiance
- A broad lumen range and optics to ensure maximum efficiency at all lighting levels
- Optimized total cost of ownership
- Compatible with all standard and advanced Philips lighting systems and CityTouch Ready
- Easy on-site maintenance of the driver

CityCharm Cone

Application

- Residential areas
- Footpaths and cycle lanes
- Parks and boulevards

Dimensional drawing

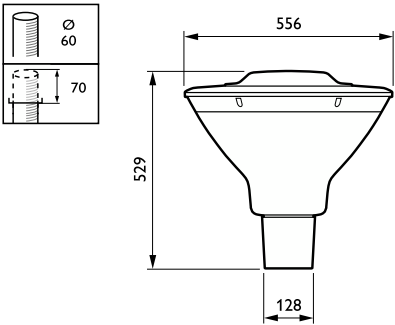

Product details



CityCharm_Cordoba_Cone-
BDS490_BDS491_DGR-DP02.tif



CityCharm_Cone-BDS491_DGR-
DP03.tif

General Information	
Driver included	Yes
Gear	EB
Lamp family code	CG25
Light source replaceable	Yes
Number of gear units	1 unit
Service tag	Yes
Light Technical	
Luminaire light beam spread	360°
Color rendering index (CRI)	70
Number of light sources	15
Upward light output ratio	0.03
Operating and Electrical	
Surge Protection (Common/ Differential)	Surge protection level until 6 kV differential mode and 8 kV common mode
Controls and Dimming	
Dimmable	No
Maximum dim level	Not applicable
Mechanical and Housing	
Optical cover type	Polycarbonate bowl/cover
Housing Color	Gray
Mech. impact protection code	IK10
Ingress protection code	IP66
Standard tilt angle side entry	0°
Standard tilt angle posttop	0°
Approval and Application	
CE mark	Yes
Flammability mark	-
Glow-wire test	Temperature 650 °C, duration 5 s
Over Time Performance (IEC Compliant)	
Driver failure rate at 5000 h	0.05 %
Product Data	
Product family code	BDS491

Light Technical

Order Code	Full Product Name	Light source color	Correlated Color		Optic type outdoor
			Temperature (Nom)	Luminous Flux	
93921500	BDS491 CG25-/740 II S GR D11 76	740 neutral white	4000 K	2,140 lm	Symmetrical
93926000	BDS491 CG25-/740 II A GR H07RN-PX1.5 60	740 neutral white	4000 K	2,140 lm	Asymmetrical
93927700	BDS491 CG25-/730 II S GR 60	730 warm white	3000 K	2,117 lm	Symmetrical

Operating and Electrical

Order Code	Full Product Name	Power Consumption
93921500	BDS491 CG25-/740 II S GR D11 76	20 W
93926000	BDS491 CG25-/740 II A GR H07RN-PX1.5 60	20 W

Order Code	Full Product Name	Power Consumption
93927700	BDS491 CG25-/730 II S GR 60	22 W

Polar Wide Diagrams

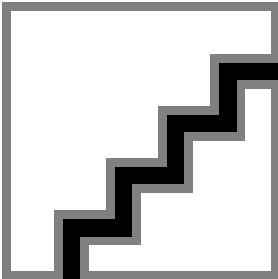

Polar Normal (separate) - BDS490I - 910505017431

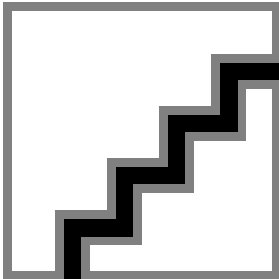

Polar Normal (separate) - BDS490I - 910505017426

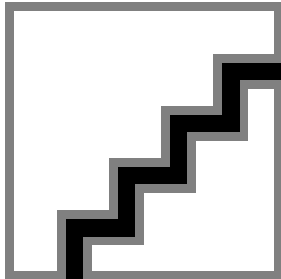

Polar Normal (separate) - BDS490I - 910505017432

