



# CityCharm: combining visual comfort and performance

## CityCharm Cone

The CityCharm range is designed for use in urban areas where comfortable lighting, ambience, and design play an important role. It offers three iconic, timeless designs: CityCharm cordoba (BDS490), CityCharm cone (BDS491), and CityCharm fluid (BDS492) along with a range of decorative and practical accessories. This enables you to create a lighting solution that carries the signature of your municipality, both by day and by night. Whether you specify cordoba, cone or fluid LED lights, CityCharm provides high visual comfort while maintaining excellent performance. It offers a choice of two innovative Lighting technologies: GentleBeam, which maximizes visual comfort, or ClearGuide (cordoba or cone), which optimizes vertical illumination and visual guidance. To personalize your CityCharm lighting solution further, decorative accessories for this range make it possible to define the volume of the bowl and change its appearance. A variety of dedicated brackets and masts are also available to enable you to reshape your residential areas and city centers in the most elegant way imaginable.

### Benefits

- Elegant, iconic range enhanced by dedicated poles and brackets to create distinctive styles
- Comfortable lighting with GentleBeam or ClearGuide technologies
- Multiple geometries for visual comfort in all urban spaces
- Excellent lighting performance, high-quality finishing
- Future-ready with Zhaga-D4i system ready (SR) top socket to connect with Interact controls
- Service tag for easy installation and maintenance

# CityCharm Cone

## Features

- Choice of luminaire shapes, color effects, poles and brackets
- Diffusing tools for visual comfort, colored inserts to enhance ambiance
- Wide range of lumen outputs and optics for maximum efficiency at all lighting levels
- Choice of color temperatures and color rendering for different ambiances: 2200K, 2700K, 3000K and 4000K
- Efficacy up to 144 lm/W
- Cordoba and fluid versions available with ULR < 1%
- Lifetime up to 100,000 hours @L96 B10
- 5-year standard warranty (option to extend up to 10 years)

## Application

- Residential
- Footpaths and cycle lanes
- Parks and boulevards

## Dimensional drawing

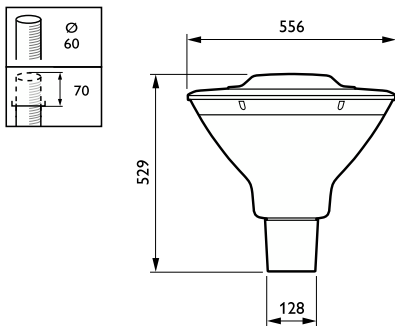

## Product details



CityCharm\_Cordoba\_Cone-  
BDS490\_BDS491\_DGR-DP02.tif



CityCharm\_Cone-BDS491\_DGR-  
DP03.tif

General Information	
Driver included	Yes
Light source replaceable	Yes
Number of gear units	1 unit
Service tag	Yes
Light Technical	
Luminaire light beam spread	360°
Controls and Dimming	
Dimmable	No
Maximum dim level	Not applicable
Mechanical and Housing	
Optical cover type	Polycarbonate bowl/cover
Housing Color	Gray
Mech. impact protection code	IK10
Ingress protection code	IP66
Standard tilt angle side entry	0°
Standard tilt angle posttop	0°
Approval and Application	
CE mark	Yes
Flammability mark	-
Product Data	
Product family code	BDS491

General Information

Order Code	Full Product Name	Gear	Lamp family code
910505017426	BDS491 CG25-/740 II S GR D11 76	EB	CG25
910505017431	BDS491 CG25-/740 II A GR H07RN-PX1.5 60	EB	CG25
910505017432	BDS491 CG25-/730 II S GR 60	EB	CG25
912300024687	BDS491 LED70-/830 I S GRB GR 60	-	LED70
912300024693	BDS491 LED30-/830 II DM GRB GR 60	-	LED30
912300024719	BDS491 LED20/722 PSU II DM GRB GR H07 60	-	LED20
912300024684	BDS491 LED100-/740 I DM GRB DF-S GR CLO	-	LED100
912300024685	BDS491 LED10-/740 I DM GRB DF-S GR CLO S	-	LED10
912300024721	BDS491 LED40/730 PSU I DW DF-S GR H07 60	-	LED40

Light Technical (1/2)

Order Code	Full Product Name	Light source color	Correlated Color Temperature	Color rendering index	Luminous Flux
			(Nom)	(CRI)	
910505017426	BDS491 CG25-/740 II S GR D11 76	740 neutral white	4000 K	70	2,140 lm
910505017431	BDS491 CG25-/740 II A GR H07RN-PX1.5 60	740 neutral white	4000 K	70	2,140 lm
910505017432	BDS491 CG25-/730 II S GR 60	730 warm white	3000 K	70	2,117 lm
912300024687	BDS491 LED70-/830 I S GRB GR 60	830 warm white	3000 K	80	5,670 lm
912300024693	BDS491 LED30-/830 II DM GRB GR 60	830 warm white	3000 K	80	2,400 lm
912300024719	BDS491 LED20/722 PSU II DM GRB GR H07 60	722 warm white	2200 K	70	1,600 lm

Order Code	Full Product Name	Light source color	Correlated Color Temperature	Color rendering index	Luminous Flux
			(Nom)	(CRI)	
912300024684	BDS491 LED100-/740 I DM GRB DF-S GR CLO	740 neutral white	4000 K	70	7,600 lm
912300024685	BDS491 LED10-/740 I DM GRB DF-S GR CLO S	740 neutral white	4000 K	70	800 lm
912300024721	BDS491 LED40/730 PSU I DW DF-S GR H07 60	730 warm white	3000 K	70	3,200 lm

Light Technical (2/2)

Order Code	Full Product Name	Number of light sources	Optic type outdoor	Upward light output ratio
910505017426	BDS491 CG25-/740 II S GR D11 76	15	Symmetrical	0.03
910505017431	BDS491 CG25-/740 II A GR H07RN-PX1.5 60	15	Asymmetrical	0.03
910505017432	BDS491 CG25-/730 II S GR 60	15	Symmetrical	0.03
912300024687	BDS491 LED70-/830 I S GRB GR 60	-	Symmetrical	0.0136
912300024693	BDS491 LED30-/830 II DM GRB GR 60	-	Distribution medium	0.03

Order Code	Full Product Name	Number of light sources	Optic type outdoor	Upward light output ratio
912300024719	BDS491 LED20/722 PSU II DM GRB GR H07 60	-	Distribution medium	0.0261
912300024684	BDS491 LED100-/740 I DM GRB DF-S GR CLO	-	Distribution medium	0.0351
912300024685	BDS491 LED10-/740 I DM GRB DF-S GR CLO S	-	Distribution medium	0.0307
912300024721	BDS491 LED40/730 PSU I DW DF-S GR H07 60	-	Distribution wide	0.0322

Operating and Electrical

Order Code	Full Product Name	Power Consumption	Surge Protection (Common/Differential)
910505017426	BDS491 CG25-/740 II S GR D11 76	20 W	Surge protection level until 6 kV differential mode and 8 kV common mode
910505017431	BDS491 CG25-/740 II A GR H07RN-PX1.5 60	20 W	Surge protection level until 6 kV differential mode and 8 kV common mode
910505017432	BDS491 CG25-/730 II S GR 60	22 W	Surge protection level until 6 kV differential mode and 8 kV common mode
912300024687	BDS491 LED70-/830 I S GRB GR 60	53 W	Surge protection level until 6 kV differential mode and 8 kV common mode
912300024693	BDS491 LED30-/830 II DM GRB GR 60	23.5 W	Surge protection level until 6 kV differential mode and 8 kV common mode

Order Code	Full Product Name	Power Consumption	Surge Protection (Common/Differential)
912300024719	BDS491 LED20/722 PSU II DM GRB GR H07 60	17.2 W	Surge protection level until 6 kV differential mode and 8 kV common mode
912300024684	BDS491 LED100-/740 I DM GRB DF-S GR CLO	58 W	Surge protection level until 10 kV differential mode and 10 kV common mode
912300024685	BDS491 LED10-/740 I DM GRB DF-S GR CLO S	6.8 W	Surge protection level until 10 kV differential mode and 10 kV common mode
912300024721	BDS491 LED40/730 PSU I DW DF-S GR H07 60	26.5 W	Surge protection level until 6 kV differential mode and 8 kV common mode

Approval and Application

Order Code	Full Product Name	Glow-wire test
910505017426	BDS491 CG25-/740 II S GR D11 76	Temperature 650 °C, duration 5 s
910505017431	BDS491 CG25-/740 II A GR H07RN-PX1.5 60	Temperature 650 °C, duration 5 s
910505017432	BDS491 CG25-/730 II S GR 60	Temperature 650 °C, duration 5 s
912300024687	BDS491 LED70-/830 I S GRB GR 60	-
912300024693	BDS491 LED30-/830 II DM GRB GR 60	-

Order Code	Full Product Name	Glow-wire test
912300024719	BDS491 LED20/722 PSU II DM GRB GR H07 60	-
912300024684	BDS491 LED100-/740 I DM GRB DF-S GR CLO	-
912300024685	BDS491 LED10-/740 I DM GRB DF-S GR CLO S	-
912300024721	BDS491 LED40/730 PSU I DW DF-S GR H07 60	-

Over Time Performance (IEC Compliant)

Order Code	Full Product Name	Driver failure rate at 5000 h
910505017426	BDS491 CG25-/740 II S GR D11 76	0.05 %
910505017431	BDS491 CG25-/740 II A GR H07RN-PX1.5 60	0.05 %
910505017432	BDS491 CG25-/730 II S GR 60	0.05 %
912300024687	BDS491 LED70-/830 I S GRB GR 60	-
912300024693	BDS491 LED30-/830 II DM GRB GR 60	-

Order Code	Full Product Name	Driver failure rate at 5000 h
912300024719	BDS491 LED20/722 PSU II DM GRB GR H07 60	-
912300024684	BDS491 LED100-/740 I DM GRB DF-S GR CLO	-
912300024685	BDS491 LED10-/740 I DM GRB DF-S GR CLO S	-
912300024721	BDS491 LED40/730 PSU I DW DF-S GR H07 60	-

Polar Wide Diagrams

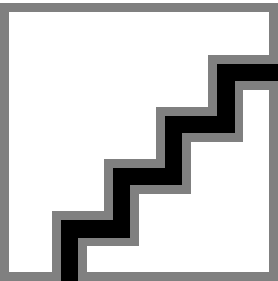

Polar Normal (separate) - BDS490I - 910505017431

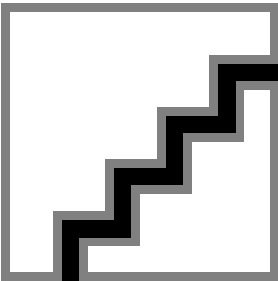

Polar Normal (separate) - BDS490I - 910505017426

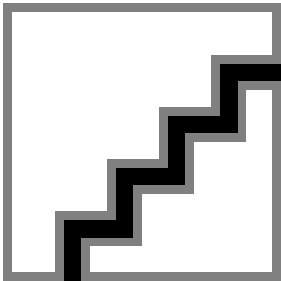

Polar Normal (separate) - BDS490I - 910505017432

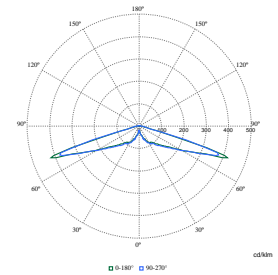

Polar Normal (separate) - BDS490I - 912300024687

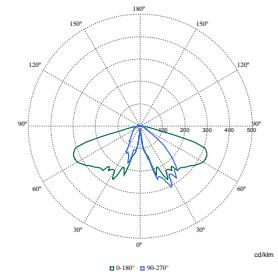

Polar Normal (separate) - BDS490I - 912300024693

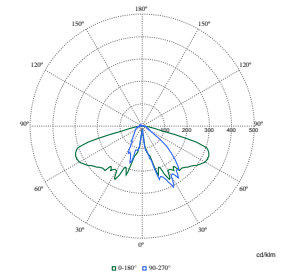

Polar Normal (separate) - BDS490I - 912300024719

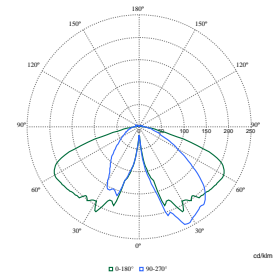

Polar Normal (separate) - BDS490I - 912300024721

