



Get your city ready for the future with DigiStreet

DigiStreet Catenary

DigiStreet Catenary is a new member of the DigiStreet Road & Street family, and it enables you to benefit from the same lighting quality, distinctive design and the advantages of connected lighting systems in applications requiring catenary solutions. Supporting Smart City initiatives, the full DigiStreet range can be equipped with two System Ready (SR) sockets to enable your city to opt in for existing and future controls, sensors and applications such as the CityTouch remote light management system. In addition, each individual luminaire is uniquely identifiable, thanks to the Service tag, which is based on QR coding. With a simple scan of the QR code, which is located on the inside of the mast door, you gain instant access to the luminaire configuration, making maintenance and programming operations faster and easier, throughout the luminaire's entire lifetime.

Benefits

- Prepared for the future, DigiStreet Catenary is easy to upgrade directly after installation or later with future CMS nodes and sensors to enable new functionalities
- Dedicated optics to match international road and street geometries
- Equipped with Service tag, a QR-based identification system that makes each luminaire uniquely identifiable and provides maintenance, installation and spare part information

Features

- Catenary solution within the DigiStreet Road & street family
- Option to equip with two SR sockets for easy upgradability to new functionalities
- Easy luminaire identification due to the Service tag
- L-tune tool available
- Lifetime 100Khrs up to L96 at Tq +25 °C

DigiStreet Catenary

Application

- Traffic routes and main access roads
- Urban areas
- City centers and main streets

Versions



DigiStreet Catenary-BTP764



DigiStreet Suspended-BSP764

Dimensional drawing

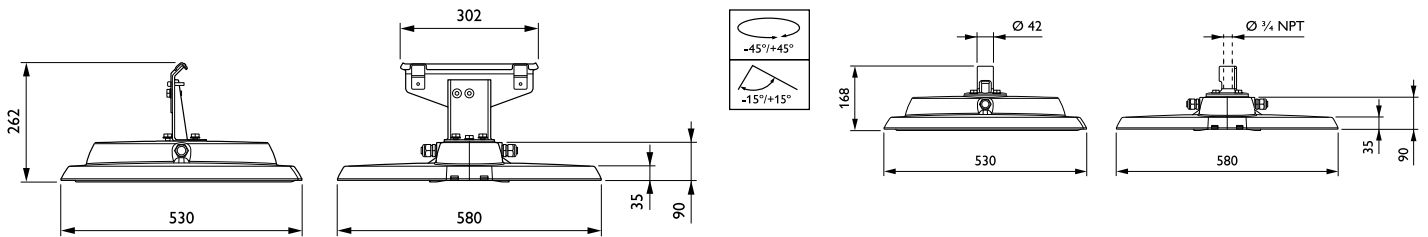

Product details



DigiStreet_Catenary-
BTP764-1DPP.tif



DigiStreet_Catenary-
BTP764-2DPP.tif

DigiStreet Catenary

Product details



DigiStreet_Catenary-
BTP764-3DPP.tif



DigiStreet_Catenary-
BTP764-4DPP.tif



DigiStreet_Catenary-
BTP764-5DPP.tif



DigiStreet_Catenary-
BTP764-6DPP.tif



DigiStreet_Suspended-
BSP764-1DPP.tif



DigiStreet_Suspended-
BSP764-2DPP.tif

General Information

| | |
|--------------------------|--------|
| Driver included | Yes |
| Lamp family code | LED64 |
| Light source replaceable | Yes |
| Number of gear units | 1 unit |
| Service tag | Yes |

Light Technical

| | |
|------------------------------------|-------------------|
| Light source color | 740 neutral white |
| Correlated Color Temperature (Nom) | 4000 K |
| Color rendering index (CRI) | 70 |
| Luminous Flux | 6,400 lm |
| Upward light output ratio | 0 |

Operating and Electrical

| | |
|--|--|
| Power Consumption | 38 W |
| Surge Protection (Common/Differential) | Surge protection level until 6 kV differential mode and 6 kV common mode |

Controls and Dimming

| | |
|-------------------|-----|
| Dimmable | Yes |
| Maximum dim level | 10% |

Mechanical and Housing

| | |
|--------------------------------|------------|
| Optical cover type | Flat glass |
| Housing Color | Aluminum |
| Mech. impact protection code | IK09 |
| Ingress protection code | IP66 |
| Standard tilt angle side entry | - |
| Standard tilt angle posttop | - |

Approval and Application

| | |
|-------------------|---|
| CE mark | Yes |
| Flammability mark | For mounting on normally flammable surfaces |

Light Technical

| Order Code | Full Product Name | Luminaire light beam | |
|--------------|---|----------------------|---------------------------------|
| | | spread | Optic type outdoor |
| 912300023969 | BTP764 LED64-4S/740 DSW1 PSD-SR SRT SRB | - | Distribution symmetrical wide 1 |
| 912300023970 | BSP764 LED64-4S/740 DW10 PSD-SR SRT SRB | 52° - 7° x 151° | Distribution wide 10 |

Product Data

| Order Code | Full Product Name | Product family code | Order Code | Full Product Name | Product family code |
|--------------|---|---------------------|--------------|---|---------------------|
| 912300023969 | BTP764 LED64-4S/740 DSW1 PSD-SR SRT SRB | BTP764 | 912300023970 | BSP764 LED64-4S/740 DW10 PSD-SR SRT SRB | BSP764 |

Polar Wide Diagrams

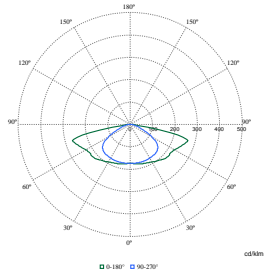

Polar Normal (separate) - BTP760I -
912300023969

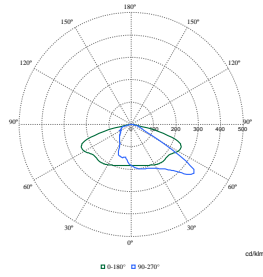

Polar Normal (separate) - BTP760I -
912300023970

