



# Get your city ready for the future with DigiStreet

## DigiStreet Catenary

DigiStreet Catenary is a new member of the DigiStreet Road & Street family, and it enables you to benefit from the same lighting quality, distinctive design and the advantages of connected lighting systems in applications requiring catenary solutions. Supporting Smart City initiatives, the full DigiStreet range can be equipped with two System Ready (SR) sockets to enable your city to opt in for existing and future controls, sensors and applications such as the CityTouch remote light management system. In addition, each individual luminaire is uniquely identifiable, thanks to the Service tag, which is based on QR coding. With a simple scan of the QR code, which is located on the inside of the mast door, you gain instant access to the luminaire configuration, making maintenance and programming operations faster and easier, throughout the luminaire's entire lifetime.

### Benefits

- Prepared for the future, DigiStreet Catenary is easy to upgrade directly after installation or later with future CMS nodes and sensors to enable new functionalities
- Dedicated optics to match international road and street geometries
- Equipped with Service tag, a QR-based identification system that makes each luminaire uniquely identifiable and provides maintenance, installation and spare part information

### Features

- Catenary solution within the DigiStreet Road & street family
- Option to equip with two SR sockets for easy upgradability to new functionalities
- Easy luminaire identification due to the Service tag
- L-tune tool available
- Lifetime 100Khrs up to L96 at Tq +25 °C

# DigiStreet Catenary

## Application

- Traffic routes and main access roads
- Urban areas
- City centers and main streets

## Versions



DigiStreet Catenary-BTP764



DigiStreet Suspended-BSP764

## Dimensional drawing

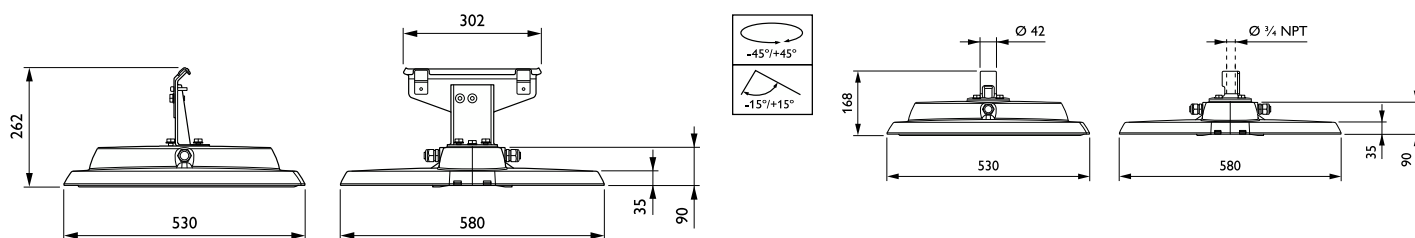

## Product details



DigiStreet\_Catenary-  
BTP764-1DPP.tif



DigiStreet\_Catenary-  
BTP764-2DPP.tif

Product details



DigiStreet\_Catenary-  
BTP764-3DPP.tif



DigiStreet\_Catenary-  
BTP764-4DPP.tif



DigiStreet\_Catenary-  
BTP764-5DPP.tif



DigiStreet\_Catenary-  
BTP764-6DPP.tif



DigiStreet\_Suspended-  
BSP764-1DPP.tif



DigiStreet\_Suspended-  
BSP764-2DPP.tif

General Information	
Driver included	Yes
Lamp family code	LED64
Light source replaceable	Yes
Number of gear units	1 unit
Service tag	Yes
Light Technical	
Light source color	740 neutral white
Correlated Color Temperature (Nom)	4000 K
Color rendering index (CRI)	70
Luminous Flux	6,400 lm
Upward light output ratio	0
Operating and Electrical	
Power Consumption	38 W
Surge Protection (Common/ Differential)	Surge protection level until 6 kV differential mode and 6 kV common mode
Controls and Dimming	
Dimmable	Yes
Maximum dim level	10%
Mechanical and Housing	
Optical cover type	Flat glass
Housing Color	Aluminum
Mech. impact protection code	IK09
Ingress protection code	IP66
Standard tilt angle side entry	-
Standard tilt angle posttop	-
Approval and Application	
CE mark	Yes
Flammability mark	For mounting on normally flammable surfaces

Light Technical

		Luminaire light beam	
Order Code	Full Product Name	spread	Optic type outdoor
912300023969	BTP764 LED64-4S/740 DSW1 PSD-SR SRT SRB	-	Distribution symmetrical wide 1
912300023970	BSP764 LED64-4S/740 DW10 PSD-SR SRT SRB	52° - 7° x 151°	Distribution wide 10

Product Data

Order Code	Full Product Name	Product family code	Order Code	Full Product Name	Product family code
912300023969	BTP764 LED64-4S/740 DSW1 PSD-SR SRT SRB	BTP764	912300023970	BSP764 LED64-4S/740 DW10 PSD-SR SRT SRB	BSP764

Polar Wide Diagrams

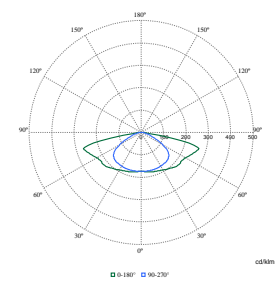

Polar Normal (separate) - BTP760I - 912300023969

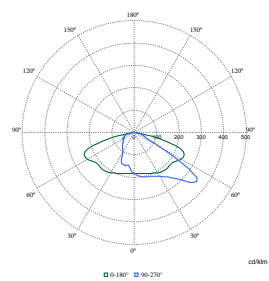

Polar Normal (separate) - BTP760I - 912300023970

