

PHILIPS

Fortimo

LED

Fortimo SLM C PA 1203
L09 1619 G8 HE

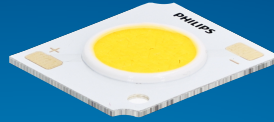

Datasheet

Refined light recipe for effortless experiences and high-end applications

Fortimo LED SLM G8(N) PA

Introducing the new Premium Ambiance light recipe, which expands our Fortimo SLM G8(N) HE offering by bringing a refined lighting option tailored for premium spaces. Carefully engineered to create a warm, inviting atmosphere while maintaining high focus on the merchandise, it is ideal for applications such as retail, hospitality, residential, and cruise environments where ambiance and comfort are key.

With high-quality light output combined with warmer CCT options, Premium Ambiance supports relaxed, effortless experiences while subtly enhancing the emotional appeal of the space allowing an end user to truly enjoy the illuminated space and merchandise. This light recipe has been specifically designed for settings with luxurious interior elements - such as dark-toned ceilings, wooden shelving, and richly textured décor - bringing depth and sophistication to every detail.

Key features and benefits

- New light recipe in Fortimo SLM G8(N) HE portfolio optimized for luxury interior design (wood, dark ceilings, textured materials, leathers)
- Warm CCT options - 2700K and 3000K to enhance merchandise and emotional appeal
- CRI 80 and 90 versions available
- High efficiency and performance similar to Premium White G8(N) HE
- Excellent color consistency management (2 SDCM)
- System proposition (Module + Driver + Holder)
- Seamless integration into existing COB spotlight designs using industry standard LES sizes and footprints - G8 and G8N

June 2025



Ordering data

Commercial product name	EOC	12NC	EPREL registration #	Box quantity
Fortimo SLM C 827 PA 1203 L09 1619 G8 HE	8721103 115843 00	9290 048 37401	2374885	20
Fortimo SLM C 830 PA 1203 L09 1619 G8 HE	8721103 115874 00	9290 048 37501	2374901	20
Fortimo SLM C 927 PA 1203 L09 1619 G8 HE	8721103 115904 00	9290 048 37001	2374900	20
Fortimo SLM C 930 PA 1203 L09 1619 G8 HE	8721103 115935 00	9290 048 37101	2374888	20

Not all products are globally available by default.

Please contact your local sales representative for local availability and activation conditions.

Drive currents

Parameter	Nominal*	Life**	Max***	Unit
Fortimo SLM C PA 1203 L09 1619 G8 HE	300	540	540	mA

Module temperatures

Parameter	Nominal*	Life**	Max***	Unit
T _c (case temperature at T _c point)	65	95	95	°C

* Nominal value at which typical performance is specified

** Value at which life time is specified

*** Maximum value for safe operation, do not operate above this value

Optical characteristics - table per color (CCT)

Fortimo SLM C 827 PA 1203 L09 1619 G8 HE

Parameter	Min	Typ	Max	Unit
Luminous flux	1548	1630	1793	lm
Efficacy		157		lm/W
Correlated color temperature (CCT)		2700		K
Color coordinates (CIEx, CIEy)		(0.450, 0.395)		-
Color consistency			2	SDCM
CRI	83			
R9	25			
Photometric code		827/259		
Photobiological safety		RG1 unlimited		



Measurement precision $\pm 5\%$ for the flux data and $\pm 6\%$ for the efficacy data. Measurement precision for color coordinates ± 0.005 . Measurement precision for CRI ± 1.5 .

Operation point	827	lm	lm/W
80% I-nom 240mA	Tc 25 °C	1395	168
	Tc-nom 65 °C	1327	162
	Tc-max 95 °C	1257	155
I-nom 300mA	Tc 25 °C	1715	163
	Tc-nom 65 °C	1630	157
	Tc-max 95 °C	1542	150
I-max 540mA	Tc 25 °C	2903	144
	Tc-nom 65 °C	2751	138
	Tc-max 95 °C	2594	131

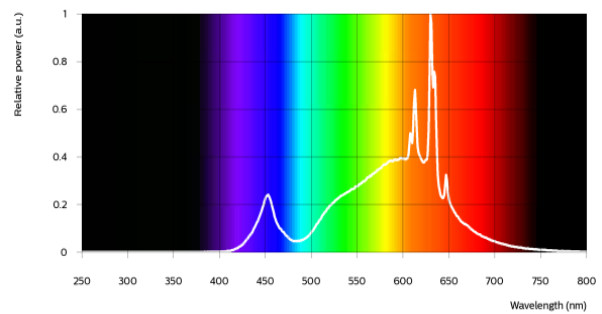

Fortimo SLM C 830 PA 1203 L09 1619 G8 HE

Parameter	Min	Typ	Max	Unit
Luminous flux	1596	1680	1848	lm
Efficacy		161		lm/W
Correlated color temperature (CCT)		3000		K
Color coordinates (CIEx, CIEy)		(0.433, 0.395)		-
Color consistency			2	SDCM
CRI	84			
R9	32			
Photometric code		830/259		
Photobiological safety		RG1 unlimited		



Measurement precision $\pm 5\%$ for the flux data and $\pm 6\%$ for the efficacy data. Measurement precision for color coordinates ± 0.005 . Measurement precision for CRI ± 1.5 .

Operation point	830	lm	lm/W
80% I-nom 240mA	Tc 25 °C	1438	173
	Tc-nom 65 °C	1368	167
	Tc-max 95 °C	1295	160
I-nom 300mA	Tc 25 °C	1767	168
	Tc-nom 65 °C	1680	162
	Tc-max 95 °C	1590	154
I-max 540mA	Tc 25 °C	2992	148
	Tc-nom 65 °C	2836	142
	Tc-max 95 °C	2674	135

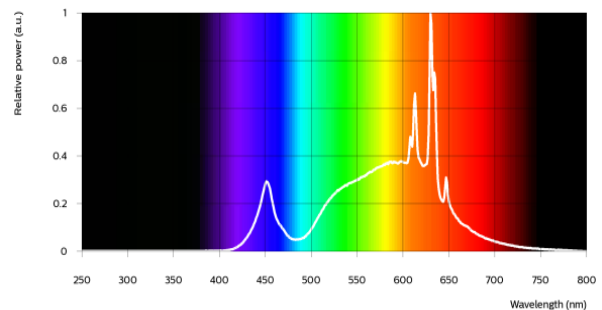

Fortimo SLM C 927 PA 1203 L09 1619 G8 HE

Parameter	Min	Typ	Max	Unit
Luminous flux	1463	1540	1694	lm
Efficacy		148		lm/W
Correlated color temperature (CCT)		2700		K
Color coordinates (CIEx, CIEy)		(0.452, 0.392)		-
Color consistency			2	SDCM
CRI	91			
R9	50			
Photometric code		927/259		
Photobiological safety		RG1 unlimited		

Measurement precision ± 5% for the flux data and ± 6% for the efficacy data. Measurement precision for color coordinates ± 0.005. Measurement precision for CRI ± 1.5.

Operation point	927	lm	lm/W
80% I-nom 240mA	Tc 25 °C	1318	159
	Tc-nom 65 °C	1254	153
	Tc-max 95 °C	1187	147
I-nom 300mA	Tc 25 °C	1620	154
	Tc-nom 65 °C	1540	148
	Tc-max 95 °C	1457	141
I-max 540mA	Tc 25 °C	2742	136
	Tc-nom 65 °C	2599	130
	Tc-max 95 °C	2451	124

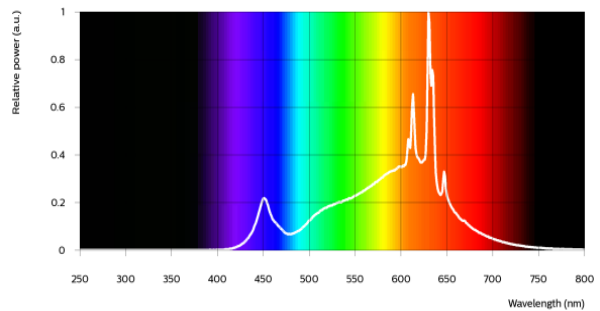

Fortimo SLM C 930 PA 1203 L09 1619 G8 HE

Parameter	Min	Typ	Max	Unit
Luminous flux	1501	1580	1738	lm
Efficacy		152		lm/W
Correlated color temperature (CCT)		3000		K
Color coordinates (CIEx, CIEy)		(0.435, 0.391)		-
Color consistency			2	SDCM
CRI	92			
R9	58			
Photometric code		930/259		
Photobiological safety		RG1 unlimited		

Measurement precision ± 5% for the flux data and ± 6% for the efficacy data. Measurement precision for color coordinates ± 0.005. Measurement precision for CRI ± 1.5.

Operation point	930	lm	lm/W
80% I-nom 240mA	Tc 25 °C	1352	163
	Tc-nom 65 °C	1287	157
	Tc-max 95 °C	1218	150
I-nom 300mA	Tc 25 °C	1662	158
	Tc-nom 65 °C	1580	152
	Tc-max 95 °C	1495	145
I-max 540mA	Tc 25 °C	2814	139
	Tc-nom 65 °C	2667	133
	Tc-max 95 °C	2515	127

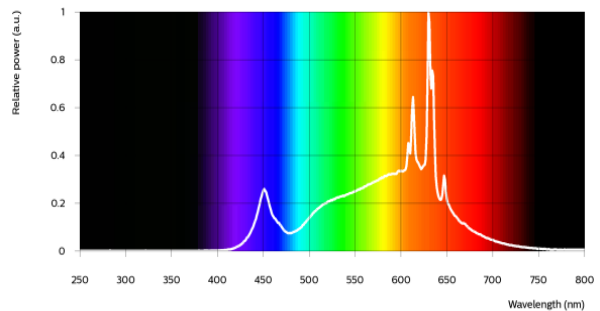

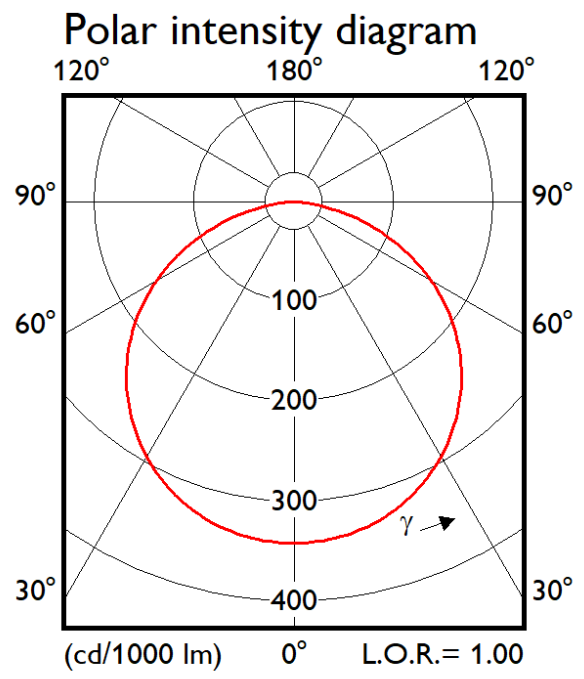

Electrical characteristics

Parameter	Min	Typ	Max	Unit
Forward voltage	32.5	34.7	37.0	V
Power consumption		10.4		W = kWh/1000h
Number of modules in series per chain			1	
Number of modules per chain			1	
Number of modules in parallel			1	

Measurement precision for Vf +/- 3%. Measurement precision for power +/- 3.3%

Tuning information

Flux and efficacy versus current (at Tc nominal)

I [mA]	Flux [%]	Efficacy [%]
540	169	88
420	135	94
300	100	100
240	81	104
150	52	110

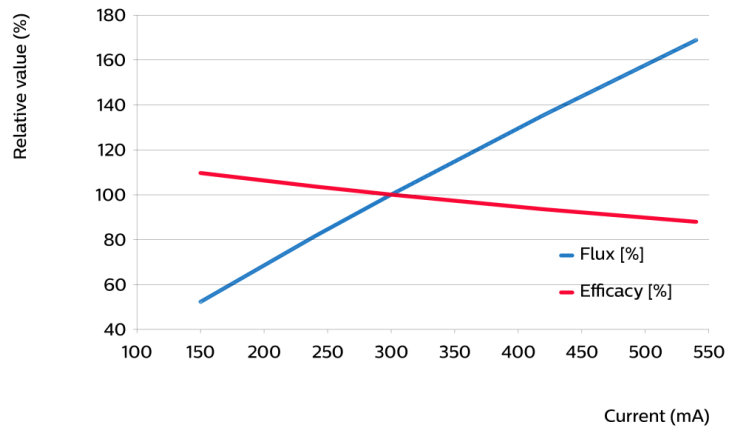

Flux and efficacy versus temperature at Tc (at I nominal)

Tc [°C]	Flux [%]	Efficacy [%]
95	95	95
65	100	100
25	105	104
0	108	106

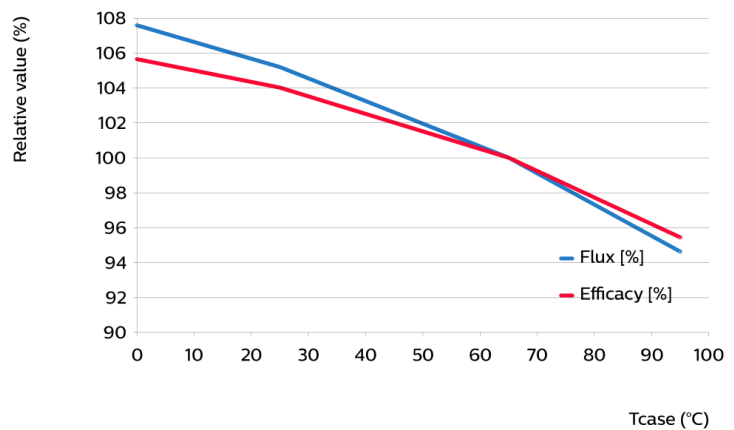

Lumen maintenance

Operation point	Lumen maintenance x 1000 hours	L70			L80			L90		
		B50	B20	B10	B50	B20	B10	B50	B20	B10
80% I-nom 240mA	Tc 50°C	>66	>66	>66	>66	>66	>66	>66	>66	>66
	Tc 65°C	>66	>66	>66	>66	>66	>66	>66	>66	>66
	Tc 95°C	>66	>66	>66	>66	>66	>66	>66	>66	>66
I-nom 300mA	Tc 50°C	>66	>66	>66	>66	>66	>66	>66	>66	>66
	Tc 65°C	>66	>66	>66	>66	>66	>66	>66	>66	>66
	Tc 95°C	>66	>66	>66	>66	>66	>66	>66	56	51
I-max 540mA	Tc 50°C	>66	>66	>66	>66	>66	>66	50	42	39
	Tc 65°C	>66	>66	>66	>66	>66	62	38	32	29
	Tc 95°C	>66	>66	60	49	41	38	23	19	17

Lifetime

Parameter	Value	Unit
M70F50 nominal	>66000	hours

Performance Window

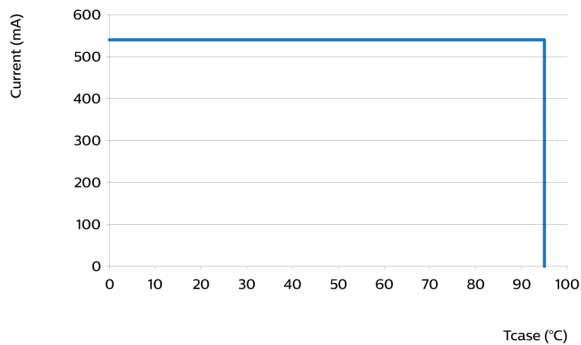

Mechanical characteristics

Parameter	Min	Typ	Max	Unit
Length	18.8	19	19.2	mm
Width	15.8	16	16.2	mm
Height Height PCB	0.9	1	1.1	mm
Height Height including dam	1.3	1.6	1.9	mm
Product mass		0.81		gram

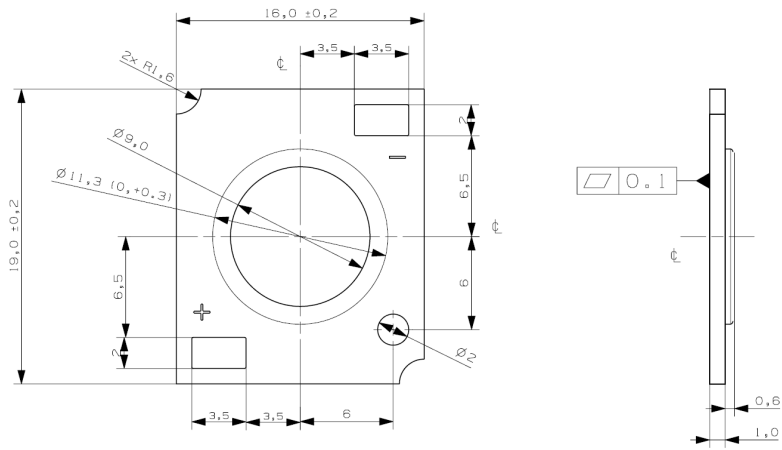

Absolute ratings

Parameter	Min	Max	Unit
Current through the LED module (I-max)		540	mA
Case temperature (Tc-max)		95	°C
ESD (direct contact)	8		kV
Working voltage		60	V _{dc}
Ambient temperature	-20	40	°C
Storage temperature	-40	80	°C

At illumination levels exceeding 1342 lux risk group classification may be RG2.

Application information

Certificates and Standards

CB
 CE
 ENEC
 ENEC+
 EPRS 001
 IEC 62031
 UKCA
 UL
 UL 8750

Environmental

RoHS/REACH

Application

Dimming

Yes



© 2025 Signify Holding, IBRS 10461, 5600VB, NL. All rights reserved. The information provided herein is subject to change, without notice. Signify does not give any representation or warranty as to the accuracy or completeness of the information included herein and shall not be liable for any action in reliance thereon. The information presented in this document is not intended as any commercial offer and does not form part of any quotation or contract, unless otherwise agreed by Signify.

www.philips.com/oem

Philips and the Philips Shield Emblem are registered trademarks of Koninklijke Philips N.V. All other trademarks are owned by Signify Holding or their respective owners.
UK importer address: Signify Commercial UK Limited, 3 Guildford Business Park, GU2 8XG

16/06/2025