

PHILIPS

Fortimo

LED

Fortimo SLM C 9xx 1210
L15 1919 G8N

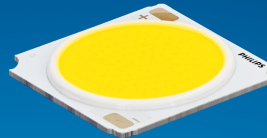

Datasheet

Best offer of performance and value

Fortimo LED SLM CRI90 G8N Standard

The Fortimo SLM family is Signify's core portfolio, now in its latest generation - Gen 8. This new generation boasts improved efficacy compared to the previous one and an expanded portfolio that includes specific spectrums such as Premium White, Premium Color, and standard color for all applications. It maintains the same two footprints as the previous generation, enabling easy upgrades. Together with other Fortimo SLM G8 product lines, our Fortimo SLM G8 will continuously unlock the extraordinary potential of light, facilitate innovation, and inspire the next generation of luminaire design for our OEM customers. Please also visit the online Easy Design-in Tool for your perfect system combination at www.easydesignintool.com.

Key features and benefits

- +5% efficacy further improvement Vs G7
- Best quality of light available for all applications
- More complete portfolio for easy choice
- Same footprint for easy upgrade
- System proposition

March 2025



Ordering data

Commercial product name	EOC	12NC	EPREL registration #	Box quantity
Fortimo SLM C 927 1210 L15 1919 G8N	8721103 082558 00	9290 048 18201	2270441	20
Fortimo SLM C 930 1210 L15 1919 G8N	8721103 082589 00	9290 048 18301	2270438	20
Fortimo SLM C 935 1210 L15 1919 G8N	8721103 082619 00	9290 048 18401	2270424	20
Fortimo SLM C 940 1210 L15 1919 G8N	8721103 082640 00	9290 048 18501	2270094	20
Fortimo SLM C 930 PW 1210 L15 1919 G8N	8721103 082671 00	9290 048 18601	2270467	20
Fortimo SLM C 935 PW 1210 L15 1919 G8N	8721103 082701 00	9290 048 18701	2270460	20
Fortimo SLM C 940 PW 1210 L15 1919 G8N	8721103 082732 00	9290 048 18801	2270472	20

Drive currents

Parameter	Nominal*	Life**	Max***	Unit
Fortimo SLM C 9xx 1210 L15 1919 G8N	900	see performance window	2300	mA

Module temperatures

Parameter	Nominal*	Life**	Max***	Unit
T _c (case temperature at T _c point)	65	see performance window	95	°C

* Nominal value at which typical performance is specified

** Value at which life time is specified

*** Maximum value for safe operation, do not operate above this value

Optical characteristics - table per color (CCT)

Fortimo SLM C 927 1210 L15 1919 G8N

Parameter	Min	Typ	Max	Unit
Luminous flux	3705	3900	4290	lm
Efficacy		126		lm/W
Correlated color temperature (CCT)		2700		K
Color coordinates (CIEx, CIEy)		(0.458, 0.410)		-
Color consistency			3	SDCM
CRI	90			
R9	50			
Photometric code		927/359		
Photobiological safety		RG1 unlimited		



Measurement precision $\pm 5\%$ for the flux data and $\pm 6\%$ for the efficacy data. Measurement precision for color coordinates ± 0.005 . Measurement precision for CRI ± 1.5 .

Operation point	927	lm	lm/W
80% I-nom 720mA	Tc 25 °C	3315	134
	Tc-nom 65 °C	3171	130
	Tc-max 95 °C	3032	126
I-nom 900mA	Tc 25 °C	4079	130
	Tc-nom 65 °C	3900	126
	Tc-max 95 °C	3727	121
I-max 2300mA	Tc 25 °C	9418	104
	Tc-nom 65 °C	8968	100
	Tc-max 95 °C	8531	96

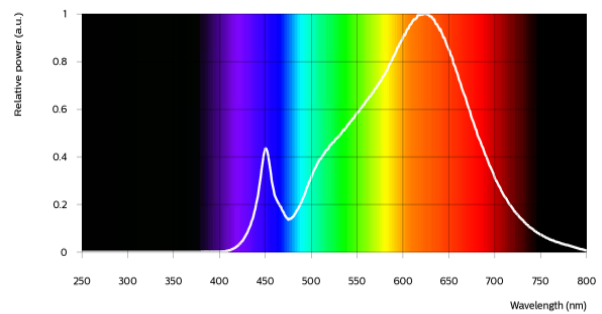

Fortimo SLM C 930 1210 L15 1919 G8N

Parameter	Min	Typ	Max	Unit
Luminous flux	3938	4145	4560	lm
Efficacy		134		lm/W
Correlated color temperature (CCT)		3000		K
Color coordinates (CIEx, CIEy)		(0.434, 0.403)		-
Color consistency			3	SDCM
CRI	90			
R9	50			
Photometric code		930/359		
Photobiological safety		RG1 unlimited		



Measurement precision $\pm 5\%$ for the flux data and $\pm 6\%$ for the efficacy data. Measurement precision for color coordinates ± 0.005 . Measurement precision for CRI ± 1.5 .

Operation point	930	lm	lm/W
80% I-nom 720mA	Tc 25 °C	3523	143
	Tc-nom 65 °C	3370	139
	Tc-max 95 °C	3222	134
I-nom 900mA	Tc 25 °C	4335	138
	Tc-nom 65 °C	4145	134
	Tc-max 95 °C	3961	129
I-max 2300mA	Tc 25 °C	10011	110
	Tc-nom 65 °C	9534	106
	Tc-max 95 °C	9071	102

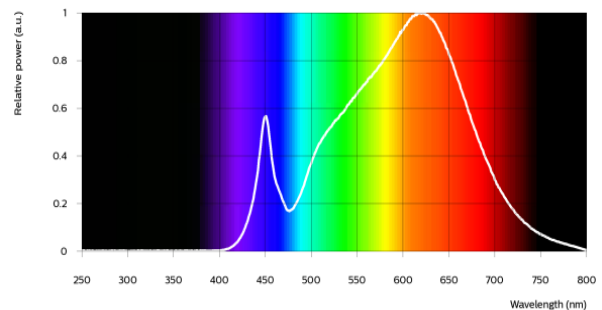

Fortimo SLM C 935 1210 L15 1919 G8N

Parameter	Min	Typ	Max	Unit
Luminous flux	4052	4265	4692	lm
Efficacy		138		lm/W
Correlated color temperature (CCT)		3500		K
Color coordinates (CIEx, CIEy)		(0.408, 0.393)		-
Color consistency			3	SDCM
CRI	90			
R9	50			
Photometric code		935/359		
Photobiological safety		RG1 unlimited		

Measurement precision ± 5% for the flux data and ± 6% for the efficacy data. Measurement precision for color coordinates ± 0.005. Measurement precision for CRI ± 1.5.

Operation point	935	lm	lm/W
80% I-nom 720mA	Tc 25 °C	3625	147
	Tc-nom 65 °C	3468	143
	Tc-max 95 °C	3316	138
I-nom 900mA	Tc 25 °C	4460	142
	Tc-nom 65 °C	4265	138
	Tc-max 95 °C	4076	133
I-max 2300mA	Tc 25 °C	10301	113
	Tc-nom 65 °C	9811	109
	Tc-max 95 °C	9335	105

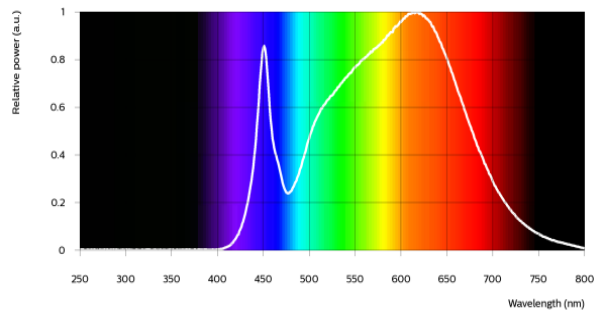

Fortimo SLM C 940 1210 L15 1919 G8N

Parameter	Min	Typ	Max	Unit
Luminous flux	4147	4365	4802	lm
Efficacy		141		lm/W
Correlated color temperature (CCT)		4000		K
Color coordinates (CIEx, CIEy)		(0.382, 0.380)		-
Color consistency			3	SDCM
CRI	90			
R9	50			
Photometric code		940/359		
Photobiological safety		RG1 unlimited		

Measurement precision ± 5% for the flux data and ± 6% for the efficacy data. Measurement precision for color coordinates ± 0.005. Measurement precision for CRI ± 1.5.

Operation point	940	lm	lm/W
80% I-nom 720mA	Tc 25 °C	3710	150
	Tc-nom 65 °C	3549	146
	Tc-max 95 °C	3393	141
I-nom 900mA	Tc 25 °C	4565	145
	Tc-nom 65 °C	4365	141
	Tc-max 95 °C	4172	136
I-max 2300mA	Tc 25 °C	10544	116
	Tc-nom 65 °C	10042	112
	Tc-max 95 °C	9555	107

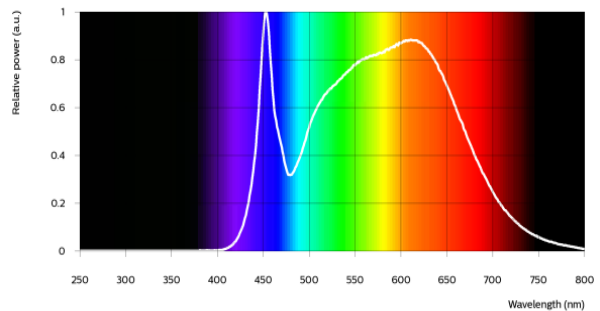

Fortimo SLM C 930 PW 1210 L15 1919 G8N

Parameter	Min	Typ	Max	Unit
Luminous flux	3938	4145	4560	lm
Efficacy		134		lm/W
Correlated color temperature (CCT)		3000		K
Color coordinates (CIEx, CIEy)		(0.422, 0.386)		-
Color consistency			3	SDCM
CRI	90			
R9	50			
Photometric code		930/359		
Photobiological safety		RG1 unlimited		

Measurement precision ± 5% for the flux data and ± 6% for the efficacy data. Measurement precision for color coordinates ± 0.005. Measurement precision for CRI ± 1.5.

Operation point	930	lm	lm/W
80% I-nom 720mA	Tc 25 °C	3523	143
	Tc-nom 65 °C	3370	139
	Tc-max 95 °C	3222	134
I-nom 900mA	Tc 25 °C	4335	138
	Tc-nom 65 °C	4145	134
	Tc-max 95 °C	3961	129
I-max 2300mA	Tc 25 °C	10011	110
	Tc-nom 65 °C	9534	106
	Tc-max 95 °C	9071	102

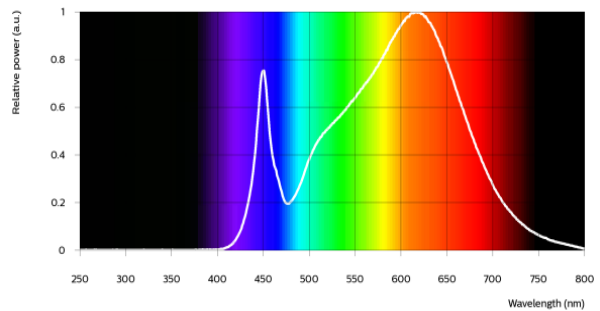

Fortimo SLM C 935 PW 1210 L15 1919 G8N

Parameter	Min	Typ	Max	Unit
Luminous flux	4052	4265	4692	lm
Efficacy		138		lm/W
Correlated color temperature (CCT)		3500		K
Color coordinates (CIEx, CIEy)		(0.398, 0.376)		-
Color consistency			3	SDCM
CRI	90			
R9	50			
Photometric code		935/359		
Photobiological safety		RG1 unlimited		

Measurement precision ± 5% for the flux data and ± 6% for the efficacy data. Measurement precision for color coordinates ± 0.005. Measurement precision for CRI ± 1.5.

Operation point	935	lm	lm/W
80% I-nom 720mA	Tc 25 °C	3625	147
	Tc-nom 65 °C	3468	143
	Tc-max 95 °C	3316	138
I-nom 900mA	Tc 25 °C	4460	142
	Tc-nom 65 °C	4265	138
	Tc-max 95 °C	4076	133
I-max 2300mA	Tc 25 °C	10301	113
	Tc-nom 65 °C	9811	109
	Tc-max 95 °C	9335	105

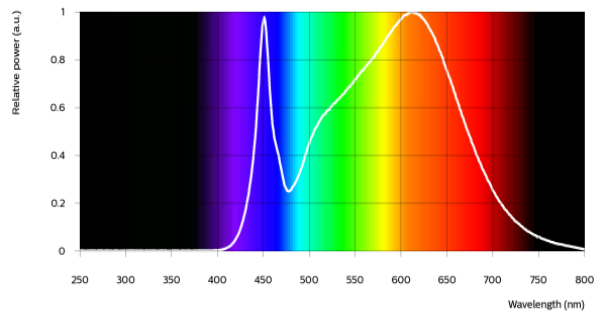

Fortimo SLM C 940 PW 1210 L15 1919 G8N

Parameter	Min	Typ	Max	Unit
Luminous flux	4147	4365	4802	lm
Efficacy		141		lm/W
Correlated color temperature (CCT)		4000		K
Color coordinates (CIEx, CIEy)		(0.374, 0.364)		-
Color consistency			3	SDCM
CRI	90			
R9	50			
Photometric code		940/359		
Photobiological safety		RG1 unlimited		

Measurement precision ± 5% for the flux data and ± 6% for the efficacy data. Measurement precision for color coordinates ± 0.005. Measurement precision for CRI ± 1.5.

Operation point	940	lm	lm/W
80% I-nom 720mA	Tc 25 °C	3710	150
	Tc-nom 65 °C	3549	146
	Tc-max 95 °C	3393	141
I-nom 900mA	Tc 25 °C	4565	145
	Tc-nom 65 °C	4365	141
	Tc-max 95 °C	4172	136
I-max 2300mA	Tc 25 °C	10544	116
	Tc-nom 65 °C	10042	112
	Tc-max 95 °C	9555	107

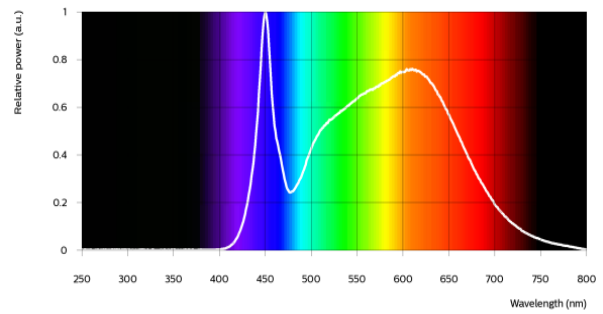



Electrical characteristics

Parameter	Min	Typ	Max	Unit
Forward voltage	32.5	34.5	37.0	V
Power consumption	29.3	31.1	33.3	W = kWh/1000h
Number of modules in series per chain			1	
Number of modules per chain			1	
Number of modules in parallel			1	

Measurement precision for Vf +/- 3%. Measurement precision for power +/- 3.3%

Tuning information

Flux and efficacy versus current (at Tc nominal)

I [mA]	Flux [%]	Efficacy [%]
2300	230	79
1600	168	88
900	100	100
720	81	104
450	52	109

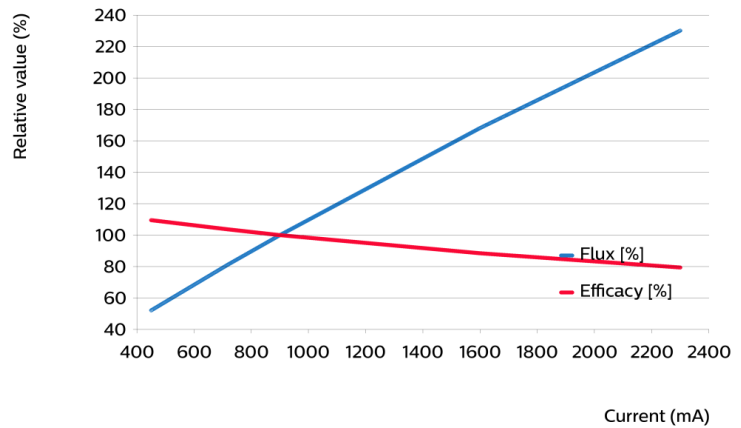

Flux and efficacy versus temperature at Tc (at I nominal)

Tc [°C]	Flux [%]	Efficacy [%]
95	96	97
65	100	100
25	105	103
0	107	105

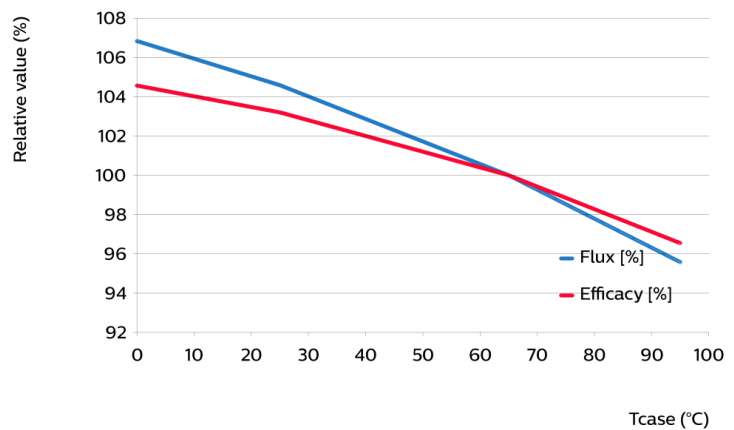

Lumen maintenance

Operation point	Lumen maintenance x 1000 hours	L70			L80			L90		
		B50	B20	B10	B50	B20	B10	B50	B20	B10
80% I-nom 720mA	Tc 50°C	>66	>66	>66	>66	>66	>66	>66	>66	>66
	Tc 65°C	>66	>66	>66	>66	>66	>66	>66	>66	>66
	Tc 95°C	>66	>66	>66	>66	>66	>66	>66	>66	>66
I-nom 900mA	Tc 50°C	>66	>66	>66	>66	>66	>66	>66	>66	>66
	Tc 65°C	>66	>66	>66	>66	>66	>66	>66	>66	>66
	Tc 95°C	>66	>66	>66	>66	>66	>66	>66	>66	62
I-max 2300mA	Tc 50°C	>66	>66	>66	>66	58	53	32	27	25
	Tc 65°C	>66	>66	64	51	43	40	24	20	18
	Tc 95°C	50	42	39	31	26	24	14	12	11

Lifetime

Parameter	Value	Unit
M70F50 nominal	>66000	hours

Performance Window

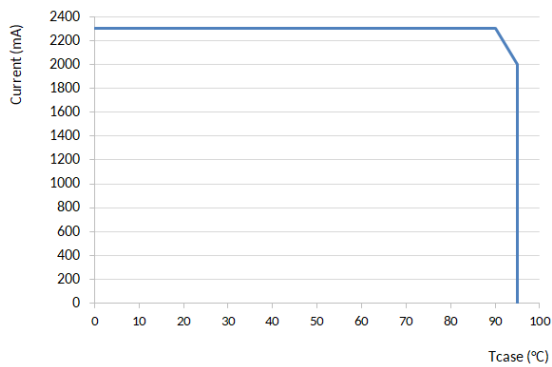

Mechanical characteristics

Parameter	Min	Typ	Max	Unit
Length	18.75	19	19.25	mm
Width	18.75	19	19.25	mm
Height PCB	0.8	0.9	1	mm
Height including dam	1.1	1.4	1.7	mm
Product mass		0.99		gram

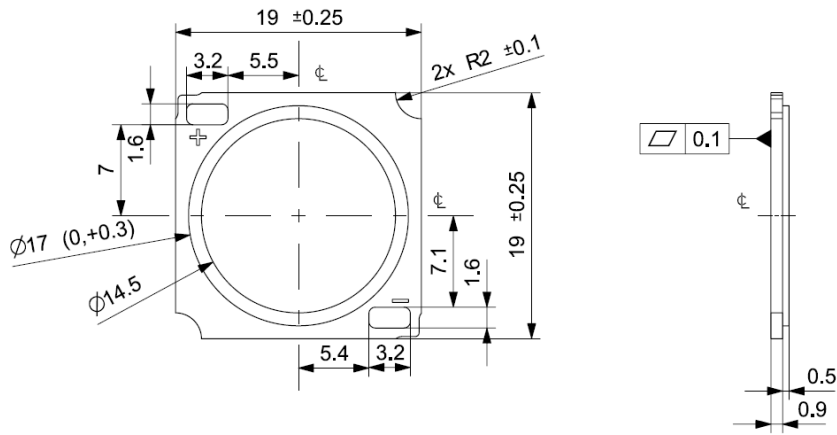

Absolute ratings

Parameter	Min	Max	Unit
Current through the LED module (I-max)		2300	mA
Case temperature (Tc-max)		95	°C
ESD (direct contact)	8		kV
Working voltage		60	V _{dc}
Ambient temperature	-20	40	°C
Storage temperature	-40	80	°C

At illumination levels exceeding 1372 lux risk group classification may be RG2.

Application information

Certificates and Standards

CB
 CE
 ENEC
 IEC/EN 62031
 UKCA
 UL
 UL 8750

Environmental

RoHS/REACH

Application

IP rating	No IP-rating
Overheating protection	No
Luminaire class	IEC Class I and Class II
Dimming	Yes



© 2025 Signify Holding, IBRS 10461, 5600VB, NL. All rights reserved. The information provided herein is subject to change, without notice. Signify does not give any representation or warranty as to the accuracy or completeness of the information included herein and shall not be liable for any action in reliance thereon. The information presented in this document is not intended as any commercial offer and does not form part of any quotation or contract, unless otherwise agreed by Signify.

www.philips.com/oem

Philips and the Philips Shield Emblem are registered trademarks of Koninklijke Philips N.V. All other trademarks are owned by Signify Holding or their respective owners.
UK importer address: Signify Commercial UK Limited, 3 Guildford Business Park, GU2 8XG

10/03/2025