

**PHILIPS**

**Fortimo**

**LED**

Fortimo SLM C 9xx 1208  
L15 1919 G8N

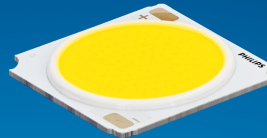

Datasheet

# Best offer of performance and value

## Fortimo LED SLM CRI90 G8N Standard

The Fortimo SLM family is Signify's core portfolio, now in its latest generation - Gen 8. This new generation boasts improved efficacy compared to the previous one and an expanded portfolio that includes specific spectrums such as Premium White, Premium Color, and standard color for all applications. It maintains the same two footprints as the previous generation, enabling easy upgrades. Together with other Fortimo SLM G8 product lines, our Fortimo SLM G8 will continuously unlock the extraordinary potential of light, facilitate innovation, and inspire the next generation of luminaire design for our OEM customers. Please also visit the online Easy Design-in Tool for your perfect system combination at [www.easydesignintool.com](http://www.easydesignintool.com).

### Key features and benefits

- +5% efficacy further improvement Vs G7
- Best quality of light available for all applications
- More complete portfolio for easy choice
- Same footprint for easy upgrade
- System proposition

March 2025



## Ordering data

Commercial product name	EOC	12NC	EPREL registration #	Box quantity
Fortimo SLM C 927 1208 L15 1919 G8N	8721103 081988 00	9290 048 16301	2270387	20
Fortimo SLM C 930 1208 L15 1919 G8N	8721103 082015 00	9290 048 16401	2270384	20
Fortimo SLM C 935 1208 L15 1919 G8N	8721103 082046 00	9290 048 16501	2270385	20
Fortimo SLM C 940 1208 L15 1919 G8N	8721103 082077 00	9290 048 16601	2270369	20
Fortimo SLM C 930 PW 1208 L15 1919 G8N	8721103 082107 00	9290 048 16701	2270447	20
Fortimo SLM C 935 PW 1208 L15 1919 G8N	8721103 082138 00	9290 048 16801	2270429	20
Fortimo SLM C 940 PW 1208 L15 1919 G8N	8721103 082169 00	9290 048 16901	2270443	20

## Drive currents

Parameter	Nominal*	Life**	Max***	Unit
Fortimo SLM C 9xx 1208 L15 1919 G8N	720	see performance window	1840	mA

## Module temperatures

Parameter	Nominal*	Life**	Max***	Unit
T <sub>c</sub> (case temperature at T <sub>c</sub> point)	65	see performance window	95	°C

\* Nominal value at which typical performance is specified

\*\* Value at which life time is specified

\*\*\* Maximum value for safe operation, do not operate above this value

## Optical characteristics - table per color (CCT)

### Fortimo SLM C 927 1208 L15 1919 G8N

Parameter	Min	Typ	Max	Unit
Luminous flux	3007	3165	3482	lm
Efficacy		128		lm/W
Correlated color temperature (CCT)		2700		K
Color coordinates (CIEx, CIEy)		(0.458, 0.410)		-
Color consistency			3	SDCM
CRI	90			
R9	50			
Photometric code		927/359		
Photobiological safety		RG1 unlimited		

Measurement precision  $\pm 5\%$  for the flux data and  $\pm 6\%$  for the efficacy data. Measurement precision for color coordinates  $\pm 0.005$ . Measurement precision for CRI  $\pm 1.5$ .

Operation point	927	lm	lm/W
80% I-nom 576mA	Tc 25 °C	2699	137
	Tc-nom 65 °C	2573	132
	Tc-max 95 °C	2462	128
I-nom 720mA	Tc 25 °C	3321	132
	Tc-nom 65 °C	3165	128
	Tc-max 95 °C	3027	123
I-max 1840mA	Tc 25 °C	7657	105
	Tc-nom 65 °C	7277	101
	Tc-max 95 °C	6941	97

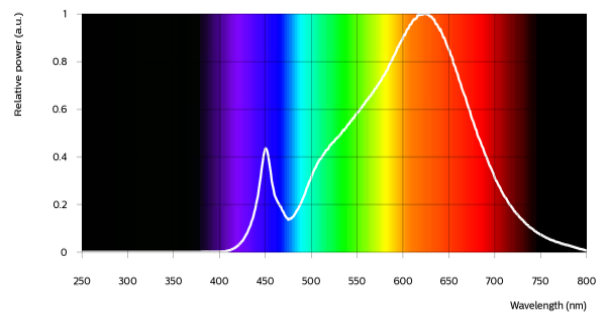

### Fortimo SLM C 930 1208 L15 1919 G8N

Parameter	Min	Typ	Max	Unit
Luminous flux	3197	3365	3702	lm
Efficacy		136		lm/W
Correlated color temperature (CCT)		3000		K
Color coordinates (CIEx, CIEy)		(0.434, 0.403)		-
Color consistency			3	SDCM
CRI	90			
R9	50			
Photometric code		930/359		
Photobiological safety		RG1 unlimited		

Measurement precision  $\pm 5\%$  for the flux data and  $\pm 6\%$  for the efficacy data. Measurement precision for color coordinates  $\pm 0.005$ . Measurement precision for CRI  $\pm 1.5$ .

Operation point	930	lm	lm/W
80% I-nom 576mA	Tc 25 °C	2869	146
	Tc-nom 65 °C	2735	140
	Tc-max 95 °C	2617	136
I-nom 720mA	Tc 25 °C	3531	141
	Tc-nom 65 °C	3365	136
	Tc-max 95 °C	3219	131
I-max 1840mA	Tc 25 °C	8142	112
	Tc-nom 65 °C	7739	107
	Tc-max 95 °C	7382	103

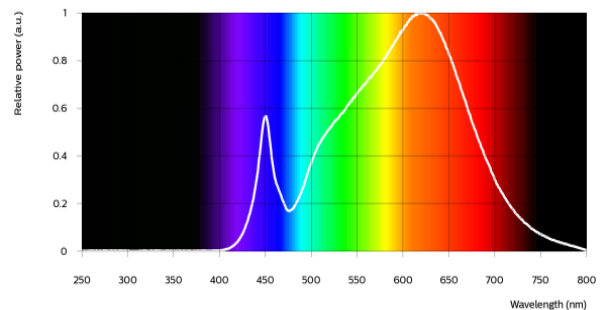

Fortimo SLM C 935 1208 L15 1919 G8N

Parameter	Min	Typ	Max	Unit
Luminous flux	3292	3465	3812	lm
Efficacy		140		lm/W
Correlated color temperature (CCT)		3500		K
Color coordinates (CIEx, CIEy)		(0.408, 0.393)		-
Color consistency			3	SDCM
CRI	90			
R9	50			
Photometric code		935/359		
Photobiological safety		RG1 unlimited		

Measurement precision ± 5% for the flux data and ± 6% for the efficacy data. Measurement precision for color coordinates ± 0.005. Measurement precision for CRI ± 1.5.

Operation point	935	lm	lm/W
80% I-nom 576mA	Tc 25 °C	2954	150
	Tc-nom 65 °C	2817	144
	Tc-max 95 °C	2695	140
I-nom 720mA	Tc 25 °C	3636	145
	Tc-nom 65 °C	3465	140
	Tc-max 95 °C	3315	135
I-max 1840mA	Tc 25 °C	8385	115
	Tc-nom 65 °C	7970	110
	Tc-max 95 °C	7603	106

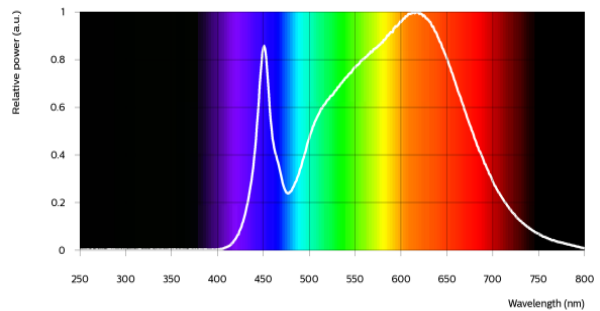

Fortimo SLM C 940 1208 L15 1919 G8N

Parameter	Min	Typ	Max	Unit
Luminous flux	3363	3540	3894	lm
Efficacy		143		lm/W
Correlated color temperature (CCT)		4000		K
Color coordinates (CIEx, CIEy)		(0.382, 0.380)		-
Color consistency			3	SDCM
CRI	90			
R9	50			
Photometric code		940/359		
Photobiological safety		RG1 unlimited		

Measurement precision ± 5% for the flux data and ± 6% for the efficacy data. Measurement precision for color coordinates ± 0.005. Measurement precision for CRI ± 1.5.

Operation point	940	lm	lm/W
80% I-nom 576mA	Tc 25 °C	3018	153
	Tc-nom 65 °C	2877	148
	Tc-max 95 °C	2753	143
I-nom 720mA	Tc 25 °C	3714	148
	Tc-nom 65 °C	3540	143
	Tc-max 95 °C	3386	138
I-max 1840mA	Tc 25 °C	8567	117
	Tc-nom 65 °C	8143	113
	Tc-max 95 °C	7768	108

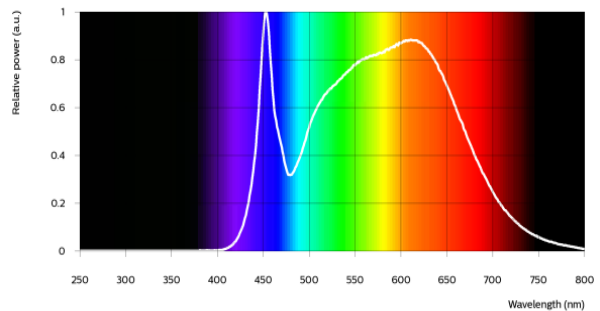

Fortimo SLM C 930 PW 1208 L15 1919 G8N

Parameter	Min	Typ	Max	Unit
Luminous flux	3197	3365	3702	lm
Efficacy		136		lm/W
Correlated color temperature (CCT)		3000		K
Color coordinates (CIEx, CIEy)		(0.422, 0.386)		-
Color consistency			3	SDCM
CRI	90			
R9	50			
Photometric code		930/359		
Photobiological safety		RG1 unlimited		

Measurement precision ± 5% for the flux data and ± 6% for the efficacy data. Measurement precision for color coordinates ± 0.005. Measurement precision for CRI ± 1.5.

Operation point	930	lm	lm/W
80% I-nom 576mA	Tc 25 °C	2869	146
	Tc-nom 65 °C	2735	140
	Tc-max 95 °C	2617	136
I-nom 720mA	Tc 25 °C	3531	141
	Tc-nom 65 °C	3365	136
	Tc-max 95 °C	3219	131
I-max 1840mA	Tc 25 °C	8142	112
	Tc-nom 65 °C	7739	107
	Tc-max 95 °C	7382	103

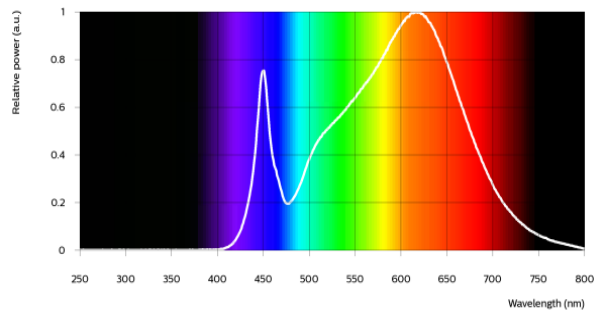

Fortimo SLM C 935 PW 1208 L15 1919 G8N

Parameter	Min	Typ	Max	Unit
Luminous flux	3292	3465	3812	lm
Efficacy		140		lm/W
Correlated color temperature (CCT)		3500		K
Color coordinates (CIEx, CIEy)		(0.398, 0.376)		-
Color consistency			3	SDCM
CRI	90			
R9	50			
Photometric code		935/359		
Photobiological safety		RG0		

Measurement precision ± 5% for the flux data and ± 6% for the efficacy data. Measurement precision for color coordinates ± 0.005. Measurement precision for CRI ± 1.5.

Operation point	935	lm	lm/W
80% I-nom 576mA	Tc 25 °C	2954	150
	Tc-nom 65 °C	2817	144
	Tc-max 95 °C	2695	140
I-nom 720mA	Tc 25 °C	3636	145
	Tc-nom 65 °C	3465	140
	Tc-max 95 °C	3315	135
I-max 1840mA	Tc 25 °C	8385	115
	Tc-nom 65 °C	7970	110
	Tc-max 95 °C	7603	106

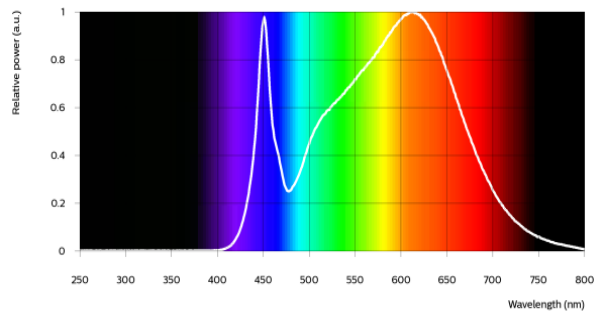

Fortimo SLM C 940 PW 1208 L15 1919 G8N

Parameter	Min	Typ	Max	Unit
Luminous flux	3368	3545	3900	lm
Efficacy		143		lm/W
Correlated color temperature (CCT)		4000		K
Color coordinates (CIEx, CIEy)		(0.374, 0.364)		-
Color consistency			3	SDCM
CRI	90			
R9	50			
Photometric code		940/359		
Photobiological safety		RG1 unlimited		

Measurement precision ± 5% for the flux data and ± 6% for the efficacy data. Measurement precision for color coordinates ± 0.005. Measurement precision for CRI ± 1.5.

Operation point	940	lm	lm/W
80% I-nom 576mA	Tc 25 °C	3022	153
	Tc-nom 65 °C	2882	148
	Tc-max 95 °C	2757	143
I-nom 720mA	Tc 25 °C	3719	148
	Tc-nom 65 °C	3545	143
	Tc-max 95 °C	3391	138
I-max 1840mA	Tc 25 °C	8580	118
	Tc-nom 65 °C	8155	113
	Tc-max 95 °C	7780	109

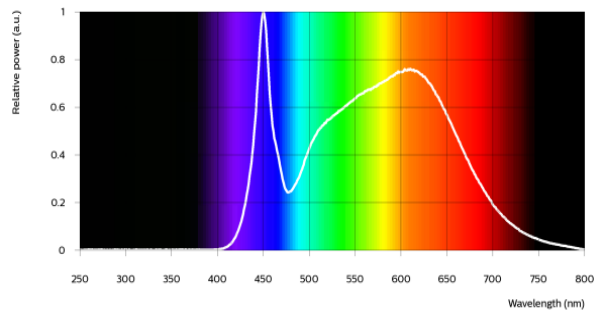



## Electrical characteristics

Parameter	Min	Typ	Max	Unit
Forward voltage	32.5	34.5	37.0	V
Power consumption	23.4	24.8	26.6	W = kWh/1000h
Number of modules in series per chain			1	
Number of modules per chain			1	
Number of modules in parallel			1	

Measurement precision for Vf +/- 3%. Measurement precision for power +/- 3.3%

## Tuning information

Flux and efficacy versus current (at Tc nominal)

I [mA]	Flux [%]	Efficacy [%]
1840	230	79
1280	168	88
720	100	100
576	81	104
360	52	109

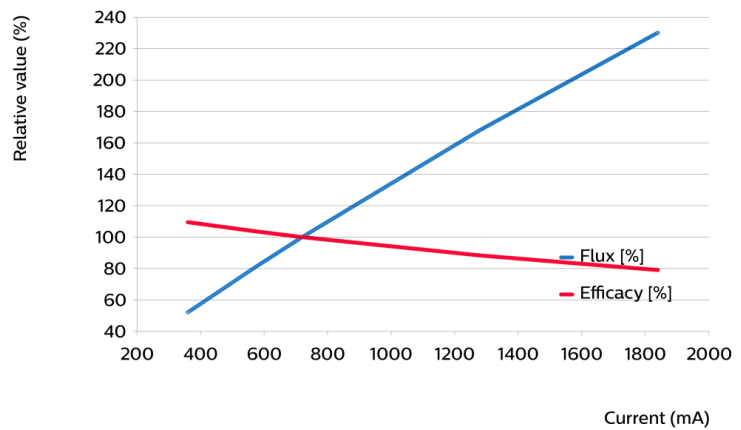

Flux and efficacy versus temperature at Tc (at I nominal)

Tc [°C]	Flux [%]	Efficacy [%]
95	96	96
65	100	100
25	105	104
0	108	106

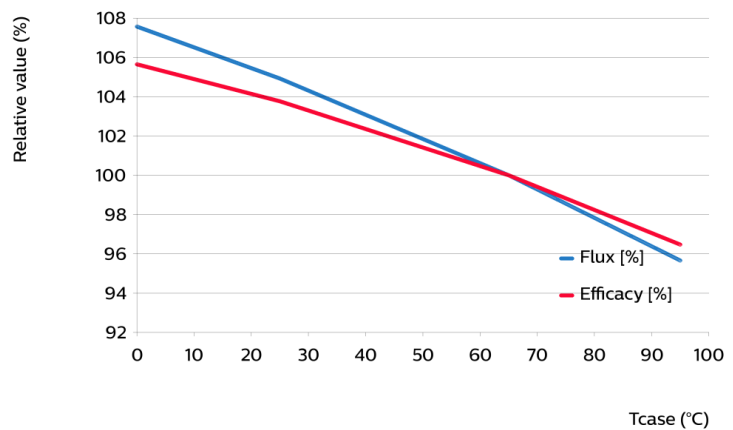

## Lumen maintenance

Operation point	Lumen maintenance x 1000 hours	L70			L80			L90		
		B50	B20	B10	B50	B20	B10	B50	B20	B10
80% I-nom 576mA	Tc 50°C	>66	>66	>66	>66	>66	>66	>66	>66	>66
	Tc 65°C	>66	>66	>66	>66	>66	>66	>66	>66	>66
	Tc 95°C	>66	>66	>66	>66	>66	>66	>66	>66	>66
I-nom 720mA	Tc 50°C	>66	>66	>66	>66	>66	>66	>66	>66	>66
	Tc 65°C	>66	>66	>66	>66	>66	>66	>66	>66	>66
	Tc 95°C	>66	>66	>66	>66	>66	>66	>66	>66	62
I-max 1840mA	Tc 50°C	>66	>66	>66	>66	58	53	32	27	25
	Tc 65°C	>66	>66	64	51	43	40	24	20	18
	Tc 95°C	50	42	39	31	26	24	14	12	11

## Lifetime

Parameter	Value	Unit
M70F50 nominal	>66000	hours

## Performance Window

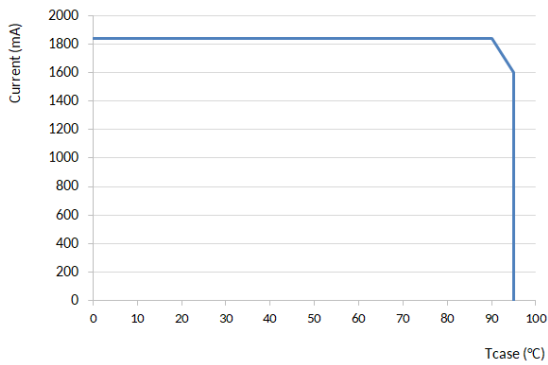

## Mechanical characteristics

Parameter	Min	Typ	Max	Unit
Length	18.75	19	19.25	mm
Width	18.75	19	19.25	mm
Height	0.8	0.9	1	mm
Height	1.1	1.4	1.7	mm
Product mass		0.98		gram

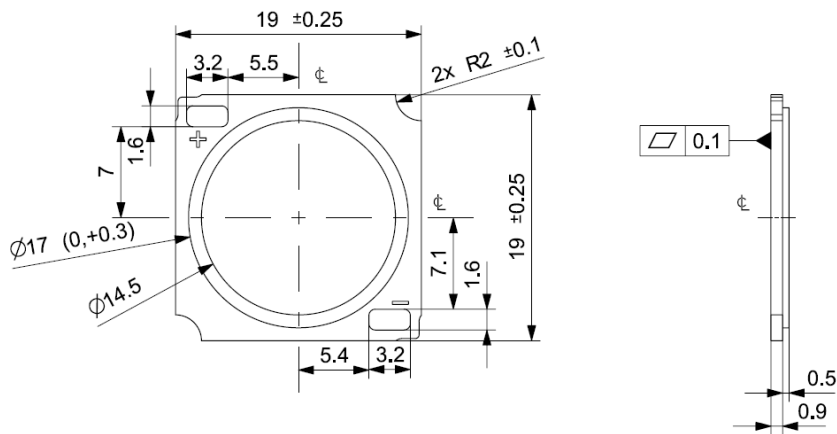

## Absolute ratings

Parameter	Min	Max	Unit
Current through the LED module (I-max)		1840	mA
Case temperature (Tc-max)		95	°C
ESD (direct contact)	8		kV
Working voltage		60	V <sub>dc</sub>
Ambient temperature	-20	40	°C
Storage temperature	-40	80	°C

At illumination levels exceeding 1372 lux risk group classification may be RG2.

## Application information

### Certificates and Standards

CB  
 CE  
 ENEC  
 IEC/EN 62031  
 UKCA  
 UL  
 UL 8750

### Environmental

RoHS/REACH

### Application

IP rating	No IP-rating
Overheating protection	No
Luminaire class	IEC Class I and Class II
Dimming	Yes



© 2025 Signify Holding, IBRS 10461, 5600VB, NL. All rights reserved. The information provided herein is subject to change, without notice. Signify does not give any representation or warranty as to the accuracy or completeness of the information included herein and shall not be liable for any action in reliance thereon. The information presented in this document is not intended as any commercial offer and does not form part of any quotation or contract, unless otherwise agreed by Signify.

[www.philips.com/oem](http://www.philips.com/oem)

Philips and the Philips Shield Emblem are registered trademarks of Koninklijke Philips N.V. All other trademarks are owned by Signify Holding or their respective owners.  
UK importer address: Signify Commercial UK Limited, 3 Guildford Business Park, GU2 8XG

10/03/2025