

PHILIPS

Fortimo

LED

Fortimo SLM C 9xx 1206
L15 1919 G8N

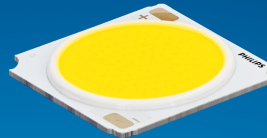

Datasheet

Best offer of performance and value

Fortimo LED SLM CRI90 G8N Standard

The Fortimo SLM family is Signify's core portfolio, now in its latest generation - Gen 8. This new generation boasts improved efficacy compared to the previous one and an expanded portfolio that includes specific spectrums such as Premium White, Premium Color, and standard color for all applications. It maintains the same two footprints as the previous generation, enabling easy upgrades. Together with other Fortimo SLM G8 product lines, our Fortimo SLM G8 will continuously unlock the extraordinary potential of light, facilitate innovation, and inspire the next generation of luminaire design for our OEM customers. Please also visit the online Easy Design-in Tool for your perfect system combination at www.easydesignintool.com.

Key features and benefits

- +5% efficacy further improvement Vs G7
- Best quality of light available for all applications
- More complete portfolio for easy choice
- Same footprint for easy upgrade
- System proposition

March 2025



Ordering data

Commercial product name	EOC	12NC	EPREL registration #	Box quantity
Fortimo SLM C 927 1206 L15 1919 G8N	8721103 081414 00	9290 039 63301	2270119	20
Fortimo SLM C 930 1206 L15 1919 G8N	8721103 081445 00	9290 039 63401	2270102	20
Fortimo SLM C 935 1206 L15 1919 G8N	8721103 081476 00	9290 039 63501	2270124	20
Fortimo SLM C 940 1206 L15 1919 G8N	8721103 081506 00	9290 039 63601	2270129	20
Fortimo SLM C 930 PW 1206 L15 1919 G8N	8721103 081537 00	9290 039 63701	2270135	20
Fortimo SLM C 935 PW 1206 L15 1919 G8N	8721103 081568 00	9290 039 63801	2270454	20
Fortimo SLM C 940 PW 1206 L15 1919 G8N	8721103 081599 00	9290 039 63901	2270107	20

Drive currents

Parameter	Nominal*	Life**	Max***	Unit
Fortimo SLM C 9xx 1206 L15 1919 G8N	540	see performance window	1380	mA

Module temperatures

Parameter	Nominal*	Life**	Max***	Unit
T _c (case temperature at T _c point)	65	see performance window	95	°C

* Nominal value at which typical performance is specified

** Value at which life time is specified

*** Maximum value for safe operation, do not operate above this value

Optical characteristics - table per color (CCT)

Fortimo SLM C 927 1206 L15 1919 G8N

Parameter	Min	Typ	Max	Unit
Luminous flux	2290	2410	2651	lm
Efficacy		130		lm/W
Correlated color temperature (CCT)		2700		K
Color coordinates (CIEx, CIEy)		(0.458, 0.410)		-
Color consistency			3	SDCM
CRI	90			
R9	50			
Photometric code		927/359		
Photobiological safety		RG1 unlimited		

Measurement precision $\pm 5\%$ for the flux data and $\pm 6\%$ for the efficacy data. Measurement precision for color coordinates ± 0.005 . Measurement precision for CRI ± 1.5 .

Operation point	927	lm	lm/W
80% I-nom 432mA	Tc 25 °C	2051	139
	Tc-nom 65 °C	1958	134
	Tc-max 95 °C	1866	129
I-nom 540mA	Tc 25 °C	2524	134
	Tc-nom 65 °C	2410	130
	Tc-max 95 °C	2295	125
I-max 1380mA	Tc 25 °C	5852	108
	Tc-nom 65 °C	5565	104
	Tc-max 95 °C	5276	100

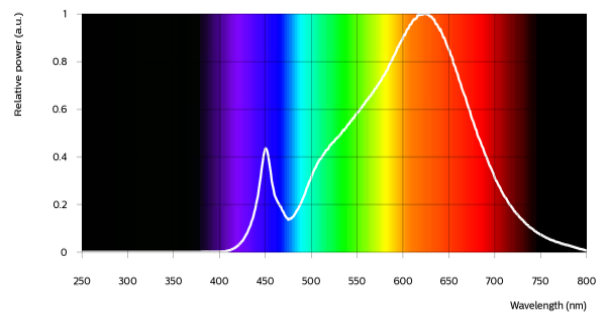

Fortimo SLM C 930 1206 L15 1919 G8N

Parameter	Min	Typ	Max	Unit
Luminous flux	2432	2560	2816	lm
Efficacy		138		lm/W
Correlated color temperature (CCT)		3000		K
Color coordinates (CIEx, CIEy)		(0.434, 0.403)		-
Color consistency			3	SDCM
CRI	90			
R9	50			
Photometric code		930/359		
Photobiological safety		RG1 unlimited		

Measurement precision $\pm 5\%$ for the flux data and $\pm 6\%$ for the efficacy data. Measurement precision for color coordinates ± 0.005 . Measurement precision for CRI ± 1.5 .

Operation point	930	lm	lm/W
80% I-nom 432mA	Tc 25 °C	2178	147
	Tc-nom 65 °C	2080	142
	Tc-max 95 °C	1982	137
I-nom 540mA	Tc 25 °C	2681	142
	Tc-nom 65 °C	2560	138
	Tc-max 95 °C	2438	132
I-max 1380mA	Tc 25 °C	6217	115
	Tc-nom 65 °C	5913	111
	Tc-max 95 °C	5606	106

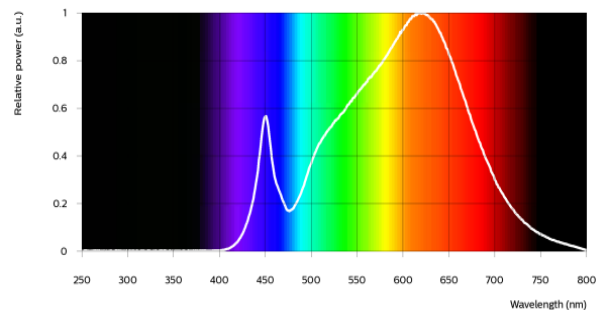

Fortimo SLM C 935 1206 L15 1919 G8N

Parameter	Min	Typ	Max	Unit
Luminous flux	2503	2635	2898	lm
Efficacy		142		lm/W
Correlated color temperature (CCT)		3500		K
Color coordinates (CIEx, CIEy)		(0.408, 0.393)		-
Color consistency			3	SDCM
CRI	90			
R9	50			
Photometric code		935/359		
Photobiological safety		RG1 unlimited		

Measurement precision ± 5% for the flux data and ± 6% for the efficacy data. Measurement precision for color coordinates ± 0.005. Measurement precision for CRI ± 1.5.

Operation point	935	lm	lm/W
80% I-nom 432mA	Tc 25 °C	2242	151
	Tc-nom 65 °C	2141	147
	Tc-max 95 °C	2040	141
I-nom 540mA	Tc 25 °C	2760	146
	Tc-nom 65 °C	2635	142
	Tc-max 95 °C	2509	136
I-max 1380mA	Tc 25 °C	6399	118
	Tc-nom 65 °C	6087	114
	Tc-max 95 °C	5771	109

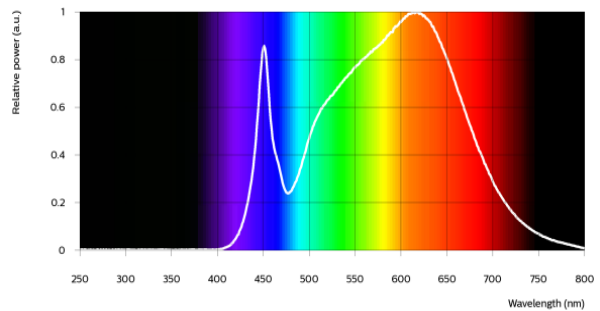

Fortimo SLM C 940 1206 L15 1919 G8N

Parameter	Min	Typ	Max	Unit
Luminous flux	2560	2695	2964	lm
Efficacy		145		lm/W
Correlated color temperature (CCT)		4000		K
Color coordinates (CIEx, CIEy)		(0.382, 0.380)		-
Color consistency			3	SDCM
CRI	90			
R9	50			
Photometric code		940/359		
Photobiological safety		RG1 unlimited		

Measurement precision ± 5% for the flux data and ± 6% for the efficacy data. Measurement precision for color coordinates ± 0.005. Measurement precision for CRI ± 1.5.

Operation point	940	lm	lm/W
80% I-nom 432mA	Tc 25 °C	2293	155
	Tc-nom 65 °C	2190	150
	Tc-max 95 °C	2086	144
I-nom 540mA	Tc 25 °C	2822	149
	Tc-nom 65 °C	2695	145
	Tc-max 95 °C	2566	139
I-max 1380mA	Tc 25 °C	6545	121
	Tc-nom 65 °C	6226	116
	Tc-max 95 °C	5904	111

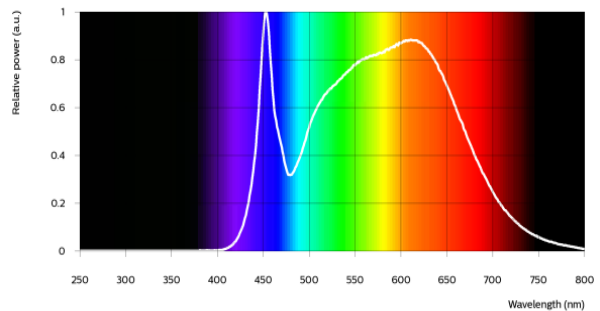

Fortimo SLM C 930 PW 1206 L15 1919 G8N

Parameter	Min	Typ	Max	Unit
Luminous flux	2432	2560	2816	lm
Efficacy		138		lm/W
Correlated color temperature (CCT)		3000		K
Color coordinates (CIEx, CIEy)		(0.422, 0.386)		-
Color consistency			3	SDCM
CRI	90			
R9	50			
Photometric code		930/359		
Photobiological safety		RG1 unlimited		

Measurement precision ± 5% for the flux data and ± 6% for the efficacy data. Measurement precision for color coordinates ± 0.005. Measurement precision for CRI ± 1.5.

Operation point	930	lm	lm/W
80% I-nom 432mA	Tc 25 °C	2178	147
	Tc-nom 65 °C	2080	142
	Tc-max 95 °C	1982	137
I-nom 540mA	Tc 25 °C	2681	142
	Tc-nom 65 °C	2560	138
	Tc-max 95 °C	2438	132
I-max 1380mA	Tc 25 °C	6217	115
	Tc-nom 65 °C	5913	111
	Tc-max 95 °C	5606	106

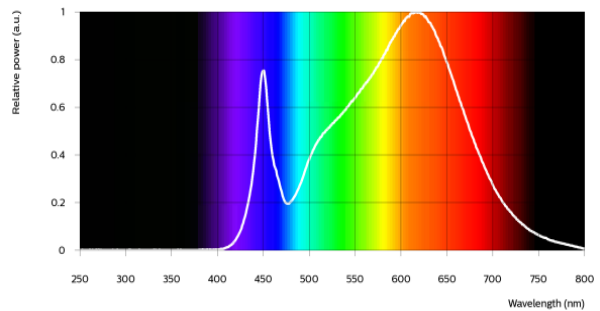

Fortimo SLM C 935 PW 1206 L15 1919 G8N

Parameter	Min	Typ	Max	Unit
Luminous flux	2503	2635	2898	lm
Efficacy		142		lm/W
Correlated color temperature (CCT)		3500		K
Color coordinates (CIEx, CIEy)		(0.398, 0.376)		-
Color consistency			3	SDCM
CRI	90			
R9	50			
Photometric code		935/359		
Photobiological safety		RG1 unlimited		

Measurement precision ± 5% for the flux data and ± 6% for the efficacy data. Measurement precision for color coordinates ± 0.005. Measurement precision for CRI ± 1.5.

Operation point	935	lm	lm/W
80% I-nom 432mA	Tc 25 °C	2242	151
	Tc-nom 65 °C	2141	147
	Tc-max 95 °C	2040	141
I-nom 540mA	Tc 25 °C	2760	146
	Tc-nom 65 °C	2635	142
	Tc-max 95 °C	2509	136
I-max 1380mA	Tc 25 °C	6399	118
	Tc-nom 65 °C	6087	114
	Tc-max 95 °C	5771	109

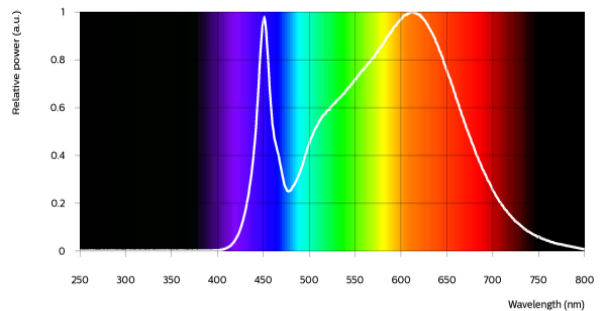

Fortimo SLM C 940 PW 1206 L15 1919 G8N

Parameter	Min	Typ	Max	Unit
Luminous flux	2560	2695	2964	lm
Efficacy		145		lm/W
Correlated color temperature (CCT)		4000		K
Color coordinates (CIEx, CIEy)		(0.374, 0.364)		-
Color consistency			3	SDCM
CRI	90			
R9	50			
Photometric code		940/359		
Photobiological safety		RG1 unlimited		

Measurement precision ± 5% for the flux data and ± 6% for the efficacy data. Measurement precision for color coordinates ± 0.005. Measurement precision for CRI ± 1.5.

Operation point	940	lm	lm/W
80% I-nom 432mA	Tc 25 °C	2293	155
	Tc-nom 65 °C	2190	150
	Tc-max 95 °C	2086	144
I-nom 540mA	Tc 25 °C	2822	149
	Tc-nom 65 °C	2695	145
	Tc-max 95 °C	2566	139
I-max 1380mA	Tc 25 °C	6545	121
	Tc-nom 65 °C	6226	116
	Tc-max 95 °C	5904	111

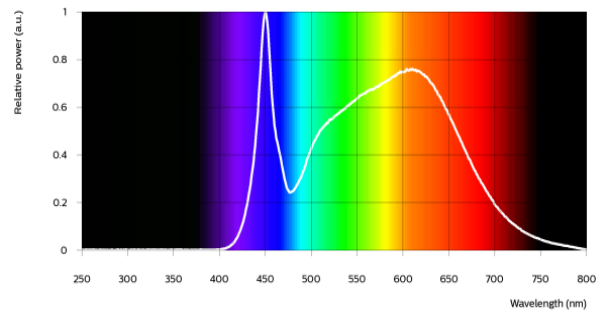



Electrical characteristics

Parameter	Min	Typ	Max	Unit
Forward voltage	32.5	34.5	37.0	V
Power consumption	17.6	18.6	20.0	W = kWh/1000h
Number of modules in series per chain			1	
Number of modules per chain			1	
Number of modules in parallel			1	

Measurement precision for Vf +/- 3%. Measurement precision for power +/- 3.3%

Tuning information

Flux and efficacy versus current (at Tc nominal)

I [mA]	Flux [%]	Efficacy [%]
1380	231	80
960	168	89
540	100	100
432	81	103
270	52	109

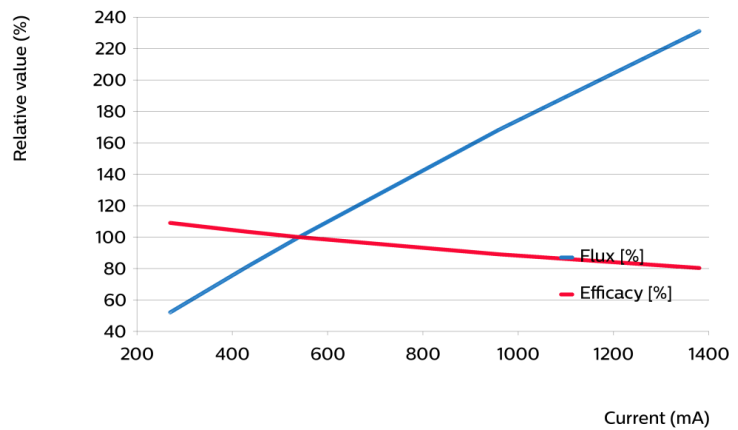

Flux and efficacy versus temperature at Tc (at I nominal)

Tc [°C]	Flux [%]	Efficacy [%]
95	95	96
65	100	100
25	105	103
0	107	104

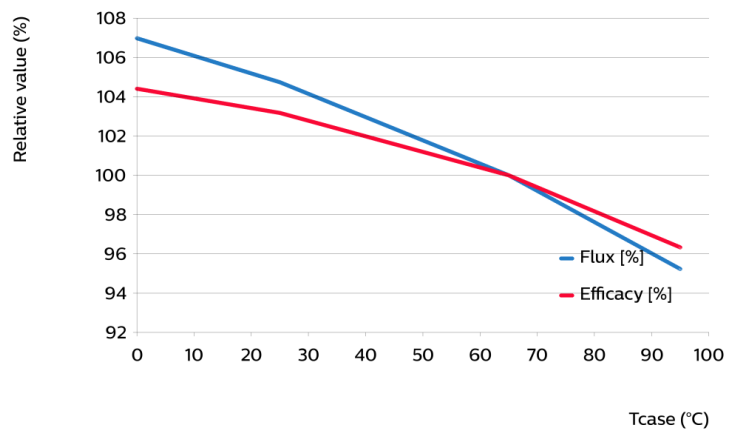

Lumen maintenance

Operation point	Lumen maintenance x 1000 hours	L70			L80			L90		
		B50	B20	B10	B50	B20	B10	B50	B20	B10
80% I-nom 432mA	Tc 50°C	>66	>66	>66	>66	>66	>66	>66	>66	>66
	Tc 65°C	>66	>66	>66	>66	>66	>66	>66	>66	>66
	Tc 95°C	>66	>66	>66	>66	>66	>66	>66	>66	>66
I-nom 540mA	Tc 50°C	>66	>66	>66	>66	>66	>66	>66	>66	>66
	Tc 65°C	>66	>66	>66	>66	>66	>66	>66	>66	>66
	Tc 95°C	>66	>66	>66	>66	>66	>66	>66	>66	62
I-max 1380mA	Tc 50°C	>66	>66	>66	>66	58	53	32	27	25
	Tc 65°C	>66	>66	64	51	43	40	24	20	18
	Tc 95°C	50	42	39	31	26	24	14	12	11

Lifetime

Parameter	Value	Unit
M70F50 nominal	>66000	hours

Performance Window

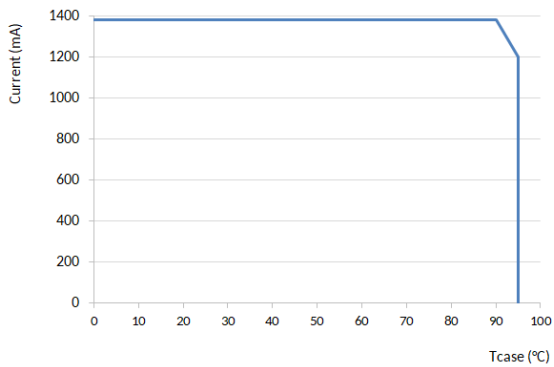

Mechanical characteristics

Parameter	Min	Typ	Max	Unit
Length	18.75	19	19.25	mm
Width	18.75	19	19.25	mm
Height PCB	0.8	0.9	1	mm
Height including dam	1.1	1.4	1.7	mm
Product mass		0.97		gram

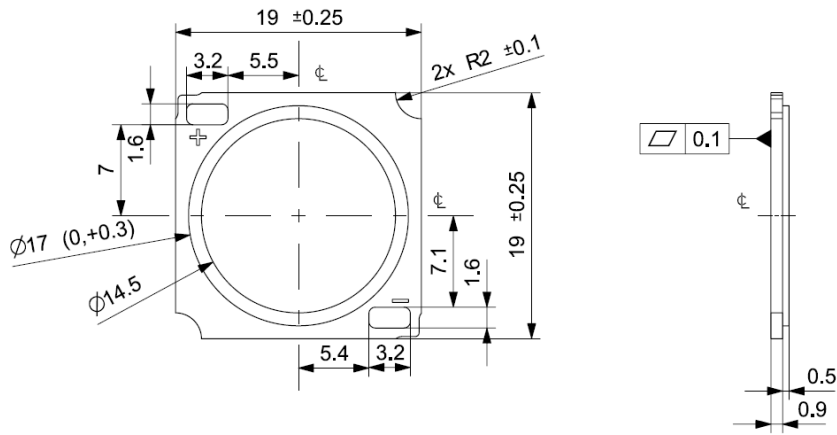

Absolute ratings

Parameter	Min	Max	Unit
Current through the LED module (I-max)		1380	mA
Case temperature (Tc-max)		95	°C
ESD (direct contact)	8		kV
Working voltage		60	V _{dc}
Ambient temperature	-20	40	°C
Storage temperature	-40	80	°C

At illumination levels exceeding 1372 lux risk group classification may be RG2.

Application information

Certificates and Standards

CB
 CE
 ENEC
 IEC/EN 62031
 UKCA
 UL
 UL 8750

Environmental

RoHS/REACH

Application

IP rating	No IP-rating
Overheating protection	No
Luminaire class	IEC Class I and Class II
Dimming	Yes



© 2025 Signify Holding, IBRS 10461, 5600VB, NL. All rights reserved. The information provided herein is subject to change, without notice. Signify does not give any representation or warranty as to the accuracy or completeness of the information included herein and shall not be liable for any action in reliance thereon. The information presented in this document is not intended as any commercial offer and does not form part of any quotation or contract, unless otherwise agreed by Signify.

www.philips.com/oem

Philips and the Philips Shield Emblem are registered trademarks of Koninklijke Philips N.V. All other trademarks are owned by Signify Holding or their respective owners.
UK importer address: Signify Commercial UK Limited, 3 Guildford Business Park, GU2 8XG

11/03/2025