

PHILIPS

Fortimo

LED

Fortimo SLM C 9xx 1205
L15 1919 G8N

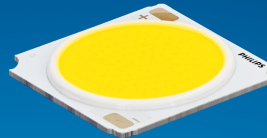

Datasheet

Best offer of performance and value

Fortimo LED SLM CRI90 G8N Standard

The Fortimo SLM family is Signify's core portfolio, now in its latest generation - Gen 8. This new generation boasts improved efficacy compared to the previous one and an expanded portfolio that includes specific spectrums such as Premium White, Premium Color, and standard color for all applications. It maintains the same two footprints as the previous generation, enabling easy upgrades. Together with other Fortimo SLM G8 product lines, our Fortimo SLM G8 will continuously unlock the extraordinary potential of light, facilitate innovation, and inspire the next generation of luminaire design for our OEM customers. Please also visit the online Easy Design-in Tool for your perfect system combination at www.easydesignintool.com.

Key features and benefits

- +5% efficacy further improvement Vs G7
- Best quality of light available for all applications
- More complete portfolio for easy choice
- Same footprint for easy upgrade
- System proposition

March 2025



Ordering data

Commercial product name	EOC	12NC	EPREL registration #	Box quantity
Fortimo SLM C 927 1205 L15 1919 G8N	8721103 080844 00	9290 039 61401	2270358	20
Fortimo SLM C 930 1205 L15 1919 G8N	8721103 080875 00	9290 039 61501	2270364	20
Fortimo SLM C 935 1205 L15 1919 G8N	8721103 080905 00	9290 039 61601	2270362	20
Fortimo SLM C 940 1205 L15 1919 G8N	8721103 080936 00	9290 039 61701	2270372	20
Fortimo SLM C 930 PW 1205 L15 1919 G8N	8721103 080967 00	9290 039 61801	2270360	20
Fortimo SLM C 935 PW 1205 L15 1919 G8N	8721103 080998 00	9290 039 61901	2270366	20
Fortimo SLM C 940 PW 1205 L15 1919 G8N	8721103 081025 00	9290 039 62001	2270374	20

Drive currents

Parameter	Nominal*	Life**	Max***	Unit
Fortimo SLM C 9xx 1205 L15 1919 G8N	450	see performance window	1150	mA

Module temperatures

Parameter	Nominal*	Life**	Max***	Unit
T _c (case temperature at T _c point)	65	see performance window	95	°C

* Nominal value at which typical performance is specified

** Value at which life time is specified

*** Maximum value for safe operation, do not operate above this value

Optical characteristics - table per color (CCT)

Fortimo SLM C 927 1205 L15 1919 G8N

Parameter	Min	Typ	Max	Unit
Luminous flux	1933	2035	2238	lm
Efficacy		131		lm/W
Correlated color temperature (CCT)		2700		K
Color coordinates (CIEx, CIEy)		(0.458, 0.410)		-
Color consistency			3	SDCM
CRI	90			
R9	50			
Photometric code		927/359		
Photobiological safety		RG1 unlimited		

Measurement precision $\pm 5\%$ for the flux data and $\pm 6\%$ for the efficacy data. Measurement precision for color coordinates ± 0.005 . Measurement precision for CRI ± 1.5 .

Operation point	927	lm	lm/W
80% I-nom 360mA	Tc 25 °C	1717	140
	Tc-nom 65 °C	1653	136
	Tc-max 95 °C	1581	132
I-nom 450mA	Tc 25 °C	2115	135
	Tc-nom 65 °C	2035	131
	Tc-max 95 °C	1945	127
I-max 1150mA	Tc 25 °C	4917	108
	Tc-nom 65 °C	4708	105
	Tc-max 95 °C	4473	101

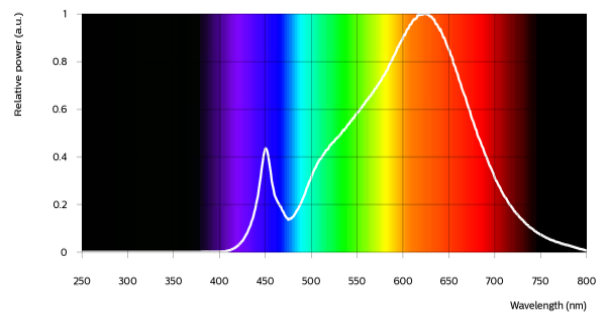

Fortimo SLM C 930 1205 L15 1919 G8N

Parameter	Min	Typ	Max	Unit
Luminous flux	2052	2160	2376	lm
Efficacy		139		lm/W
Correlated color temperature (CCT)		3000		K
Color coordinates (CIEx, CIEy)		(0.434, 0.403)		-
Color consistency			3	SDCM
CRI	90			
R9	50			
Photometric code		930/359		
Photobiological safety		RG1 unlimited		

Measurement precision $\pm 5\%$ for the flux data and $\pm 6\%$ for the efficacy data. Measurement precision for color coordinates ± 0.005 . Measurement precision for CRI ± 1.5 .

Operation point	930	lm	lm/W
80% I-nom 360mA	Tc 25 °C	1822	148
	Tc-nom 65 °C	1755	144
	Tc-max 95 °C	1678	140
I-nom 450mA	Tc 25 °C	2244	143
	Tc-nom 65 °C	2160	139
	Tc-max 95 °C	2065	135
I-max 1150mA	Tc 25 °C	5219	115
	Tc-nom 65 °C	4999	111
	Tc-max 95 °C	4750	107

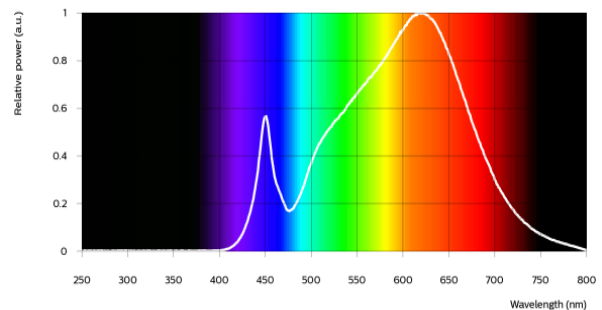

Fortimo SLM C 935 1205 L15 1919 G8N

Parameter	Min	Typ	Max	Unit
Luminous flux	2114	2225	2448	lm
Efficacy		144		lm/W
Correlated color temperature (CCT)		3500		K
Color coordinates (CIEx, CIEy)		(0.408, 0.393)		-
Color consistency			3	SDCM
CRI	90			
R9	50			
Photometric code		935/359		
Photobiological safety		RG1 unlimited		

Measurement precision ± 5% for the flux data and ± 6% for the efficacy data. Measurement precision for color coordinates ± 0.005. Measurement precision for CRI ± 1.5.

Operation point	935	lm	lm/W
80% I-nom 360mA	Tc 25 °C	1877	153
	Tc-nom 65 °C	1808	148
	Tc-max 95 °C	1729	144
I-nom 450mA	Tc 25 °C	2312	147
	Tc-nom 65 °C	2225	144
	Tc-max 95 °C	2127	139
I-max 1150mA	Tc 25 °C	5377	118
	Tc-nom 65 °C	5150	115
	Tc-max 95 °C	4893	110

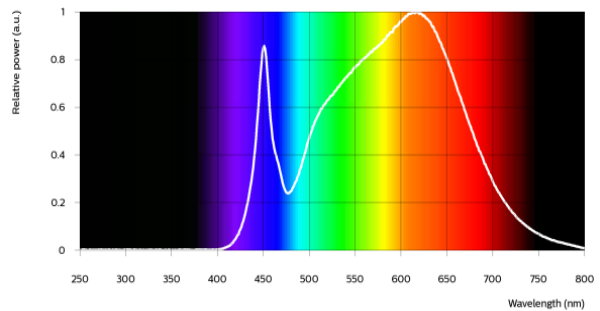

Fortimo SLM C 940 1205 L15 1919 G8N

Parameter	Min	Typ	Max	Unit
Luminous flux	2161	2275	2502	lm
Efficacy		147		lm/W
Correlated color temperature (CCT)		4000		K
Color coordinates (CIEx, CIEy)		(0.382, 0.380)		-
Color consistency			3	SDCM
CRI	90			
R9	50			
Photometric code		940/359		
Photobiological safety		RG1 unlimited		

Measurement precision ± 5% for the flux data and ± 6% for the efficacy data. Measurement precision for color coordinates ± 0.005. Measurement precision for CRI ± 1.5.

Operation point	940	lm	lm/W
80% I-nom 360mA	Tc 25 °C	1919	156
	Tc-nom 65 °C	1848	151
	Tc-max 95 °C	1768	147
I-nom 450mA	Tc 25 °C	2364	151
	Tc-nom 65 °C	2275	147
	Tc-max 95 °C	2175	142
I-max 1150mA	Tc 25 °C	5498	121
	Tc-nom 65 °C	5266	117
	Tc-max 95 °C	5004	112

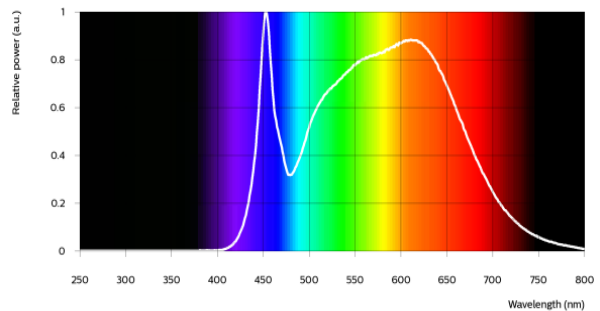

Fortimo SLM C 930 PW 1205 L15 1919 G8N

Parameter	Min	Typ	Max	Unit
Luminous flux	2052	2160	2376	lm
Efficacy		139		lm/W
Correlated color temperature (CCT)		3000		K
Color coordinates (CIEx, CIEy)		(0.422, 0.386)		-
Color consistency			3	SDCM
CRI	90			
R9	50			
Photometric code		930/359		
Photobiological safety		RG1 unlimited		

Measurement precision ± 5% for the flux data and ± 6% for the efficacy data. Measurement precision for color coordinates ± 0.005. Measurement precision for CRI ± 1.5.

Operation point	930	lm	lm/W
80% I-nom 360mA	Tc 25 °C	1822	148
	Tc-nom 65 °C	1755	144
	Tc-max 95 °C	1678	140
I-nom 450mA	Tc 25 °C	2244	143
	Tc-nom 65 °C	2160	139
	Tc-max 95 °C	2065	135
I-max 1150mA	Tc 25 °C	5219	115
	Tc-nom 65 °C	4999	111
	Tc-max 95 °C	4750	107

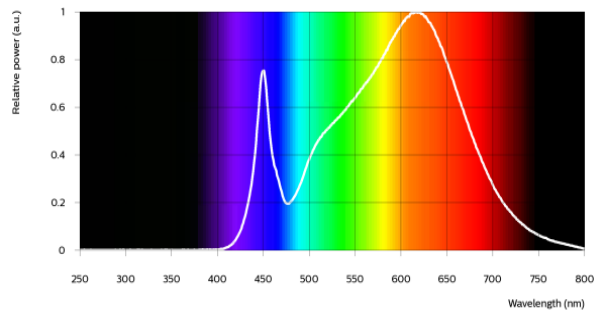

Fortimo SLM C 935 PW 1205 L15 1919 G8N

Parameter	Min	Typ	Max	Unit
Luminous flux	2114	2225	2448	lm
Efficacy		144		lm/W
Correlated color temperature (CCT)		3500		K
Color coordinates (CIEx, CIEy)		(0.398, 0.376)		-
Color consistency			3	SDCM
CRI	90			
R9	50			
Photometric code		935/359		
Photobiological safety		RG1 unlimited		

Measurement precision ± 5% for the flux data and ± 6% for the efficacy data. Measurement precision for color coordinates ± 0.005. Measurement precision for CRI ± 1.5.

Operation point	935	lm	lm/W
80% I-nom 360mA	Tc 25 °C	1877	153
	Tc-nom 65 °C	1808	148
	Tc-max 95 °C	1729	144
I-nom 450mA	Tc 25 °C	2312	147
	Tc-nom 65 °C	2225	144
	Tc-max 95 °C	2127	139
I-max 1150mA	Tc 25 °C	5377	118
	Tc-nom 65 °C	5150	115
	Tc-max 95 °C	4893	110

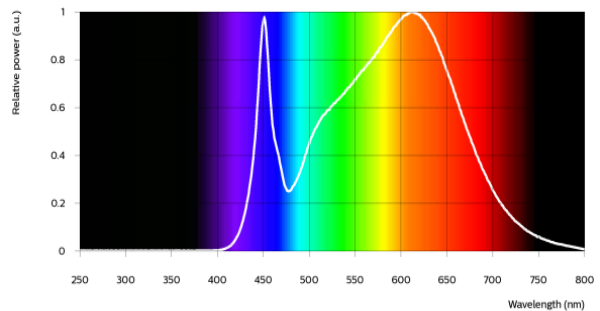

Fortimo SLM C 940 PW 1205 L15 1919 G8N

Parameter	Min	Typ	Max	Unit
Luminous flux	2161	2275	2502	lm
Efficacy		147		lm/W
Correlated color temperature (CCT)		4000		K
Color coordinates (CIEx, CIEy)		(0.374, 0.364)		-
Color consistency			3	SDCM
CRI	90			
R9	50			
Photometric code		940/359		
Photobiological safety		RG1 unlimited		

Measurement precision ± 5% for the flux data and ± 6% for the efficacy data. Measurement precision for color coordinates ± 0.005. Measurement precision for CRI ± 1.5.

Operation point	940	lm	lm/W
80% I-nom 360mA	Tc 25 °C	1919	156
	Tc-nom 65 °C	1848	151
	Tc-max 95 °C	1768	147
I-nom 450mA	Tc 25 °C	2364	151
	Tc-nom 65 °C	2275	147
	Tc-max 95 °C	2175	142
I-max 1150mA	Tc 25 °C	5498	121
	Tc-nom 65 °C	5266	117
	Tc-max 95 °C	5004	112

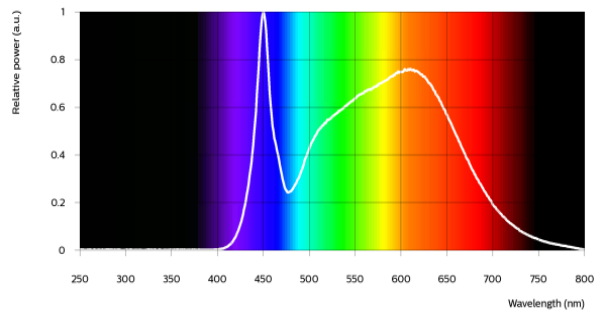



Electrical characteristics

Parameter	Min	Typ	Max	Unit
Forward voltage	32.5	34.5	37.0	V
Power consumption	14.6	15.5	16.7	W = kWh/1000h
Number of modules in series per chain			1	
Number of modules per chain			1	
Number of modules in parallel			1	

Measurement precision for Vf +/- 3%. Measurement precision for power +/- 3.3%

Tuning information

Flux and efficacy versus current (at Tc nominal)

I [mA]	Flux [%]	Efficacy [%]
1150	231	80
800	169	89
450	100	100
360	81	103
225	52	109

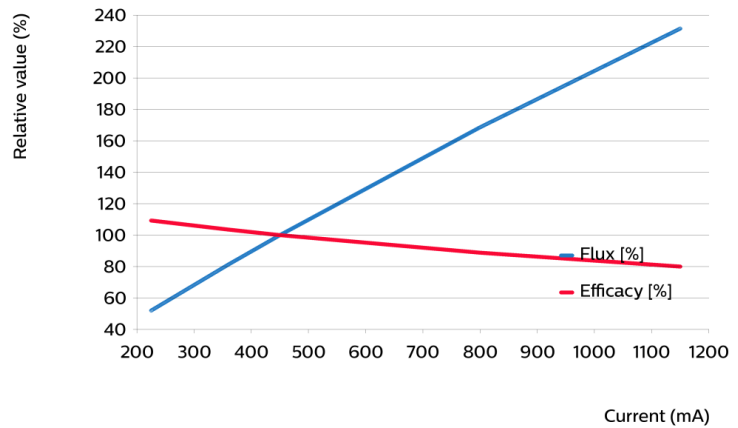

Flux and efficacy versus temperature at Tc (at I nominal)

Tc [°C]	Flux [%]	Efficacy [%]
95	96	97
65	100	100
25	104	102
0	106	103

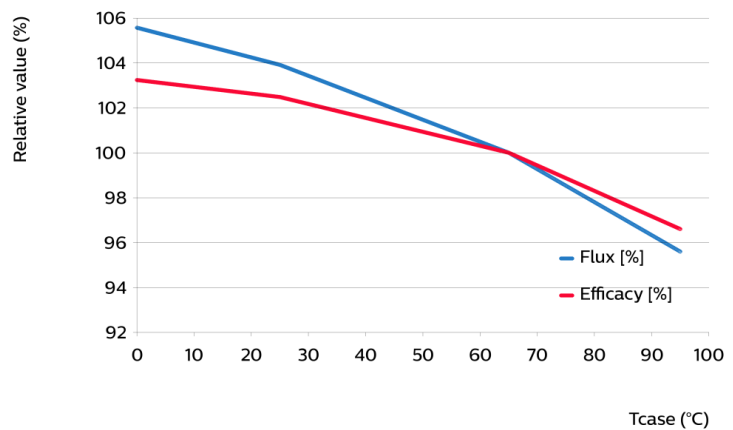

Lumen maintenance

Operation point	Lumen maintenance x 1000 hours	L70			L80			L90		
		B50	B20	B10	B50	B20	B10	B50	B20	B10
80% I-nom 360mA	Tc 50°C	>66	>66	>66	>66	>66	>66	>66	>66	>66
	Tc 65°C	>66	>66	>66	>66	>66	>66	>66	>66	>66
	Tc 95°C	>66	>66	>66	>66	>66	>66	>66	>66	>66
I-nom 450mA	Tc 50°C	>66	>66	>66	>66	>66	>66	>66	>66	>66
	Tc 65°C	>66	>66	>66	>66	>66	>66	>66	>66	>66
	Tc 95°C	>66	>66	>66	>66	>66	>66	>66	>66	62
I-max 1150mA	Tc 50°C	>66	>66	>66	>66	58	53	32	27	25
	Tc 65°C	>66	>66	64	51	43	40	24	20	18
	Tc 95°C	50	42	39	31	26	24	14	12	11

Lifetime

Parameter	Value	Unit
M70F50 nominal	>66000	hours

Performance Window

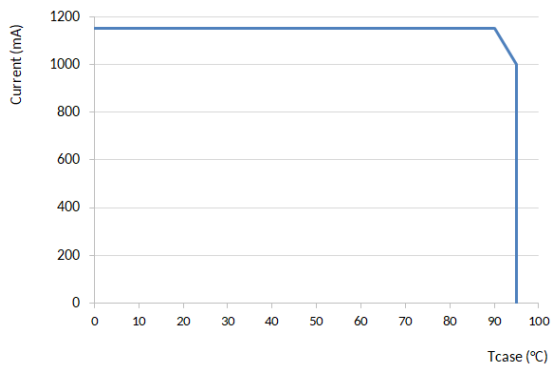

Mechanical characteristics

Parameter	Min	Typ	Max	Unit
Length	18.75	19	19.25	mm
Width	18.75	19	19.25	mm
Height PCB	0.8	0.9	1	mm
Height including dam	1.1	1.4	1.7	mm
Product mass		0.97		gram

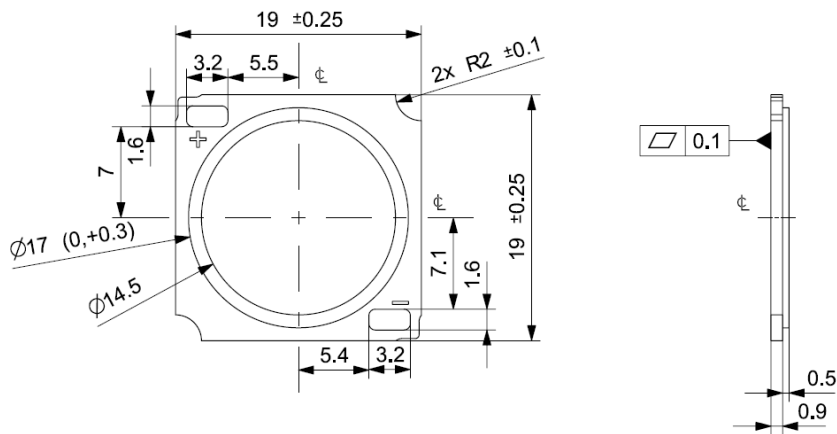

Absolute ratings

Parameter	Min	Max	Unit
Current through the LED module (I-max)		1150	mA
Case temperature (Tc-max)		95	°C
ESD (direct contact)	8		kV
Working voltage		60	V _{dc}
Ambient temperature	-20	40	°C
Storage temperature	-40	80	°C

At illumination levels exceeding 1372 lux risk group classification may be RG2.

Application information

Certificates and Standards

CB
CE
ENEC
IEC/EN 62031
UKCA
UL
UL 8750

Environmental

RoHS/REACH

Application

IP rating	No IP-rating
Overheating protection	No
Luminaire class	IEC Class I and Class II
Dimming	Yes



© 2025 Signify Holding, IBRS 10461, 5600VB, NL. All rights reserved. The information provided herein is subject to change, without notice. Signify does not give any representation or warranty as to the accuracy or completeness of the information included herein and shall not be liable for any action in reliance thereon. The information presented in this document is not intended as any commercial offer and does not form part of any quotation or contract, unless otherwise agreed by Signify.

www.philips.com/oem

Philips and the Philips Shield Emblem are registered trademarks of Koninklijke Philips N.V. All other trademarks are owned by Signify Holding or their respective owners.
UK importer address: Signify Commercial UK Limited, 3 Guildford Business Park, GU2 8XG

10/03/2025