

**PHILIPS**

**Fortimo**

**LED**

Fortimo SLM C 9xx 1203  
L09 1619 G8

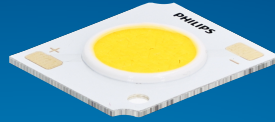

Datasheet

# Best offer of performance and value

## Fortimo LED SLM CRI90 G8 Standard

The Fortimo SLM family is Signify's core portfolio, now in its latest generation - Gen 8. This new generation boasts improved efficacy compared to the previous one and an expanded portfolio that includes specific spectrums such as Premium White, Premium Color, and standard color for all applications. It maintains the same two footprints as the previous generation, enabling easy upgrades. Together with other Fortimo SLM G8 product lines, our Fortimo SLM G8 will continuously unlock the extraordinary potential of light, facilitate innovation, and inspire the next generation of luminaire design for our OEM customers. Please also visit the online Easy Design-in Tool for your perfect system combination at [www.easydesignintool.com](http://www.easydesignintool.com).

### Key features and benefits

- +5% efficacy further improvement Vs G7
- Best quality of light available for all applications
- More complete portfolio for easy choice
- Same footprint for easy upgrade
- System proposition

March 2025



## Ordering data

Commercial product name	EOC	12NC	EPREL registration #	Box quantity
Fortimo SLM C 927 1203 L09 1619 G8	8721103 074447 00	9290 039 40201	2270260	20
Fortimo SLM C 930 1203 L09 1619 G8	8721103 074478 00	9290 039 40301	2270239	20
Fortimo SLM C 935 1203 L09 1619 G8	8721103 074508 00	9290 039 40401	2270209	20
Fortimo SLM C 940 1203 L09 1619 G8	8721103 074539 00	9290 039 40501	2270247	20
Fortimo SLM C 930 PW 1203 L09 1619 G8	8721103 074560 00	9290 039 40601	2270259	20
Fortimo SLM C 935 PW 1203 L09 1619 G8	8721103 074591 00	9290 039 40701	2270227	20
Fortimo SLM C 940 PW 1203 L09 1619 G8	8721103 074621 00	9290 039 40801	2270213	20
Fortimo SLM C 930 PC 1203 L09 1619 G8	8721103 074652 00	9290 039 40901	2270212	20

## Drive currents

Parameter	Nominal*	Life**	Max***	Unit
Fortimo SLM C 9xx 1203 L09 1619 G8	300	see performance window	690	mA

## Module temperatures

Parameter	Nominal*	Life**	Max***	Unit
T <sub>c</sub> (case temperature at T <sub>c</sub> point)	65	see performance window	95	°C

\* Nominal value at which typical performance is specified

\*\* Value at which life time is specified

\*\*\* Maximum value for safe operation, do not operate above this value

## Optical characteristics - table per color (CCT)

### Fortimo SLM C 927 1203 L09 1619 G8

Parameter	Min	Typ	Max	Unit
Luminous flux	1249	1315	1446	lm
Efficacy		126		lm/W
Correlated color temperature (CCT)		2700		K
Color coordinates (CIEx, CIEy)		(0.458, 0.410)		-
Color consistency			3	SDCM
CRI	90			
R9	>50			
Photometric code		927/359		
Photobiological safety		RG1 unlimited		

Measurement precision  $\pm 5\%$  for the flux data and  $\pm 6\%$  for the efficacy data. Measurement precision for color coordinates  $\pm 0.005$ . Measurement precision for CRI  $\pm 1.5$ .

Operation point	927	lm	lm/W
80% I-nom 240mA	Tc 25 °C	1120	135
	Tc-nom 65 °C	1070	131
	Tc-max 95 °C	1023	126
I-nom 300mA	Tc 25 °C	1377	131
	Tc-nom 65 °C	1315	126
	Tc-max 95 °C	1256	122
I-max 690mA	Tc 25 °C	2893	108
	Tc-nom 65 °C	2750	103
	Tc-max 95 °C	2614	99

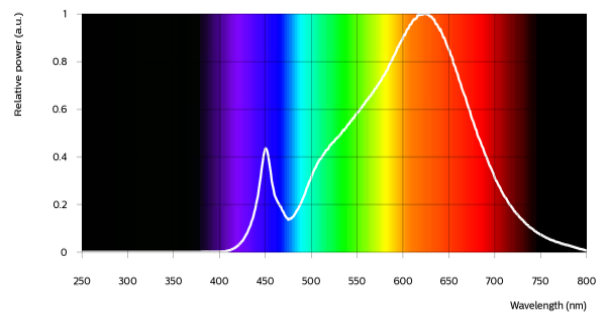

### Fortimo SLM C 930 1203 L09 1619 G8

Parameter	Min	Typ	Max	Unit
Luminous flux	1330	1400	1540	lm
Efficacy		135		lm/W
Correlated color temperature (CCT)		3000		K
Color coordinates (CIEx, CIEy)		(0.434, 0.403)		-
Color consistency			3	SDCM
CRI	90			
R9	>50			
Photometric code		930/359		
Photobiological safety		RG1 unlimited		

Measurement precision  $\pm 5\%$  for the flux data and  $\pm 6\%$  for the efficacy data. Measurement precision for color coordinates  $\pm 0.005$ . Measurement precision for CRI  $\pm 1.5$ .

Operation point	930	lm	lm/W
80% I-nom 240mA	Tc 25 °C	1192	144
	Tc-nom 65 °C	1139	139
	Tc-max 95 °C	1089	134
I-nom 300mA	Tc 25 °C	1466	140
	Tc-nom 65 °C	1400	135
	Tc-max 95 °C	1337	130
I-max 690mA	Tc 25 °C	3080	115
	Tc-nom 65 °C	2929	110
	Tc-max 95 °C	2784	105

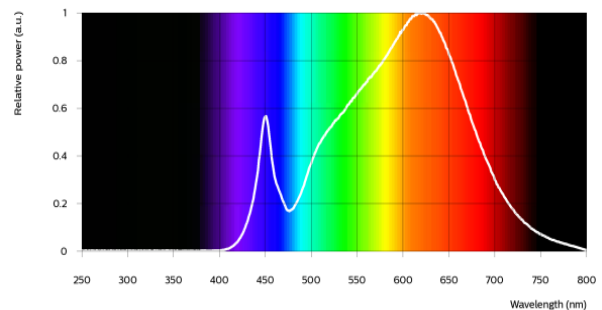

Fortimo SLM C 935 1203 L09 1619 G8

Parameter	Min	Typ	Max	Unit
Luminous flux	1368	1440	1584	lm
Efficacy		138		lm/W
Correlated color temperature (CCT)		3500		K
Color coordinates (CIEx, CIEy)		(0.407, 0.392)		-
Color consistency			3	SDCM
CRI	90			
R9	>50			
Photometric code		935/359		
Photobiological safety		RG1 unlimited		

Measurement precision ± 5% for the flux data and ± 6% for the efficacy data. Measurement precision for color coordinates ± 0.005. Measurement precision for CRI ± 1.5.

Operation point	935	lm	lm/W
80% I-nom 240mA	Tc 25 °C	1226	148
	Tc-nom 65 °C	1172	143
	Tc-max 95 °C	1120	138
I-nom 300mA	Tc 25 °C	1507	144
	Tc-nom 65 °C	1440	138
	Tc-max 95 °C	1375	134
I-max 690mA	Tc 25 °C	3168	118
	Tc-nom 65 °C	3013	113
	Tc-max 95 °C	2864	108

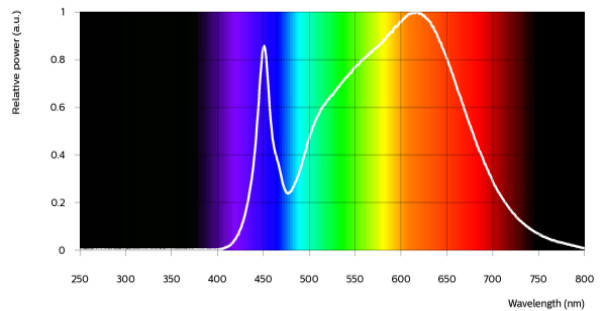

Fortimo SLM C 940 1203 L09 1619 G8

Parameter	Min	Typ	Max	Unit
Luminous flux	1401	1475	1622	lm
Efficacy		142		lm/W
Correlated color temperature (CCT)		4000		K
Color coordinates (CIEx, CIEy)		(0.382, 0.380)		-
Color consistency			3	SDCM
CRI	90			
R9	>50			
Photometric code		940/359		
Photobiological safety		RG1 unlimited		

Measurement precision ± 5% for the flux data and ± 6% for the efficacy data. Measurement precision for color coordinates ± 0.005. Measurement precision for CRI ± 1.5.

Operation point	940	lm	lm/W
80% I-nom 240mA	Tc 25 °C	1256	151
	Tc-nom 65 °C	1200	146
	Tc-max 95 °C	1147	142
I-nom 300mA	Tc 25 °C	1544	147
	Tc-nom 65 °C	1475	142
	Tc-max 95 °C	1409	137
I-max 690mA	Tc 25 °C	3246	121
	Tc-nom 65 °C	3087	116
	Tc-max 95 °C	2934	111

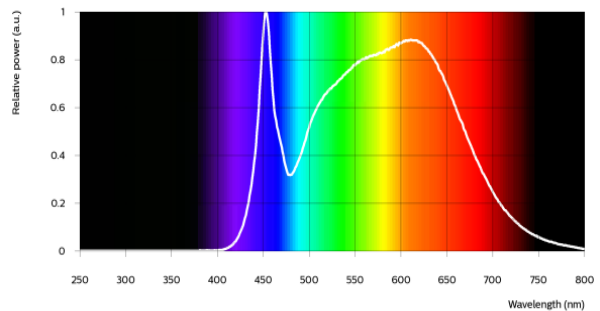

Fortimo SLM C 930 PW 1203 L09 1619 G8

Parameter	Min	Typ	Max	Unit
Luminous flux	1330	1400	1540	lm
Efficacy		135		lm/W
Correlated color temperature (CCT)		3000		K
Color coordinates (CIEx, CIEy)		(0.422, 0.386)		-
Color consistency			3	SDCM
CRI	90			
R9	>50			
Photometric code		930/359		
Photobiological safety		RG1 unlimited		

Measurement precision ± 5% for the flux data and ± 6% for the efficacy data. Measurement precision for color coordinates ± 0.005. Measurement precision for CRI ± 1.5.

Operation point	930	lm	lm/W
80% I-nom 240mA	Tc 25 °C	1192	144
	Tc-nom 65 °C	1139	139
	Tc-max 95 °C	1089	134
I-nom 300mA	Tc 25 °C	1466	140
	Tc-nom 65 °C	1400	135
	Tc-max 95 °C	1337	130
I-max 690mA	Tc 25 °C	3080	115
	Tc-nom 65 °C	2929	110
	Tc-max 95 °C	2784	105

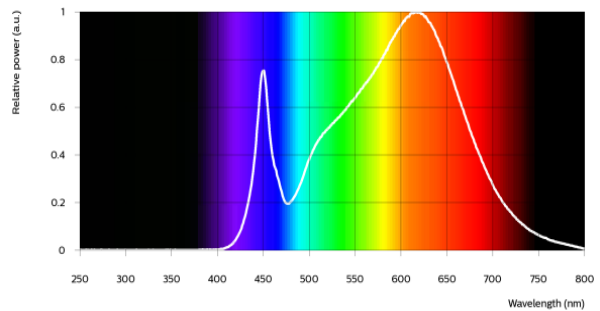

Fortimo SLM C 935 PW 1203 L09 1619 G8

Parameter	Min	Typ	Max	Unit
Luminous flux	1368	1440	1584	lm
Efficacy		138		lm/W
Correlated color temperature (CCT)		3500		K
Color coordinates (CIEx, CIEy)		(0.398, 0.376)		-
Color consistency			3	SDCM
CRI	90			
R9	>50			
Photometric code		935/359		
Photobiological safety		RG1 unlimited		

Measurement precision ± 5% for the flux data and ± 6% for the efficacy data. Measurement precision for color coordinates ± 0.005. Measurement precision for CRI ± 1.5.

Operation point	935	lm	lm/W
80% I-nom 240mA	Tc 25 °C	1226	148
	Tc-nom 65 °C	1172	143
	Tc-max 95 °C	1120	138
I-nom 300mA	Tc 25 °C	1507	144
	Tc-nom 65 °C	1440	138
	Tc-max 95 °C	1375	134
I-max 690mA	Tc 25 °C	3168	118
	Tc-nom 65 °C	3013	113
	Tc-max 95 °C	2864	108

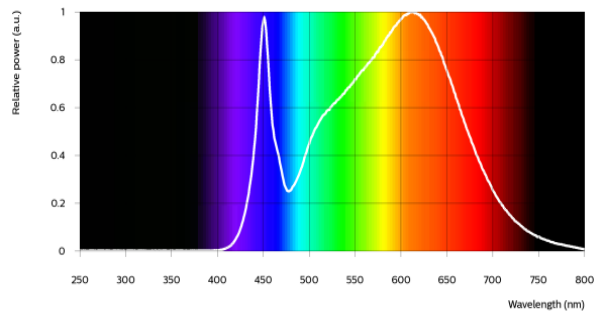

Fortimo SLM C 940 PW 1203 L09 1619 G8

Parameter	Min	Typ	Max	Unit
Luminous flux	1401	1475	1622	lm
Efficacy		142		lm/W
Correlated color temperature (CCT)		4000		K
Color coordinates (CIEx, CIEy)		(0.374, 0.364)		-
Color consistency			3	SDCM
CRI	90			
R9	>50			
Photometric code		940/359		
Photobiological safety		RG1 unlimited		

Measurement precision ± 5% for the flux data and ± 6% for the efficacy data. Measurement precision for color coordinates ± 0.005. Measurement precision for CRI ± 1.5.

Operation point	940	lm	lm/W
80% I-nom 240mA	Tc 25 °C	1256	151
	Tc-nom 65 °C	1200	146
	Tc-max 95 °C	1147	142
I-nom 300mA	Tc 25 °C	1544	147
	Tc-nom 65 °C	1475	142
	Tc-max 95 °C	1409	137
I-max 690mA	Tc 25 °C	3246	121
	Tc-nom 65 °C	3087	116
	Tc-max 95 °C	2934	111

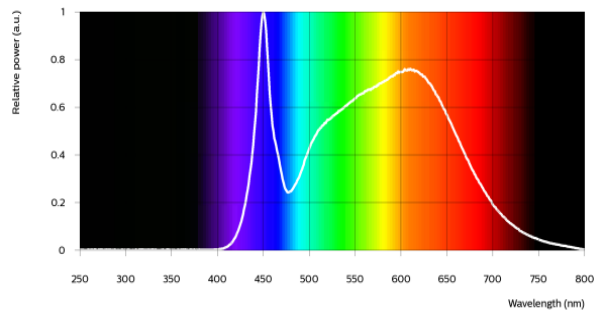

Fortimo SLM C 930 PC 1203 L09 1619 G8

Parameter	Min	Typ	Max	Unit
Luminous flux	1249	1315	1446	lm
Efficacy		126		lm/W
Correlated color temperature (CCT)		3000		K
Color coordinates (CIEx, CIEy)		(0.422, 0.386)		-
Color consistency			3	SDCM
CRI	90			
R9	>70			
Photometric code		930/359		
Photobiological safety		RG1 unlimited		

Measurement precision ± 5% for the flux data and ± 6% for the efficacy data. Measurement precision for color coordinates ± 0.005. Measurement precision for CRI ± 1.5.

Operation point	930	lm	lm/W
80% I-nom 240mA	Tc 25 °C	1120	135
	Tc-nom 65 °C	1070	131
	Tc-max 95 °C	1023	126
I-nom 300mA	Tc 25 °C	1377	131
	Tc-nom 65 °C	1315	126
	Tc-max 95 °C	1256	122
I-max 690mA	Tc 25 °C	2893	108
	Tc-nom 65 °C	2750	103
	Tc-max 95 °C	2614	99

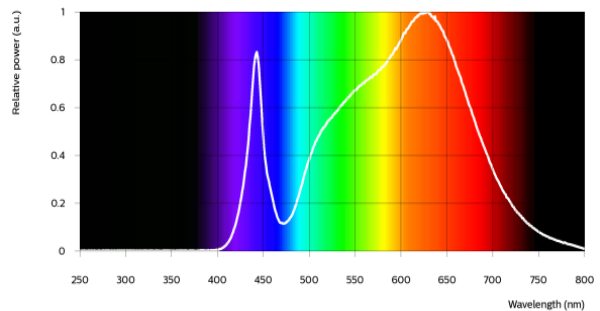



## Electrical characteristics

Parameter	Min	Typ	Max	Unit
Forward voltage	32.5	34.7	37.0	V
Power consumption	9.8	10.4	11.1	W = kWh/1000h
Number of modules in series per chain			1	
Number of modules per chain			1	
Number of modules in parallel			1	

Measurement precision for Vf +/- 3%. Measurement precision for power +/- 3.3%

## Tuning information

Flux and efficacy versus current (at Tc nominal)

I [mA]	Flux [%]	Efficacy [%]
690	209	82
495	157	90
300	100	100
240	81	104
150	52	110

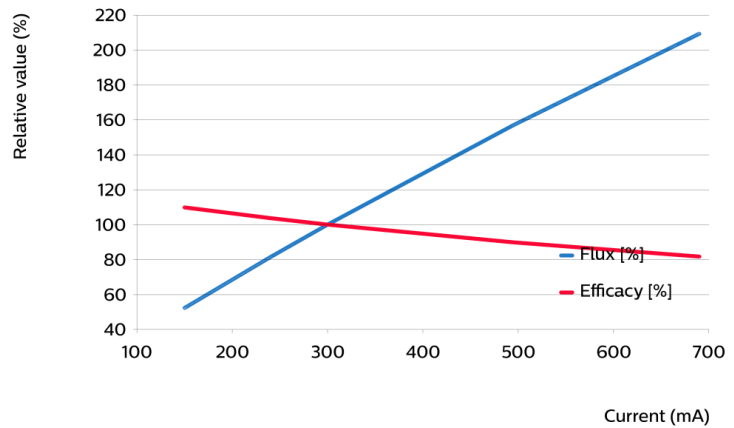

Flux and efficacy versus temperature at Tc (at I nominal)

Tc [°C]	Flux [%]	Efficacy [%]
95	96	96
65	100	100
25	105	103
0	107	105

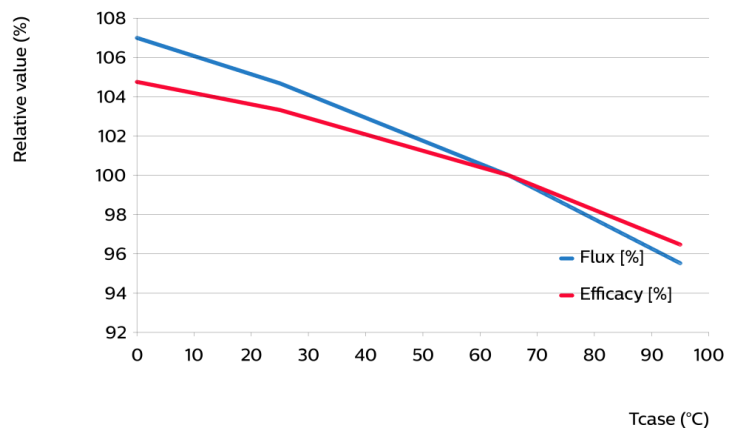

## Lumen maintenance

Operation point	Lumen maintenance x 1000 hours	L70			L80			L90		
		B50	B20	B10	B50	B20	B10	B50	B20	B10
80% I-nom 240mA	Tc 50°C	>66	>66	>66	>66	>66	>66	>66	>66	>66
	Tc 65°C	>66	>66	>66	>66	>66	>66	>66	>66	>66
	Tc 95°C	>66	>66	>66	>66	>66	>66	>66	>66	>66
I-nom 300mA	Tc 50°C	>66	>66	>66	>66	>66	>66	>66	>66	>66
	Tc 65°C	>66	>66	>66	>66	>66	>66	>66	>66	>66
	Tc 95°C	>66	>66	>66	>66	>66	>66	>66	56	51
I-max 690mA	Tc 50°C	>66	>66	>66	>66	58	53	32	27	25
	Tc 65°C	>66	>66	64	51	43	40	24	20	18
	Tc 95°C	50	42	39	31	26	24	14	12	11

## Lifetime

Parameter	Value	Unit
M70F50 nominal	>66000	hours

## Performance Window

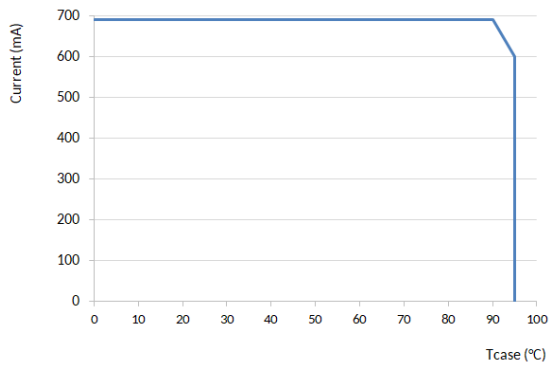

## Mechanical characteristics

Parameter	Min	Typ	Max	Unit
Length	18.8	19	19.2	mm
Width	15.8	16	16.2	mm
Height PCB	0.9	1	1.1	mm
Height including dam	1.2	1.5	1.8	mm
Product mass		0.8		gram

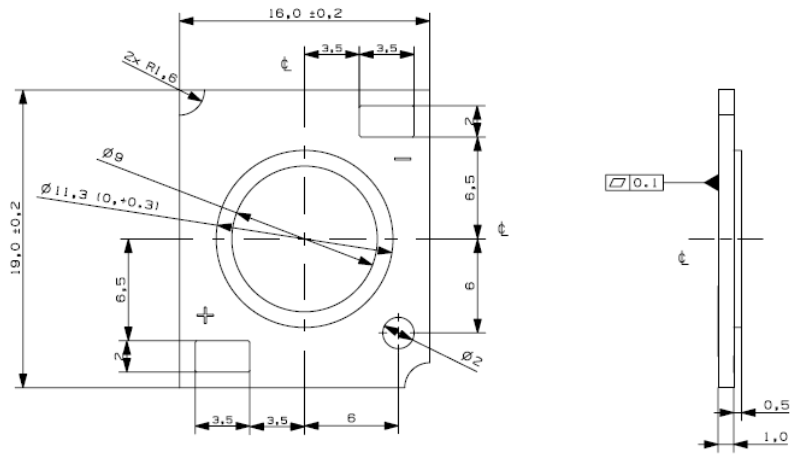

## Absolute ratings

Parameter	Min	Max	Unit
Current through the LED module (I-max)		690	mA
Case temperature (Tc-max)		95	°C
ESD (direct contact)	8		kV
Working voltage		60	V <sub>dc</sub>
Ambient temperature	-20	40	°C
Storage temperature	-40	80	°C

At illumination levels exceeding 1372 lux risk group classification may be RG2.

## Application information

### Certificates and Standards

CB  
CE  
ENEC  
IEC 62031  
UKCA  
UL  
UL 8750

### Environmental

RoHS/REACH

### Application

IP rating	No IP-rating
Overheating protection	No
Luminaire class	IEC Class I and Class II
Dimming	Yes



© 2025 Signify Holding, IBRS 10461, 5600VB, NL. All rights reserved. The information provided herein is subject to change, without notice. Signify does not give any representation or warranty as to the accuracy or completeness of the information included herein and shall not be liable for any action in reliance thereon. The information presented in this document is not intended as any commercial offer and does not form part of any quotation or contract, unless otherwise agreed by Signify.

[www.philips.com/oem](http://www.philips.com/oem)

Philips and the Philips Shield Emblem are registered trademarks of Koninklijke Philips N.V. All other trademarks are owned by Signify Holding or their respective owners.  
UK importer address: Signify Commercial UK Limited, 3 Guildford Business Park, GU2 8XG

05/03/2025