

# EMI20C Twin-head IP65

## Mounting instruction

Indoor Use Only

IEC 60598-2-22

IP65

RoHS

Type Des.	Input Power	Emergency Power	Lumen	Battery	Function	Voltage	Frequency	Class	
EMI20C Twin-head LED5/865 IP65	3W	4.5W	500lm	LiFePO <sub>4</sub> 6.4V 3.3Ah	Manual test switchable	220-240V~	50/60Hz	II	1.10
EMI20C Twin-head LED6/865 IP65	3W	4.5W	650lm						1.10
EMI20C Twin-head LED10/865 IP65	4.5W	9W	1000lm	LiFePO <sub>4</sub> 6.4V 6.6Ah					1.27
EMI20C Twin-head LED13/865 IP65	4.5W	9W	1300lm						1.27

1

2

Torque values 2~2.5NM

Drill hole Ø6mmx4

3

4

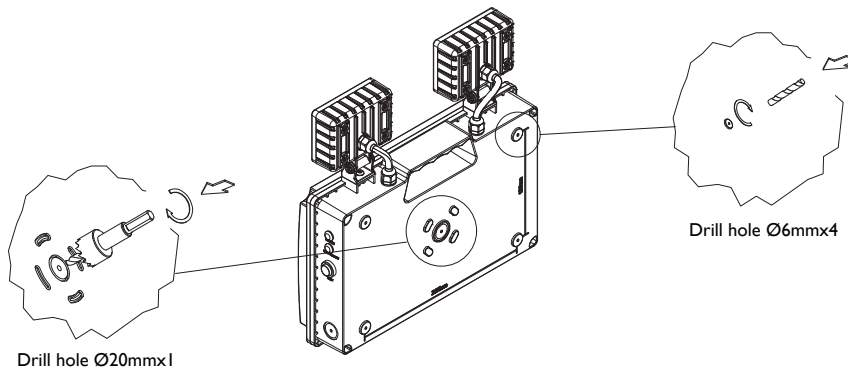

5

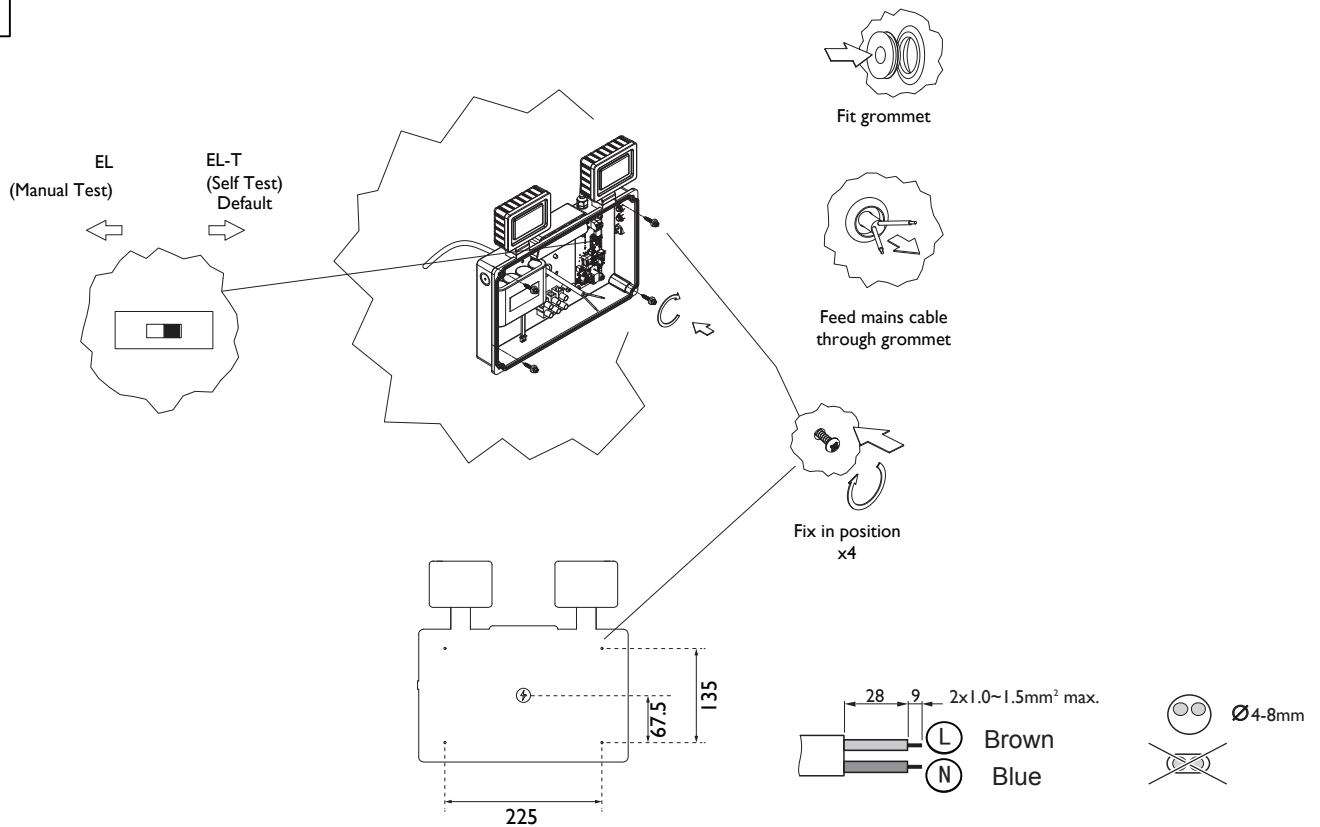

6

Note: If use side entry, drill Ø20mm hole and apply PG13.5 cable gland

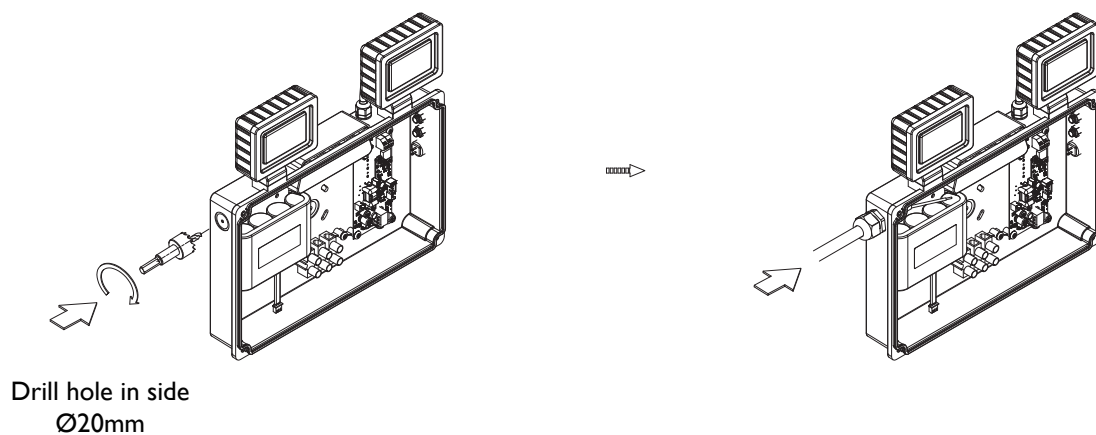

7

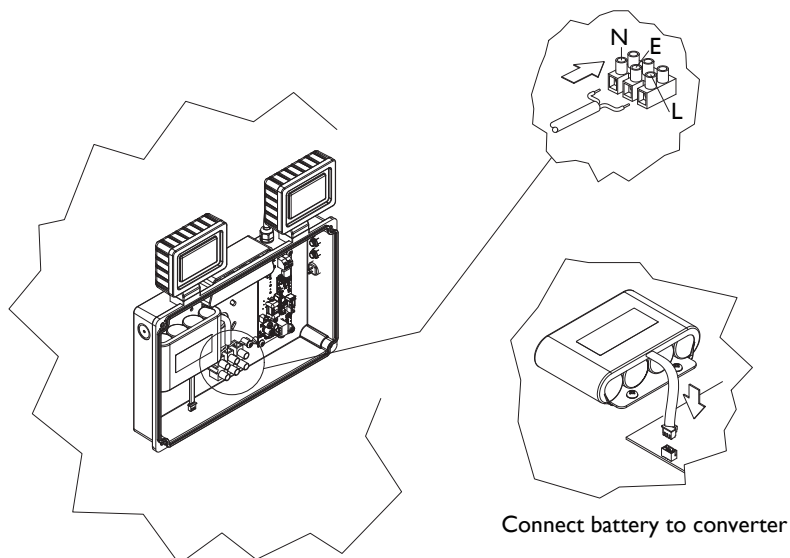

Connect battery to converter

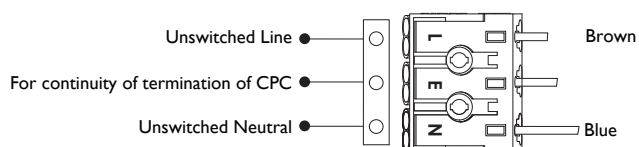

8

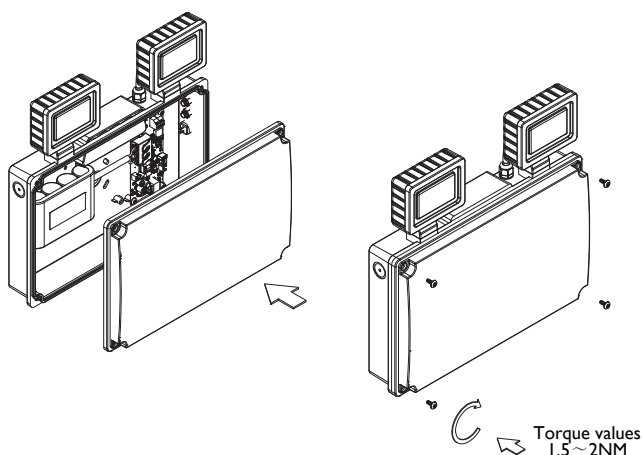

9

SWITCH ON THE MAINS SUPPLY  
AFTER INSTALLATION OR  
SERVICING

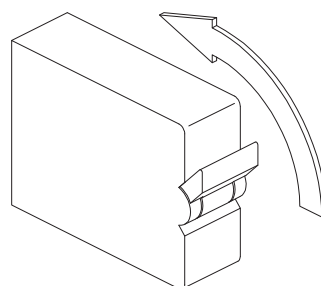

### Indicator

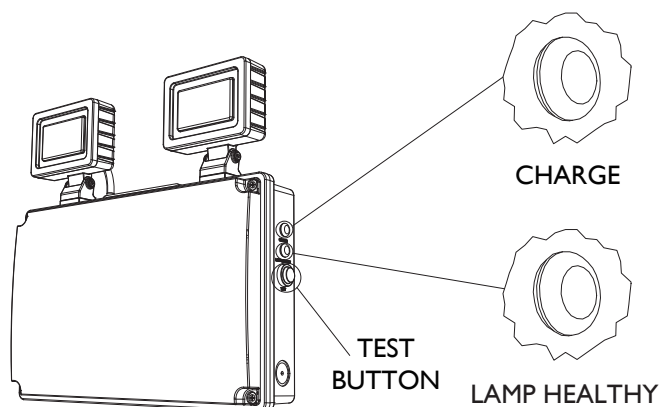

### Charge indicator:

Refer to self test program for different status

### Lamp healthy indicator:

Indicate light source connection (green light on for normal connection; light off for abnormal connection)

Type Des.	Run Current(A) @220V	Start (Inrush) Current(A) / I <sub>peak</sub> (A)	Start Current Duration (μs) / T(@50% of I <sub>peak</sub> ) (μs)	Touch current or protective conductor current (mA)	MCB Type B 16A Max no. fitting (pcs)	MCB Type C 16A Max no. fitting (pcs)
EM120C Twin-head LED5/865 IP65	0.04	6.72	12	0.7	200	280
EM120C Twin-head LED6/865 IP65	0.04	6.72	12	0.7	200	280
EM120C Twin-head LED10/865 IP65	0.05	6.48	12.8	0.7	210	220
EM120C Twin-head LED13/865 IP65	0.05	6.48	12.8	0.7	210	220

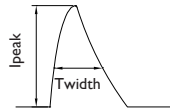

- For indoor use only.  
The luminaire is complied to IEC 60598-1 IEC 60598-2-22.
- The luminaire must be installed by a qualified electrician and wired in accordance with the latest IEE Electrical regulations or the national requirements.
- Turn off the power supply before checking, installation, maintenance or moving.
- Do not switch on before complete installation.
- The light source and/or controller contained in this luminaire shall only be replaced by the manufacturer or his service agent or a similar qualified person.
- Batteries shall only be replaced by the manufacturer or his service agent or a similar qualified person.
- Batteries should be replaced when the luminaire no longer meets the 3 hours duration performance.



Please inform yourself about the local waste disposal, separation and collection system for electrical and electronic products and packaging. Please act according to your local rules and do not dispose your old product and packaging with your normal household waste. The correct disposal of the packaging, your product and/or batteries will help prevent potential negative consequences for the environment and human health. Batteries should be disposed separately from the municipal waste stream via designated collection facilities. When disposing a product that contains non-user replaceable batteries, the non-user replaceable batteries shall be removed by a professional.

### Testing Record

Product: \_\_\_\_\_ Location: \_\_\_\_\_ Installation Date: \_\_\_\_\_

Month	Functional/Duration	Year 1	Year 2	Year 3	Year 4	Year 5
1						
2						
3						
4						
5						
6						
7						
8						
9						
10						
11						
12						

# EMI20C Twin-head IP65

## Specifications For Self Test

EMI20C









### Function Test

The function test is carried out every week for 5 seconds. It will check the connection of battery, battery discharging and the connection of LED module.

### Duration Test

An initial duration test is automatically carried out at first power on, but after 24 hours charging. After that, the duration test is carried out for 3 hours every half year, on one day within the 175th day to the 195th day. It will also check the connection of battery and LED module.

### Description corresponding to the color and status of the charge indicator

Charge Indicator Color	Status	On Time (Seconds)	Off Time (Seconds)	Description
Green	 Permanent on	/	/	Normal status when mains connected
	 Slow flash	1s	1s	Duration test running
	 Fast flash	0.2s	0.2s	Function test running
	 Normal flash three times only	0.5s	0.5s	Time reset
Red	 Permanent on	/	/	Battery connection is abnormal or failure
	 Slow flash	1s	1s	Lamp connection is abnormal or failure
	 Fast flash	0.2s	0.2s	Duration failure - the capacity of the battery is decay
Both Off	 Off	/	/	Emergency mode

**It should be taken to check connectivity or replace the abnormal battery or lamp**

### Test button for manual inspection on function test or duration test

#### Mode of operation

Mode	Description
Press for <2s	Simulate emergency mode.
Press for 3-5s	Start duration test manually. The test can be aborted by pressing off (1-2s). * Must be conducted when the initial duration test finished and after another 24 hours battery charging.
Press for 5-8s	Start Function test manually for 60s. The test can be aborted by pressing off (1-2s).
Press for >10s	Time Reset.

### Note:

1. When the mains is on, the green indicator will be permanent on. It will check the connection of battery and the connection of LED module. When the mains is off, no test will perform.
2. When there is a lamp failure at non-maintained mode, the indicator remains green but will turn red and be slow flashing after the failure is detected in a weekly function test.
3. The luminaries on which we want to perform the duration tests must be connected to the mains supply for at least 24 uninterrupted hours.
4. When the fault is corrected, the indicator will only be reset to its normal status after mains reconnected or test switch pressed.
5. An accuracy of the timing of the test interval is ensured that it has an accuracy of  $\pm 75$  s per week. The timing function will be retained through periods of mains supply failure or interruption for up to 7 days.
6. The battery charge does not start if the cell temperature is below 0°C or above 65°C.

# EMI20C Twin-head IP65

## Storage

EM120C

1. The battery should be preserved in a clean and dry environment to ensure battery performance.

2. Do not exceed the storage temperature and time as defined below.

-20°C to 35°C, >3months and the battery should be recharged every 9 months\*.

-20°C to 40°C, 1-3months and the battery should be recharged every 3 months.

-20°C to 50°C, <1month and the battery should be recharged every 1 month.

\*The battery should be charged in ex-work condition (as per required law of dangerous goods or UN38.3).