

# PHILIPS

## CoreLine Panel RC132V IP65

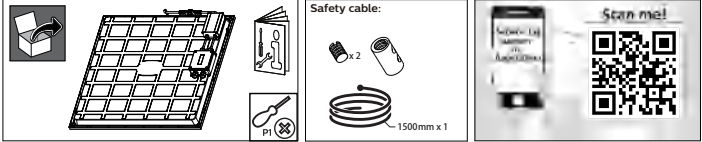

Lifetime up to 100Khrs @L80
 Ta 25 °C
 Max. 35°C Min. -10°C

	IP	IK	L×W×H1(mm)	
RC132V G6 36S/840 PSU W60L60 NOC IP65_20	IP65/IP20	IK03	595x595x39	2.44
RC132V G6 50S/940 PSU W60L60 NOC IP65	IP65	IK03	595x595x39	2.90
RC132V G6 48S/940 PSU W60L60 OC IP65	IP65	IK03	595x595x39	2.90
RC132V G6 48S/940 PSD W60L60 OC IP65	IP65	IK03	595x595x39	2.90

Lifetime Table	Lumen	CRI	50K hrs	100K hrs
	3600lm	80	L90	L80
	>4300lm	80/90	L85	L75

Energy efficiency class of light source	
840	940
C	D



Available as accessory (Need to purchase separately)

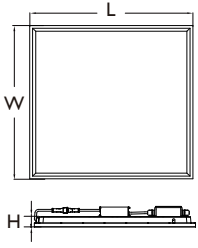
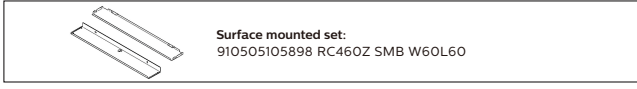

### Power Connection

#### IP65

60227 IEC52  
 2 x 0.75-1.5 mm<sup>2</sup>  
 Ø6-8mm

basic insulation between LV and control conductors

1

Remove the film

2

stick the driver

#### PSD Touch & Dim

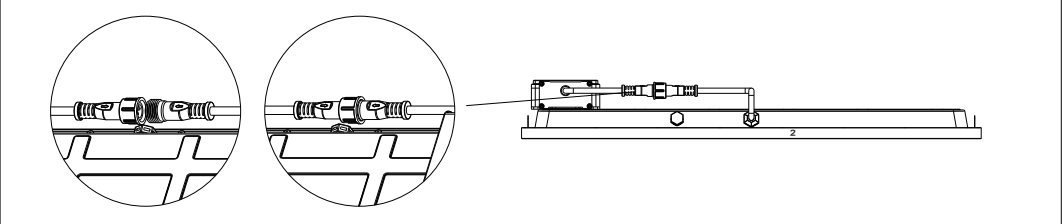

## IP65\_20

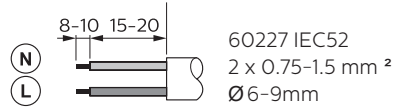
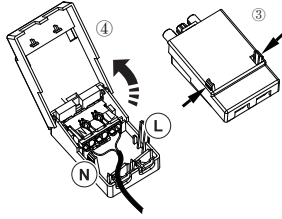
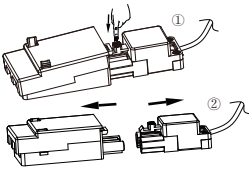

basic insulation between LV and control conductors

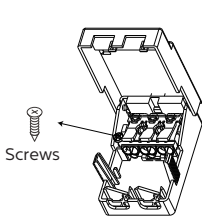

Screws

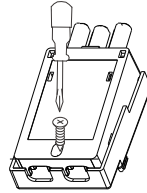

**IP65\_20**  
Needs screw fix  
60227 IEC52  
2 x 2.5 mm<sup>2</sup>  
Ø8-11mm



**VPC Visible Profile Ceiling/ Lay-In mounting**

Optional with  
911401809187 RC159Z Safety Cable

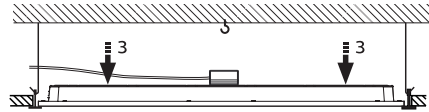
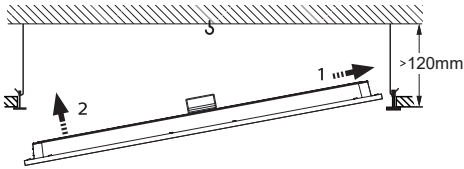

1

**Safety cable**

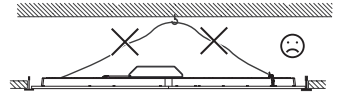
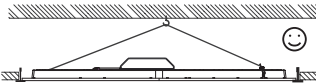
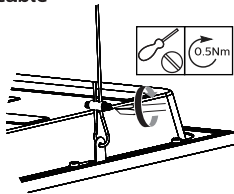

2

## Inrush current

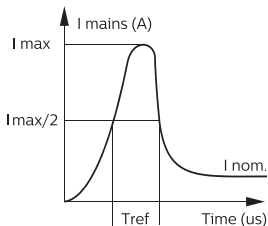

	PSU 26W	PSU 45W	PSD 45W
<b>Electrical characteristics</b>			
<b>I<sub>max</sub>(A)</b>	20	17.2	15.6
<b>T<sub>ref</sub> (us)</b>	200	290	295
<b>MCB</b>	<b>No. of luminaires max.</b>		
<b>B-10 A</b>	14	13	14
<b>B-16A</b>	23	20	25
<b>C-10 A</b>	24	22	26
<b>C-16A</b>	40	36	43