

PHILIPS

ClearFlood gen2

Floodlight

ClearFlood

Your floodlight range for
outstanding performance,
efficiency and connectivity



Philips is a lighting brand by Signify.
Official Lighting Partner of Mercedes-AMG Petronas F1 Team

signify



AMG
PETRONAS
FORMULA ONE TEAM

Official Lighting Partner



Contents

> Main product highlights of the new generation	3
> Product configurator	4
> Product design highlights	5
> Application areas	6
> Connectivity: Interact	8
> Lighting for circularity	9
> Product specifications	11

Reach new heights in performance and savings

Welcome the next generation of Philips ClearFlood: Optimized energy efficiency and product design for a cost-effective switch to LED in logistics, retail, parking sites, recreational sports fields and more

In today's competitive environment, reducing energy consumption and maintenance costs without compromising safety and comfort is paramount. The new Philips ClearFlood gen2 addresses these challenges, offering advanced technology and innovative design that deliver exceptional performance, reliability and optional integrated connectivity.

Experience the benefits of an attractive total cost of ownership thanks to the intelligent product design and improved energy efficiency. With optional integrated wireless connectivity, the ClearFlood gen2 allows you to achieve even greater energy savings and operational excellence.

And with the HID ban underway in 2027, it's high time to discover how the new ClearFlood gen2 can transform your lighting installations, offering the perfect balance between safety, convenience and cost efficiency.

Highlights of the new generation

Small



Medium



Large



Very attractive total cost of ownership

Thanks to its high luminous efficacy (143 lm/W to 167 lm/W, at CCT 4000K, CRI70), cost-effective design and very long lifetime (100,000 hours @L90).

Interact Ready connectivity for smart lighting

Connect to the cloud and discover additional ways to save energy through optimized efficiency and improved lighting management.

> [Learn more about Interact](#)



Optimized product design

From the harmonized look of the entire product range to the improved placement of the connectivity node, the new ClearFlood comes with a number of clever updates.

> [Learn more](#)

High-end optical platform

Philips OptiVision LED for optimal light distribution in sports and area applications.

Meets lighting for circularity criteria to help you achieve your sustainability goals

> [Learn more](#)



Product configurator

With our configuration options, you can customize the new Philips ClearFlood gen2 to match your demands and budget. Look out for our configuration recommendations in the brochure, labeled with this icon: 

Tip: With the configuration components listed below you can easily decipher every product code, for example:

BVP656 LED600-4S/740 A65-WNB ALU

Family description	Lumen packages	Color temperature	Optics		Housing color
BVP655 Small	LED757 / LED740 BVP655: 10,000 lm – 30,000 lm BVP656: 35,000 lm – 60,000 lm	757 Cool white (5700K, CRI70)	A35-NB	A65-WB	N Housing and bracket unpainted
BVP656 Medium	BVP657: 50,000 lm – 93,000 lm	740 Neutral white (4000K, CRI70)	A35-MB	A35-NWB	ALU Standard grey 9007
BVP657 Large	LED730 / LED727 BVP655: 10,000 lm – 29,000 lm BVP656: 30,000 lm – 55,000 lm BVP657: 45,000 lm – 85,000 lm	730 Warm white (3000K, CRI70)	A35-WB	A35-NMB	RAL RAL (20 standard colors, others on request)
		727 Warm white (2700K, CRI70)	A35-VWB	A55-NMB	
		840 Neutral white (4000K, CRI80)	A55-NB	A65-NWB	
			A55-MB	A65-VWB	
			A55-WB	DW10	
			A65-NB	DW30	

Link to be added once available

Get all product details in the [Philips e-catalog](#) or configure your own variant with our [online configurator](#)



Versatile, robust design in all sizes

Your requirements, your choice

Serviceability:

- Toolless opening of glass cover
([i](#) Select FG-TO in the product configurator)
- Opening of glass cover with screws
([i](#) Select FG in the product configurator)

Choice of housing finishings for different requirements and budgets

- Unpainted aluminum housing
([i](#) Select N in the housing color configuration)
- Standard coating
([i](#) Select N in the product configurator)
- Marine protected coating
([i](#) Select MSP in the product configurator)
- Swimming pool coating
([i](#) select SPO in the product configurator)

Durable design for reliable performance

- IP 66 / IK 08
- Ambient temperature resistance: -40°C to +50°C
- Very long lifetime: 100,000 hrs at L90

Hassle-free installation

More compact product design and 25% lighter compared to previous generation¹

Bracket designed for easy 1-to-1 HID retrofit installations

Connectivity

Connectivity options available for all product sizes

Node integrated into the luminaire housing², instead of externally, for a sleeker look and lower cost

¹ Comparing ClearFlood gen2 small (BVP655) with ClearFlood (BVP650)

² Possible up to an inclination of 35°, beyond this an external box is required for optimum signal transmission/reception

Tailored lighting for diverse applications

Transportation hubs

- Outdoor: car parks, aprons, harbors, toll stations
- Indoor: train stations, airports

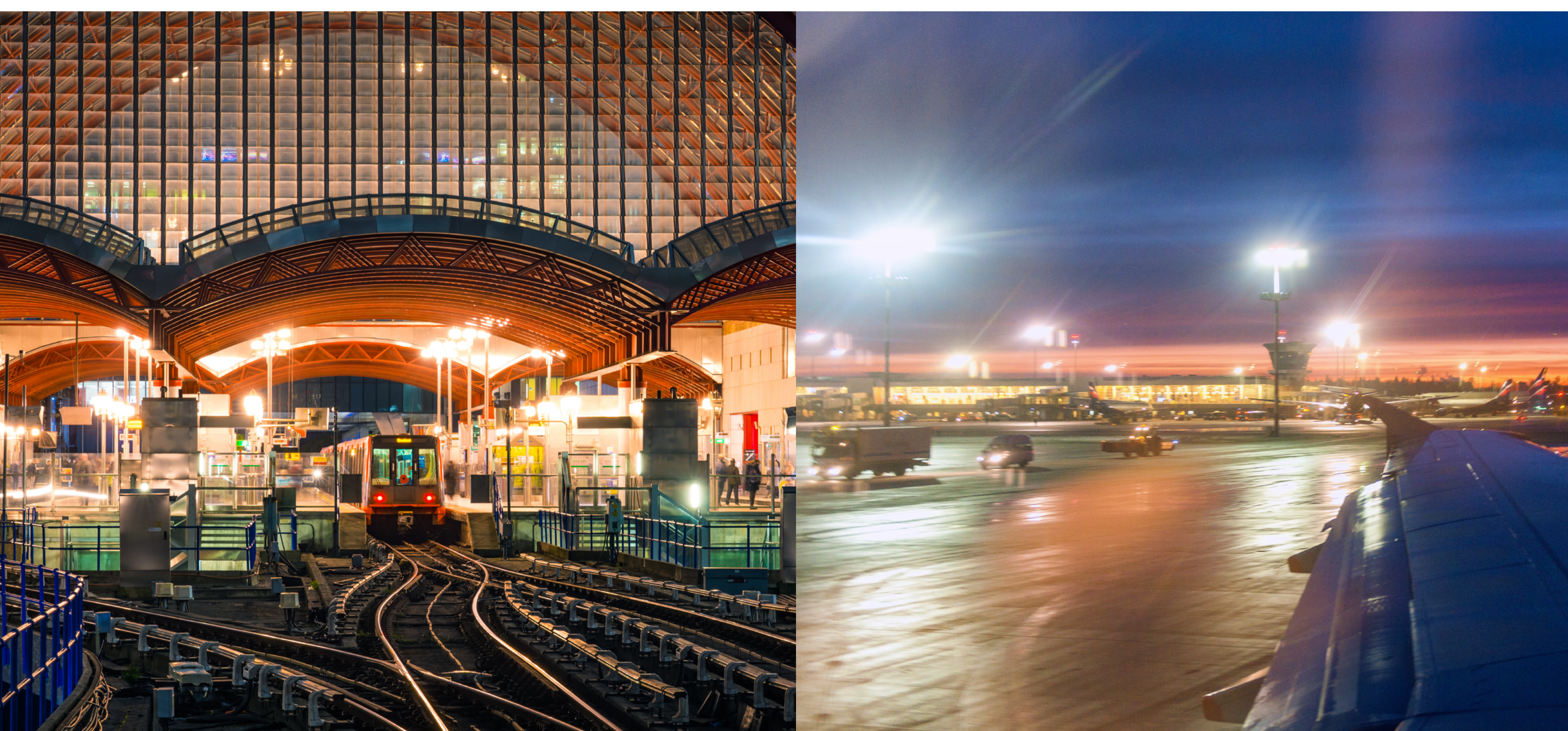

Retail and industrial sites

- Outdoor: car parks, facades, area lighting
- Indoor: storage areas



Recreational sports

- Outdoor: small and medium sized tennis courts, urban sports areas (e.g. basketball courts, skate parks)
- Indoor: multipurpose gymnasiums, swimming pools, basketball courts





Your way forward: Interact wireless smart lighting

With Interact, it's easier than ever to realize the benefits of smart lighting: higher energy savings, greater comfort, and improved operational efficiency – and a big step towards achieving sustainability goals.

General benefits

- Ideal for refurbishments and new installations
- No additional (DALI) control wires needed
- Quick to install with little downtime

Sustainable

- Enable higher energy and cost savings
- Reduce CO₂ emission and material waste

Smart

- Benefit from remote control and monitoring and reporting capabilities
- Use data to make better informed decisions more quickly

Safe

- Easily set the right lighting conditions for enhanced comfort and safety
- Get informed about issues to allow for timely and cost-efficient maintenance



The integrated connectivity node lets you connect to the cloud¹ to utilize the benefits of Interact smart lighting

i Select SRTB (Interact system ready driver) or PSD (DALI) in the product configurator

¹ Simplified illustration, setup depending on system details

Designed for a circular economy

In 2022, we used 1.7 times the resources our planet can sustain. To transition to a sustainable and circular economy, we need to rethink the way we produce and consume. There's no plan B for our home planet.

By choosing our lighting for circularity solutions, you get flexibility in lighting configurations and settings while reducing your carbon footprint to help you reach your sustainability development goals.

Go for optimal sustainability by selecting your renovation path

Are you looking to update your non-LED lighting?

- Choose our lighting for circularity **products**
- Full portfolio of circular economy ready Philips LED luminaires
- Superior efficacy
- Products are recyclable, connectable and serviceable.

Are you planning to update your LED-based infrastructure?

- Discover our remanufacturing or refurbishment **services**
- Gain enhanced luminaire performance, extended lifetimes, and end of contract management

Do you want to unlock the potential of smart lighting?

- Update your infrastructure to smart lighting with our **systems** solutions
- Optimize your energy costs with insights into your energy usage
- Configure lighting behavior
- Remotely monitor your lighting system

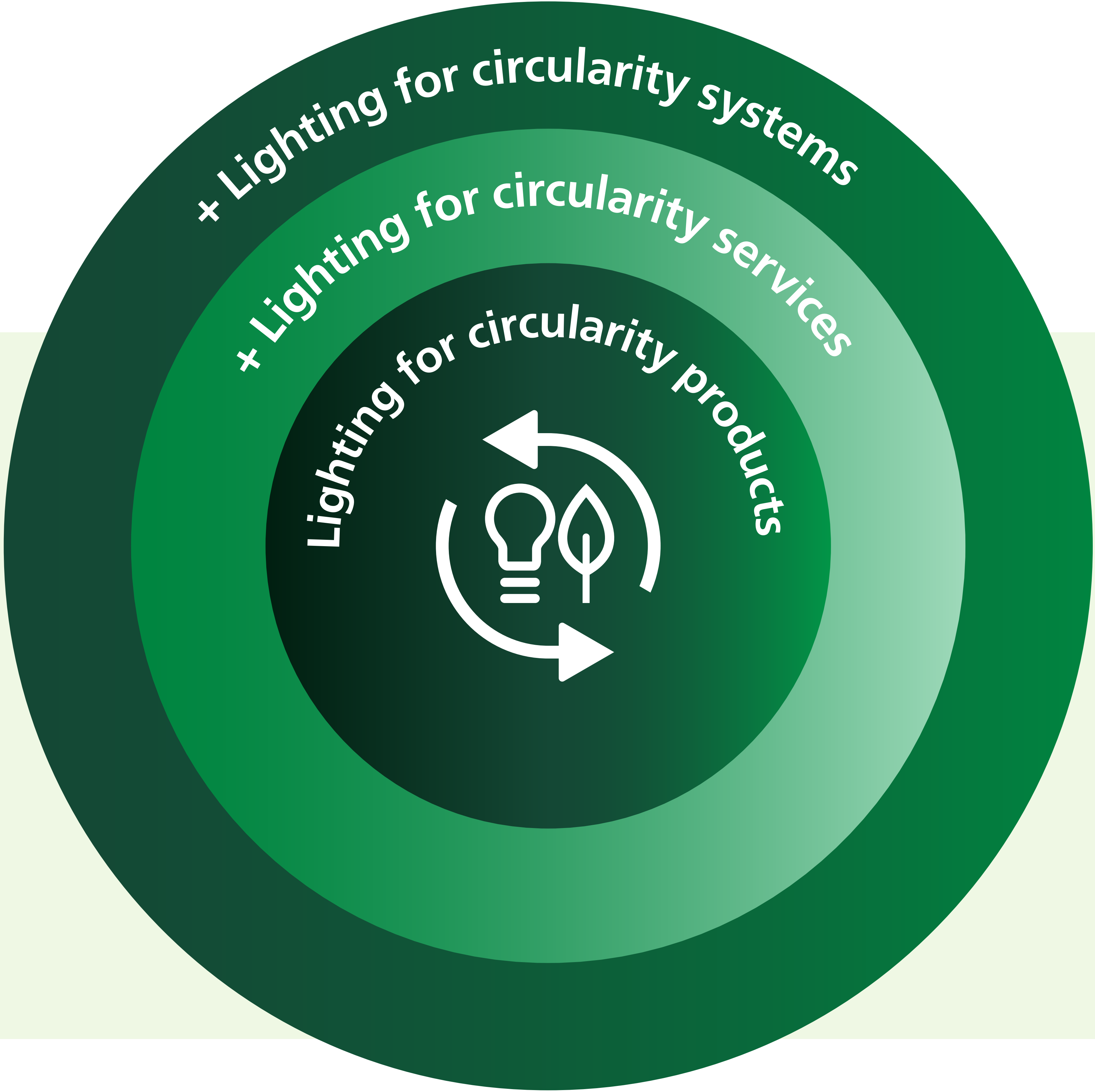

Philips ClearFlood gen2 meets the five criteria of lighting for circularity

1. Energy efficiency and extended lifetime

- High-efficacy light engine with luminous efficacy from 143 lm/W to 167 lm/W (at CCT 4000K, CRI70)
- Optics support optimized lighting design for key applications
- Very long lifetime of 100,000 hours (L90) reduces the need to replace luminaires or components

2. Connectable

- Serviceable drivers can connect ClearFlood to smart lighting systems, both wired (e.g. DALI) and wireless (e.g. Interact)

3. Upgradeable

- Flexible system: Simply add new luminaires or drivers to upgrade specific functions or the entire system

4. Reusable and recyclable

- Easy to dismantle and recycle
- No glue, no potted drivers

5. Serviceable

- Easy to install, service, maintain, repair and replace thanks to the QR-based service tag identification system
- Each luminaire and driver is uniquely identifiable

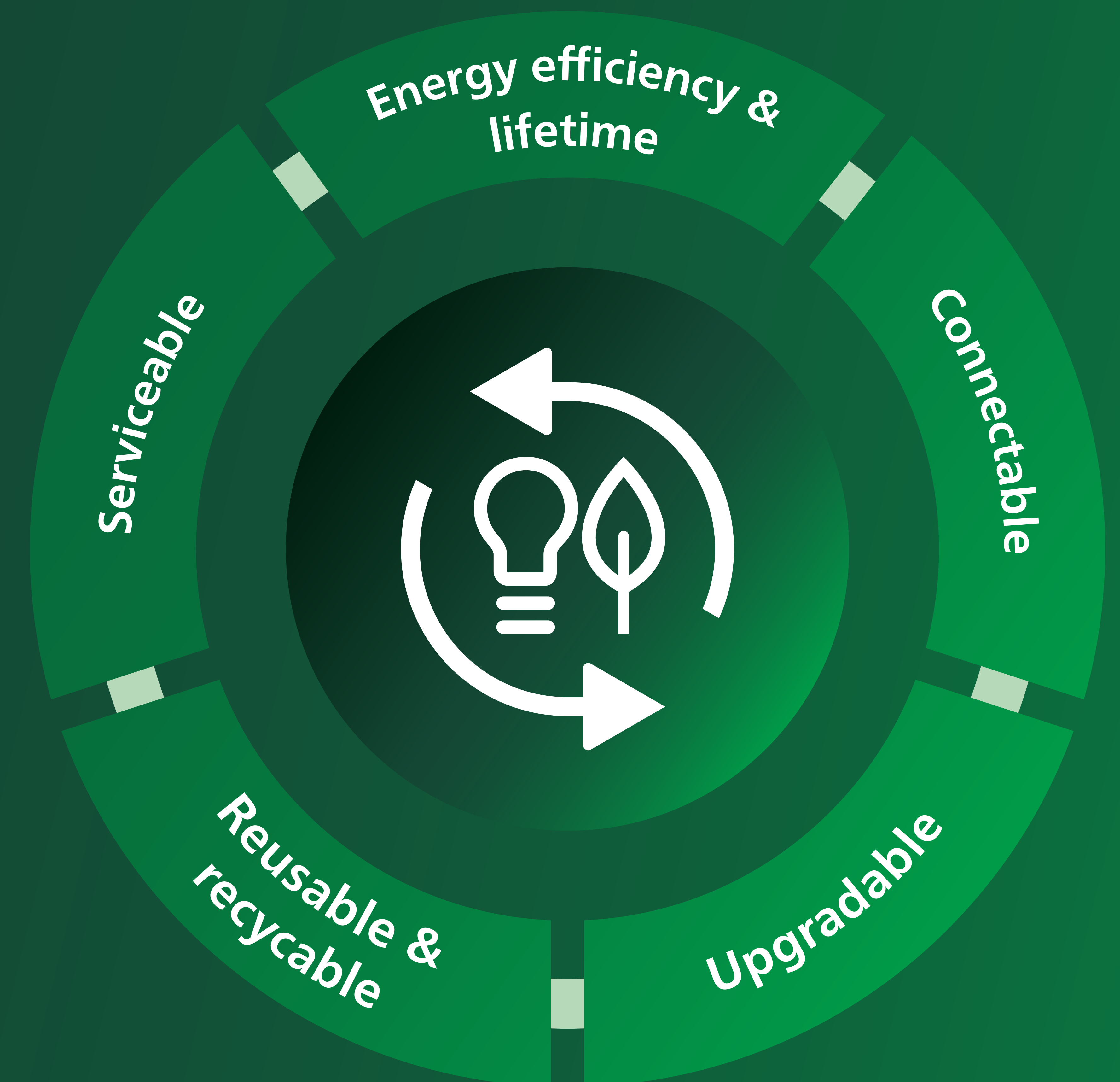

Specifications

Luminous flux	From 10,000 lm, up to 93,000 lm source lumen output
Efficacy	Typical efficacy from 143 lm/W to 167 lm/W (at CCT 4000K, CRI70)
Correlated color temperature	2700K / 3000 K / 4000 K / 5700 K
Color rendering index	≥70
Lifetime	100,000 hours at L90
Weight	12 kg (small; up to 30,000 lm) / 19 kg (medium; up to 60,000 lm) / 27 kg (large; up to 93,000 lm)
Optics	Dedicated Sports and Area light distribution platform, also used in OptiVision LED gen3.5
Voltage	230V
Electrical class	I and II
Ingress protection	IP66
Impact resistance	IK08
Surge protection	6/8 kV (standard) / 10kV (optional)
Ambient temperature	-40°C to +50°C
Finishing	Raw aluminium / Standard (500 hrs SST) / MSP (1,000 hrs SST) / Swimming pool treatment
Controls	DALI / SR (Interact Ready)
Warranty	5 years ¹

¹ For warranty conditions, visit www.lighting.philips.com/main/support/support/warranty

Product dimensions

BVP655 small

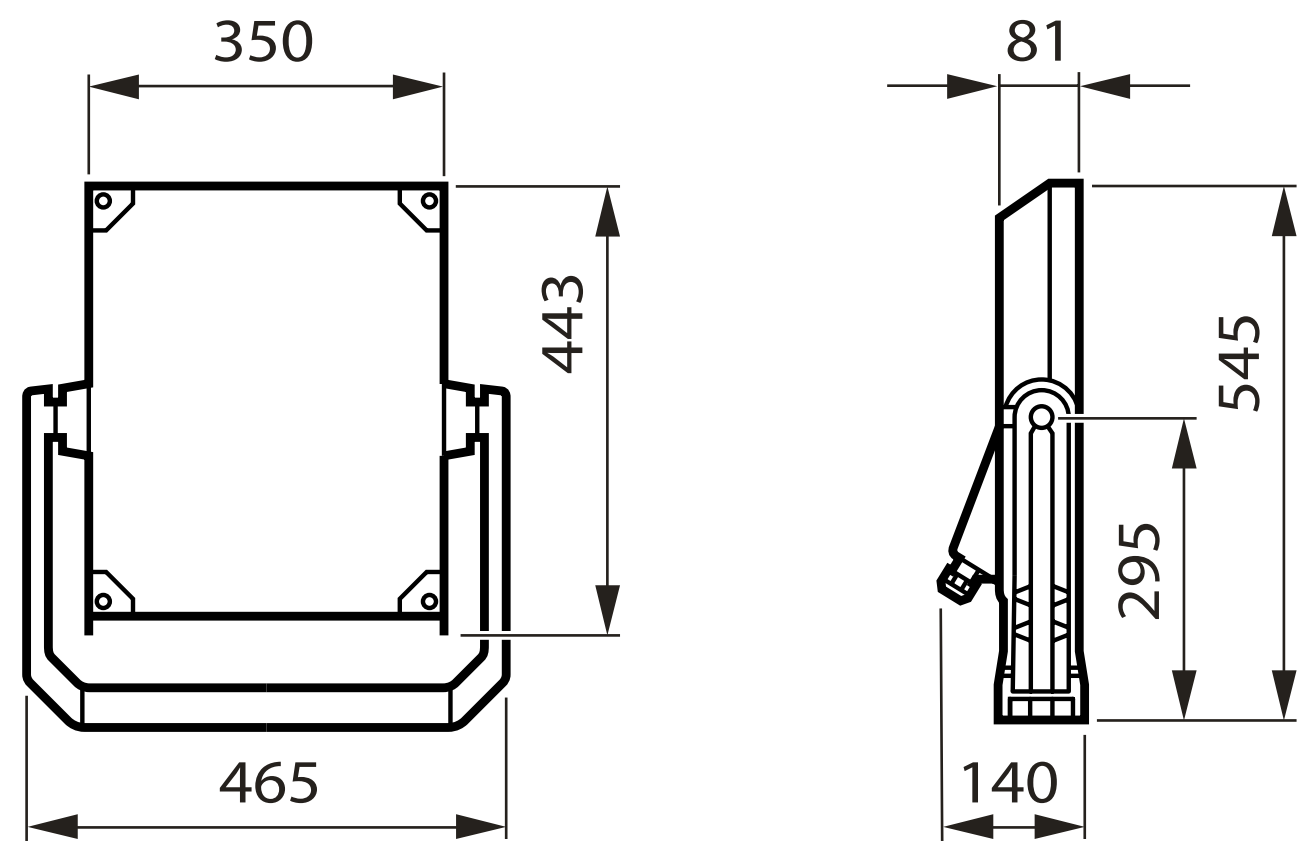

BVP656 medium

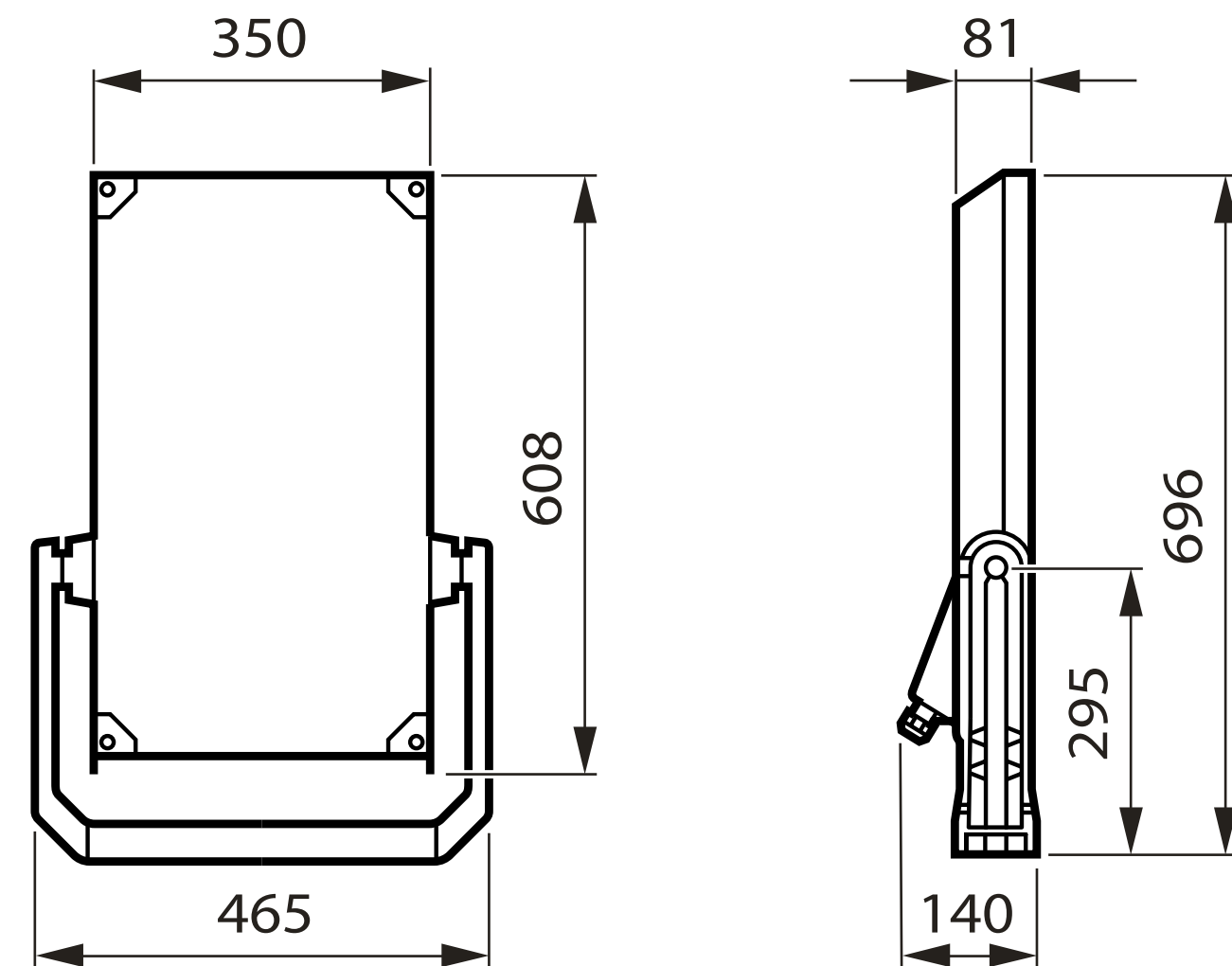

BVP657 large

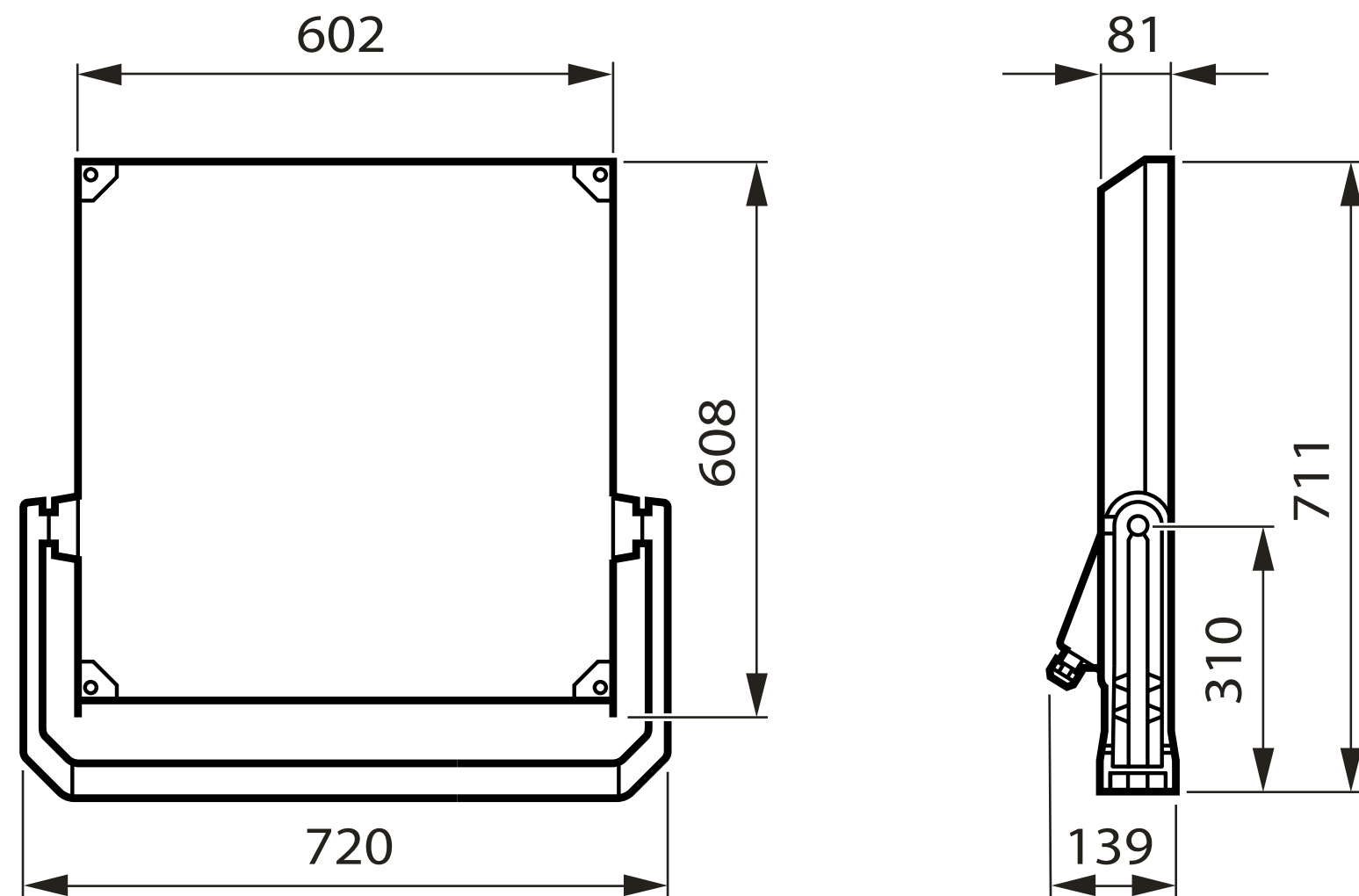

You and Signify – a reliable partnership

Signify, previously known as Philips Lighting, is the world leader in connected LED lighting systems, software and services. We proudly market the best lighting brands in the world, including Philips and Interact.

Close cooperation before, during and after projects is important to us. Our local service teams make sure you always get the competent support and information you need. You can rely on us for flexible, on-time delivery and product availability.

To help you stay on top of your game the [Signify Lighting Academy](#) offers a comprehensive range of educational resources for you to grow your expertise and get certified.

Our global brands

PHILIPS

The Philips brand stands for quality and energy-efficiency in light. For over 125 years, Philips products have been at the forefront of innovation.

Today Philips is recognized as the leading brand in lighting.

interact

Interact is the brand of our IoT software and platform that manages smart lighting systems and the data that those systems collect.

Easy to install and set up, Interact software can be used in a wide range of application areas, from small offices to entire cities.

Get more info on our products, services and tools:

The Signify logo, featuring a stylized 'S' inside a circle followed by the word 'ignify' in a sans-serif font.

Driven by responsible innovation

Signify and Mercedes-AMG PETRONAS F1 Team are driven by a shared passion for technology and the desire to push the boundaries of what is possible.

Our innovations in lighting support the team's ambition to become one of the world's most sustainable in sport, serve the well-being and performance of the team, and deliver powerful experiences for fans, trackside and at home.

Learn more at

Signify is Official Lighting Partner of
Mercedes-AMG PETRONAS F1 Team

Signify



Official Lighting Partner

[Return to contents](#)

11



© 2024 Signify Holding. All rights reserved. The information provided herein is subject to change, without notice. Signify does not give any representation or warranty as to the accuracy or completeness of the information included herein and shall not be liable for any action in reliance thereon. The information presented in this document is not intended as any commercial offer and does not form part of any quotation or contract, unless otherwise agreed by Signify.

Philips and the Philips Shield Emblem are registered trademarks of Koninklijke Philips N.V. All other trademarks are owned by Signify Holding or their respective owners.

All technical information can be found at www.philips.com