



Deep Recessed Spotlight

RS350 G2 SF Rd D100 11W 30K 24D 1H

Deep Recessed Spotlight, 11 W, 1000 lm, 3000 K, Beam angle 24°, White

Deep Recessed offers excellent experience for the consumer, which includes eye comfort, reliable quality and outstanding performance, especially the anti glare feature.

Product data

| General Information | |
|------------------------------------|----------------|
| Light source replaceable | No |
| Number of gear units | 10 units |
| Driver included | Yes |
| Switching Cycle | 15,000 |
| Lighting Technology | LED |
| Value ladder | Performance |
| Warranty period | 1 years |
| Light Technical | |
| Luminous Flux | 1,000 lm |
| Correlated Color Temperature (Nom) | 3000 K |
| Luminous Efficacy (rated) (Nom) | 90 lm/W |
| Color rendering index (CRI) | 90 |
| Light source color | 930 warm white |
| Optic type | Beam angle 24° |
| Luminaire light beam spread | 24° |

| Operating and Electrical | |
|------------------------------------------|----------------------------|
| Input Voltage | 220 to 240 V |
| Line Frequency | 50 or 60 Hz |
| Input Frequency | 50 or 60 Hz |
| Inrush current | 8.5 A |
| Inrush time | 0.18 ms |
| Power Consumption | 11 W |
| Power Factor (Fraction) | 0.5 |
| Connection | Flying leads/wires |
| Cable | Cable 0.7 m without plug |
| Number of products on MCB of 16 A type B | 110 |
| Suitable for random switching | No |
| Protection class IEC | Safety class II |
| Controls and Dimming | |
| Dimmable | No |
| Driver/power unit/transformer | Power supply unit (On/Off) |

Deep Recessed Spotlight

| | |
|-----------------------|----|
| Constant light output | No |
|-----------------------|----|

Mechanical and Housing

| | |
|------------------------------|-------------------------------|
| Housing Material | Aluminum die-cast |
| Reflector material | Polycarbonate aluminum coated |
| Optic material | Polycarbonate |
| Optical cover material | Polycarbonate |
| Fixation material | Steel |
| Housing Color | White |
| Optical cover finish | Clear |
| Overall height | 140 mm |
| Overall diameter | 100 mm |
| Ingress protection code | IP20 [Finger-protected] |
| Mech. impact protection code | IK03 [0.3 J] |
| Net Weight (Piece) | 0.600 kg |

Approval and Application

| | |
|---------------------------|---------------------------------------------|
| Glow-wire test | Temperature 650 °C, duration 30 s |
| Flammability mark | For mounting on normally flammable surfaces |
| EU RoHS compliant | Yes |
| EyeComfort | Yes |
| Ambient temperature range | -20 to +40 °C |

Initial Performance (IEC Compliant)

| | |
|-----------------------------|---------------------------------|
| Luminous flux tolerance | +/-10% |
| Initial chromaticity | ((, 0.4341 , , 0.3993) 5SDCM |
| Power consumption tolerance | +/-10% |

Over Time Performance (IEC Compliant)

| | |
|-------------------------------|----------------|
| Driver failure rate at 5000 h | 0.015 % |
| Median useful life L70B50 | 25,000 hour(s) |

Product Data

| | |
|---------------------------------|------------------------------------|
| Order product name | RS350 G2 SF Rd D100 11W 30K 24D 1H |
| Full product name | RS350 G2 SF Rd D100 11W 30K 24D 1H |
| Full product code | 692234195860100 |
| Order code | 929003220010 |
| Material Nr. (12NC) | 929003220010 |
| Numerator - Quantity Per Pack | 1 |
| EAN/UPC - Product/Case | 6922341958601 |
| Numerator - Packs per outer box | 12 |
| EAN/UPC - Case | 6922341958618 |

Dimensional drawing

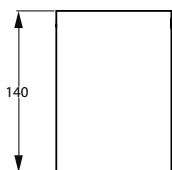
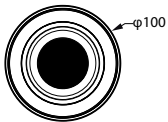

Deep Recessed Spotlight

Photometric data

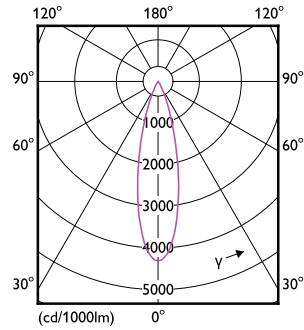
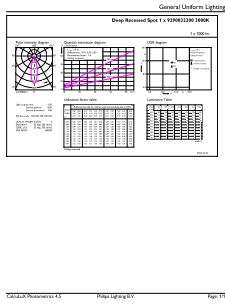

General uniform lighting - RS350 G2 SF Rd D100 11W 30K 24D 1H

Light Distribution Diagram - RS350 G2 SF Rd D100 11W 30K 24D 1H

