



# Essential LED spot GU10

## LEDspot50W GU10Kit\_S 827 100-240V 36D PF

LEDspot, PAR16, 50 W, GU10, 2700 K, 350 lm, 15000 hour(s)

Essential LEDspots are compatible with most existing fixtures with a GU10 socket and are designed as a retrofit replacement for halogen spots. Essential LEDspots deliver significant energy savings and minimize initial investment.

### Product data

General Information	
Cap-Base	GU10
Nominal lifetime	15,000 hour(s)
Switching Cycle	50,000
Lighting Technology	LEDspot
Warranty period	1 years
Light Technical	
Color Code	827 [CCT of 2700K]
Beam Angle (Nom)	36 degree(s)
Luminous Flux	350 lm
Luminous Intensity (Nom)	600 cd
Color Designation	Warm White (WW)
Correlated Color Temperature (Nom)	2700 K
Luminous Efficacy (rated) (Nom)	70.00 lm/W
Color Consistency	<6
Color rendering index (CRI)	80
LLMF At End Of Nominal Lifetime (Nom)	70 %

Operating and Electrical	
Line Frequency	50 to 60 Hz
Input Frequency	50 to 60 Hz
Power Consumption	5 W
Lamp Current (Nom)	75 mA
Wattage Equivalent	50 W
Starting Time (Nom)	0.5 s
Warm-up time to 60% light	0.5 s
Power Factor (Fraction)	0.4
Voltage (Nom)	100-240 V
Temperature	
T-Case Maximum (Nom)	75 °C
Controls and Dimming	
Dimmable	No
Mechanical and Housing	
Bulb Shape	PAR16

# Essential LED spot GU10

Net Weight (Piece)	0.078 kg
--------------------	----------

## Approval and Application

Suitable For Accent Lighting	Yes
EU RoHS compliant	Yes
Ambient temperature range	-20 to +45 °C

## Application Conditions

Wireless Technology	Not applicable
---------------------	----------------

## Product Data

Order product name	LEDspot50W GU10Kit_S 827 100-240V 36D PF
--------------------	--

Full product name	LEDspot50W GU10Kit_S 827 100-240V 36D PF
Full product code	871951426574500
Order code	929001971161
Material Nr. (12NC)	929001971161
Numerator - Quantity Per Pack	1
EAN/UPC - Product/Case	8719514265745
Numerator - Packs per outer box	10
EAN/UPC - Case	8719514265752

## Dimensional drawing

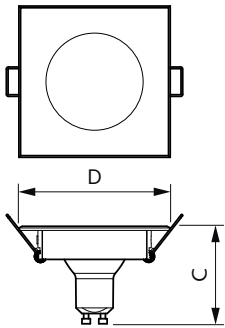

Product	D	C
LEDspot50W GU10Kit_S 827 100-240V 36D PF	50 mm	54 mm

## Photometric data

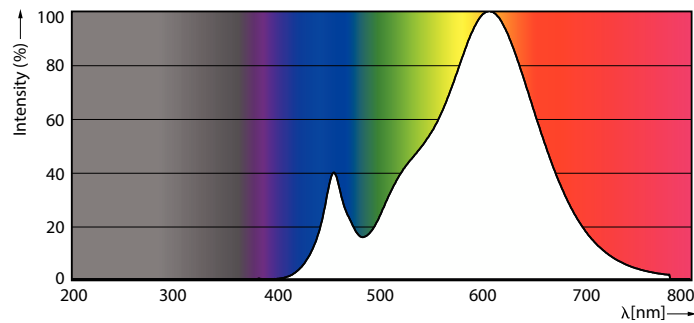

Spectral Power Distribution Colour - LEDspot50W GU10Kit\_S 827 100-240V 36D PF

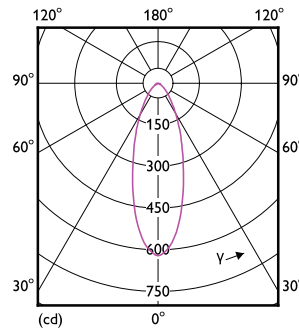

Light Distribution Diagram - LEDspot50W GU10Kit\_S 827 100-240V 36D PF

# Essential LED spot GU10

## Photometric data

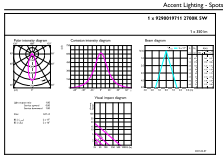

Accent Lighting Spots - LEDspot50W GU10Kit\_S 827 100-240V 36D PF

## Lifetime



Life Expectancy Diagram

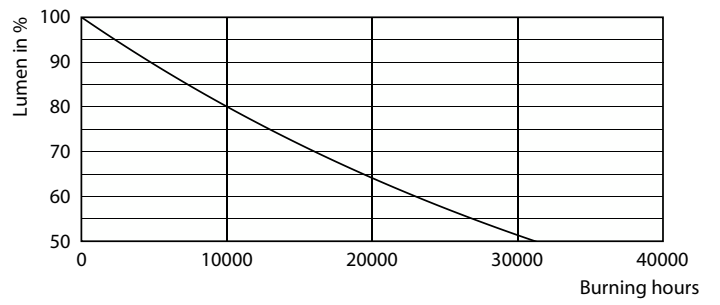

Lumen Maintenance Diagram - LEDspot50W GU10Kit\_S 827 100-240V 36D PF

