



HID-High Power ballasts for HPL and HPI lamps

BHL 1000L 202

The HID High-Power ballast is an impregnated (HID standard) electromagnetic copper/iron ballast for use with an external ignitor for HID lamps.

Product data

Operating and Electrical	
Input Voltage	230 V
Line Frequency	50 Hz
Input Frequency	50 Hz
Wiring	
Connector Type	Screw
Mechanical and Housing	
Net Weight (Piece)	6.900 kg
Approval and Application	
Approval Marks	CE marking CCC certificate

Product Data	
Order product name	BHL 1000L 202
Full product name	BHL 1000L 202
Full product code	697480505065900
Order code	913710104942
Material Nr. (12NC)	913710104942
Numerator - Quantity Per Pack	1
EAN/UPC - Product/Case	6974805050659
Numerator - Packs per outer box	1
EAN/UPC - Case	6974805050666

HID-High Power ballasts for HPL and HPI lamps

Dimensional drawing

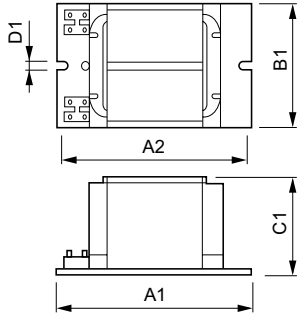

Product	D1	C1	A1	A2
BHL 1000L 202	7 mm	102.0 mm	165 mm	123 mm

