

# PrimaVision Compact for CDM

## HID-PV C 70 /I CDM 220-240V 50/60Hz NG

High-quality, compact and lightweight HID electronic gear for optimal and reliable performance of 20, 35, 50 and 70 W CDM lamps

### Product data

Operating and Electrical	
Input Voltage	220 to 240 V
Line Frequency	50 to 60 Hz
Input frequency	50 to 60 Hz
Earth leakage current (max.)	0.25 mA
Inrush current width	0.33 ms
Inrush current peak (max.)	33 A
Number of products on MCB (16 A type B) (nom.)	20
Wiring	
Cable length from device to lamp	2.0 m
Connector type	Insert
Temperature	
T-case lifetime (nom.)	75 °C
T-Case maximum (max.)	75 °C
Mechanical and Housing	
Housing	/I
Net Weight (Piece)	0.360 kg

Approval and Application	
Safety standard	EN 61347-2-12
Environmental standard	ISO 14001
Approval marks	CE marking ENEC certificate
CE mark	Yes
Ambient temperature range	-20°C to 45°C
Product Data	
Order product name	HID-PV C 70 /I CDM 220-240V 50/60Hz NG
Full product name	HID-PV C 70 /I CDM 220-240V 50/60Hz NG
Full EOC	872790085988100
Order code	913700653266
Material no. (12 NC)	913700653266
Local order code	HIDPVC70ICDM
Numerator – quantity per pack	1
EAN/UPC – Product/Case	8711500881717
Numerator – packs per outer box	12
EAN/UPC - Case	8727900859881

## PrimaVision Compact for CDM

### Dimensional drawing

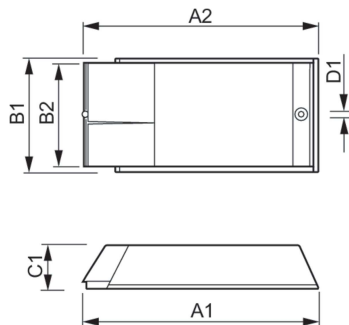

Product	D1	C1	A1	A2	B1
HID-PV C 70 /I CDM 220-240V 50/60Hz NG	4.8 mm	34.5 mm	188.0 mm	170.0 mm	82.7 mm

