



CoreLine Projector gen2

ST151T LED30S/940 WB WH

CoreLine Projector gen2, Track-mounted, 27 W, D80 mm, 3000 lm, 4000 K, CRI>90, Wide beam, White

The well-known CoreLine Projector with its latest generation has undergone important design and performance improvement, raising the bar even higher and setting a new standard for track projectors used in retail and hospitality applications.

Warnings and Safety

- The luminaire should be mounted outside of arm's reach
- The luminaire should be installed by a qualified electrician and wired in accordance with the latest IEE electrical regulations or the national requirements

Product data

General Information	
Light source replaceable	No
Number of gear units	Unit
Driver included	Yes
Lighting Technology	LED
Value ladder	Performance
Serviceability class	Class C, luminaire without serviceable parts, not serviceable
Warranty period	5 years
Sustainability rating	Unclassified

Light Technical	
Luminous Flux	3,000 lm

Saturated Red (R9)	>50
Correlated Colour Temperature (Nom)	4000 K
Luminous efficacy (rated) (nom.)	110 lm/W
Colour rendering index (CRI)	>90
Beam angle of light source	38 degree(s)
Light source colour	940 neutral white
Optic type	Wide beam
Luminaire light beam spread	38°
Unified Glare Rating (CEN)	20

Operating and Electrical	
Input Voltage	220 to 240 V
Line Frequency	50 or 60 Hz

CoreLine Projector gen2

Initial CLO power consumption	27 W
Average CLO power consumption	27 W
Inrush current	43.8 A
Inrush time	0.0115 ms
Power Consumption	27 W
Power Factor (Fraction)	0.9
Connection	3C Track
Cable	-
Number of products on MCB (16 A type B)	30
Suitable for random switching	No
Protection class IEC	Safety class I
Total harmonic distortion	20 %

Controls and Dimming

Dimmable	No
Driver/power unit/transformer	Power supply unit (On/Off)
Constant light output	No
Maximum dim level	Not applicable

Mechanical and Housing

Housing material	Aluminium
Reflector material	-
Optic material	Polycarbonate
Optical cover/lens material	Polycarbonate
Fixation material	-
Housing Colour	White
Optical cover/lens finish	-
Overall length	207 mm
Overall width	87 mm
Overall height	125 mm
Overall diameter	80 mm
Dimensions (height x width x depth)	125 x 87 x 207 mm
Ingress protection code	IP20 [Finger-protected]
Mech. impact protection code	IK03 [0.3 J]
Net Weight (Piece)	0.510 kg

Approval and Application

Glow-wire test	Temperature 650 °C, duration 30 s
----------------	-----------------------------------

Dimensional drawing

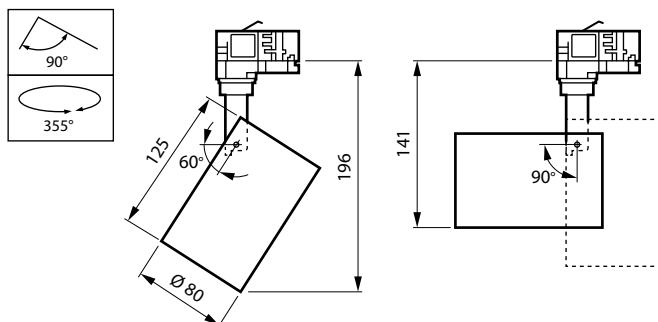

Flammability mark	-
CE mark	Yes
ENEC mark	ENEC mark
Photobiological risk	Photobiological risk group 0 @200mm to EN62778
Photobiological risk specification	0.2 m
EU RoHS compliant	Yes
Performance ambient temperature Tq	25 °C
Flickering value (PstLM)	1
Stroboscopic effect	1.6
Ambient temperature range	-20 to +40 °C

Initial Performance (IEC Compliant)

Luminous flux tolerance	+/-10%
Initial chromaticity	(0.3837, 0.3828) SDCM <4
Power consumption tolerance	+/-10%
Standard Deviation of Colour Matching (McAdam ellipse)	SDCM ≤4

Over Time Performance (IEC Compliant)

Control gear failure rate at median useful life 50,000 h	5 %
Lumen maintenance (EN-IEC 62722-2-1) at median useful life* 50000 h	L70

Product Data

Order product name	ST151T LED30S/940 WB WH
Full product name	ST151T LED30S/940 WB WH
Full EOC	871951452862899
Order code	911401847282
Material no. (12 NC)	911401847282
Numerator – quantity per pack	1
EAN/UPC – Product/Case	8719514528628
Numerator – packs per outer box	10
EAN/UPC – Case	8719514528703

CoreLine Projector gen2

Photometric data

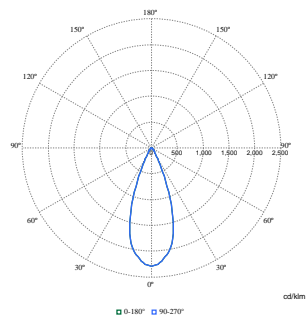

Polar Normal (separate) - null - 911401847282

