



# CoreLine Projector gen2

## ST151T LED30S/930 MB WH

CoreLine Projector gen2, Track-mounted, 30 W, D80 mm, 3000 lm, 3000 K, CRI>90, Medium beam, White

The well-known CoreLine Projector with its latest generation has undergone important design and performance improvement, raising the bar even higher and setting a new standard for track projectors used in retail and hospitality applications.

### Warnings and Safety

- The luminaire should be mounted outside of arm's reach
- The luminaire should be installed by a qualified electrician and wired in accordance with the latest IEE electrical regulations or the national requirements

### Product data

General Information		Color rendering index (CRI)	
Light source replaceable	No		>90
Number of gear units	1 unit	Beam angle of light source	25 degree(s)
Driver included	Yes	Light source color	930 warm white
Lighting Technology	LED	Optic type	Medium beam
Value ladder	Performance	Luminaire light beam spread	25°
Warranty period	5 years	Unified glare rating CEN	19
Light Technical		Operating and Electrical	
Luminous Flux	3,000 lm	Input Voltage	220 to 240 V
Saturated Red (R9)	>50	Line Frequency	50 or 60 Hz
Correlated Color Temperature (Nom)	3000 K	Initial CLO power consumption	30 W
Luminous Efficacy (rated) (Nom)	100 lm/W	Average CLO power consumption	30 W
		Inrush current	43.8 A

## CoreLine Projector gen2

Inrush time	0.0115 ms
Power Consumption	30 W
Power Factor (Fraction)	0.9
Connection	3C Track
Cable	-
Number of products on MCB of 16 A type B	30
Suitable for random switching	No
Protection class IEC	Safety class I
Total harmonic distortion	20 %

### Controls and Dimming

Dimmable	No
Driver/power unit/transformer	Power supply unit (On/Off)
Constant light output	No
Maximum dim level	Not applicable

### Mechanical and Housing

Housing Material	Aluminum
Reflector material	-
Optic material	Polycarbonate
Optical cover material	Polycarbonate
Fixation material	-
Housing Color	White
Optical cover finish	-
Overall length	207 mm
Overall width	87 mm
Overall height	125 mm
Overall diameter	80 mm
Dimensions (Height x Width x Depth)	125 x 87 x 207 mm
Ingress protection code	IP20 [Finger-protected]
Mech. impact protection code	IK03 [0,3 J]
Net Weight (Piece)	0.510 kg

### Approval and Application

Glow-wire test	Temperature 650 °C, duration 30 s
Flammability mark	-
CE mark	Yes
ENEC mark	ENEC mark
Photobiological risk	Photobiological risk group 0 @200mm to EN62778
Photobiological risk specification	0.2 m
EU RoHS compliant	Yes
Performance ambient temperature Tq	25 °C
Flickering value (PstLM) - Flickering value as per EN 61000-3-3	1
Stroboscopic effect visibility measure (SVM)	1.6

Ambient temperature range	-20 to +40 °C
---------------------------	---------------

### Initial Performance (IEC Compliant)

Luminous flux tolerance	+/-10%
Initial chromaticity	(0.4355, 0.4045) SDCM <4
Power consumption tolerance	+/-10%
Standard Deviation of Colour Matching (McAdam ellipse)	SDCM≤4

### Over Time Performance (IEC Compliant)

Control gear failure rate at median useful life 50000 h	5 %
Lumen maintenance (EN-IEC 62722-2-1) at median useful life* 50000 h	L70

### Sustainability Data

Sustainability rating	Unclassified
Repair class	Repair Class D, this product is not designed to be repaired.
Embedded carbon (A1-A3)	10.3 kg CO <sub>2</sub> e
Product non-virgin material ratio	8.02 %
Recyclable content ratio of the finished product	37.7 %
GWP total B6 (kg CO <sub>2</sub> eq) Declared Unit	Please calculate using your local energy mix value: Power Declared Unit (kW) * Service life (hrs) Declared Unit * Energy mix (kg CO <sub>2</sub> eq / kwh)
GWP total B6 (kg CO <sub>2</sub> eq) Functional Unit	Please calculate using your local energy mix value: Power Declared Unit (kW) * 1000 (lm) /Lumen output (lm) Declared Unit * 35000 (hrs) * Energy mix (kg CO <sub>2</sub> eq / kwh)

### Product Data

Order product name	ST151T LED30S/930 MB WH
Full product name	ST151T LED30S/930 MB WH
Full product code	871951452857499
Order code	52857499
Material Nr. (12NC)	911401846782
Numerator - Quantity Per Pack	1
EAN/UPC - Product/Case	8719514528574
Numerator - Packs per outer box	10
EAN/UPC - Case	8719514528659

# CoreLine Projector gen2

## Dimensional drawing

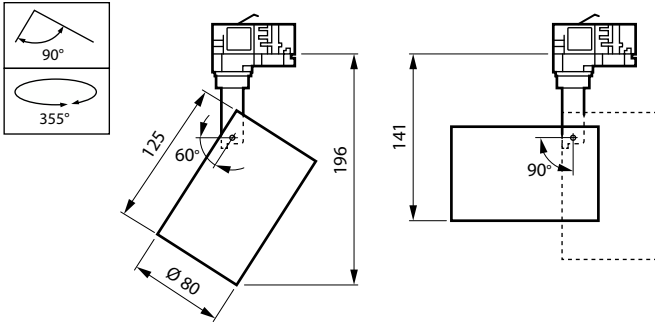

## Photometric data

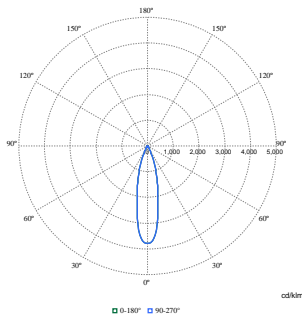

Polar Normal (separate) - 911401846782

