



# CoreLine SlimDownlight

## DN145C LED10S/840 PSU II WH

CoreLine SlimDownlight, Surface-mounted, 11 W, D171 mm, 1100 lm, 4000 K, Opal, IP20/44

Surface-mounted, D171 mm, Aluminum die cast, White, Traffic white (RAL9016), Surface, Power supply unit (On/Off), 1100 lm, 11 W, 100 lm/W, 4000 K, (0.38212,0.38031) SDCM<3, Beam angle 90°, Opal, Polystyrene, IP20/44 | Finger-protected; wire-protected, splash-proof, IK02 | 0.2 J standard, Safety class II, Connection unit 2-pole

### Product data

General Information		Color rendering index (CRI)	
Lamp family code	LED10S [LED Module, system flux 1000 lm]	>80	
Light source replaceable	No	Number of light sources	1
Number of gear units	1 unit	Beam angle of light source	120 degree(s)
Driver included	Yes	Light source color	840 neutral white
Service tag	Yes	Optic type	Beam angle 90°
Lighting Technology	LED	Luminaire light beam spread	84°
Mounting	Surface	Unified glare rating CEN	28
Value ladder	Performance		
Warranty period	5 years		
Light Technical		Operating and Electrical	
Luminous Flux	1,100 lm	Input Voltage	220 to 240 V
Saturated Red (R9)	<50	Line Frequency	50 or 60 Hz
Correlated Color Temperature (Nom)	4000 K	Initial CLO power consumption	- W
Luminous Efficacy (rated) (Nom)	100 lm/W	Average CLO power consumption	- W
		Inrush current	10.1 A
		Inrush time	0.0022 ms
		Power Consumption	11 W

# CoreLine SlimDownlight

Power Factor (Fraction)	0.9
Connection	Connection unit 2-pole
Cable	-
Number of products on MCB of 16 A type B	47
Suitable for random switching	Yes
Protection class IEC	Safety class II
Total harmonic distortion	20 %

## Controls and Dimming

Dimmable	No
Driver/power unit/transformer	Power supply unit (On/Off)
Control interface	-
Constant light output	No
Maximum dim level	Not applicable

## Mechanical and Housing

Housing Material	Aluminum die cast
Reflector material	-
Optic material	Polymethyl methacrylate
Optical cover material	Polystyrene
Fixation material	-
Housing Color	White
Optical cover finish	Opal
Overall height	50 mm
Overall diameter	168 mm
Nominal Ceiling cut-out diameter	205 mm
Ingress protection code	IP20/44 [Finger-protected; wire-protected, splash-proof]
Mech. impact protection code	IK02 [0.2 J standard]
Mounting	Surface
Optical cover type	Opal
Net Weight (Piece)	0.550 kg

## Approval and Application

Glow-wire test	Temperature 650 °C, duration 30 s
Flammability mark	For mounting on normally flammable surfaces
CE mark	Yes
ENEC mark	ENEC mark
Photobiological risk	Photobiological risk group 0 @200mm to EN62778
EU RoHS compliant	Yes
Performance ambient temperature Tq	25 °C
Remarks	*-Per Lighting Europe guidance paper "Evaluating performance of LED based luminaires - January 2018": statistically there is no relevant difference in lumen maintenance between B50 and for example B10. Therefore, the median useful life (B50) value also represents the B10 value.
Flickering value (PstLM) - Flickering value as per EN 61000-3-3	1

Stroboscopic effect visibility measure (SVM)	1.6
Ambient temperature range	0 to +35 °C

## Initial Performance (IEC Compliant)

Luminous flux tolerance	+/-10%
Initial chromaticity	(0.38212,0.38031) SDCM<3
Power consumption tolerance	+/-10%
Standard Deviation of Colour Matching (McAdam ellipse)	SDCM≤3

## Over Time Performance (IEC Compliant)

Driver failure rate at 5000 h	0.0015 %
Control gear failure rate at median useful life 50000 h	5 %
Lumen maintenance (EN-IEC 62722-2-1) at median useful life* 50000 h	L70

## Sustainability Data

Sustainability rating	Unclassified
Repair class	Repair Class D, this product is not designed to be repaired.
Embedded carbon (A1-A3)	8.62 kg CO <sub>2</sub> e
Product non-virgin material ratio	15.9 %
Recyclable content ratio of the finished product	64.5 %
GWP total B6 (kg CO <sub>2</sub> eq) Declared Unit	Please calculate using your local energy mix value: Power Declared Unit (kW) * Service life (hrs) Declared Unit * Energy mix (kg CO <sub>2</sub> eq / kwh)
GWP total B6 (kg CO <sub>2</sub> eq) Functional Unit	Please calculate using your local energy mix value: Power Declared Unit (kW) * 1000 (lm) / lumen output (lm) Declared Unit * 35000 (hrs) * Energy mix (kg CO <sub>2</sub> eq / kwh)
Non-virgin material ratio of the packaging	Cardboard > 80% recycled
Packaging Recyclable content ratio	Cardboard recycling rate > 80%
Packaging Material	Cardboard

## Product Data

Order product name	DN145C LED10S/840 PSU II WH
Full product name	DN145C LED10S/840 PSU II WH
Full product code	871016333952899
Order code	911401806480
Material Nr. (12NC)	911401806480
Numerator - Quantity Per Pack	1
EAN/UPC - Product/Case	8710163339528
Numerator - Packs per outer box	10
EAN/UPC - Case	8710163339849

# CoreLine SlimDownlight

## Dimensional drawing

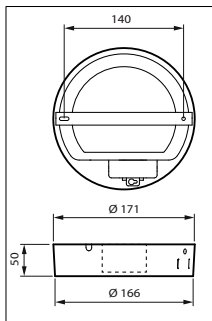

## Photometric data

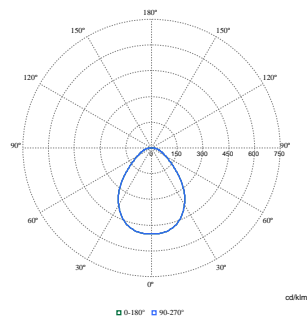

Polar Normal (separate) - 911401806480

