



Greenup Slim Downlight

DN150B LED6S 840 PSU GM

Greenup Slim Downlight, 6.5 W, 650 lm, 4000 K, Textured, IP20 | Finger-protected

Greenup Slim downlight is ultra-thin product for general lighting applications with limited build-in height, which is suitable for a series of Lighting applications in Office, Retail and General Area Lighting. Available in a wide variety of lumen packs, cut out size, color temp and dimming option (ETO approach).

Product data

General Information	
Number of gear units	1 unit
Driver included	Yes
Light source engine type	LED
Service tag	Yes
Warranty period	3 years
Light Technical	
Luminous Flux	650 lm
Correlated Color Temperature (Nom)	4000 K
Luminous Efficacy (rated) (Nom)	100 lm/W
Color rendering index (CRI)	>80
Beam angle of light source	- degree(s)
Light source color	840 neutral white
Optic type	-
Luminaire light beam spread	-

Operating and Electrical	
Input Voltage	220 to 240 V
Line Frequency	50 or 60 Hz
Initial CLO power consumption	N.A. W
Average CLO power consumption	N.A. W
Power Consumption	6.5 W
Power Factor (Fraction)	0.9
Connection	Push-in connector 2-pole
Cable	-
Number of products on MCB of 16 A type B	-
Suitable for random switching	No
Protection class IEC	Safety class II
Controls and Dimming	
Dimmable	No
Driver/power unit/transformer	Power supply unit (On/Off)
Control interface	-

Greenup Slim Downlight

Constant light output	No
Maximum dim level	Not applicable

Mechanical and Housing

Housing Material	Aluminum
Reflector material	-
Optic material	Polymethyl methacrylate
Optical cover material	Polymethyl methacrylate
Fixation material	Aluminum
Housing Color	White
Optical cover finish	Textured
Overall length	0 mm
Overall width	0 mm
Overall height	30 mm
Overall diameter	85 mm
Dimensions (Height x Width x Depth)	30 x 0 x 0 mm
Ingress protection code	IP20 [Finger-protected]
Mech. impact protection code	IK02 [0.2 J standard]
Optical cover type	Polycarbonate Diffuser
Net Weight (Piece)	0.160 kg

Approval and Application

Glow-wire test	Temperature 650 °C, duration 30 s
Flammability mark	-
CE mark	Yes
ENEC mark	-

EU RoHS compliant	Yes
Ambient temperature range	-20 to +40 °C

Initial Performance (IEC Compliant)

Luminous flux tolerance	+/-10%
Initial chromaticity	SDCM<5
Power consumption tolerance	+/-10%

Over Time Performance (IEC Compliant)

Driver failure rate at 5000 h	0.0015 %
Median useful life L70B50	57,000 hour(s)
Median useful life L80B50	35,000 hour(s)
Median useful life L90B50	16,000 hour(s)

Product Data

Order product name	DN150B LED6S 840 PSU GM
Full product name	DN150B LED6S 840 PSU GM
Full product code	871016333924599
Order code	911401803080
Material Nr. (12NC)	911401803080
Numerator - Quantity Per Pack	1
EAN/UPC - Product/Case	8710163339245
Numerator - Packs per outer box	10
EAN/UPC - Case	8710163339566

Dimensional drawing

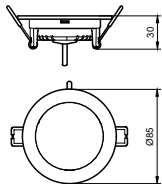

Greenup Slim Downlight

